

CH-300 Quick Guide

1. Please read below introduction carefully before using.

1. Please check any defects on the product before installation. We are not responsible for any cost or expense incurred, as a result of the failure to check before installation.
2. If the constant power discharge protection function is set 'ON', motion detection will work as parking REC mode. If the car battery voltage becomes lower than setting value of cut off voltage, a recording will stop even parking REC mode.
3. Below table is Recordable Time by "SD card Folder Capacity Adjustment" and "Video Quality" based on the default setting.
4. We shall not take any responsibility for loss and damage of the device if used with other Micro SD card.
5. In case of an accident, be sure to turn off the product and remove the SD card from the product and save the accident video file to the PC. We are not responsible for the deleted parts of the files.

* SD card capacity/recording system by saving time (default setting) (Unit : Min)

CH	Video Quality	Camera	16GB			32GB			64GB		
			Normal (50%)	Motion (20%)	Event (30%)	Normal (50%)	Motion (20%)	Event (30%)	Normal (50%)	Motion (20%)	Event (30%)
1CH	Super High	Front	76	30	46	152	61	91	304	122	182
	High	Front	88	35	53	177	71	106	353	141	212
	Normal	Front	105	42	63	211	84	126	421	168	253
2CH	Super High	Front/Rear	49	20	29	98	39	59	195	78	117
	High	Front/Rear	56	23	34	113	45	68	226	90	135
	Normal	Front/Rear	67	27	40	133	53	80	267	107	160

By Time : If there is insufficient storage space, the old recording files are automatically deleted from the oldest recording file.

By Type : When saving a recording file, set the memory usage ratio by recording type, if the memory space is full then the recording files are automatically deleted sequentially. Therefore, accident video recording files may also be deleted.

2. Package

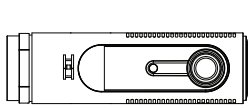

Main Body (CH-300)



Bracket

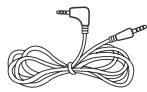

Rear Camera Cable

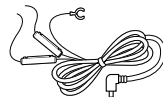

Hardwire Cable

Option

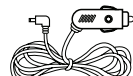

Cigar Lighter Cable

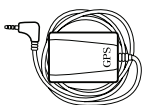

GPS Module

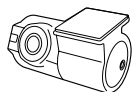

Rear Camera



Micro SD card & Adaptor

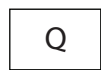

Quick Manual

3. Installation

Front Camera Installation

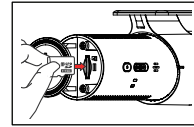

1. Insert Micro SD card to the slot of the device. (check the any faulty of the SD card)



2. Remove the protection film from the bracket's tape.

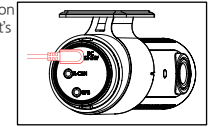

3. Connect the Hardwire cable to DC-IN port.

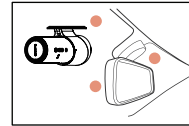

4. Attach the bracket at the left which from the windshield.



5. Connect the Hardwire cable into car fuse box.

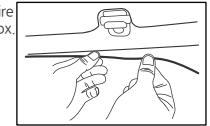

6. After checking the device, clean up the cables.



Please make sure to insert the hardwire cable to exact fuse box terminal. Some vehicles fuse terminal locations are different types. (Some vehicles may be blocked within minutes due to vehicle characteristics.)

※Please refer to the user manual of our website(www.blacksys.co.kr/en) for details of assembly and disassembly of the brackets.

Rear Camera Installation

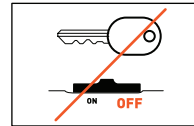

1. Please power off the car before installation. (disconnect the power connection)

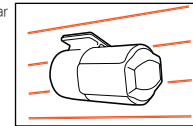

2. Remove the protection film of the bracket and attach the Camera in the proper location.

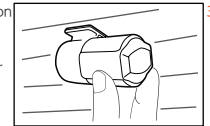

3. Adjust the camera angle and fix it. (To adjust the angle, the horizon is seen above the right center of the screen.)

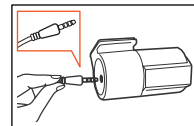

4. Plug (→) shape's rear end of the plug to the camera connection, (↵) shape's one to the device. (※caution※ Please note that if the wrong connection, the video will not be output.)

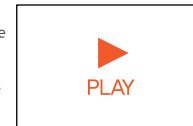

5. Turn the device on and check whether to record properly.

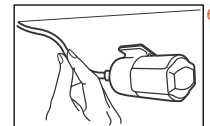

6. Arrange the wire by using the cable clip. (Please be careful not to drop or damage the cable during installation.)



While recording a video, the device may be affected by wireless devices such as radio frequency, DMB signal, remote start device, remote controller etc. Install as far away from the antenna and antenna cable as possible; and when cabling or tidying up cables, please avoid the cables to be duplicated.

External GPS Installation

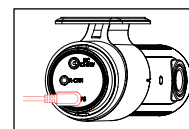

Connect the external GPS to GPS port on the device terminal.

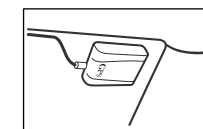

Attach the external GPS into appropriate place, and tidy up the cable.



This feature may not be available in some countries. Other electronic devices may interfere with GPS signal if placed too close to the device. Keep its distance from them as much as possible. GPS may be affected by weather conditions, satellite signal, or surrounding geographical features. Coated windshields can interfere with GPS signal which may result in poor or blocked GPS reception.