

Warning:
Changes or modifications to this unit not expressly approved by the party responsible for compliance could void the user's authority to operate the equipment.

NOTE:
This device complies with part 15 of the FCC Rules. Operation is subject to the following two conditions: (1) This device may not cause harmful interference, and (2) this device must accept any interference received, including interference that may cause undesired operation.

NOTE:
This equipment has been tested and found to comply with the limits for a Class B digital device, pursuant to part 15 of the FCC Rules. These limits are designed to provide reasonable protection against harmful interference in a residential installation. This equipment generates, uses and can radiate radio frequency energy and, if not installed and used in accordance with the instructions, may cause harmful interference to radio communications. However, there is no guarantee that interference will not occur in a particular installation. If this equipment does cause harmful interference to radio or television reception, which can be determined by turning the equipment off and on, the user is encouraged to try to correct the interference by one or more of the following measures:
-Reorient or relocate the receiving antenna.
-Increase the separation between the equipment and receiver.
-Connect the equipment into an outlet on a circuit different from that to which the receiver is connected.
-Consult the dealer or an experienced radio/TV technician for help.

RF exposure compliance statement:
This device has been evaluated to meet the general RF exposure requirement it can be used in portable exposure condition without restriction.

CONTENTS

- Product introduction 1
- Display information 2
- M OK - + button functions 3-5
- Pair to socket 6
- Set system time 7-8
- Thermostat-Mode 9
- Thermo-Timer-Mode 10-11
- Current temperature correction 12
- System reset 13
- Battery replacement 14
- Warning 15

Product introduction

The OTS600N has a powerful programming ability to provide various timer and temperature requirement. It is ideal for most heating appliances, such as infra-red heaters, tube heaters, fan heaters, floor heaters and portable radiators, as well as many electric cooling devices. Please read this manual carefully before starting or using the device. Always store the manual in a safe place for future reference.

Features:

- Temperature control range: 0.0°C~70°C or 32.0°F~158.0°F
- Time, week, temperature range can be programmed in combination.
- 3 modes: Manual Mode (always ON/OFF), Thermostat-Mode, Thermo-Timer-Mode (up to 4 settings).
- 2.4GHz wireless auto connection technology.
- Easy to view LCD screen with LED backlight.
- 12 or 24 hours setting for time.
- C Celsius and F Fahrenheit.
- DST - Daylight saving time selection.
- Low battery alert icon, appears when the battery should be replaced.
- Current temperature correction and system reset function.
- Top safety protection, built-in with its own relay control and fuse protection, and the socket is made of flame retardant PC material.

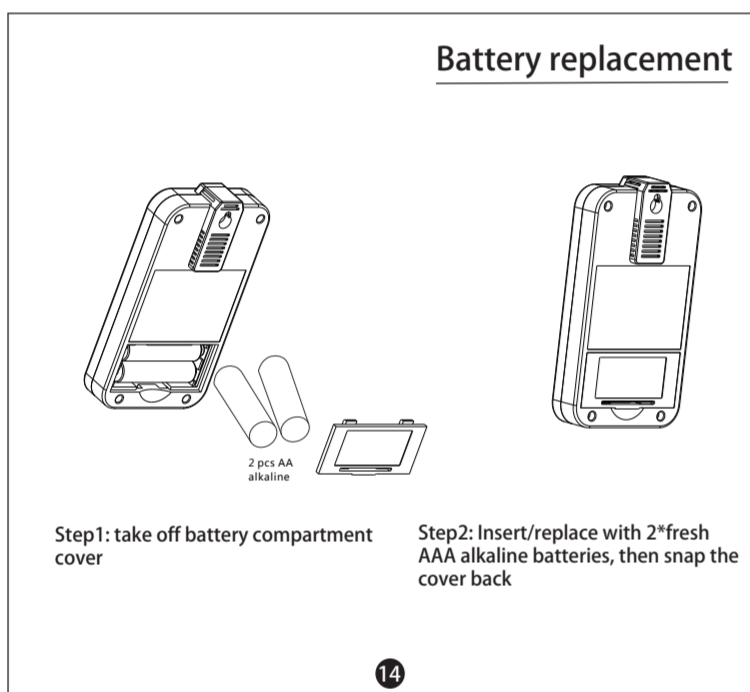
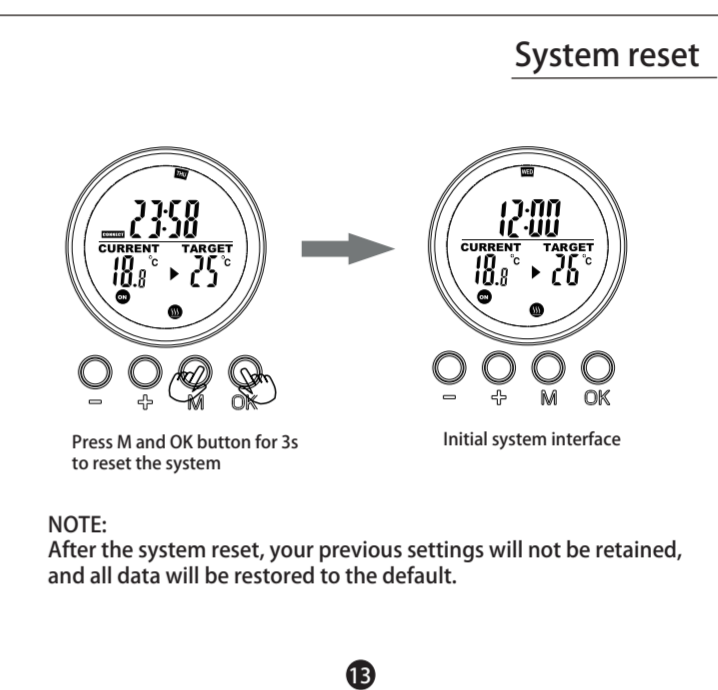
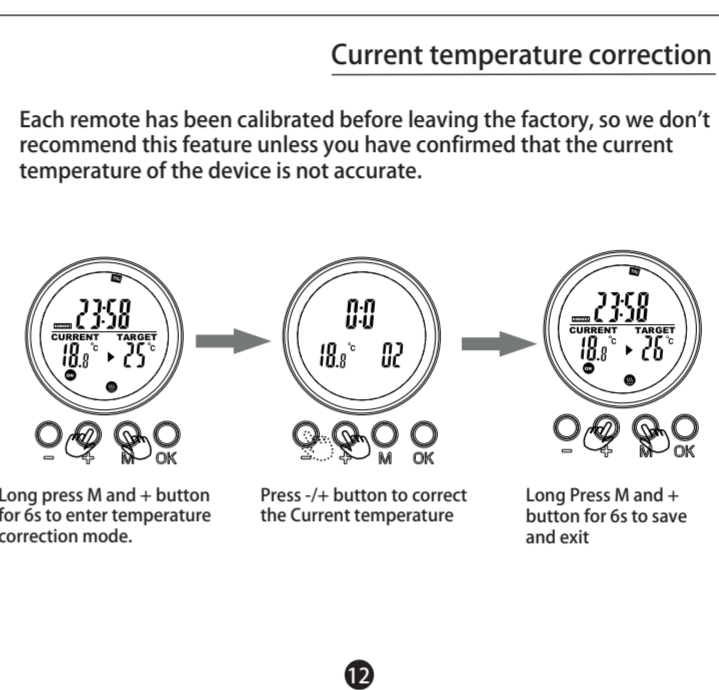
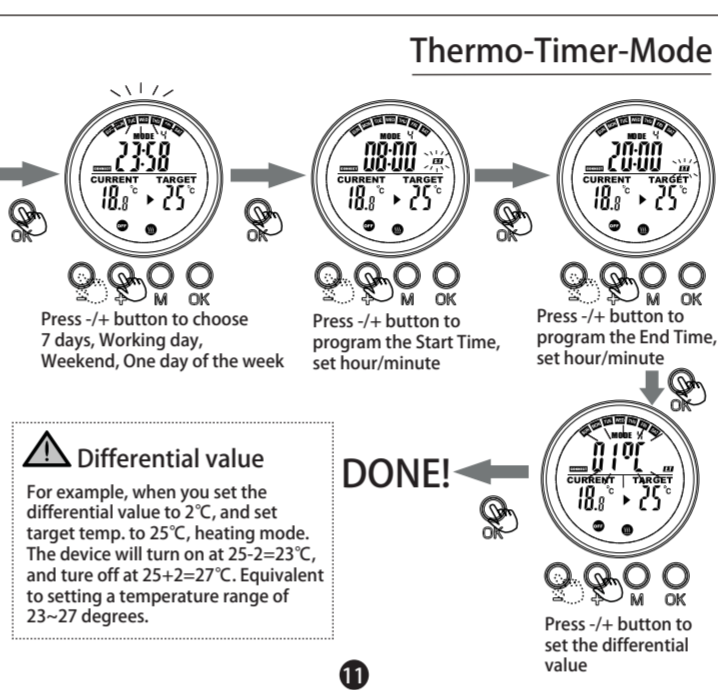
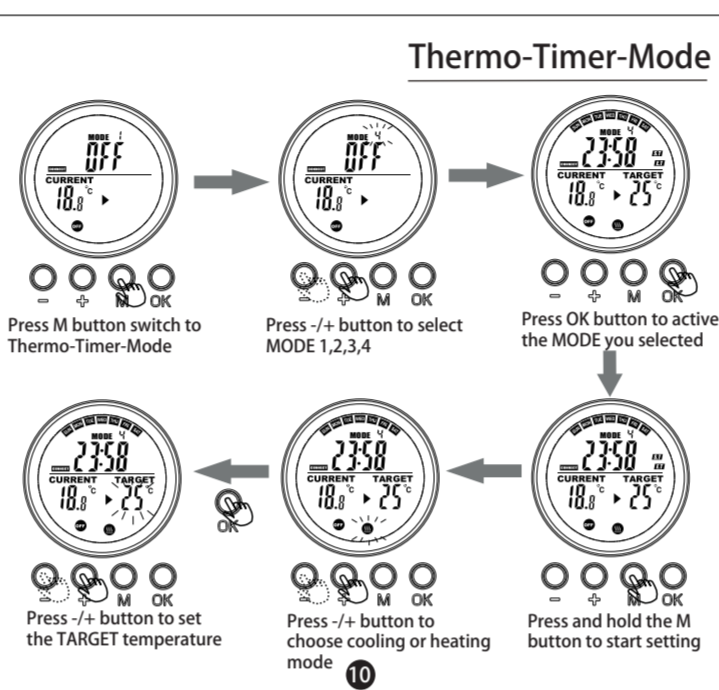
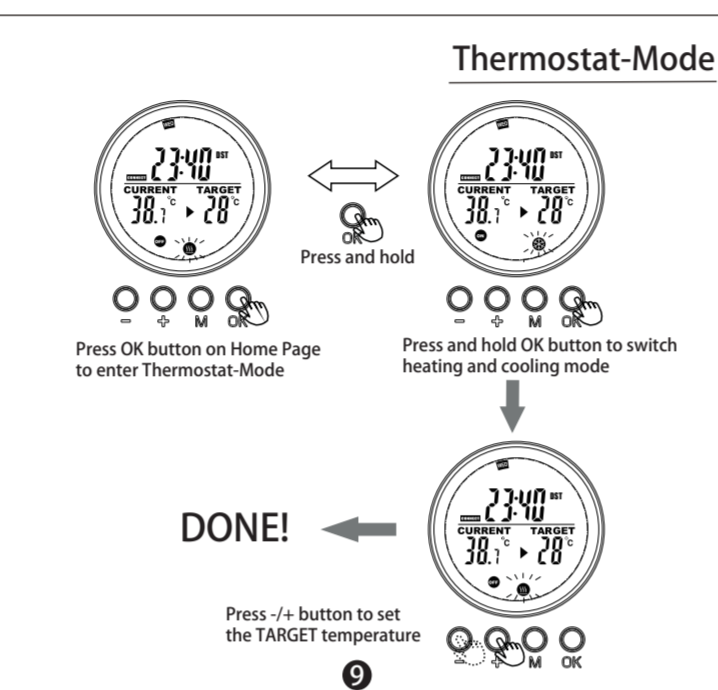
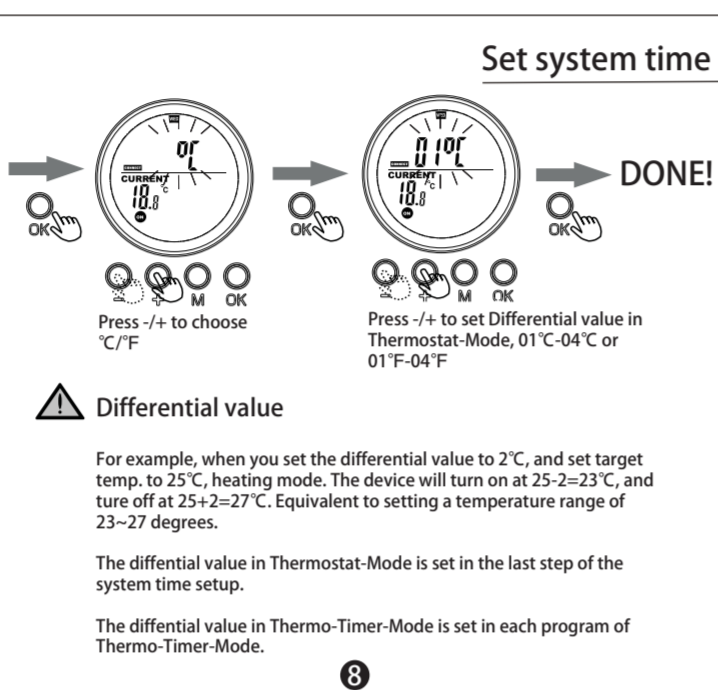
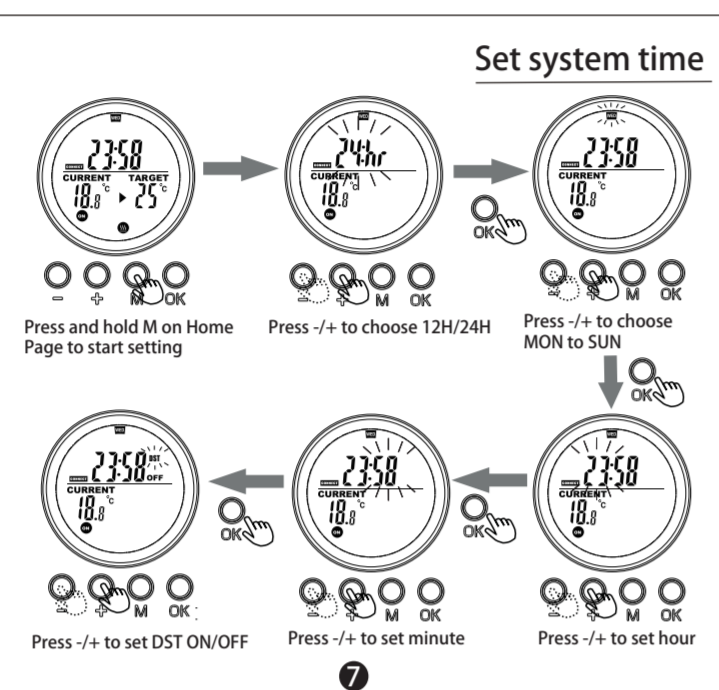
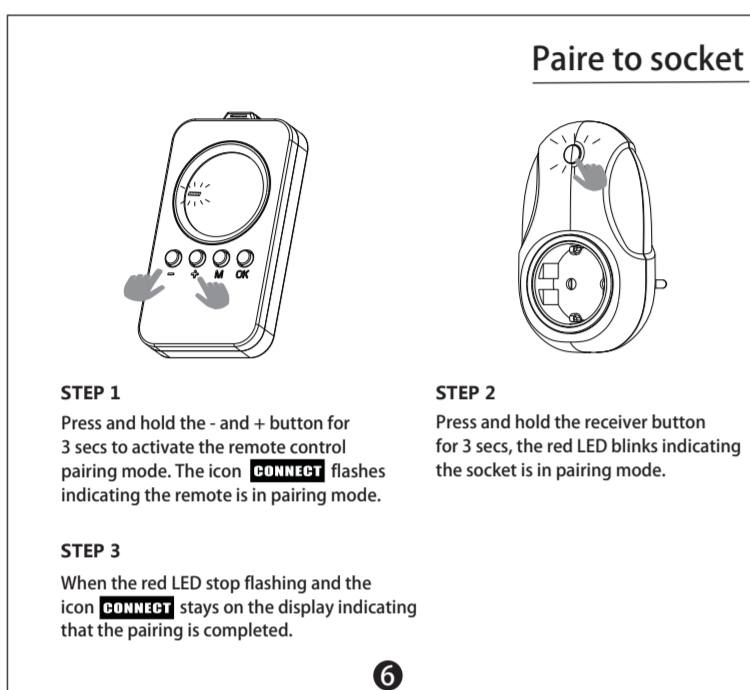
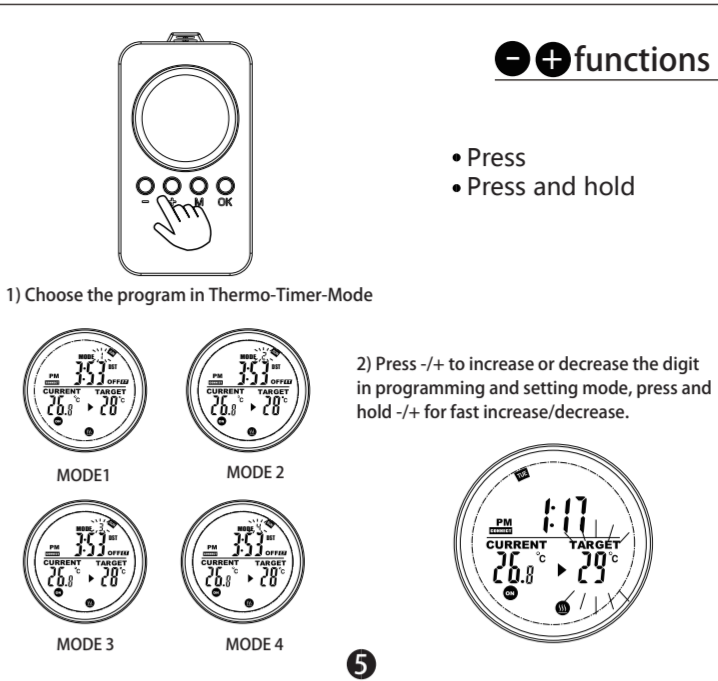
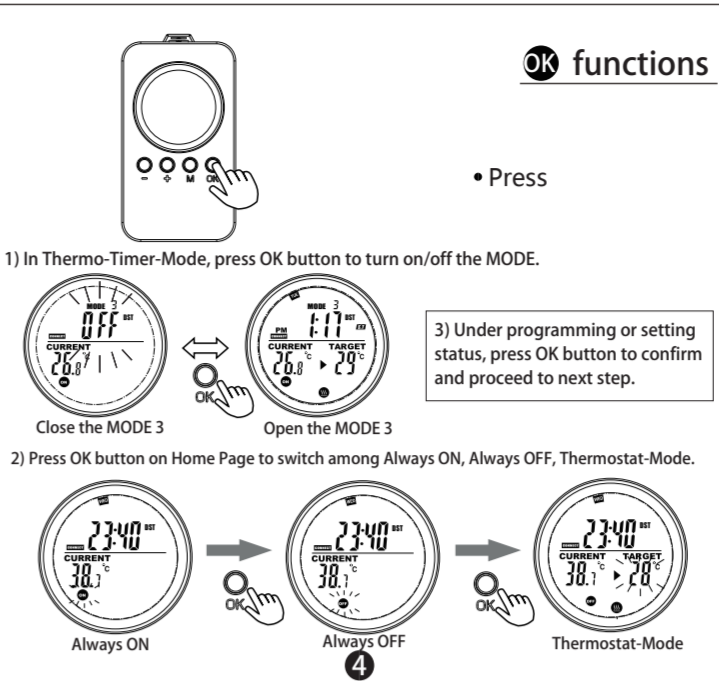
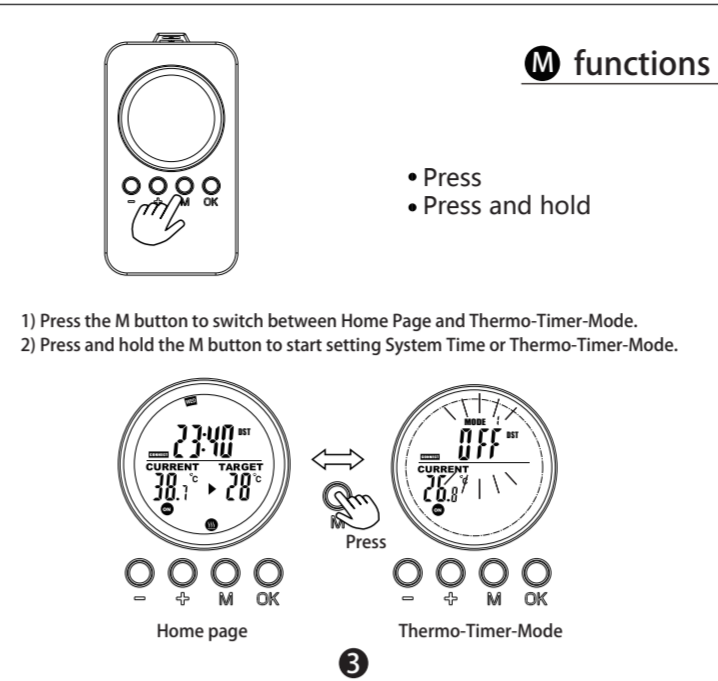
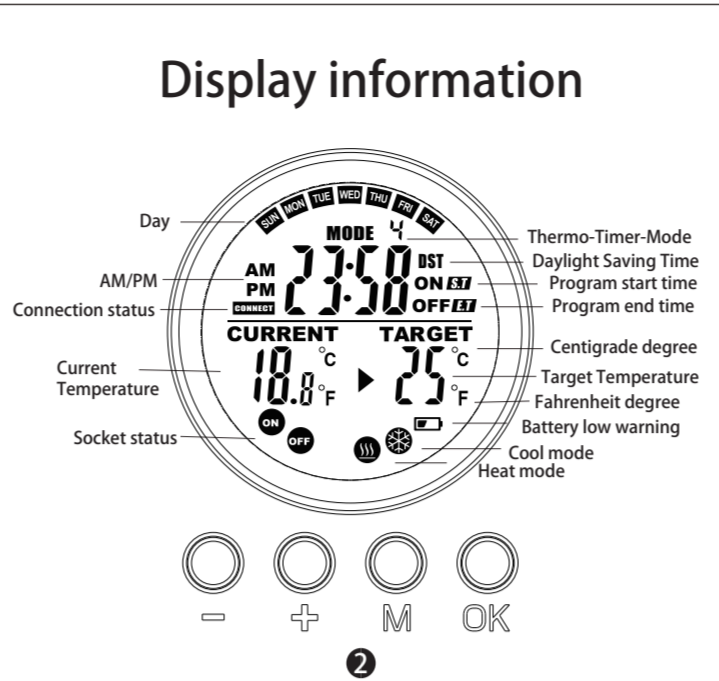

Warning

- Do not use the device in potentially explosive rooms.
- Do not use the device in aggressive atmosphere.
- This appliance is not a toy! Keep away from children and animals.
- Protect the device from permanent direct sunlight.
- Do not remove any safety signs, stickers or labels from the device. Keep all safety signs, stickers and labels in legible condition.
- Do not open the device with a tool.