



5013266900

PPM N1U_SB1 Sub-1G module Quick Installation Guide

Essential Points for Safety

- Request a specialist to dispose of the product.
- Take care to ensure no water or other liquid gets on the SUB_1G.
- The product may malfunction or may be damaged by static electricity. Be sure to remove any static electricity on the body, through such means as touching a metal object nearby, prior to coming into contact with the product.
- Store the product in a location with the temperature ranging between -30 and +70°C, with the humidity ranging from 30 to 85% RH.

Do not install the product in the following places:

- Do not expose to extreme fluctuation temperature.
- Do not expose to salt air.
- Do not expose to corrosive substances, explosive / flammable GAS, chemicals.
- Do not install in direct sunlight.
- Do not install in a place exceeding the operating temperature range (-25 to +55°C).
- Do not install above 3000m MSL or higher.
- Do not expose to water vapor, oil vapor, smoke, cotton dust, metal powder, sawdust.
※ If installed outdoor, please put it in box which is suitable for outdoor use.

Warning	
	Do not allow any fire producing objects to be near the product, or apply any spray, including combustible gases, to the product. The product may ignite or explode in the unlikely event such an occurrence takes place.
	Do not touch the product with wet hands. The product may cause injury due to electric shock or equipment malfunction may occur in the unlikely event such an occurrence takes place.
	Do not disassemble or modify the product. The product may cause injury or fire due to electric shock in the unlikely event such an occurrence takes place.
Caution	
	When installing the SUB_1G on a wall made of materials that are not wood, be sure to acquire plastic anchors available on the market to secure SUB_1G on the wall surface. There is danger of injury from the product falling in some rare cases.
	Do not install the product in the following types of locations: There is danger of burnout in some rare cases. <ul style="list-style-type: none"> • Locations that are exposed to rain water, such as outdoors or under eaves and the like. • Locations that are exposed to steam or where the moisture level is 30 to 85% RH, such as lavatories, changing rooms, work sites, kitchens and the like.
	Do not use organic solvents (paint thinners, benzene and the like), strong alkaline substances or strong acidic substances to clean the case of the product. There is danger of discoloring the case or the equipment malfunctioning in some rare cases.
	Do not install the product in a place that is subject to significant effects of vibration and impact. There is danger of injury from the product falling in some rare cases.

Scope of Delivery

NO.	Product name	Qty	Remarks	Shape
1	SUB_1G	1 unit	Main unit	
2	Antenna	1 piece	Install antenna to enhance Wireless Signals.	
3	Quick Installation Guide	1 copy	Installation guide	
4	Screw	2 pieces	SUB_1G screws	

SUB_1G Module

■ SUB_1G Module	
Name	Explanation
Network standard support	FCC/CE/TELEC/NCC
Data rates	5860bps (BW: 500kHz) 2930bps (BW: 250kHz)
Modulation techniques	FSK/OOK
Bandwidth	FCC: 500kHz CE: 250kHz TELEC: 500kHz NCC: 500kHz

SUB_1G Antenna

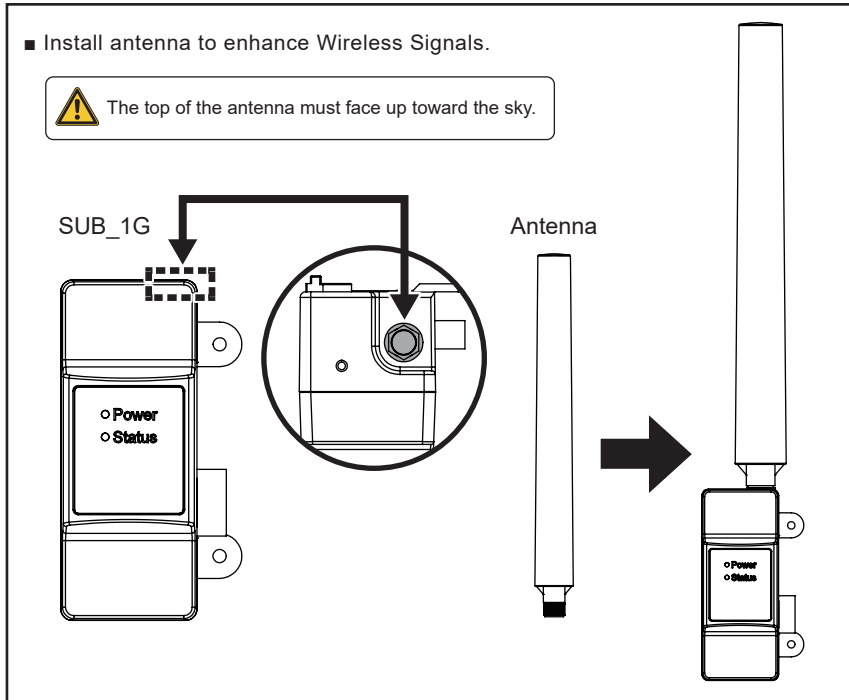

Installation Diagram

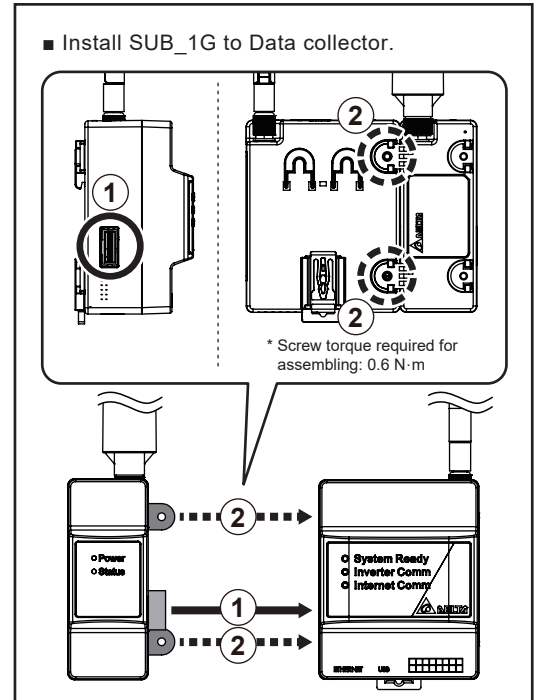

LED Description

Status	Red LED	Yellow LED	Green LED	Description
Upgrade N1	Slow Flash	OFF	Slow Flash	Update N1 card.
Upgrade Module	Slow Flash	Slow Flash	OFF	Update RF module.
No Host	OFF	Slow Flash	Slow Flash	No back-end devices are connected.
Module Not Ready	Slow Flash	OFF	OFF	Waiting for module initialization.
Ext. Idle	OFF	ON	OFF	No Ext. data transmission for more than 300 seconds.
Int. Idle	OFF	Slow Flash	OFF	No Int. data transmission for more than 600 seconds.
Normal	OFF	OFF	ON	Connecting.

Power	Light Green LED		Description
	ON		When the device is receiving power.
	OFF		Powered off.

FCC Part 15.19

This device complies with Part 15 of the FCC Rules. Operation is subject to the following two conditions:

- (1) this device may not cause harmful interference and
- (2) this device must accept any interference received, including interference that may cause undesired operation

FCC Part 15.21 information for user

You are cautioned that changes or modifications not expressly approved by the party responsible for compliance could void your authority to operate the equipment.

FCC Section 15.105 Information to the user.

NOTE:

This equipment has been tested and found to comply with the limits for a class B digital device, pursuant to Part 15 of the FCC Rules. These limits are designed to provide reasonable protection against harmful interference in a residential installation. This equipment generates uses and can radiate radio frequency energy and, if not installed and used in accordance with the instructions, may cause harmful interference to radio communications. However, there is no guarantee that interference will not occur in a particular installation. If this equipment does cause harmful interference to radio or television reception, which can be determined by turning the equipment off and on, the user is encouraged to try to correct the interference by one or more of the following measures:

- Reorient or relocate the receiving antenna.
- Increase the separation between the equipment and receiver.
- Connect the equipment into an outlet on a circuit different from that to which the receiver is connected.
- Consult the dealer or an experienced radio/TV technician for help.

IMPORTANT NOTE :

FCC Radiation Exposure Statement :

This equipment complies with FCC radiation exposure limits set forth for an uncontrolled environment.

This equipment should be installed and operated with minimum distance 20cm between the radiator & your body.