

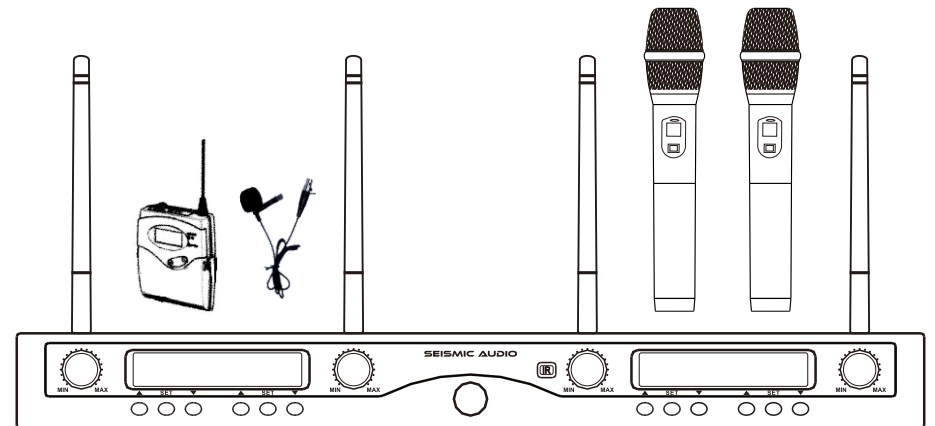

PRODUCT MANUAL



Contents included are specific to the product model purchased. Additional accessories may be purchased separately at SeismicAudio.com

SA-U4

SEISMIC AUDIO SA-U4 USER MANUAL

VALID ON MODEL #'S:

**SA-U4HH4-2, SA-U4LV6-2 & SA-U4HHLV5-2
PROFESSIONAL QUAD WIRELESS MICROPHONE SYSTEM**

Thank you for purchasing this Seismic Audio Wireless Microphone System. We strive to bring you professional equipment at an affordable price. It has been our principal ideal since the company was founded in 2000. Don't let the prices deceive you. Just because we are less expensive than the big brand name speaker companies, does not mean quality has been compromised. We manufacture the best PA Speakers the highest quality PA Speakers, and the most affordable PA Speakers. Again we stand behind our product 100%. If for any reason, you decide that our product is not for you, send us an email at: CustomerService@SeismicAudioSpeakers.com or call us: 1-877-347-3423 within 30 days after your purchase and we will issue an RMA# for you to send your item(s) back to us for a refund or exchange, NO questions asked!

We also know that choosing the right gear can be the difference between a terrible performance and a rockstar like performance that could lead to future gigs and possible contracts. That is why we offer the best, most personal customer service in the industry. We are real people here to guide you in the right direction to make sure you get the right gear that will be ideal and work best in certain situations and various venues! We treat our customers the way we want to be treated, like family!

So not only will you receive the highest quality, most affordable gear in the industry, you will also receive top notch customer service, plus all the technical expertise you will ever need is just a phone call or email away! Join the Seismic Audio revolution and see what tens of thousands already know. Whether it is for the garage band, live sound, stage, or studio... Seismic Audio is bang for the buck, the best Pro Audio gear for all PA applications!

FEATURES

- Wide Frequency Response Digital Control Circuit- resists unwanted interference with a 60dB signal to noise ratio and a 45dB carrier wave.
- Wide Range- Wireless transmission is possible over 400 feet in good surroundings.
- Series Output Circuit- Can connect to an audio mixer or other PA equipment in multiple ways.
- Cardioid Pickup Pattern- Microphone sound pickup emphasizes main sound source and minimizes background noise.
- Windscreen and Pop Filter- Microphone design includes built-in windscreen and pop filter to minimize environmental noise and sibilant sounds in speech.
- High Quality Microphone Element- Microphone constructed for best audio quality possible.
- Adaptable- Receiver can work with multiple microphone types to allow for choosing the best equipment for the situation.

TROUBLESHOOTING

FAINT SOUND OR NO SOUND

- Verify connections to PA system
- Adjust channel volume
- Turn on handheld microphone or body pack
- Check that batteries are installed correctly
- Charge or charge batteries
- Verify AC adapter is plugged securely into AC outlet
- Check that receiver unit is powered on
- Verify that antennas are connected securely

AUDIO INTERFERENCE, ARTIFACTS, OR DROPOUTS

- Change receiver and handheld microphone or body pack to a different frequency
- Identify and remove sources of interference mobile phones Wi-Fi access points signal processors, electronics et
- Charge or change batteries
- Verify system is being used within recommended range
- Move system away from metallic surfaces
- Provide line-of-sight from handheld microphone or body pack to receiver unit antennas

DISTORTION

- Lower channel volume
- Change or charge batteries
- Verify fidelity of signal cable to PA

IR SYNC NOT WORKING

- Verify both units are turned on
- Hold the handheld microphone with LCD display turned toward the receiver
- Hold the body pack with the top of the unit turned towards the receiver
- Hold the handheld microphone or body pack 3 to 6 inches from the center front face of the receiver

If you are still experiencing issues after following this troubleshooting guide, please call us directly at 1-877-347-6423 or email to customerservice@seismicaudiospeakers.com for expert assistance. The specifications and instructions provided in this manual are subject to change without notice.

VISIT US AT: SEISMICAUDIOSPEAKERS.COM

Optional Accessories available at SeismicAudioSpeakers.com

Model#	Description
SA-U4BP-2	Wireless Body Pack
SA-U24SCHS-2	Skin Colored Head Set
SA-U24BHS-2	Black Head Set
SA-U24LV-2	Lavalier / Lapel Microphone plus clip
SA-U4HH-2	Handheld Microphone

Body Pack LCD Display

1. UHF Channel Number
2. Transmitter Volume
3. Channel Frequency
4. RF Output
5. Lock Indicator
6. Battery Level

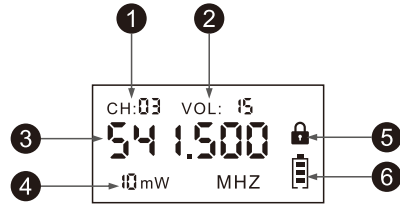

SETUP AND OPERATION

1. Connect SA-U4 Receiver to PA system with XLR for individual channel sends or via TS for mix output.
2. Turn on SA-u4 Receiver
3. Power on handheld microphone or body pack.
4. To manually choose a frequency, press the UP or DOWN buttons located on the receiver until a desired frequency is selected. After selection is made, it becomes locked after 3 seconds.
5. To SCAN all frequencies for a clear channel, press and hold the SET button until the receiver starts scanning the available frequencies. A clear frequency is selected and becomes locked after the scan is complete.
6. To sync the receiver frequency with the handheld microphone or body pack:
 - Power on handheld microphone or body pack.
 - Press SET button once to begin frequency sync between the receiver and the handheld microphone or body pack. The IR indicator on the receiver will begin flashing.
 - Point the LCD display on a handheld microphone or the top of the body pack towards the receiver, approximately 6 inches from the center front face of the receiver.
 - The IR sync will tune the microphone or body pack to the desired frequency on the receiver. The receiver will attempt to sync the frequency for approximately eight seconds.
7. Adjust volume with the volume control on the face of the receiver.
8. Repeat this procedure for each microphone or body pack, while making sure that they do not use the same frequency.

HANDHELD MICROPHONE ADDENDUM

1. In cases of extreme interference, it may help to toggle the HI/LO switch located inside the battery compartment.
2. Hold the tip of the microphone about an inch from your mouth, at about 45°. The most important thing is to maintain consistent microphone positioning for a consistent volume and tone. Varying the angle or the distance from your mouth will change the sound produced.

BODY PACK ADDENDUM

1. Power switch ON/OFF, long press 2 seconds to open, long press 2 seconds to off.
2. Open the battery compartment, and use "sync" window to receiver "IR" window can choose frequency.

SPECIFICATIONS

Operating Range	: up to 400 feet
Channel Selection	: 200UHF channels
Frequency Range	: 530-590 MHz
Frequency Stability	: ±0.05%
Modulation Mode	: UHF
Frequency Response	: 40Hz-15KHz
Dynamic Range	: >100dB
S/N	: >100dB
THD	: <0.5%
Audio Output	: Individual Balanced XLR outputs, Mix Unbalan TS or XLR
Power Voltage	: AC 110V or 220V
Temperature Range	: -4°F to 140°F
Battery Life	: up to 8 hours

RECEIVER FRONT

1. Antenna
2. Channel Select
3. Volume Control
4. LCD Display
5. Power Button
6. IR Sensor
7. Select IR

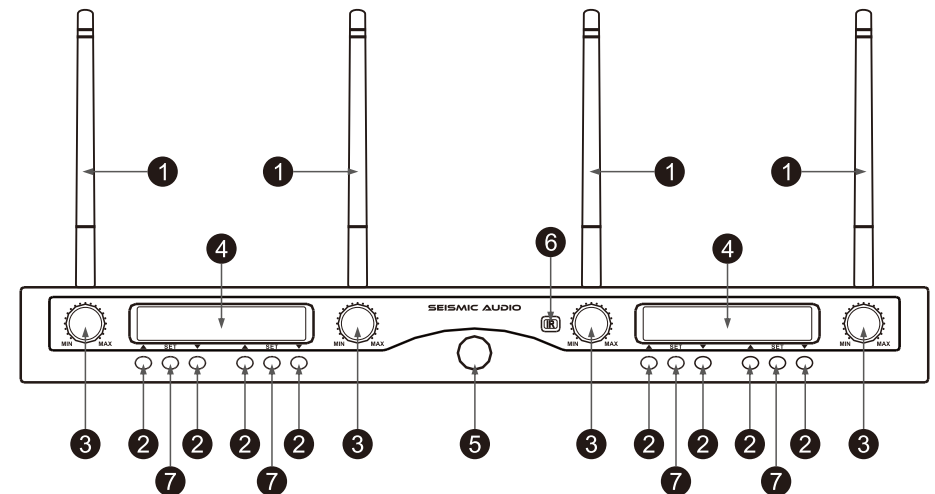

RECEIVER REAR

1. Antenna Port
2. Individual Channel Output-3-Pin XLR Male Connection
3. Mix Audio Output - 1/4" TS Female Connection or 3-Pin XLR Male Connection
4. AC Power Input

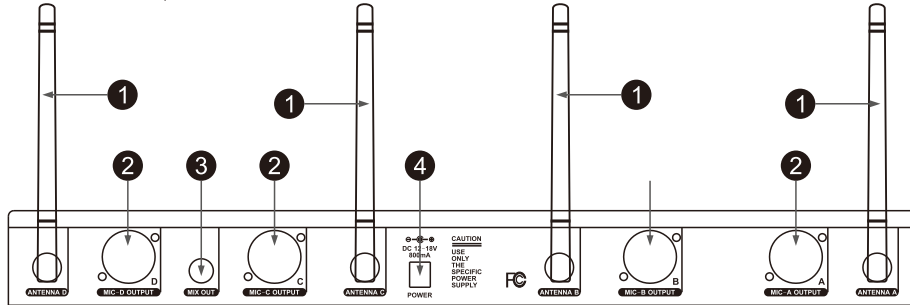

RECEIVER LCD DISPLAY

1. CH-UHF Channel Number
2. IR- Indicator for IR Transmission
3. UHF Frequency
4. RF-Signal Strength Indicator
5. VOL-Not Used
6. Battery Level

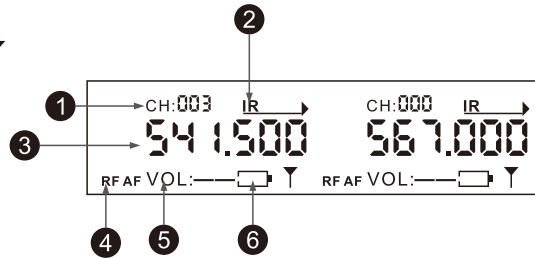

RECEIVER LCD DISPLAY

1. Windscreen and Pop Filter
2. LCD Display
3. IR receive
4. Power ON/OFF
5. Battery Cover
6. HI/LO-RF Output Level Switch

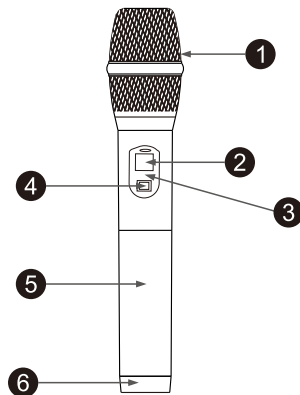

3

MICROPHONE LCD DISPLAY

1. Channel Frequency
2. Battery



LAVALIER

1. Windscreen
2. Clip
3. Mini-XLR Output

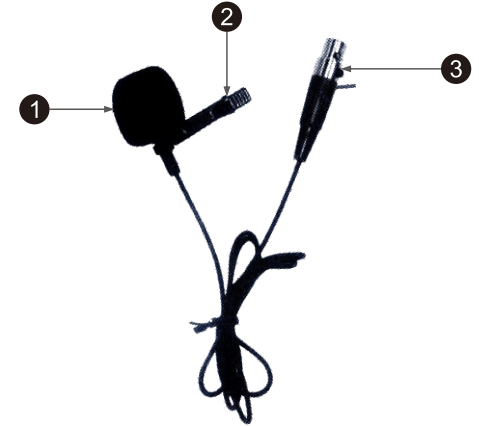

BODY PACK TOP

1. Mini-XLR Input
2. Mute
3. Antenna
4. Power indicate light

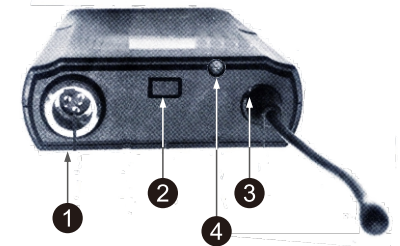

BODY PACK FRONT

1. LCD Display
2. Power ON/OFF
3. IR Receiver
4. Gaint
5. Battery Cover

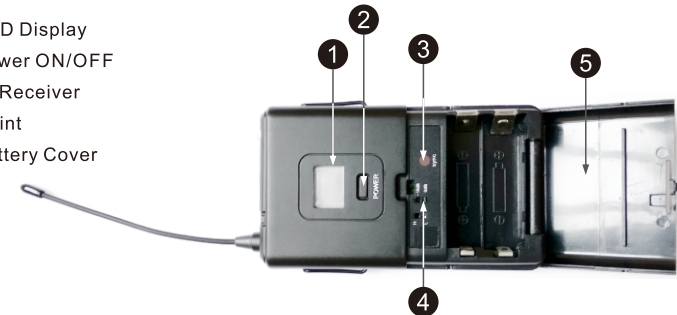

4

Sensitivity: $\leq 50\text{dBuV}(S/N \geq 20\text{dB})$

Extra Weight: 50us

3) TRANSMITTER

Modulation: FM

Higher Harmonic: 40dB lower than the Datum wave

Battery: 3V(2× AA 1.5V)

Operating temperature: -10 to 45 °C

Remarks: Because the product is continuously improving, specification may change. Please forgive us not to inform you.

FCC warning statement

This device complies with Part 15 of the FCC rules.

Operation is subject to the following two conditions:

- 1) this device may not cause harmful interference, and
- 2) this device must accept any interference received, including interference that may cause undesired operation.

Changes or modifications not expressly approved by the party responsible for compliance could void the user's authority to operate the equipment.

The device has been evaluated to meet general RF exposure requirement. The device can be used in portable exposure condition without restriction.