

200X190MM 157克双铜正面

中间对折

Mini Electric Skateboard User Operation Manual



www.urbanmove.co

Preparation

1. Position the switch of the handle/skateboard in the correct place as seen in the diagram.
 - A. Ensure skateboard power switch is off.
 - B. Position the speed switch on the remote to "slow" setting.
 - C. Ensure remote control has been fully charged.
2. Skateboard should be fully charged before using.

Remote Control Diagram

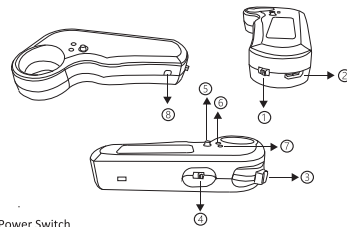

1. Power Switch
2. Charging Port(Mini USB)
3. Start/Brake Switch
4. Speed Switch (Slow/fast)
5. Direction Switch(Forward/backward)
6. Backward/Charging Indicator
7. Forward Indicator
8. Reset

When experiencing issues with remote functionality "Reset" to troubleshoot.(Ensure remote control has power)

POWER INDICATOR

The remote control has a built-in Lithium-Polymer battery, when it is low on power the red indicator will flash and an alarm will sound. If this happens turn off the skateboard and charge the remote control. It is suggested that you do not use the remote control when it's low battery.

200X190MM 157克双铜反面

中间对折

Operation

Start: After sliding the "Power switch" to turn on the skateboard the "forward indicator" will be lit (red indicator).

Forward & Backward mode:

1. If you want to accelerate forward, push forward on the "Start/Brake switch" and hold in position, the skateboard will keep moving forward; if you loosen your grip, the speed will slow down. Pull back on the "start/brake switch" to brake.

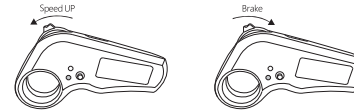

2. Switch the driving model to "reverse", and do the same operation as step to accelerate backwards/brake.

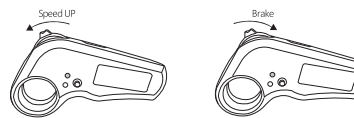

Slow & Fast mode:

1. Before starting the skateboard, set the switch to the left side, it will be in "Slow/Beginner" mode. We strongly suggest new and beginner riders only utilize this setting until they become comfortable riding the skateboard.

2. If you set the switch to the right, it will be in "Fast/Expert" mode. It's suggested that only experienced riders utilize this setting.

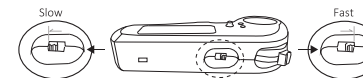

Charger

Skateboard is charged externally. First place plug into the skateboard's charging port. The charging port is located in the battery compartment side. Then plug the charger into the power source. While charging the battery, the LED light will be red, when it turns green charging is completed. Please use the standard charger. Using an alternative charger is not recommended.

Servicing and maintenance instructions

Clear note stating that regular maintenance enhances the safety of the equipment

- This includes:
1. note regarding the maintenance of the bearings
 2. replacement of wheels and cushions (where possible or present)
 3. lubrication of the bearings;
 4. steering adjustment
 5. note to remove any sharp edges created through use
 6. inspection
 7. note to look for splinters and cracks in the deck and to replace when needed

Battery

1. Please use the matched lithium battery.
2. Please don't place the battery near water, fire, or an environment of extreme temperature.
3. Please don't use an impacted or aging battery.
4. Please don't place charging batteries in a easily ignored place.
5. Please stop charging when battery is under abnormal conditions such as overheating.



Specification	Size	UR1	UR2
		Weight	43x15cm/17x6" 3.8kg/7.5lbs
Product Performance	Load	100kg/240lbs	150kg/330lbs
	Max Speed	19km/h/12mph <small>(may depend on rider's weight)</small>	25km/h/15mph <small>(may depend on rider's weight)</small>
Battery	Type	Lithium-ion	Lithium-ion
	Standard Voltage	24V	24V
	Capacity	2.2A	2.6A
Range	10km/7miles	13km/8miles	
Motor	Max Power	150W	250W
	Input Voltage	AC110-240V	AC110-240V
Charger	Output Current	1A	1A
	Charge Time	1.5h	1.5-2h
	Control Model	Remote	2.4GRF Technology
Speed	Fast/Slow	Adjust by switch	Adjust by switch
Wheel	Type	PU	PU
	Size	72*51mm	72*51mm
Packing box	inner size	455*235*118mm	485*235*128mm
	outer size	460*250*125.5mm	490*250*135mm

Caution: The user is cautioned that changes or modifications not expressly approved by the party responsible for compliance could void the user's authority to operate the equipment.

This device complies with Part 15 of the FCC Rules. Operation is subject to the following two conditions: (1) this device may not cause harmful interference, and (2) this device must accept any interference received, including interference that may cause undesired operation.

NOTE: This equipment has been tested and found to comply with the limits for a Class B digital device, pursuant to Part 15 of the FCC Rules. These limits are designed to provide reasonable protection against harmful interference in a residential installation. This equipment generates, uses and can radiate radio frequency energy and, if not installed and used in accordance with the instructions, may cause harmful interference to radio communications. However, there is no guarantee that interference will not occur in a particular installation.

If this equipment does cause harmful interference to radio or television reception, which can be determined by turning the equipment off and on, the user is encouraged to try to correct the interference by one or more of the following measures:

- Reorient or relocate the receiving antenna.
- Increase the separation between the equipment and receiver.
- Connect the equipment into an outlet on a circuit different from that to which the receiver is connected.
- Consult the dealer or an experienced radio/TV technician for help.

FCC Radiation Exposure Statement:

This equipment complies with FCC radiation exposure limits set forth for an uncontrolled environment.

This transmitter must not be co-located or operating in conjunction with any other antenna or transmitter.