

Wireless conference system equipment

Operating Manual



Please read this manual carefully before use

Equipment Overview

Connected via the USB interfaces of Internet computer devices, the wireless conference system (hereinafter referred to as "the System") can be mounted with external loudspeaker output interfaces to output meeting audio in real time. It is also mounted with multiple wireless omnidirectional microphones for the overall pick-up and also with local microphone input interfaces for ensuring easy, fast and efficient arrangement of meeting.

Equipment Introduction

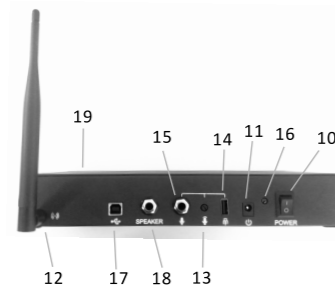

Panel Diagram in Back of the Host

- (1) Slave status ring light
- (2) Built-in microphone
- (3) Speaker mute key
- (4) Volume - key
- (5) Volume + key
- (6) Microphone mute key
- (7) Charging indicator
- (8) USB charging interface
- (9) Slave on/off button

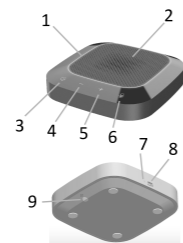

Wireless microphone slave

- (10) Power switch button
- (11) DC power input port
- (12) External antenna port
- (13) External microphone gain adjustment
- (14) USB 5V power output port
- (15) 6.5mm microphone input port
- (16) Power indicator
- (17) Master USB data interface
- (18) SPEAKER audio output port
- (19) SPEAKER audio output status indicator (at front position of host)

Packing List



Host and external antenna X1



Wireless microphone slave ≅ 4

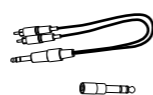

Audio cable and audio adapter X1



Host power adapter X1



Host USB cable X1

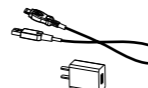

Slave power adapters ≅ 4 sets



Operating Manual X1

(2)

Installation and Connection of Equipment

1. As shown in the diagram, firstly connect the external antenna, connect the compute device via USB data wire, insert the pug of host power adapter into the power input port of host and then insert the AC power supply into the socket; turn on the power button of host and host power indicator will turn red.
2. Before use, the wireless microphone slave should be connected with the USB power adapter to fully charge the built-in battery. The slave charging indicator will be on in orange when charging and will be off when the battery is fully charged. When the host is connected wirelessly, the slave ring light flashes in red, indicating low battery and that the battery needs to be charged in time.
3. Long press the slave power button until the circular green indicator is on, which means the wireless microphone slave is connected with the host successfully through wireless mode; if this indicator flickers in green, it has no wireless connection with the host.
4. The installation distance between host loudspeaker and wireless microphone slave must be over 2m; the recommended installation distance between wireless microphone slaves is 1.5 m.

Schematic Diagram for Connection of Host Devices

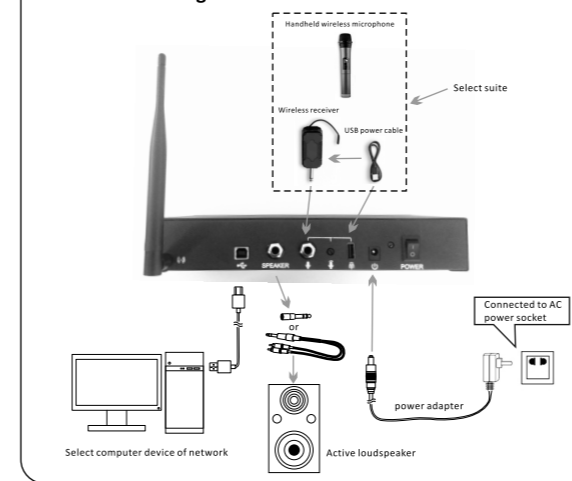

(3)

Operation Instructions

1. Main Application Connection Diagram of Net Conference Telephone



2. Connection Diagram of Sound Application in Local Classroom and Meeting Room

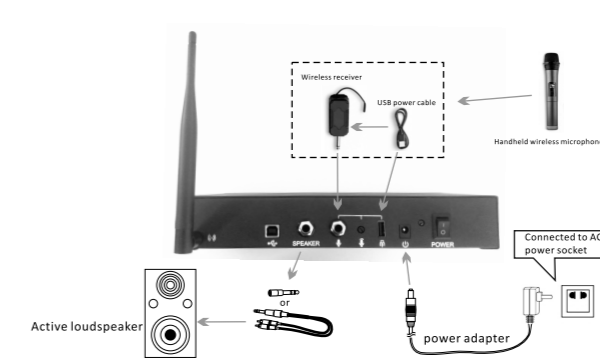

(4)

Operation Instructions

1. According to meeting application scenario and requirements for equipment installation, determine the installation locations of the active loudspeaker and wireless microphone, install the antenna on the host, connect the host to the computer the USB cable, adjust the loudspeaker to a low volume, insert the DC power adapter to supply power, turn on the power switch of host and power indicator will turn red; the indicator of SPEAKER audio output status will turn green by default.
2. Press and hold the on/off button of each wireless microphone slave in turn. When the green light is always on, it means that the slaves have been connected wirelessly to the host.
3. The communication between the remote and local meeting places shall be established through the network instant messaging APP (such as: QQ, SKYPE, etc.) of the computer; in the call process, it is necessary to moderately turn up the volume of the loudspeaker and adjust the sensitivity of the computer microphone so that we can clearly hear the voice of the local and remote meeting places, and then you can proceed to interactions through network conference telephone.
4. During the call, you can press the "Microphone Mute" button to mute the wireless microphone, at the moment, the ring red light will be always on; you can press the "Microphone Mute" button again to release the mute function and the ring red light will be off.
5. Click "Speaker mute" key of wireless microphone slave during communication and the indicator of SPEAKER audio output status at front side will turn red; click "Speaker mute" button again to recover the voices and the red indicator of host will turn green again.
6. When the device is used for loudspeaker application in local classrooms and conference rooms, it can be connected with the external microphone with a 6.5mm plug. For example, handheld wireless microphone suite can be selected and installed according to the connection diagram for local sound amplification. The external microphone gain can be adjusted properly if necessary.

Note: This device is applicable for PC with Windows and other operating systems. USB interface adopts USB1.1, USB2.0 or above; USB cable is plug and play and does not need to install additional driver.

Notes

1. In addition to this device, network linked PC cannot be connected with other microphone and loudspeaker at the same time to avoid problems in use.
2. Connect the USB cable of the loudspeaker master directly to the computer device. The use of the USB concentrator for connection will lead to problems in operation.
3. After the device is successfully connected, the default device for playing (output) and recording (input) will display "Model of Local Device" in the sound and audio device properties of the control panel option of the computer device; otherwise, "Model of Local Device" needs to be selected again for confirmation.
4. Keep the built-in battery of the equipment off high temperature and fire source to avoid explosion risk.
5. Please do not try to repair the equipment, or else it may cause electric shock. If there is a problem and the equipment needs to be repaired, please contact your dealer.

(5)

FCC Warning

This device complies with part 15 of the FCC rules. Operation is subject to the following two conditions: (1) this device may not cause harmful interference, and (2) this device must accept any interference received, including interference that may cause undesired operation.

Changes or modifications not expressly approved by the party responsible for compliance could void the user's authority to operate the equipment.

NOTE: This equipment has been tested and found to comply with the limits for a Class B digital device, pursuant to part 15 of the FCC Rules. These limits are designed to provide reasonable protection against harmful interference in a residential installation. This equipment generates uses and can radiate radio frequency energy and, if not installed and used in accordance with the instructions, may cause harmful interference to radio communications. However, there is no guarantee that interference will not occur in a particular installation. If this equipment does cause harmful interference to radio or television reception, which can be determined by turning the equipment off and on, the user is encouraged to try to correct the interference by one or more of the following measures:

- Reorient or relocate the receiving antenna.
- Increase the separation between the equipment and receiver.
- Connect the equipment into an outlet on a circuit different from that to which the receiver is connected.
- Consult the dealer or an experienced radio/TV technician for help.

Radiation Exposure Statement

This equipment complies with FCC radiation exposure limits set forth for an uncontrolled environment. This equipment should be installed and operated with minimum distance 20cm between the radiator and your body.