



New MagMount Qi User Manual

Package Contains:

- PITAKA New MagMount Qi *1
- Charging Cable *1
- User Manual*1

1

Compatibility Notice:

- The PITAKA New MagMount Qi will only wirelessly charge any Qi supported phones with a proper PITAKA MagCase (Pro).
- Wireless charging may not work when you put other cases or stick metal plates on your phone.
- Do not use the New MagMount Qi to charge your wireless charging devices that are not Qi-compatible wirelessly.

2

Quick Guide

Step 1: Connect the cable to the New MagMount Qi's USB port and your car charger's USB port. Plug the car charger into your car's power outlet.

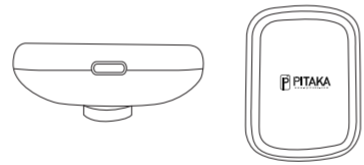

3

Step 2: Install the New MagMount Qi on your car
1, Installing the PITAKA Car Vent New MagMount Qi
Find a safe location on the vehicle vent, slide the New MagMount Qi air vent clips into your car's air vent.

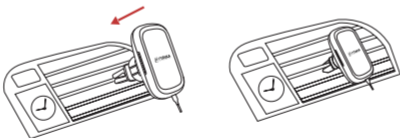

4

2, Installing the Suction Cup New MagMount Qi
Find a proper location on the windshield or the dashboard, and clean the surface. Then firmly press the suction cup and press down the suction switcher to ensure the New MagMount Qi is adhered tightly to the windshield or dashboard.

*Notice: Remember to press the suction cup on the windshield FIRST, then press the suction switcher and lock to ensure that you have tightly adhered the New MagMount Qi to the windshield.

5

2.1 Firmly press the suction cup against the windshield.



a) Push down the suction switcher to lock the mount in place.

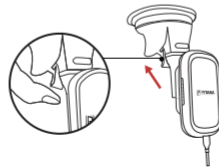

6

2.3 Then the MagMount Qi is attached on the windshield tightly.



Notice: A dashboard pad is needed when you attach it on your car's dashboard.

7

3. Installing the CD Slot MagMount Qi
Simply insert the slot mount and tighten the screw to lock it in place

3.1 Insert the mount in the CD slot

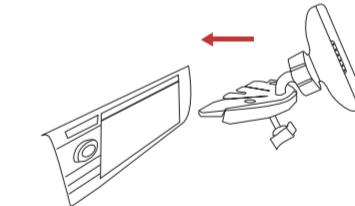

8

3.2 Tighten the mounting screw to lock the mount in place.

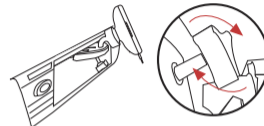

3.3 Then MagMount Qi (CD Slot) is installed well

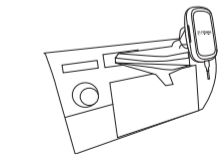

9

Step 3: Attach your compatible phone on the vent mount. The vent mount starts charging your phone immediately and holds securely.

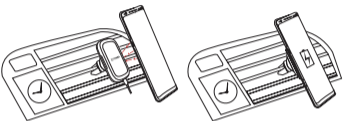

Step 4: You can adjust the ball-joint rotation of the vent mount, so your device is in either portrait or landscape orientation. And then tighten the rotation to fix the position until it rests firmly.

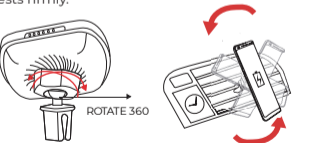

10

Spec

Items	specification
Input Voltage	5V ~9V
Input Current	≤2A
Rated Output Voltage/ Current (Normal charging)	DC 5V/1A
Rated output voltage/ current (Fast charging)	DC 9V/1.1A
Max Output Power	10W
Transmission Distance	≤5mm
Transfer Efficiency	75% Max
Operating Temperature	-10°C~30°C
Storage Temperature	-20°C~60°C
Working Frequency	110KHz-205KHz

11

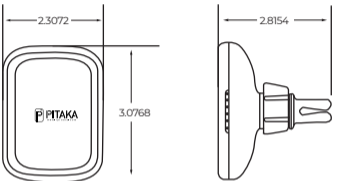

Note: Fast charging will only be supported when using a QC 3.0 adapter with an output over 18W and a USB cable supporting 3A power output.

12

Warranty

The PITAKA MagMount Qi is warranted for 12 months from the date of purchase. The MagMount Qi is warranted to be free defects in materials and function under normal use for the lifetime of the product. A defect is defined as an imperfection or flaw that is produced by a manufacturing error, including malfunction of wireless charging or surface defect, etc. This warranty is non-transferable and covers only the original end-user purchaser. PITAKA will only authorize the warranty claim if the product was purchased from the official store or authorized dealer.

MODIFICATION: Any change or modification of this device will void the warranty.

Exclusion

Damages don't cover those resulting from abuse, not correctly maintained, alteration or misuse (including disassemble, drops), abnormal wear and tear, cosmetic damages that do not affect the functionality.

13

Important

Read all instructions and warnings before using this product. Improper use may result in product damage, excess heat, toxic fumes, fire or explosion, for which damages PITAKA is not responsible.

1) DO NOT DIRECT HEATED AIR FROM THE VENT ONTO THE MOUNT WHILE IT IS ATTACHED TO THE VENT. When running the car's heater, make sure you close the vent that the mount is attached to or take the mount from the car vent directly, or direct the heated air out of the car's lower vents and away from the upper vents.

2) Do not keep the MagMount Qi in a high-temperature environment, including heat caused by intense sunlight or other forms of heat. Do not place it in the fire or other excessively hot environments.

3) Do not disassemble the New MagMount Qi or attempt to modify it in any way.

4) Do not attempt to power the New MagMount Qi with any connection other than the Type-C connector.

14

5) Do not attempt to replace any part of the New MagMount Qi.
6) All products have gone through a thorough quality assurance inspection. If you find that your New MagMount Qi is excessively hot, is emitting odor, is deformed, abraded, cut or is experiencing or demonstrating an abnormal phenomenon, immediately stop all product use and contact Manufacturer.

7) If this New MagMount Qi is intended by the purchaser to be used by a minor, purchasing adult agrees to provide detailed instructions and warnings to any minor before use. Failure to do so is the sole responsibility of the purchaser, who agrees to indemnify Manufacturer for any unintended use/misuse by a minor.

Customer Service

Phone: +852 9202 6223

E-mail: support@ipitaka.com

Website: www.ipitaka.com

15

FCC WARNING

This device complies with part 15 of the FCC Rules. Operation is subject to the following two conditions:

(1) this device may not cause harmful interference, and (2) this device must accept any interference received, including interference that may cause undesired operation. Any changes or modifications not expressly approved by the party responsible for compliance could void the user's authority to operate the equipment.

NOTE: This equipment has been tested and found to comply with the limits for a Class B digital device, pursuant to Part 15 of the FCC Rules. These limits are designed to provide reasonable protection against harmful interference in a residential installation.

This equipment generates, uses and can radiate radio frequency energy and, if not installed and used in accordance with the instructions, may cause harmful interference to radio communications. However, there is no guarantee that interference will not occur in a particular installation.

16

If this equipment does cause harmful interference to radio or television reception, which can be determined by turning the equipment off and on, the user is encouraged to try to correct the interference by one or more of the following measures:

- Reorient or relocate the receiving antenna.
- Increase the separation between the equipment and receiver.
- Connect the equipment into an outlet on a circuit different from that to which the receiver is connected.
- Consult the dealer or an experienced radio/TV technician for help.

The device has been evaluated to meet the general RF exposure requirement.

FCC ID: 2AR15-CM3001Q

17

This device complies with part 15 of the FCC Rules. Operation is subject to the following two conditions: (1) This device may not cause harmful interference, and (2) this device must accept any interference received, including interference that may cause undesired operation.