

HOW TO USE G2P

USER GUIDE



Bluetooth Intercom Headset

LEXIN

V 1.0



Table of Contents

P01 [Download User Manual Online](#)

P02 [Watch Instruction Video Online](#)

P03 [Function Introduction](#)

P04 [Product Contents](#)

P05 [Installation Instructions](#)

P09 [Basic Operation](#)

P23 [Warning](#)



Download User Manual Online

English

★- For Online User Manual in English, Spanish, German, Italian, French, Japanese... Visit **www.lexinmotorcycle.com**, Go to Support - User Manual, and select "G2P".

Français

★- Pour obtenir un mode d'emploi en Anglais, Espagnol, Allemand, Italien, Français Japonais en ligne... Accédez à **www.lexinmotorcycle.com** et trouvez-les sur Support - User Manual, puis sélectionnez "G2P".

Italiano

★- Per il Manuale Utente Online in Inglese, Spagnolo, Tedesco, Italiano, Francese Giapponese ... Visita **www.lexinmotorcycle.com**, vai su Support - User Manual, e seleziona "G2P".

Deutsch

★- Online Bedienungsanweisung auf Englisch, Spanisch, Deutsch Italienisch Französisch, Japanisch usw, besuchen Sie **www.lexinmotorcycle.com** gehen Sie zur Unterstützung - Bedienungsanweisung, dann wählen Sie "G2P".

Español

★- Para el Manual del Usuario en Línea en Inglés, Español, Alemán Italiano, Francés Japonés... Visite **www.lexinmotorcycle.com**, vaya al Soporte - Manual de Usuario, y seleccione "G2P".



Watch Instruction Video Online

English

★★ - Subscribe to our Youtube channel **@lexinmoto**, and find "G2P" Instruction videos.

Français

★★ - Suivez notre chaîne Youtube **@lexinmoto**, Et trouvez les vidéos "G2P" Instruction.

Italiano

★★ - Iscriviti al nostro canale Youtube **@lexinmoto**, e trova i video di "G2P" Instruction.

Deutsch

★★ - Abonnieren Sie unseren YouTube-Kanal **@lexinmoto** und suchen Sie das Video "G2P" Instruction.

Español

★★ - Regístrese nuestro Youtube channel **@lexinmoto**, y encuentre videos "G2P" Instruction Finden Sie das Video " G2P " Instruction.



Function Introduction

- Bluetooth 5.3
- Connect to GPS Navigation
- Siri and Other Voice Assistants
- USB-C Quick Charge
- Play Music
- Hands-free Calling
- Universal Pairing With Most Bluetooth Intercom Headset
- Support Bluetooth Six Devices Pairing for Two-ways Intercom Conference
- Two-ways Bluetooth Intercom Headset
- Conference with a Distance Up to 1.2 Kilometers
- Built-in CVC/DSP Noise Reduction

The G2P is compliant with Bluetooth Specification V5.3 supporting the following profiles: Headset Profile (HSP), Hands-Free Profile (HFP), and Advanced Audio Distribution Profile (A2DP).

It supports universal pairing with almost all Bluetooth headsets on the market.

Headset

The G2P has a high-definition 36MM stereo headset and an outstanding built-in CVC/DSP intelligent noise reduction microphone.

These designs are suitable for most open, face-off, full-face, and off-road helmets.

Battery

The G2P features an 800 mAh battery which can provide the intercom device with 18 hours of music or 13 hours of intercom conference with over one week of standby time.

WARNINGS: PLEASE CHECK ALL LOCAL LAWS AND REGULATIONS REGARDING THE USE OF IN-HELMET SPEAKERS WHILE OPERATING MOTORIZED VEHICLES.



Package Contents

- Main Unit
- Boom/Button Microphones
- Speaker Pad
- Clip Mounting Bracket
- Decorative Shells
- 3M Tape Mounting Bracket
- 36MM HD Ultra-Slim Speakers
- Boom Microphone Holder
- USB-C Cable
- Packaging
- User Manual
- Quick Start Guide

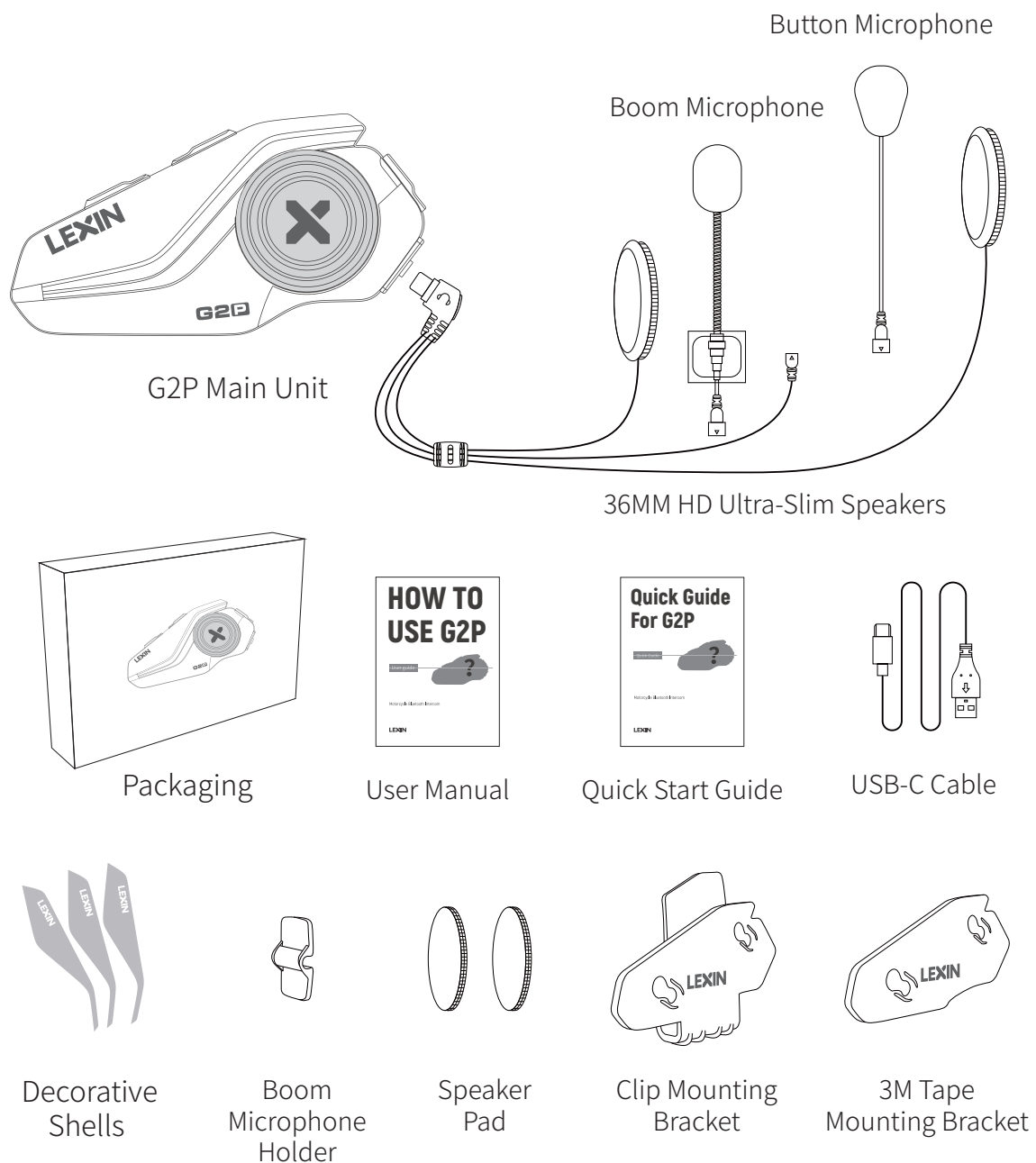

Installation Instructions

Installing Bracket for G2P to Helmet

① With Clip Mounting Bracket:

Open the clip mounting bracket and insert it into the helmet shell. (As shown on the right)

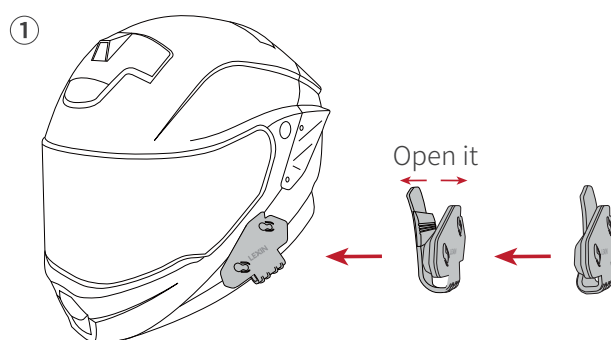

② With 3M Tape Mounting Bracket:

Except for using the clip mounting bracket, you can also use the 3M tape mounting bracket instead.

First, tear off the protective paper on the back of the 3M tape, then stick the 3M mounting bracket to a suitable position on the left side of the helmet. Press for 15 seconds to allow the glue 24 hours to dry. (As shown on the left)

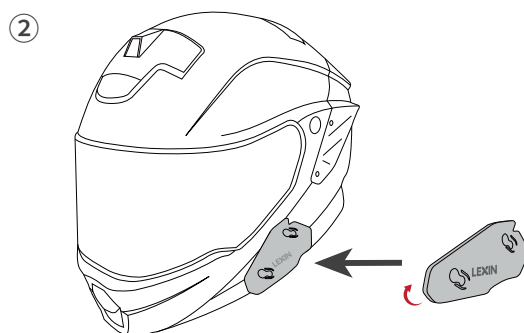

Note: Even though the 3M Tape bracket is provided for convenience, LEXIN recommends using the clip mounting bracket. The 3M Tape bracket is an option that you may use at your own risk and responsibility. LEXIN does not assume any responsibility for its use.



Mounting the G2P Main Unit

There are two square columns on the back of the G2P main unit, and there are corresponding square holes on the mounting bracket too. Align the square column on the back of the main unit with the square hole of the bracket. Slide the main unit down onto the bracket until it clicks firmly into the bottom portion of the bracket. (As shown on the right)

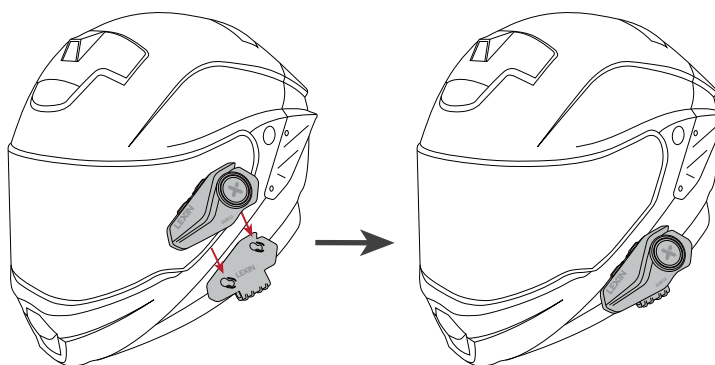

Remove the G2P Main Unit

To remove the main unit from the bracket, ensure the headset jack is not connected with the main unit, then push the main unit towards the upper left firmly until the main unit slide out from the bracket. (As shown below)

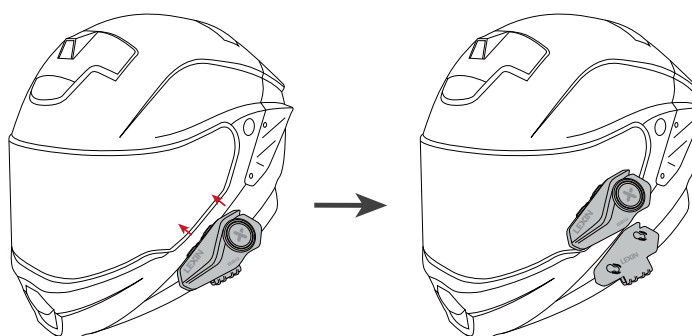

Installing Speakers

Note: The speaker with the shorter wire is for the left ear, and the speaker with the longer wire is for the right ear. This will also enhance the FM radio reception.



- Step 1: Peel off the speaker 3M tape, stick it into the helmet's inner padding.
- Step 2: Push the speakers firmly against the velcro pads. If the helmet has deep ear pockets, you can use the provided spacers to closer the speakers.
- Step 3: Hide the wires between the helmet liner and shell.(As shown below)

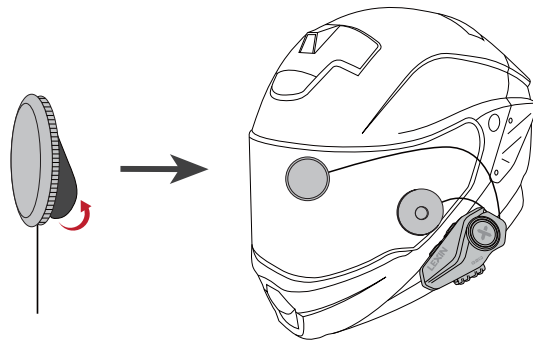

Note: We are equipped with extra speaker pads. There may be some helmets with deep speaker pockets, so you can add the extra speaker pads to increase the thickness of the speakers to make the speakers closer to your ears.

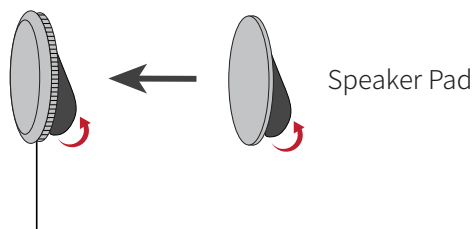

Installing Microphone

Note: The button microphone and boom microphone can be interchanged between full-face or open-face helmets. Choosing between the two is based on your preference and what fits best in the helmet(s).

Full-face Helmet/Button Microphone

- Step 1: Locate an area in the center of the mouth section of the helmet to install and adhere half of the microphone velcro pad.
- Step 2: Attach the button microphone to the attached velcro.
- Step 3: Connect it to the headphone connector from the left.

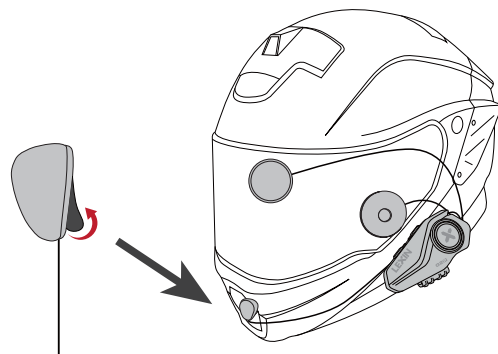



Open Face Helmet/Boom Microphone

Step 1: Adhere one half of the velcro pad to the base of the microphone and the other half to the inside of the helmet underpadding.

Step 2: Adjust the microphone's direction so that the triangular mark points towards your mouth.

Step 3: Use the boom microphone holder for additional support to the microphone if necessary. (As shown on the right)

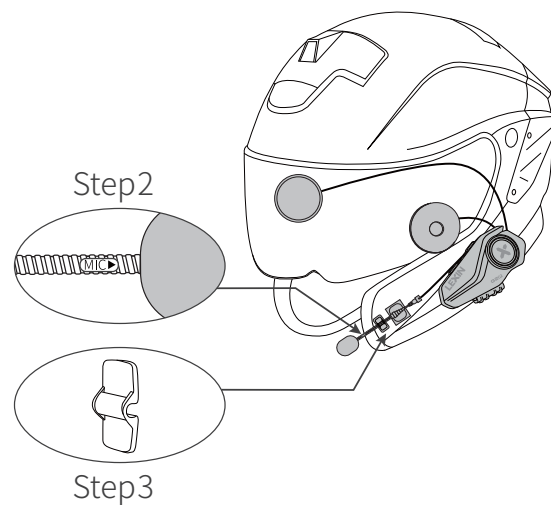

Replace the pattern shell

Step 1: Remove the old pattern shell from the unit (There is a small gap on the left of the pattern shell, please use a thin object to pry up the pattern shell from the unit.);

Step 2: Chose one new pattern shell, then align the shell with the main unit and press it until they fit perfectly.

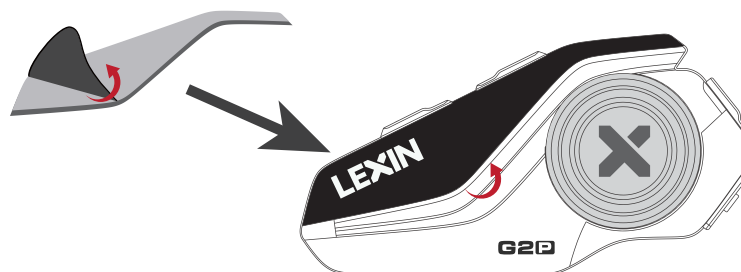



Basic Operation

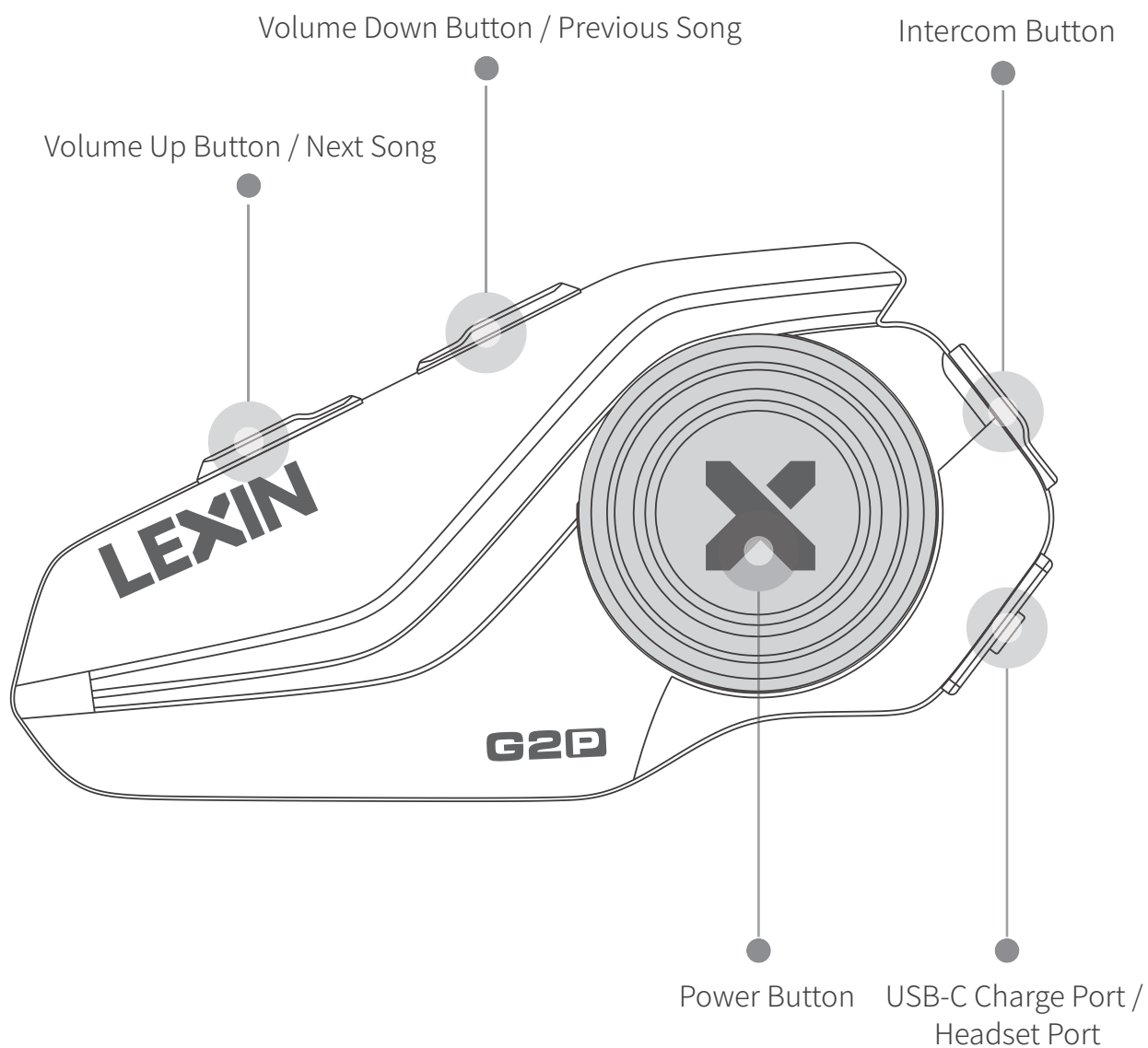

Power On/Off

Power On: Press and hold the Power Button for 2 seconds. Voice prompt "Power On" and the current battery life.

Power Off: Press and hold the Power Button for 2 seconds with voice prompt "Power Off".



Battery Charging

Plug the USB-C cable into the USB-C port to charge by any DC 5V power supply, such as mobile phone charger, computer, laptop or power bank, etc. The LED turns red while charging and then turns blue when the main unit is fully charged. It takes about 2.5 hours to charge entirely.

Battery Life Prompt: While in standby mode, press and hold the Volume Down Button for about 7 seconds, it will report "pairing" during this period, please do not release the button until the G2P device report the current battery life.

It will prompt one of five levels: 100%, 80%, 50%, 25%, LOW.

Note: While the battery capacity is below 25%, the device will notify you every 15 minutes, it indicates that the device still can work 1-1.5h around, it will turn off after running out of battery.

Pairing G2P with Bluetooth Devices

Note: A single G2P can connect with up to two Bluetooth devices(eg: two mobile phones or one mobile phone and one other Bluetooth device). It can automatically connect to your last paired device as long as Bluetooth is enabled or in standby mode without being connected with any devices. And you can click the power button to reconnect the last paired device manually as well.

Pairing Mobile Phone

Step 1: With the unit powered off, press and hold the Power Button for 5 seconds until the led flashes red and blue alternately, the device will prompt "pairing" to enter pairing mode.

Step 2: Go to Bluetooth settings on your phone, select "LEXIN G2P". Some mobile phones may need a PIN, enter "0000" for the PIN if required.

Step 3: Please confirm on your phone if the pairing is complete.

Note: The LED will blink blue and voice prompt "Pairing successful", indicating the connection is complete.

Reconnect to the Last Paired Phone

The G2P will automatically reconnect to the last paired phone by default, or in standby mode, we can click the power button to reconnect to the last phone manually as well. After pairing is complete, click the power button if the device is disconnected from the phone.



Pairing Bluetooth GPS Navigation

Step 1: While powered off, press and hold the Power Button for about 5 seconds until the LED light flashes blue and red alternately, the device will prompt "pairing" to enter pairing mode. The indicator light will blink blue once pairing complete, and the voice prompt "pairing successful."

Step 2: Follow pairing instructions for your specific GPS Navigation to connect to G2P.

Note: You will be able to listen to the sound of GPS navigation once paired.

Clear Bluetooth Pairing History: When the G2P main unit is in the standby mode, press and hold the Up Button for about 7 seconds to clear all the pairing history.

Phone Calls

Answer Phone Call: Click the Power Button to answer an incoming phone call.

End Call: Click the Power Button to end the call.

Reject Phone Call: Double-click the Power Button to reject the incoming phone call.

Answer The Second Call: When the phone is in a call, a second call comes in, double-click the Intercom Button to answer.

Reject The Second Call: When the phone is in a call, a second call comes in, double-click the Volume Up Button to reject.

Voice Dial: While the device is paired with your phone, double-click the Power Button to activate Siri or other voice assistants. Speak the name from your phone list to dial.

Music And Volume Control

Volume Control

Click the Up/Down Button to adjust the volume, the voice will prompt when it comes to maximum or minimum volume.

Play/Pause

Click the Power Button to play a song with the unit power on.

Click the Power Button to pause when the music is playing.

Change Song

Double-click the Up Button to switch to the next song, double-click the Down Button to switch to the previous song.

Note: When you are listening to audios from the phone, you will need to also adjust the volume on your phone to get louder volume.



FM Radio On/Off

Turn On FM Radio: Press the Volume Up and Down Button at the same time for about 1 second to enter radio function.

Turn Off FM Radio: Press the Volume Up and Down Button at the same time for about 1 second to end radio function.

FM Radio Station Searching: Double click the Volume Up or Down Button to adjust the radio station.

Bluetooth Pairing

G2P Bluetooth headsets pairing group intercom, which can realize up to 6 devices connecting for two-ways intercom. One G2P device can pair with up to five other G2P devices at the same time, once paired, we can switch between any two devices for intercom.

Two-way Bluetooth Pairing

Note: We strongly recommend to clear the existing established Bluetooth connected devices before pairing. The operation is as follows, please press and hold the Volume Up Button for about 7 seconds in the standby state, note that the prompt sound "pairing" will appear during this period, please do not release the button until the LED flashes red quickly, which indicates all previous pairing history has been cleared.

In standby mode, press and hold the Intercom Button for 2 seconds on both unit 1 and unit 2 until the led quick flashes red and blue, voice prompt "pairing". The two devices will be connected automatically after few seconds. After the pairing is completed, the indicator of both devices flash blue slowly, and the voice prompts "pairing successful".

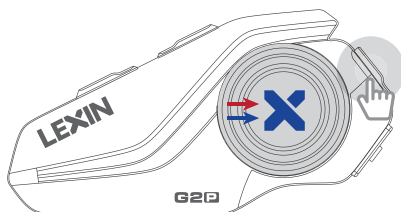

Press and hold the Intercom Button for about 2 seconds until the led quick flashes red and blue
(Unit One)

Pairing
..........

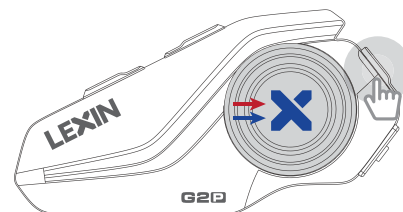

Press and hold the Intercom Button for about 2 seconds until the led quick flashes red and blue
(Unit Two)

The LED light will flash blue slowly on both units once paired successful.



Activate Two-ways Intercom Talk

After the two G2P devices were paired, click the Intercom Button on unit 1 to start intercom talk with unit 2. The indicator light flashes purple.

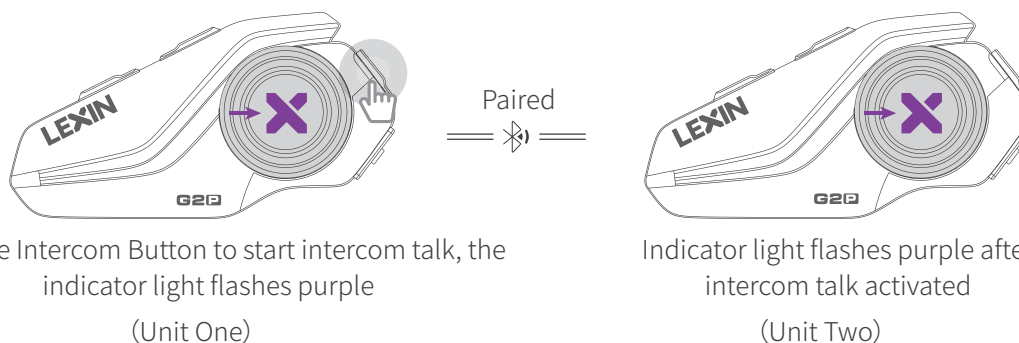

Exit Intercom Talk: Click the Power Button to exit the intercom talk, click the intercom button again to initiate intercom talk.

Note: Double click the Up or Down Button to exit Bluetooth pairing mode, the device will return to standby mode.

Universal Pairing with Different LEXIN Device

G2P support universal pairing, it can connect with one another model of LEXIN device to realize a two-ways Bluetooth Intercom Headset talk.

Function Priority: (The G2P operates in the following order of priority)

1. Mobile phone
2. Intercom Talk
3. Music/FM/GPS

Note: A lower-priority function is always interrupted by a higher-priority function. For example, stereo music can be interrupted by an intercom call, intercom talk can be interrupted by an incoming phone call.

The G2P can pair with other LEXIN models of intercom devices, and the operation steps are almost the same, such as the following LEXIN models: LEXIN B4FM/LEXIN G16/LEXIN MTX/LEXIN G2P/LEXIN NOVUS X2 , here we take LEXIN B4FM for example:



Both units are in standby mode, press and hold the Intercom Button for 2 seconds on both devices until the led quickly flashes red and blue, voice prompt "pairing".

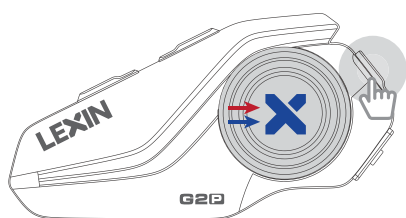

Pairing
.....

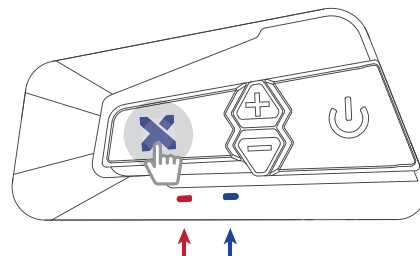

Press and hold the Intercom Button for 2 seconds until the led quick flashes red and blue

Press and hold the Intercom Button for 2 seconds until the led quick flashes red and blue

The two devices will paired automatically, after pairing successful, the indicator lights of both will flash blue slowly, voice prompts "pairing successful".

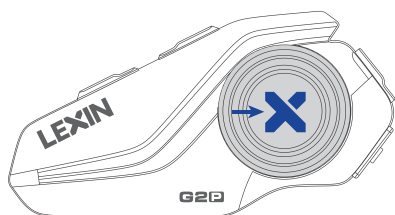

Paired
== ==

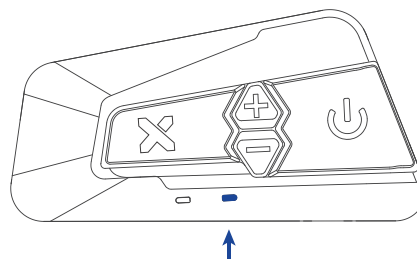

Indicator light flash blue slowly

Indicator light flash blue slowly

Start The Intercom Talk: Once the pairing is successful, click the Intercom Button on either device to start intercom, the LED light on G2P will blink purple and on B4FM will blink blue and red.



Start Intercom Talk
== ==

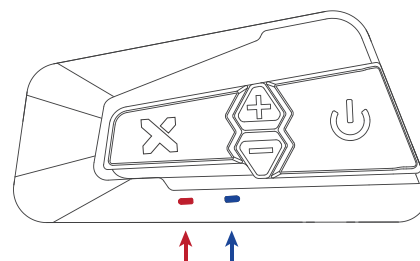

LED flash purple (G2P)

LED flash red and blue (B4FM)



End The Intercom Talk: Click the Power Button on either unit to make the device temporarily disconnect the current intercom. The light will flash blue.

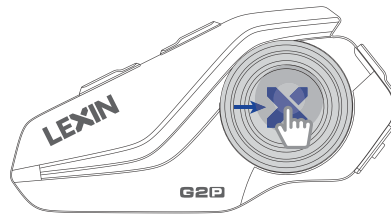

Click the Power Button, LED return to flash blue

Note: If you need to pair G2P with ET COM, please refer to the following universal pairing instruction.

Universal Pairing

Pair With Another Bluetooth Intercom Headset Outside LEXIN

Step 1: With the unit powered on, press and hold the G2P intercom for 2 seconds, the indicator light flashes blue and red alternately, voice prompts "pairing".

Step 2: Follow the pairing instructions of your other Bluetooth device to enter pairing mode, then G2P will complete the pairing automatically.

Step 3: After the pairing is complete, the led light flashes blue, and the voice prompts "pairing successful".

Step 4: Click the Volume Up and Down Button together to start the intercom talk. The led light will flash purple.

Step 5: During intercom conversation, click the Power Button to end the intercom talk.

Pairing 6 G2P Devices

G2P Bluetooth headsets pairing group intercom, which can connect up to 6 devices for two-ways intercom at the same time. One G2P device can pair with up to five other G2P devices, once paired, we can switch between any two devices of the six for intercom talk.



Note:

1. We strongly recommend to clear out the existing established Bluetooth connected devices before pairing. The operation is as follows, please press and hold the Volume Up Button for about 7 seconds in the standby state, note that the prompt sound "pairing" will appear during this period, please do not release the button until the LED flashes red quickly, which indicates all previous pairing history has been cleared.
2. In order to avoid confusion between the devices, it's recommend to identify the device a name before pairing. For example, in the following operation instructions, we mark the devices as Unit One to Unit Six.

Channel A Pairing: In standby mode, press and hold the Intercom Button for 2 seconds on both unit 1 and unit 2 until the led quick flashes red and blue and voice prompt "pairing". The two devices will be connected automatically after few seconds. After the pairing is completed, the indicator of both devices flash blue slowly, and the voice prompts "pairing successful".

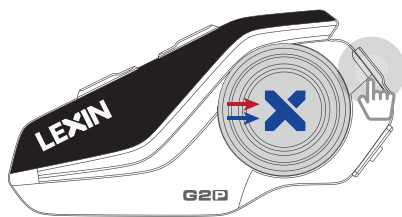

Press and hold the Intercom Button for about two seconds until the LED quick flashes red and blue

(Unit One)

Pairing
..........

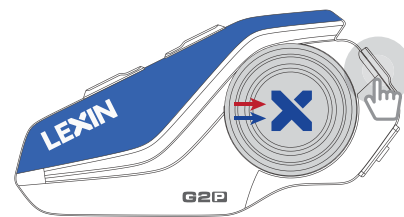

Press and hold the Intercom Button for about two seconds until the LED quick flashes red and blue

(Unit Two)

The LED light will flash blue slowly on both units once paired successful.

Start Intercom Talk under Channel A:

Once the pairing is successful, click the Intercom Button on Unit 1 to start an intercom conference with the device under Channel A (Unit 2). When in intercom mode, the LED light of both connected units will blink purple.

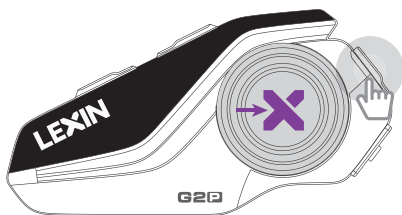

Click the Intercom Button to start intercom talk, the indicator light flashes purple

(Unit One)

Paired
====

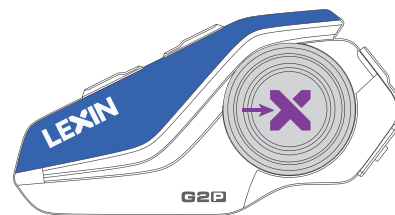

Indicator light flashes purple after intercom talk activated

(Unit Two)



Answer The Second Intercom Talk: Double click the Power Button to answer a second intercom talk if there is another rider initiate an intercom invitation to you.

End The Intercom Talk: Click the Power Button on either unit to make the device temporarily disconnect the current intercom.

Note: Double click the Up or Down Button to exit Bluetooth pairing mode, the device will return to standby mode.

Channel B Pairing: In standby mode, press and hold the Volume Up Button for 2 seconds on both devices until the led quickly flashes red and blue and voice prompt "pairing". The two devices will be connected automatically after few seconds. After the pairing is completed, the indicator of both devices flash blue slowly, and the voice prompts "pairing successful".



Press and hold the Volume Up Button for about two seconds until the LED quick flashes red and blue

(Unit One)

Press and hold the Volume Up Button for about two seconds until the LED quick flashes red and blue

(Unit Three)

The LED light will flash blue slowly on both units once paired successful.

Start The Intercom Talk Under Channel B:

Once the pairing is successful, double click the Intercom Button on the Unit 1 to start an intercom conference with the device under Channel B(Unit 3). When in intercom mode, the LED light of both connected units will blink purple.



Double-click the Intercom Button until LED flash blink purple

(Unit One)

Wait until the LED flashes blink purple

(Unit Three)

When in intercom mode, the LED light of both connected units will blink purple.



Answer The Second Intercom: Double click the Power Button to answer a second intercom talk if there is another rider initiate an intercom invitation to you.

End The Intercom Talk: Click the Power Button on either unit to make the device temporarily disconnect the current intercom.

Note: Double click the Up or Down Button to exit Bluetooth pairing mode, the device will return to standby mode.

Pair Channel C: In standby mode, press and hold the Intercom Button and the Volume Up Button for 2 seconds on both devices until the led quickly flashes red and blue and voice prompt "pairing". After the pairing is completed, the indicator of both devices flash blue slowly, and the voice prompts "pairing successful".

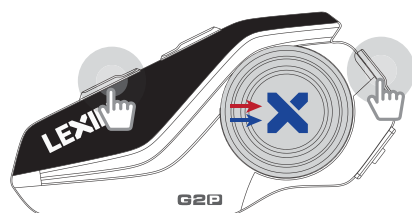

Press and hold the Intercom Button and Volume Up Button for about two seconds until the LED quick flashes red and blue

(Unit One)

Pairing
..........

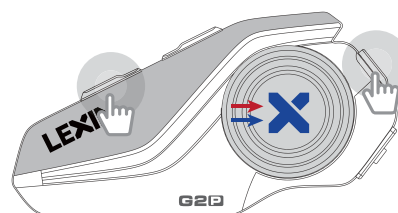

Press and hold the Intercom Button and Volume Up Button for about two seconds until the LED quick flashes red and blue

(Unit Four)

The LED light will flash blue slowly on both units once paired successful.

Start The Intercom Talk Under Channel C:

Once the pairing is successful, triple-click the Intercom Button on the Unit 1 to start an intercom conference with the device under Channel C (Unit 4). When in intercom mode, the LED light of both connected units will blink purple.

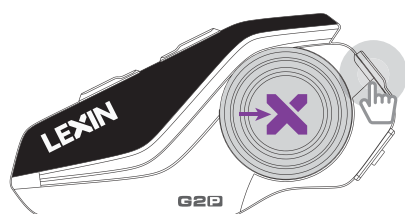

Triple-click the Intercom Button to start intercom talk, the indicator light flashes purple

(Unit One)

Paired
====

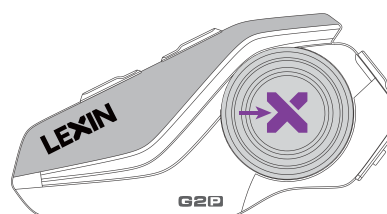

Wait for few seconds, indicator light flashes purple after intercom talk activated

(Unit Four)



Answer The Second Intercom: Double click the Power Button to answer a second intercom talk if there is another rider initiate an intercom invitation to you.

End The Intercom Talk: Click the Power Button on either unit to make the device temporarily disconnect the current intercom.

Note: Double click the Up or Down Button to exit Bluetooth pairing mode, the device will return to standby mode.

Pair Channel D: In standby mode, press and hold the Volume Down Button for 2 seconds on both devices until the led quickly flashes red and blue and voice prompt "pairing". After the pairing is completed, the indicator of both devices flash blue slowly, and the voice prompts "pairing successful".

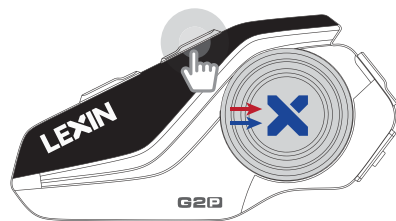

Click the Intercom Button four times to start intercom talk, the indicator light flashes purple

(Unit One)

Pairing
----- ❧ -----

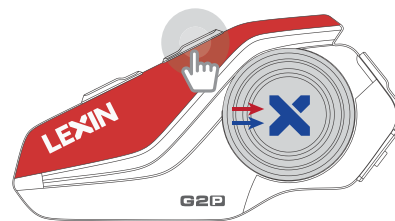

Wait for few seconds, indicator light flashes purple after intercom talk activated

(Unit Five)

The LED light will flash blue slowly on both units once paired successful.

Start The Intercom Talk Under Channel D:

Once the pairing is successful, click the Intercom Button on Unit 1 for four times to start an intercom conference with the device under Channel D(Unit 5). When in intercom mode, the LED light of both connected units will blink purple.

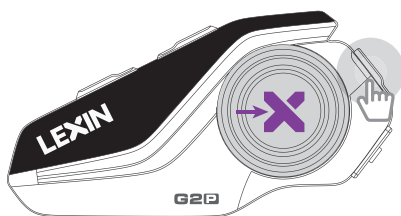

Click the Intercom Button for four times until LED flash blink purple

(Unit One)

Paired
===== ❧ =====

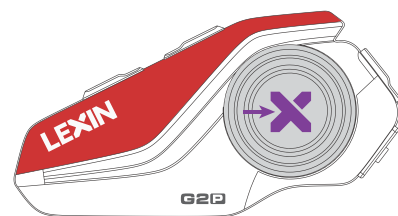

Wait until the LED flashes blink purple
(Unit Five)

When in intercom mode, the LED light of both connected units will blink purple.



Answer The Second Intercom: Double click the Power Button to answer a second intercom talk if there is another rider initiate an intercom invitation to you.

End The Intercom Talk: Click the Power Button on either unit to make the device temporarily disconnect the current intercom.

Note: Double click the Up or Down Button to exit Bluetooth pairing mode, the device will return to standby mode.

Pair Channel E: In standby mode, press and hold the Intercom Button and the Volume Down button for two seconds on both devices until the led quickly flashes red and blue and voice prompt "pairing". After the pairing is completed, the indicator of both devices flash blue slowly, and the voice prompts "pairing successful".

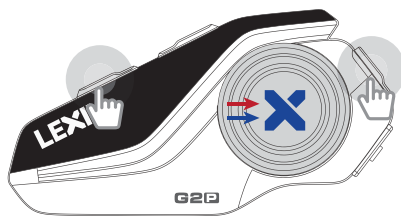

Press and hold the Intercom Button and Volume Down Button for about two seconds until the LED quick flashes red and blue
(Unit One)

Pairing
..........

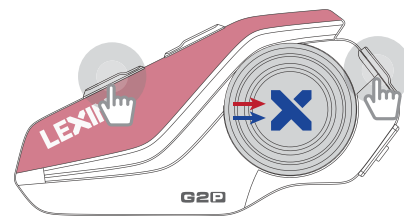

Press and hold the Intercom Button and Volume Up Button for about two seconds until the LED quick flashes red and blue
(Unit Six)

The LED light will flash blue slowly on both units once paired successful.

Start The Intercom Talk Under Channel E:

Once the pairing is successful, click the Intercom Button on the Unit 1 for five times to start an intercom conference with the device under Channel E (Unit 6). When in intercom mode, the LED light of both connected units will blink purple.



Click the Intercom Button five times to start intercom talk, the indicator light flashes purple

(Unit One)

Paired
==========

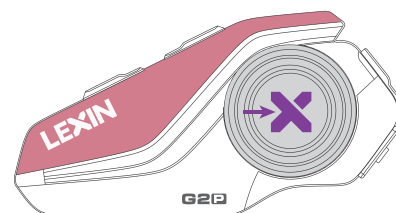

Wait for few seconds, indicator light flashes purple after intercom talk activated

(Unit Six)



Answer The Second Intercom: Double click the Power Button to answer a second intercom talk if there is another rider initiate an intercom invitation to you.

End The Intercom Talk: Click the Power Button on either unit to make the device temporarily disconnect the current intercom.

Note: Double click the Up or Down Button to exit Bluetooth pairing mode, the device will return to standby mode.

The pairing of unit 1 with other 5 units is complete when the above steps are done, we still need to cross-pair the remaining 2-6 units in order to establish a Bluetooth connection between any two of them. Please refer to the table for pairing the remaining devices.

There are five intercom channel settings which are A, B, C, D, E for Bluetooth six-way pairing. Please refer to the table to cross- pair the remaining devices. For example, when pair Unit 2 with Unit 3, please use the Channel C setting method to pair this two devices.

In order to avoid confusion between the devices, it's recommend to identify the device a serial number before pairing. For example, in the following operation instructions, we mark the devices as Unit 1 to Unit 6.

Pairing Method	Unit 1	Unit 2	Unit 3	Unit 4	Unit 5	Unit 6
Unit 1		A	B	C	D	E
Unit 2			C	D	E	B
Unit 3				E	A	D
Unit 4					B	A
Unit 5						C
Unit 6						

In the table, A, B, C, D and E are the five channel intercom settings. Please refer to the simple summery description below for the operation steps. Once all devices are cross paired with each other, all devices will be connected with each other.

Pairing Channel A: In standby mode, press and hold the Intercom Button for 2 seconds on the needed G2P device to pair.



Pairing Channel B: In standby mode, press and hold the Volume Up button for 2 seconds on needed G2P to pair.

Pairing Channel C: In standby mode, press and hold the Intercom Button and the Volume Up Button for 2 seconds at the same time on needed G2P to pair.

Pairing Channel D: In standby mode, press and hold the Volume Down Button for 2 seconds on needed G2P to pair.

Pairing Channel E: In standby mode, press and hold the Intercom Button and the Volume Down Button for 2 seconds on needed G2P to pair.

Note: For detailed operation and LED light indication, please refer to the pairing method of each channel.

Initiate the Intercom Talk of Channel A: After the two G2P devices are paired, click the intercom button to call the device under Channel A.

Initiate the Intercom Talk of Channel B: After the two G2P devices are paired, double-click the intercom button to call the device under Channel B.

Initiate the Intercom Talk of Channel C: After the two G2P devices are paired, press the intercom button three times to call the device under Channel C.

Initiate the Intercom Talk of Channel D: After the two G2P devices are paired, press the intercom button four times to call the device under Channel D.

Initiate the Intercom Talk of Channel E: After the two G2P devices are paired, press the intercom button five times to call the device under Channel E.

Note: For detailed operation and LED light indication, please refer to the pairing method of each channel.

Answer The Second Intercom:

Double click the Power Button to answer a second intercom talk if there is another rider initiate an intercom invitation to you.

End The Intercom Talk: Click the Power Button on either unit to make the device temporarily disconnect the current intercom.



Warning

NOTE: This equipment has been tested and found to comply with the limits for a Class B digital device, pursuant to part 15 of the FCC Rules. These limits are designed to provide reasonable protection against harmful interference in a residential installation. This equipment generates, uses and can radiate radio frequency energy and, if not installed and used in accordance with the instructions, may cause harmful interference to radio communications. However, there is no guarantee that interference will not occur in a particular installation. If this equipment does cause harmful interference to radio or television reception, which can be determined by turning the equipment off and on, the user is encouraged to try to correct the interference by one or more of the following measures:

- Reorient or relocate the receiving antenna.
- Increase the separation between the equipment and receiver.
- Connect the equipment into an outlet on a circuit different from that to which the receiver is connected.
- Consult the dealer or an experienced radio/TV technician for help

Changes or modifications not expressly approved by the party responsible for compliance could void the user's authority to operate the equipment.

This device complies with Part 15 of the FCC Rules. Operation is subject to the following two conditions:

(1) this device may not cause harmful interference, and (2) this device must accept any interference received, including interference that may cause undesired operation.



This device contains licence-exempt transmitter(s)/receiver(s) that comply with Innovation, Science and Economic Development Canada's licence-exempt RSS(s). Operation is subject to the following two conditions:

- (1) This device may not cause interference.
- (2) This device must accept any interference, including interference that may cause undesired operation of the device.

L' émetteur/récepteur exempt de licence contenu dans le présent appareil est conforme aux CNR d' Innovation, Sciences et Développement économique Canada applicables aux appareils radio exempts de licence. L' exploitation est autorisée aux deux conditions suivantes :

- (1) L' appareil ne doit pas produire de brouillage;
- (2) L' appareil doit accepter tout brouillage radioélectrique subi, même si le brouillage est susceptible d' en compromettre le fonctionnement.

Lexin Electronics Inc.
1(800) 380 - 8248
www.lexin-moto.com

Backed by 2-Year Warranty
For technical support :
tech@lexinmotorcycle.com



@lexinmoto