



# AXTIVE MINI

WIRELESS SPEAKER

BY MIIEGO



## Quick Start Guide

ENG	1 - 2	SE	7 - 8
DK	3 - 4	DE	9 - 10
NOR	5 - 6		

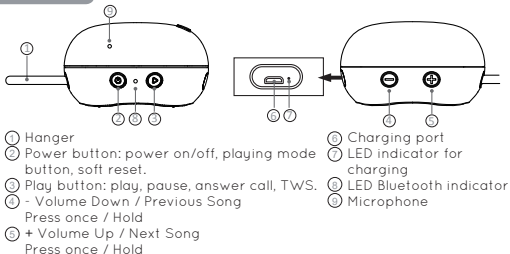

## SPECIFICATIONS

Bluetooth v5.0 - Wireless transmission range up to 10-15 m. without obstacles. Rechargeable 800 mAh Li-ion battery. Full charging time: around 2.5 hours. IPX5. BT frequency range: 2402-2480MHz. Freq. Response: 90Hz-20 KHz. Charging input power: 5V DC/1A. RMS audio output: 3W. Impedance: 4Ω.

## CARE, MAINTENANCE, SAFETY

Any modification of the product may have consequences for safety, warranty and proper functioning. Keep out of reach for children and animals. Product storage and working temperature: from -10 celsius degrees to +40. Do not expose the product to direct sunlight, heat or naked flames as it may cause damage or explosion. Do not use the product if a part is damaged or defective. Replace a damaged or defective device immediately. Disconnect the product from the electrical outlet and other equipment if problems occur. Do not charge when the product is wet. Do not leave a battery on prolonged charge when not in use. Do not dismantle, open or shred batteries. Do not drop the product and avoid bumping. This product may only be serviced by a qualified technician for maintenance to reduce the risk of electric shock etc.



This device contains a lithium accumulator.  
Improper use can cause overheating and fire.



### **Pairing your AXTIVE MIINI MIEGO® Bluetooth speaker**

- 1: Make sure the speaker is charged and turned OFF.
  - 2: Press and hold the  button for 3 seconds until the indicator light flashes WHITE (pairing mode).
  - 3: Activate Bluetooth on your phone or other device and search for new Bluetooth device and select: **MIEGO AXTIVE MIINI**.
- When AXTIVE MIINI is connected the WHITE LED light is constantly on. The speaker will remember your phone/device and automatically reconnect the next time you turn it on. An unpaired speaker will automatically turn off after 6 minutes.

### **Charging the AXTIVE MIINI speaker**

- Use a 5V/1A USB adapter for charging.
- During charging the red light is on. When fully charged the red light is off.
- Full charging time is around 2.5 hours with 1A.

### **Next time charging**

When you hear a warning tone every 180 seconds, the battery status is low and needs charging.

### **Turning Your AXTIVE MIINI On and Off**

ON: Press the  Button for 3 seconds until a tone is heard.

OFF: Press the  Button until a tone is heard.

**Activate Siri on iOS-device:** Double press the PLAY button (works only in Bluetooth mode).

### **Pairing and connecting 2 x AXTIVE MIINI speakers with TWS**

TWS only works when connecting two AXTIVE MIINIs by MIEGO® together.

- 1: Turn on both speakers (Bluetooth mode). Make sure they are unconnected.
- 2: Press and hold the PLAY button on one speaker for 2 seconds. The product emits a tone to indicate entering TWS-pairing mode.
- 3: The product emits three tones and the LED indicator light (8) will be constantly on. This is then the slave speaker. LED indicator light on master speaker will flash to indicate successful TWS-pairing.
- 4: Activate Bluetooth on your phone/device and connect with the master speaker.



To prevent possible hearing damage, do not listen at high volume levels for long periods. Please respect your surroundings, neighbours, and local laws and regulations.



Model No.: AXTIVE MIINI  
Designed in Denmark.  
Produced in China.

Milego A/S  
Lejrvejen 4  
6330 Padborg  
Denmark  
tel: +45 70 277 887  
e-mail: support@milego.com

[www.MIEGO.com](http://www.MIEGO.com)

**FCC STATEMENT :**

This device complies with Part 15 of the FCC Rules. Operation is subject to the following two conditions:

- (1) This device may not cause harmful interference, and
- (2) This device must accept any interference received, including interference that may cause undesired operation.

**Warning:** Changes or modifications not expressly approved by the party responsible for compliance could void the user's authority to operate the equipment.

NOTE: This equipment has been tested and found to comply with the limits for a Class B digital device, pursuant to Part 15 of the FCC Rules. These limits are designed to provide reasonable protection against harmful interference in a residential installation. This equipment generates uses and can radiate radio frequency energy and, if not installed and used in accordance with the instructions, may cause harmful interference to radio communications. However, there is no guarantee that interference will not occur in a particular installation. If this equipment does cause harmful interference to radio or television reception, which can be determined by turning the equipment off and on, the user is encouraged to try to correct the interference by one or more of the following measures:

- Reorient or relocate the receiving antenna.
- Increase the separation between the equipment and receiver.
- Connect the equipment into an outlet on a circuit different from that to which the receiver is connected.
- Consult the dealer or an experienced radio/TV technician for help.

**RF warning statement:**

The device has been evaluated to meet general RF exposure requirement. The device can be used in portable exposure condition without restriction.