

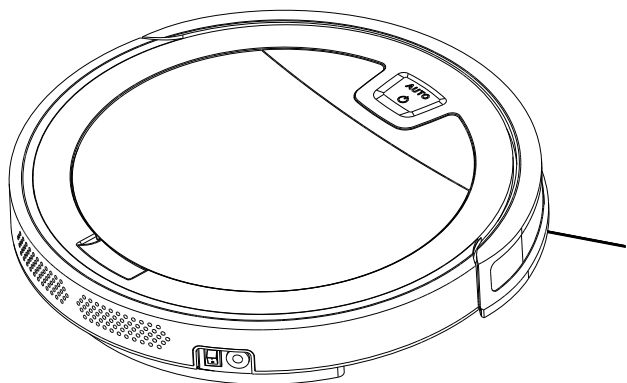

Dust expert near you

---

## Klinsmann KRV310 User Manual



Thanks for your purchasing

---

Please read this manual carefully before using

# Content







<b>1.Security Specifications</b>	2
<b>2.Product Formation</b>	3
2.1 Part Name	3
2.2 Structural Introduce	3
2.3 Technical Parameters	4
<b>3.Product usage</b>	5
3.1 Attention	5
3.2 Quick Actions	5
3.3 APP Usage	6
3.4 Mode Selection	7
3.5 Set up Appointment	7
3.6 Mop Function	7
3.7 Remote Controller Usage	8
3.8 Usage Of Side brush	9
<b>4.Maintenance</b>	10
4.1 Dust Box&Filter Material	10
4.2 Cleaning Cloth	10
4.3 Suction Inlet & Side Brush	10
4.4 Other Parts	11
<b>5.Malfunction Elimination</b>	12









# 1.Security Specifications

The safety specification is intended to prevent users' personal or property damage, Please read the following notes carefully.

The following symbols represent the following meanings:

 <b>Warning</b>	Violation of safety instructions will lead to personal injury	 <b>Attention</b>	Violation of safety instructions may result in minor personal injury or product damage
--	---	--	--

 <b>Warning</b>			
Except the maintenance technician, no one can disassembly repair or modify the product, otherwise it may catch fire or electric shock		Please do not use other adapters, otherwise it may cause damage fire or electric shock	
Do not touch the charge with wet hand when charging, otherwise it may cause damage or electric shock		Do not overbend the power cord of the adapter or place heavy objects on it, otherwise it may damage the power cord, causing a fire or electric shock	
Do not let clothes or baby parts (hair fingers etc.) get involved in machine hair brush or wheel, can cause damage to machine and personal injury		Do not get close to lights, matches or other heat sources and explosive goods. Do not flush the machine, otherwise it may damage the machine and cause fire	

 <b>Attention</b>			
Turn off the power when transport or long placement of machines		The adapter need connected to the socket, machine and adapter plug when the machine is charged	
Please do not allow children to use the machine; Do not use machine in baby house; The machine should be in places where children cannot touch		Do not place the machine on high place, in order to avoid damage	
Do not stand or seat in the machine. Do not put heavy object in the machine		Please do not use the machine in small space; Move the vulnerable goods before using (Luminous objects, fabrics, glass products, etc)	
Outdoor use is prohibited to prevent mechanical failure		Do not use in a commercial space, otherwise the machine may be damaged by overuse	

# 2.Product Formation

## 2.1 Part Name

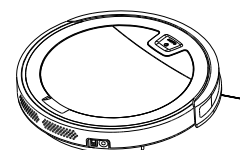

Main Body

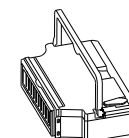

Dust Box (Water tank)



Recharge Dock



Adapter



Remote Controller



Cleaning Cloth



Manual

## 2.2 Structural Introduce

### ● Main Body

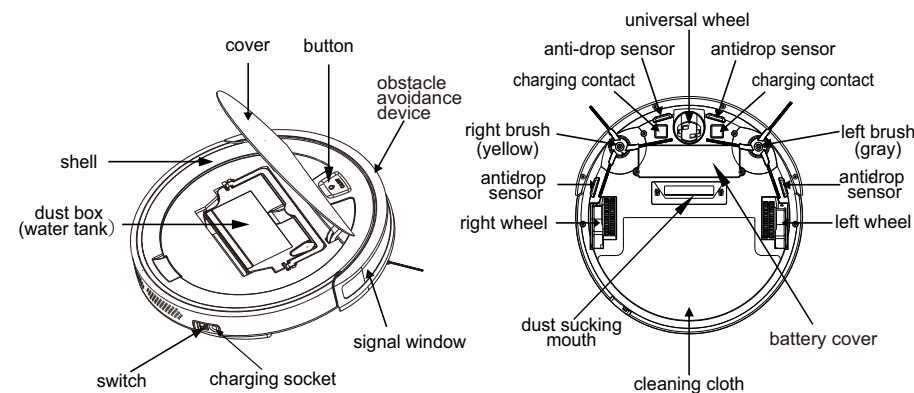

## ●Dust Box(water tank)

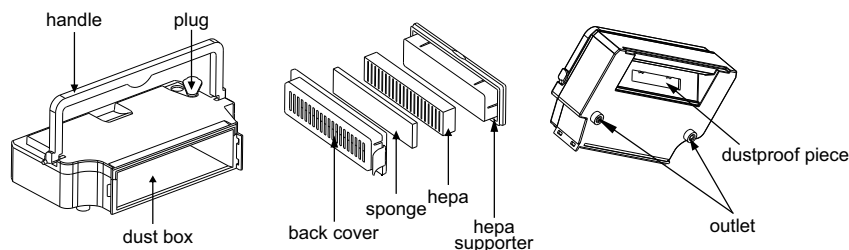

## ●Charging Dock

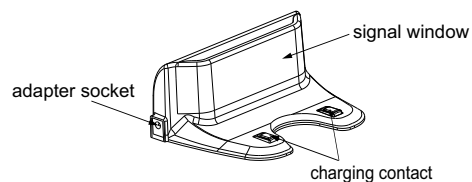

## 2.3 Technical Parameters

Model	KRV310		
Working voltage(V)	14. 8	Rated input voltage (V)	19.0
Rated power (W)	20	Rated input current (A)	0.6
Recharge dock	KCH217		
input parameter	19V ===0. 6A		
output parameter	19V ===0. 6A		
Battery	Li-ion 2000mAh		

★Due to continuous improvement of the product,if any technology or design change is required, no further notice will be informed

## 3.Product usage

### 3.1 Attention

1. Please remove the power cord, thread and other debris scattered on the ground before using, avoid to trip or wind the machine
2. Objects with less than 6CM such as bed furniture bottom may cause stuck when using,please pay special attention to such areas when cleaning.
3. Before using this product on the carpet, please remove the two sides brushes and roll the carpet's tassels.
4. This product can be used on wood floor, tile floor and cement floor and short hair carpet (less than 1CM).

### 3.2 Quick Actions

#### 1 Main body charge (The machine has both manual and automatic charging modes)

##### ① Manual Charging

Charge the power adapter at one end and the main body;Connect the socket and connect the other end to the power blue light flashing with charging music Successful charging connection. Light flashing, the machine charging; Light long bright,charging completed.

Please keep charging the machine for at least 8h the first time;Before charging, make sure the water tank empty,otherwise the floor will be wet.

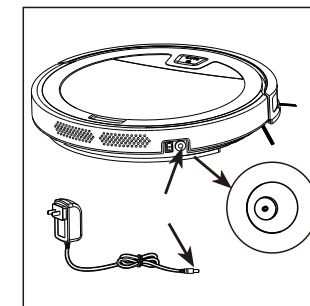

##### ② Auto-recharging

- Place the charging dock flat against the wall about 0.5m and the front 1.5m without placing objects,and cannot have a strong reflecting surface such as mirrors.
- Connect the power adapter to the power supply and connect to the charging dock
- When the battery is low,the machine will automatically look fou the charging dock and charging itself

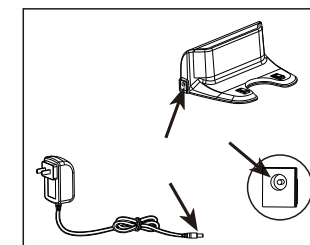

Users can also control the machine to find a charging dock by using the automatic charging function on the APP and remoto control

## 2 Turn on the machine

Turn on the machine side power switch,  
The button with blue light and always bright  
with music means successful opening.  
(“I” power on, “O” power off)

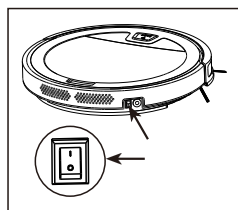

## 3 Start cleaning

Short press , start with auto  
cleaning mode

## 4 Stop working

Short press  one time, the machine  
will stop, press  again, the machine  
working again

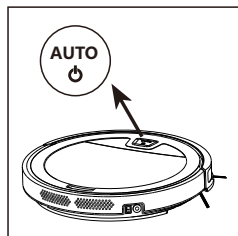

## 5 Turn off

After wtop working, turn off the  
machine power switch, power off  
finished

If the machine break off for a  
long time, please ensure there  
is no water in tank, otherwise  
the floor will be wet.

## 3.3 APP Usage

### 1 APP download

Scan the qr code, download and  
install the product APP,  
more functions, please reference the  
APP interface.



### 2 Machine WIFI Setting

Turn on the machine and press  about  
5 seconds (or use remote controller  
WIFI button), voice prompts enter WIFI  
Setting. After the machine enter WIFI  
setting, add device to the APP  
interface and connect the WIFI distribution network.

**Notice:**

- 1、When connect the APP sucessfully, no need to connect again, it need to be restarted when the wifi changed
- 2、This product supports remote control of mobile phone APP
- 3、The APP supports android and IOS users

## 3.4 Mode Selection

In order to adapt to different ground conditions and realize deep cleaning, this product has a variety of cleaning modes, the APP and remote control are used to select users, and users can also use the APP and remote control to help machine get out of stuck situation

### 1 Auto Cleaning

Machine plans full coverage cleaning

### 2 Edge Cleaning

Machine along the object edge cleaning (such as wall edge)  
especially clean in the corner of the house

### 3 Spot Cleaning (Once cleaning is complete, the machine will stop at the beginning)

Focus on specific areas, cleaning more thorough,  
it is recommended use in the living room or other area  
with less obstacles

### 4 Powerful Cleaning

With increased suction, cleaning more thoroughly.

### 5 Return to charging

Find recharge dock when the power is lower

## 3.5 Set up Appointment

For the convenience of cleaning, the product has an appointment function, and users can make an appointment to clean the time and cleaning mode on the mobile APP.

## 3.6 Mop Function

The machine has the function of mop, the design of dust box and water tank is adopted, the cloth will be attached to the bottom of the machine when using, and water will be added to the water tank of the dust box.

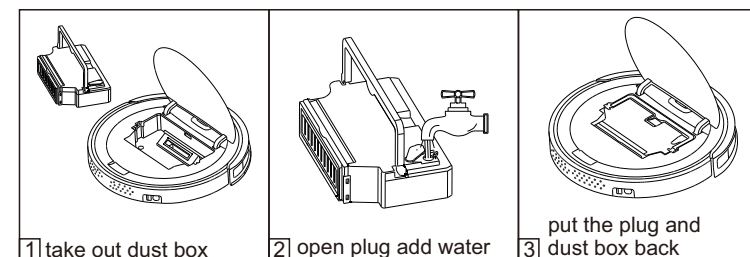

When using a cloth, place the cloth against the bottom of the machine

### 3.7 Usage of remote control

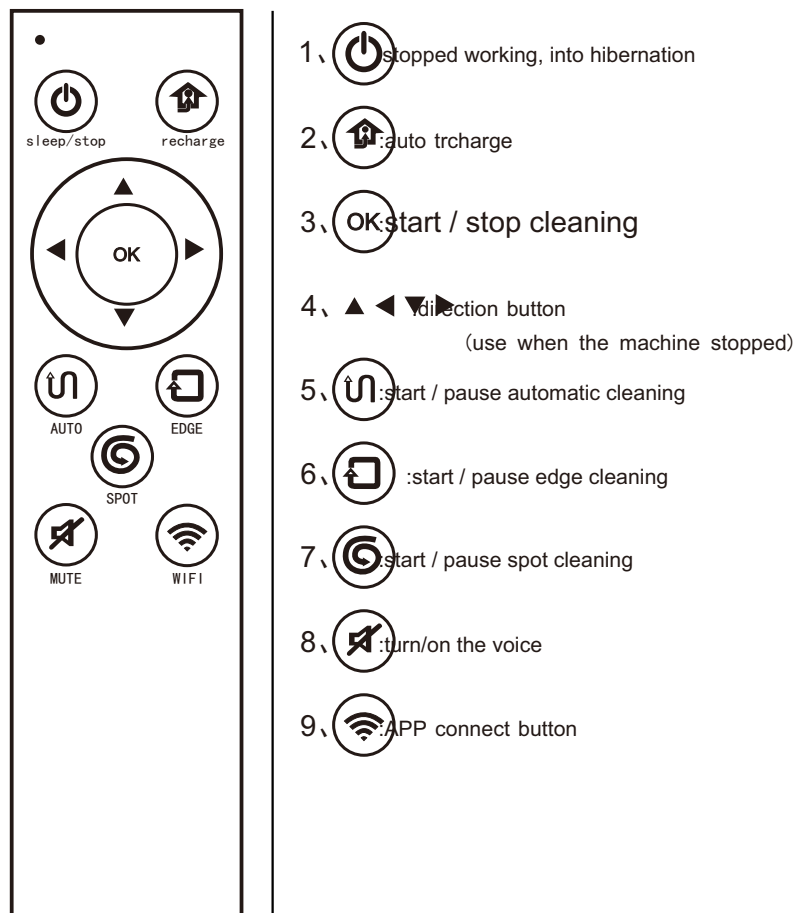

### 3.8 Usage of side brush

#### 1 Side brush explanatory chart

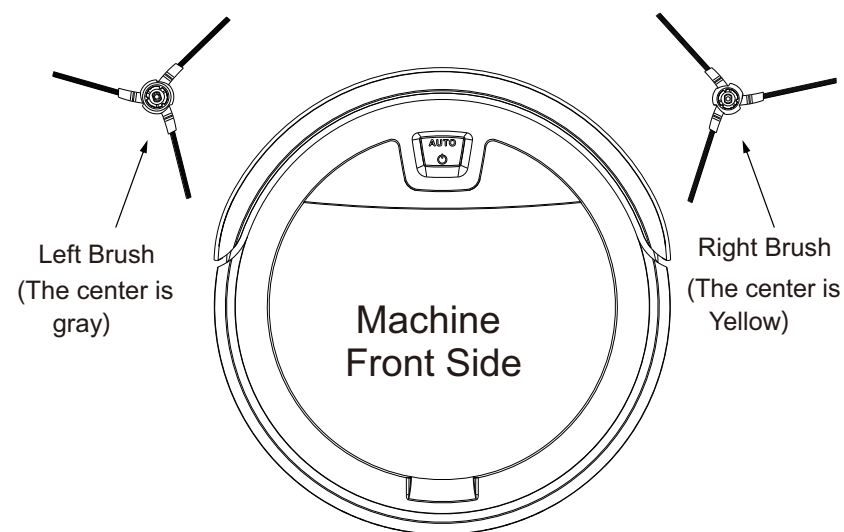

#### 2 Using instruction

- 1、 The edge of the brush (as shown above in the center color) is not interchangeable;
- 2、 In order to ensure good use effect, users should clean the surrounding hair and other debris in time after using the machine for a period of time;
- 3、 The user should change the side brush according to the diagram left and right. (use the screwdriver to remove the fixed screw and side brush, then fix the side brush for replacement);
- 4、 For the user to have good cleaning experience, in hair and other winding areas, please use carefully.

## 4. Maintenance

### 4.1 Dust Box & Filter Material

Remove the dust box and clean up the garbage

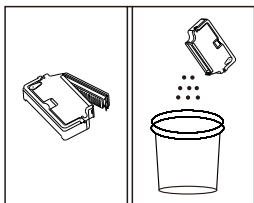

Remove the filter components and wash them. suggest: do not clean hepa with waterpat the dust slightly

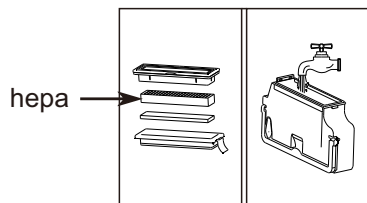

Sun-dry the dust box and filter material to ensure its use and life.

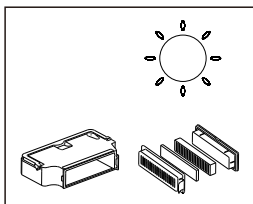

Remark: The user should clean the dust box and filter material in time to keep the machine in good condition.

### 4.2 Cleaning cloth

Clean and dry the cleaning cloth after mop finished

### 4.3 Suction Inlet & Side Brush

Clean up the suction inlet if with too much dust, please use cloth to clean it

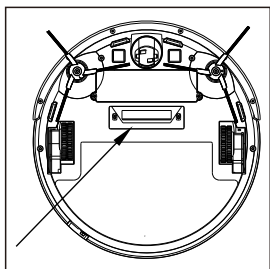

Clean brushes: use the cross screwdriver to remove the side brushes, clear the brush and foreign matter on the side brush.

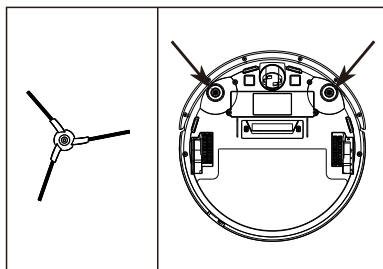

### 4.4 Other Parts

Clean the anti-drop sensor to keep the sensitivity of inductor

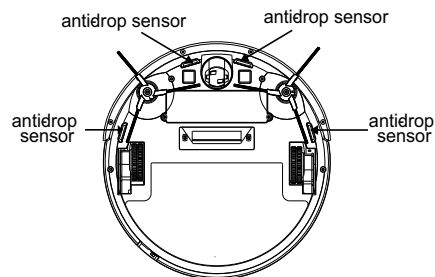

Clean the signal window for better avoidance

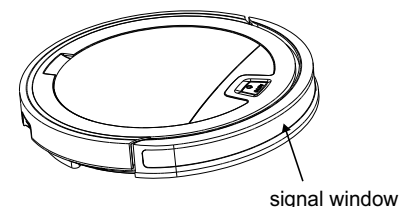

Clean the wheel, reduce the noise and hair winding

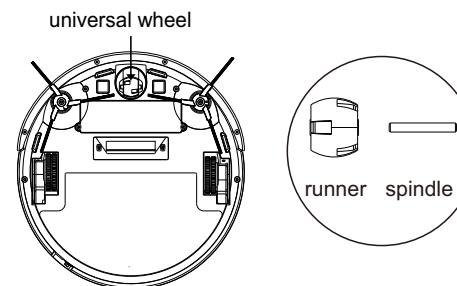

Remove the universal wheel and clean the runner and spindle

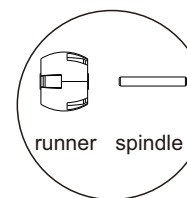

Clean the charging contact and signal window by dry cloth, insure the automatic charging process of the machine fluently

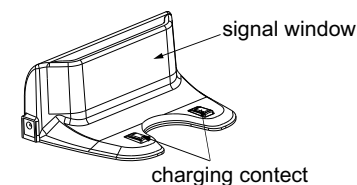
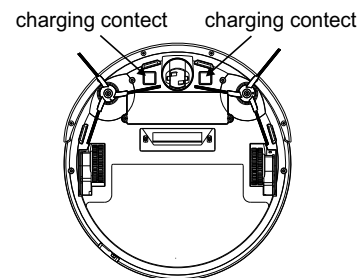



## 5. Malfunction Elimination

If the machine breakdown, in the process of using, follow below situation firstly

NO.	situation	possible cause	solution
1	Machine not working	Machine not turned on	Turn on the host power switch
		Run out of battery	Charge with adapter
2	machine cannot charge	Charging connections are unreliable	Make sure the adapter is reliable
			Wipe charger and charging contact
3	The machine is backing away	The ground sensor has a foreign matter	Use dry cloth wipe the sensor
4	The machine is in circles	Signal window with foreign matter	Use dry cloth wipe the signal window
5	Left/right wheel abnormal	The wheels were wound by foreign matter	Clean the foreign matter
6	Left/right brush abnormal	Left/right side brush setup error	Install the side brush properly
		Left/right brush was wound by foreign matter	Clean the foreign matter
7	Dust box abnormal	The dust box was not put in place	Put the dust box in place
8	Universal wheel abnormal	Universal wheel with foreign matter	clean the universal wheel
9	APP can't use	network connection failed	Follow the manual to connect network
		Network has been connected, but the user connected again	once the network connected don't connect again unless changing wifi
10	remote control insensitive	Too far away from the machine	Alignment the  button in effective range
11	Other abnormal situation	Unknown reasons	restart the machine to solve (Turn off the power switch, put machine on the flat area, then turn on it)

 **Attention: if the above investigation fails to solve the problem, please contact our after-sales service.**  
Do not disassemble the machine by yourself

This device complies with Part 15 of the FCC Rules. Operation is subject to the following two conditions:

- (1) This device may not cause harmful interference, and
- (2) This device must accept any interference received, including interference that may cause undesired operation.

Attention that changes or modification not expressly approved by the party responsible for compliance could void the user's authority to operate the equipment.

Note: This product has been tested and found to comply with the limits for a Class B digital device, pursuant to Part 15 of the FCC Rules. These limits are designed to provide reasonable protection against harmful interference in a residential installation. This product generates, uses, and can radiate radio frequency energy and, if not installed and used in accordance with the instructions, may cause harmful interference to radio communications. However, there is no guarantee that interference will not occur in a particular installation. If this product does cause harmful interference to radio or television reception, which can be determined by turning the equipment off and on, the user is encouraged to try to correct the interference by one or more of the following measures:

- Reorient or relocate the receiving antenna.
- Increase the separation between the equipment and receiver.
- Connect the equipment into an outlet on a circuit different from that to which the receiver is connected.
- Consult the dealer or an experienced radio/TV technician for help.

Please take attention that changes or modification not expressly approved by the party responsible for compliance could void the user's authority to operate the equipment. This equipment complies with FCC/IC RSS-102 radiation exposure limits set forth for an uncontrolled environment. This equipment should be installed and operated with minimum distance 20cm between the radiator & your body.