

User Guide

Package Contents

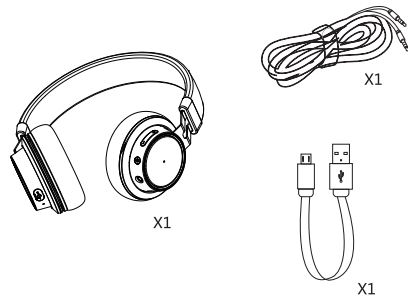

At a Glance

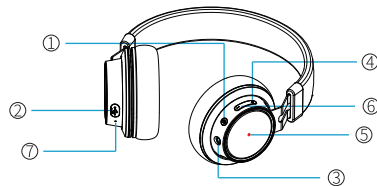

1	Multifunction button	5	LED indicator
2	Micro USB charging port	6	Previous track/Volume - button
3	3.5mm Aux-input	7	Microphone
4	Next track/Volume + button		

1. Turn on/off

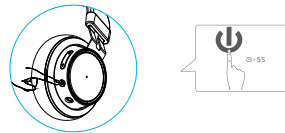

Mindkoo BH09 will automatically turn off after 5 minutes if no device is connected.

2. Pair with your device

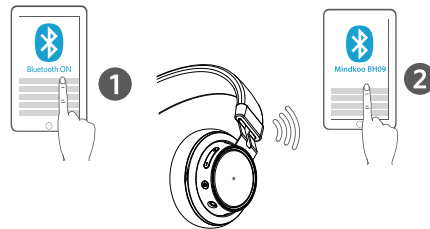

	Flashes blue and red alternately	Pairing mode
	Flashes blue once every 10 seconds	Connected to a device

With the HS21 off, hold the Multifunction Button for 3s to power on HS21 and HS21 will automatically connect to the last connected device.

With the HS21 off, hold the Multifunction Button for 5s to enter Pairing mode.

To pair a different device, first disable Bluetooth on the connected device to re-enter pairing mode. Then repeat the pairing steps.

Having connection problems? Remove H21 from your device's Bluetooth history, ensure it's less than 1 meter away then try pairing again.

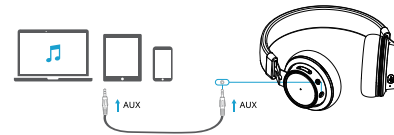

3. Connect via AUX



When using AUX mode, control audio playback via the connected device.

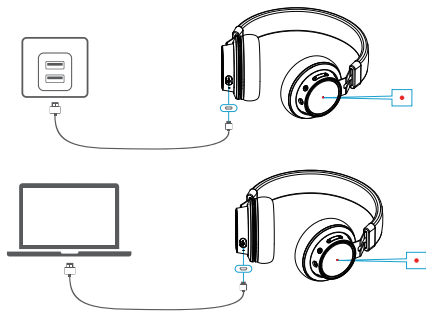



4. Charge your HS21







● Steady red	 Charging
● Steady blue	 Full charged

Mindkoo BH09 will beep every 10 s when the battery is low.

Controls

	
 X1	Play/pause
 X1	Play next/previous
 X1	Volume up/down

	
 X1	Answer/end call
 X2	Reject call
 X2	Redial

Specifications

Input	5V/1A
battery	3.7V 300mAh
Input	5V/1A
Charging Time	2.5 hours
Play Time (varies by volume level and content)	≥16 hours
Size	170×75×180mm
Weight	205g
Range	10m/33ft

Attention

- Don't disassemble
- Avoid dropping
- Avoid extreme temperature
- Do not submerge in water
- Do not use any corrosive cleaner/oil to clean

NOTE: This equipment has been tested and found to comply with the limits for a Class B digital device, pursuant to part 15 of the FCC Rules. These limits are designed to provide reasonable protection against harmful interference in a residential installation. This equipment generates uses and can radiate radio frequency energy and, if not installed and used in accordance with the instructions, may cause harmful interference to radio communications. However, there is no guarantee that interference will not occur in a particular installation. If this equipment does cause harmful interference to radio or television reception, which can be determined by turning the equipment off and on, the user is encouraged to try to correct the interference by one or more of the following measures:

- Reorient or relocate the receiving antenna.
- Increase the separation between the equipment and receiver.
- Connect the equipment into an outlet on a circuit different from that to which the receiver is connected.
- Consult the dealer or an experienced radio/TV technician for help

Changes or modifications not expressly approved by the party responsible for compliance could void the user's authority to operate the equipment.

This device complies with Part 15 of the FCC Rules. Operation is subject to the following two conditions:
 (1) this device may not cause harmful interference, and
 (2) this device must accept any interference received, including interference that may cause undesired operation.

Customer Service



12-month warranty



Lifetime technical support



MANUFACTURER

MINDKOO ELECTRONIC TECHNOLOGY CO.,LTD

16/F kowloon bldg 555 nathan rd mongkok klh hong kong. 999077

support.us@mindkoo.com



204-720655

Made in China