

User Manual

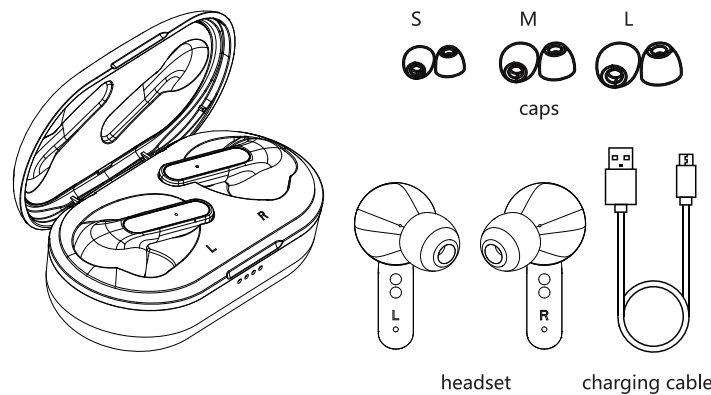

Appearance

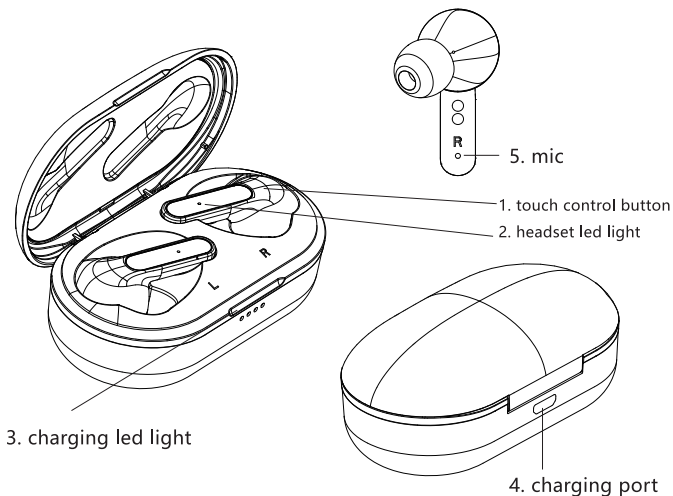

TS74 TWS HEADSET

Instruction

power on/power off

power on	Open the charging box or press 2 seconds	blue lights flashes 3 times	Voice prompt: "power on"
power off	Put headset back into charging box and close the case or press 3 seconds	red lights flashes 3 times	Voice prompt: "power off"

Connecting your device

Before pairing, make sure your headset has enough power and your connected device within the valid range.

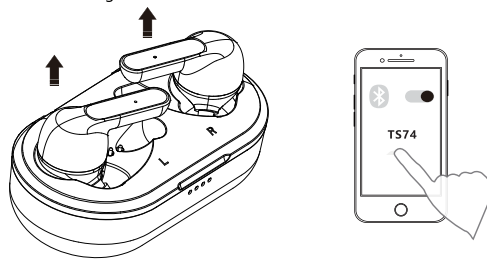

Pairing

Open the charging box or press 2 seconds to enter pairing mode, red/blue lights flash alternately, and the voice prompts: "your headset is connected, pairing mode".

Successful connection

Search & connect headset from device bluetooth list. The blue LED flashes every 2 seconds after Successful connection, and the voice prompts: "Your phone is connected".

Pairing timeout

If fail to connect to device, the red and blue indicators flash alternately and automatically turn off after 5 minutes. The voice prompts: "Power off".

Disconnected

- Manual turn off Bluetooth connection, the red lights flash once. After 10 minutes, the red/blue lights flash alternately and turn off. Voice prompt: "Power off".
- If phone and headset out of range, blue lights quickly flashes, and headset will turn off after 15 minutes.

Clear the pairing list.

Turn on headset and press 8 seconds to clear the pairing list. Voice prompt: "Do..."

Standby

After pairing & connection headset will automatically enter standby state.

Search Headset

- On your wireless Bluetooth device: iPhone, iPad, iPod and Android smartphone or tablet.
- Open the Settings feature on your Bluetooth device.
- Make sure the "Bluetooth" option on your Bluetooth device is turned on and click "Search".
- Wait for the Bluetooth name of the TS74 to be displayed in the Bluetooth list of "Available Devices".
- Select the TS74 Bluetooth name to start pairing and connecting with your Bluetooth device.
- The TS74 Blue light flashes quickly, indicating that your headset has been paired successfully, and you can start playing and listening to your favorite music.

Note:

- You have 5 minutes to connect the headset to your device, otherwise the headset will exit pairing mode and turn off. Pls tap control button 3 seconds to turn it on and re-enter the pairing mode.
- Only the left earphone connect your device. The right earphone will connect the left earphone.

Wearing

Try changing the ear caps for the best fit and sound effect. Better sealing for better sound effect.

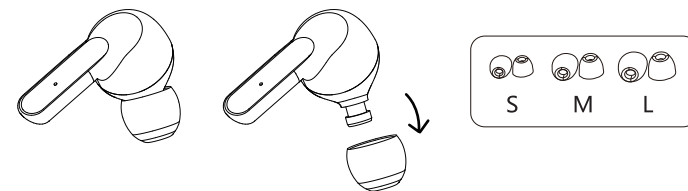

Put the earphones in the ear canal. Gently turn to comfortable fit.

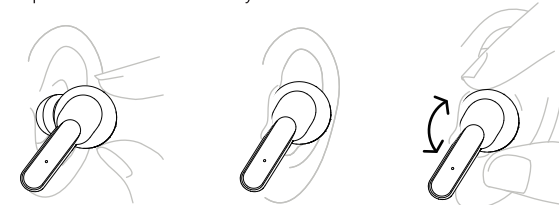

Tip: There are multiple ear caps for you. For the best sound effect, choose the one completely seals your ear canal. your left and right ears may need different size ear caps.

Play music

When Play music you can use any of the headphones to control it.

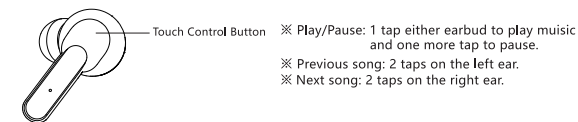

Call

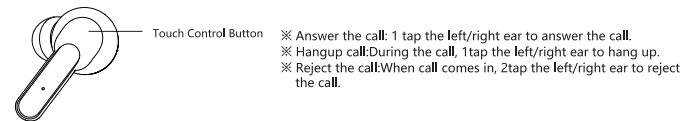

Charge the headset

Put the headset into the charging case. Close the charging box completely. During the charging process, the box blue indicator light is always on, the headset starts to charge. The box blue indicator light is off after the battery is fully charged.

Headphone low battery

When battery is low, there will be a beep alarm every 3 minutes and the red light will flash.

Charge for charging box

Box indicator during headset in recharging

charging	Box blue light on
complete	Box blue light off

Box indicator during box in recharging

charging	blue light flashes
complete	blue light on

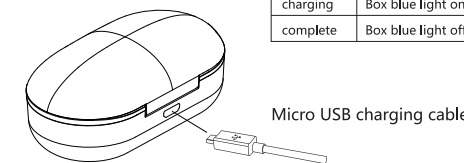

Micro USB charging cable

Plug the charging cable into charge connector to charge the charging box and headphones. The indicator light of the charging box will light up while charging.

Specification

- Bluetooth Version: V5.0
- Weight : (headset:43g)
- Standby : 80 Hours
- Frequency Response : 20Hz ~ 20kHz
- Driver unit : Φ8mm
- Support protocol: A2DP, AVRCP, HSP, HFP
- Charging time : 1 Hour
- Music play : 3-4 Hours Call : 3-4 Hours
- Distance : 10m
- Operating/storage/charging temperature : -10°C-50°C

Safety instructions

- For safety reasons, do not use headphones when riding a bicycle, motorcycle or while driving. It is dangerous to turn the volume too loudly to hear the outside sound. Please watch the surrounding vehicles drive carefully.
- Do not disassemble, bump, or squeeze the product.
- Do not place this product in a hot or humid environment.
- Do not put this product into fire, water or corrosive liquids.
- Do not place this product on flammable materials while charging.
- If you remove and replace the internal battery yourself, there is a danger of explosion.
- Avoid excessive volume or long-term high volume headphones to avoid hearing damage.
- Keep the headphones out of the reach of children to avoid the danger of improper use by children.

Frequently asked questions

- If the TS74 Wireless Bluetooth Headset does not turn on?
- Check that your TS74 Wireless Bluetooth Headset has enough battery power.
- If your computer's own battery is exhausted, your computer's USB port will not be able to charge the TS74's battery. Try charging the TS74's battery with a 5V (1A or 2A) USB charger. The charging time is about 2-3 hours.
- What if there is no sound playing music headphones?
- Check if the playing device and the Bluetooth headset are connected effectively. If the audio device is not connected properly, please reconnect and adjust the volume of the mobile phone and Bluetooth headset to the appropriate volume level.
- Please confirm whether the Bluetooth of the mobile phone is in "Device Visible Mode". If the pairing is not performed for a long time, the Bluetooth pairing function will be automatically turned off. Please turn Bluetooth back on to "Device Visible Mode". If the phone program error occurs, please restart the phone. If the Bluetooth headset program is wrong, please restart the Bluetooth headset.

NOTE: This equipment has been tested and found to comply with the limits for a Class B digital device, pursuant to part 15 of the FCC Rules. These limits are designed to provide reasonable protection against harmful interference in a residential installation. This equipment generates uses and can radiate radio frequency energy and, if not installed and used in accordance with the instructions, may cause harmful interference to radio communications. However, there is no guarantee that interference will not occur in a particular installation. If this equipment does cause harmful interference to radio or television reception, which can be determined by turning the equipment off and on, the user is encouraged to try to correct the interference by one or more of the following measures:

- Reorient or relocate the receiving antenna.
- Increase the separation between the equipment and receiver.
- Connect the equipment into an outlet on a circuit different from that to which the receiver is connected.
- Consult the dealer or an experienced radio/TV technician for help

Changes or modifications not expressly approved by the party responsible for compliance could void the user's authority to operate the equipment.

This device complies with Part 15 of the FCC Rules. Operation is subject to the following two conditions:

- (1) this device may not cause harmful interference, and
- (2) this device must accept any interference received, including interference that may cause undesired operation.