

iCARE User's Manual

The iCARE box contains : one 8 in 1 measurement device, one micro-usb charging cable, and one protective box.

Cloudmed iCARE Disclaimer

Applicable age is 18 - 75 years old. This product is for self-health management only. All the service/information congregated from iCARE and iCARE APP is not intended for use in the diagnosis of any medical condition or cure, treatment, or prevention of disease. The performance and accuracy of the information and measured data by iCARE and iCARE app may be affected by skin-condition, environmental condition, personal profile, iCARE settings, and user's gesture.

Please follow the given instructions to setup your iCARE device with iCARE APP

1. Product Introduction

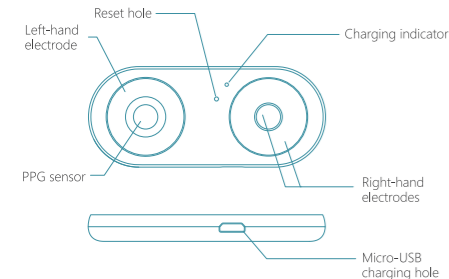

2. Install iCARE APP on Phone

Search "CloudMed iCARE" APP on Google Play/Apple Store or scan the QR Code and download the app from official website.



3. To Connect via Bluetooth

Start iCARE APP and follow the instructions to create an account. Then, click the Bluetooth icon to search iCARE device and start measuring.

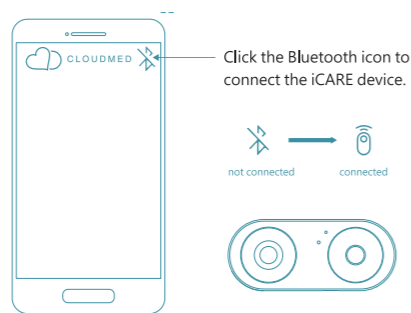

4. iCARE Charging

When the battery capacity is low, please charge the iCARE device. It's not recommended to use the iCARE device during charging due to the power-line interference.

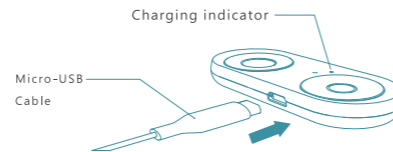

5. Measurement Reminder

Please put your fingers on the upper side of the device and relax yourself during the measurement.

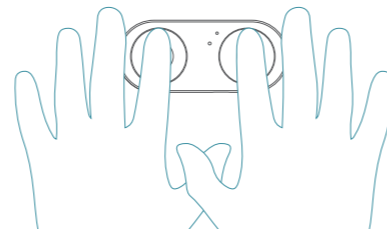

6. Six Features

8 in 1 Quick Measurement (Within 60 seconds.)

Instant Report with Suggestions

Health Journal in Cloud (Free for 3 months health data storage.*)

Waveform Recording

Medication Reminder

One Click for SOS+Positioning

* Cloudmed Co.,Ltd. reserves the right to make changes.

7. Specifications

Product	Information
Product Size	70x30x8 mm
Battery Capacity	70 mAh
System Requirement	BLE 4.2 or above
Input Voltage	5.0 V (DC)
Charging Function	Yes(Micro-USB)
Charging Indicator	Yes/Red
Phone Version	Android 6.0 / iPhone 7 or above

8. Service Policy

1. The Cloudmed iCARE comes with an one year warranty from date of purchase.

2. Only hardware and manufacturing defects are covered under warranty.

3. Contact Cloudmed helpline through voice, email or chat for any issues with your device.

FCC Warning Federal Communications Commission Statement

This device complies with FCC rules part 15. Operation is subject to the following two conditions:
This device may not cause harmful interference.
This device must accept any interference received including interference that may cause undesired operation.

This equipment has been tested and found to comply with the limits for a Class B digital device, pursuant to part 15 of the FCC Rules. These limits are designed to provide reasonable protection against harmful interference in a residential installation. This equipment generates, uses and can radiate radio frequency energy and, if not installed and used in accordance with the instructions, may cause harmful interference to radio communications. However, there is no guarantee that interference will not occur in a particular installation. If this equipment cause harmful interference to radio or television reception, which can be determined by turning the equipment off and on, the user is encouraged to try to correct the interference by one or more of the following measures:
•Reorient or relocate the receiving antenna.
•Increase the separation between the equipment and receiver.
•Connect the equipment into an outlet on a circuit different from that to which the receiver is connected.
•Consult the dealer or an experienced radio/ TV technician for help.

FCC Caution

Any changes or modifications not expressly approved by the party responsible for compliance could void the user's authority to operate this equipment.

Radiation Exposure Statement

This equipment complies with FCC radiation exposure limits set forth for an uncontrolled environment. End users must follow the specific operating instructions for satisfying RF exposure compliance. The antenna(s) used for this transmitter must not be co-located or operating in conjunction with any other antenna or transmitter.

Cloudmed

Official Website: <https://www.cloudmed-ai.com>

E-mail: service@cloudmed-ai.com



iCARE User's Manual