

DASH

# GUARDIAN

## Quick Start Guide

v1.0.0

### What's in the Box



Camera x1



Power Cable x1



Weather Foam Seal x1



Mounting Plate x1



Hardware Package x1



Power Adapter x1



Hole Guide x1



QSG x1

### Know your Guardian

LED  
LED Indicator



Lens



Built-in Mic

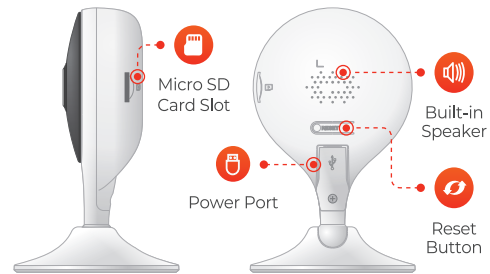

**Note:** Press & hold the reset button for 10s to reset the camera. The pattern of the LED indicator is included in the following table.

LED Indicator Status	Device Status
Off	<ul style="list-style-type: none"><li>Powered off/LED turned off</li><li>Rebooting after reset</li></ul>
Red light on	<ul style="list-style-type: none"><li>Booting</li><li>Device malfunction</li></ul>
Green light flashing	Waiting for network
Green light on	Operating properly
Red light flashing	Network connection failed
Green and Red light flashing alternately	Firmware updating

## About the Guide

- This quick start guide is for reference only. Minor difference might be found in user interface.
- All the design and software here are subject to change without prior written notice.
- All trademarks & registered trademarks mentioned are the properties of their respective owners.
- Please visit our website or contact your local service engineer for more information.
- If there is any uncertainty or controversy, please refer to our final explanation.

## Using the Dash App

### Step 1

Scan the QR code or search "IC Realtime" in the Google Play or App Store to download & install DASH.



### Step 2

Run the DASH App, and then register a new account if you do not already have one.

### Step 3

Connect the camera to a power source.

### Step 4

The camera LED indicator will flash green when it is fully booted on.

### Step 5

With your mobile device connected to a 2.4 GHz band, follow the steps on the app to add a camera.

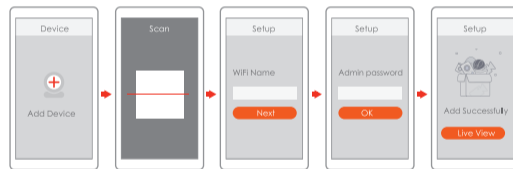

- Note:**
- Repeat step 5 for adding multiple cameras.
  - If camera fails to add or the WiFi connection is changed. Reset the camera and repeat step 5.

## Camera Installation

**Note:** Make sure that the mounting surface can hold at least 1lb.

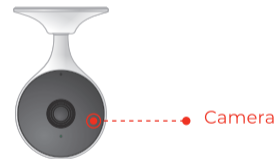

- Step 1** Use the guide to mark & drill holes for the drywall anchors.
- Step 2** Attach the mounting plate by drilling the provided screws into the anchors from step 1.
- Step 3** Attach the camera to the magnetic mounting plate, and adjust lens as needed.

# Regulatory Information

---

The regulatory information herein might vary according to the model you purchased. Some information is only applicable for the country or region where the product is sold.

## FCC Information



Changes or modifications not expressly approved by the party responsible for compliance could void the user's authority to operate the equipment.

### FCC conditions:

This device complies with part 15 of the FCC Rules. Operation is subject to the following two conditions:

- This device may not cause harmful interference.
- This device must accept any interference received, including interference that may cause undesired operation.

### FCC compliance:

This equipment has been tested and found to comply with the limits for a digital device, pursuant to part 15 of the FCC Rules. This equipment generates, uses, and can radiate radio frequency energy and, if not installed and used in accordance with the instructions, may cause harmful interference to radio communication.

- For class B device, these limits are designed to provide reasonable protection against harmful interference in a residential installation. However, there is no guarantee that interference will not occur in a particular installation. If this equipment does cause harmful interference to radio or television reception, which can be determined by turning the equipment off and on, the user is encouraged to try to correct the interference by one or more of the following measures:

- Reorient or relocate the receiving antenna.
- Increase the separation between the equipment and receiver.
- Connect the equipment into an outlet on a circuit different from that to which the receiver is connected.
- Consult the dealer or an experienced radio/TV technician for help.

This equipment should be installed and operated with a minimum distance 20cm between the radiator and your body.

## **Battery Replacement and Disposal**

Applicable to products with battery.



**CAUTION**

Risk of explosion if battery is replaced by an incorrect type. Dispose of used batteries according to the instructions.

## **Privacy Protection Notice**

---

As the device user or data controller, you might collect personal data of others such as face, fingerprints, car plate number, Email address, phone number, GPS and so on. You need to be in compliance with the local privacy protection laws and regulations to protect the legitimate rights and interests of other people by implementing measures include but not limited to: providing clear and visible identification to inform data subject the existence of surveillance area and providing related contact.

SDOC statement: <http://icrealtime.com/FCC/>