

FCC ID: 2AR93-082V1927

Model No.:VL1BLE

Model Name:Bluetooth Padlock

This device complies with Part 15 of the FCC Rules. Operation is subject to the following two conditions:(1) this device may not cause harmful interference, and (2) this device must accept any interference received, including interference that may cause undesired operation.

FOR MASS PRODUCTION
仅供量产用

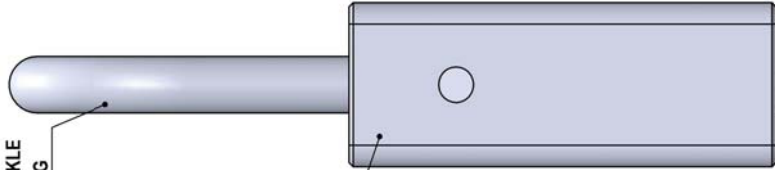
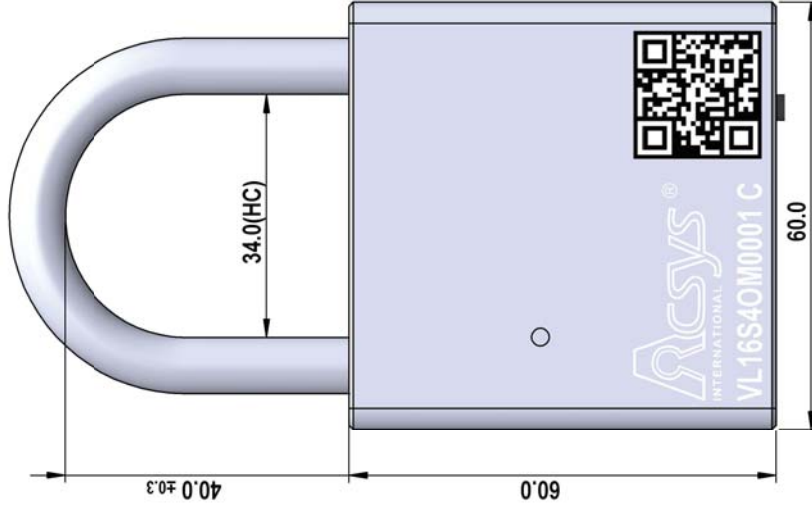
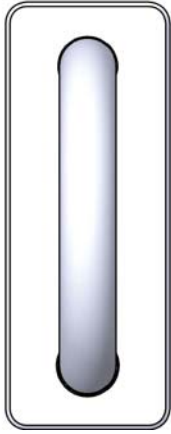
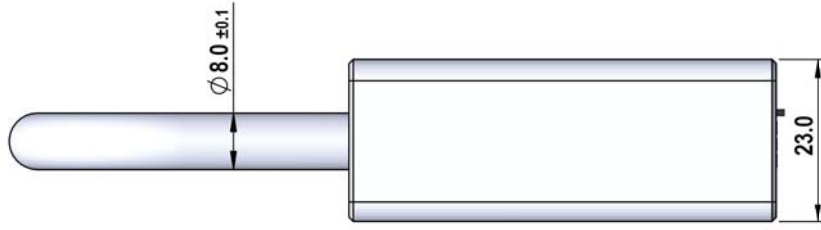
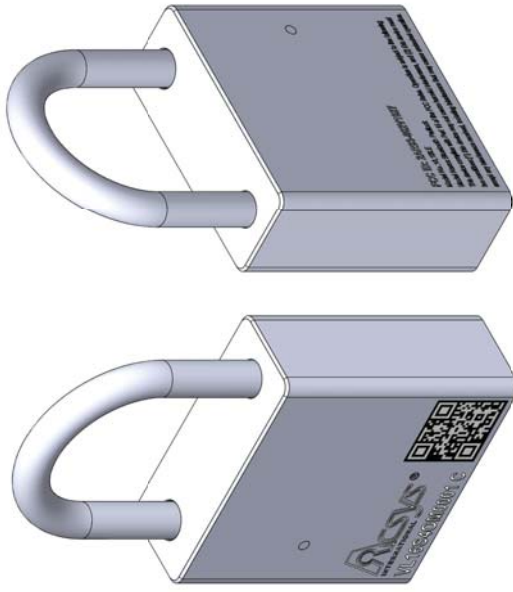
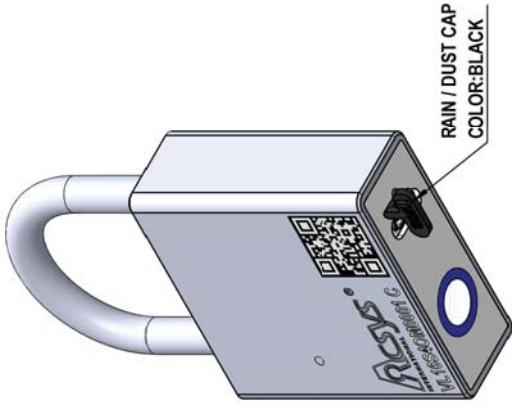

HARDENED CARBON TEEL SHACKLE
WHITH NICKEL+CHROME PLATING

LOCK BODY:
BRUSHED ALUMINUM
WITH ANODIZED
(REF SAMPLE)

DECORATE BRACKET
COLOR :BLUE-PANTONE 2746C

ACTIVATION BUTTON AND
LED INDICATOR
COLOR:WITHE 50% TRANSPARENT

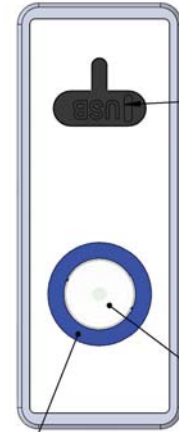

NOTE:
DIMENSIONS ARE IN MM TOLERANCES
ONE PLACE DECIMAL: ± 0.3

ACSYS[®] VL1BLE
ACCESS CONTROL SYSTEM

TITLE:

VL1BLE PADLOCK

DWG. NO. REV

VL1-0826-FC-S4-00-AC-40 S0

A4 SCALE: 1:1

DO NOT SCALE DRAWING

SHEET 1 OF 4

DATE: 2019/06/28 NAME: TONY S0 CREATION BASE 190101A-VL1BLE-S7

REV: MODIFICATIONS

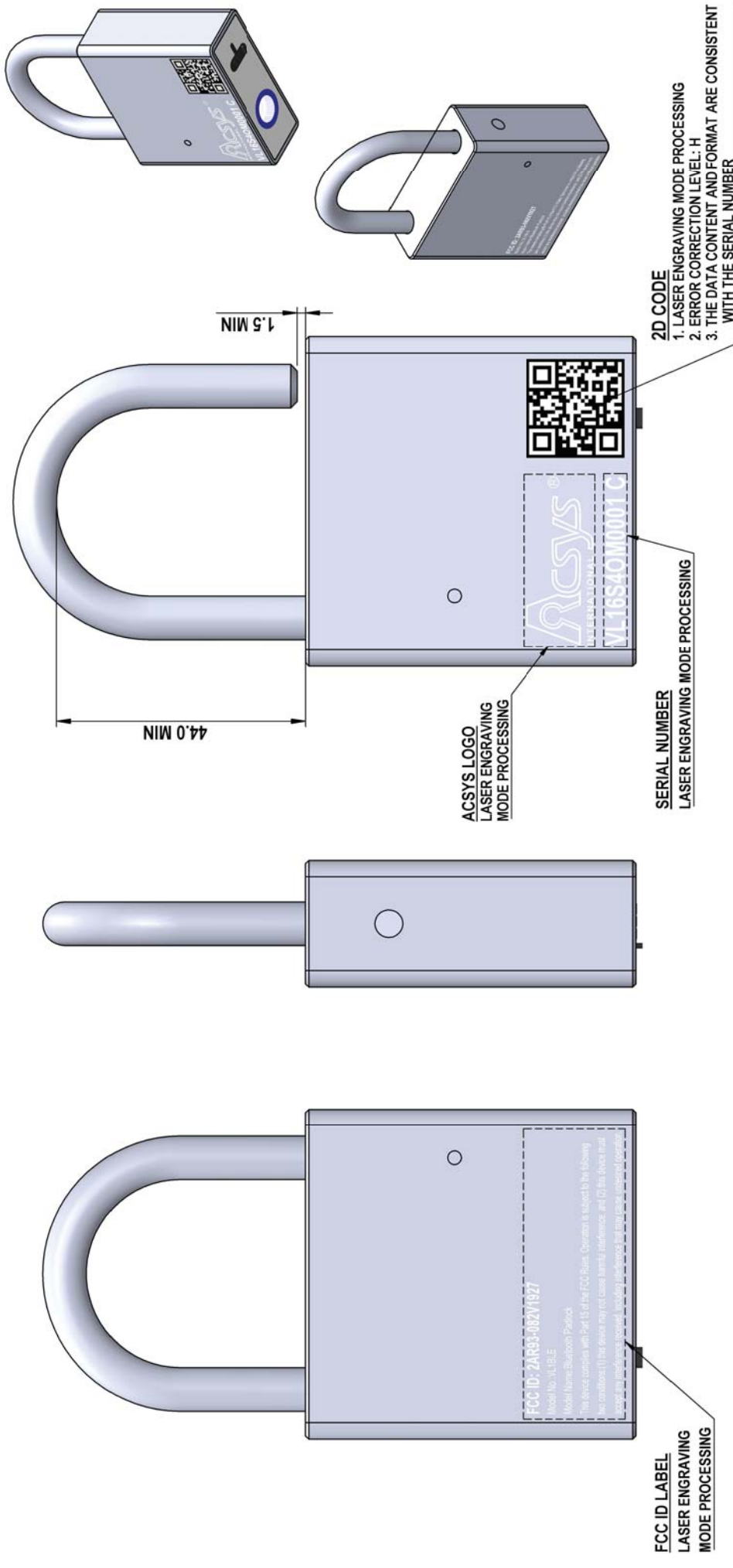

INCREASE LASER DIMENSION 2

INCREASE LASER DIMENSION 1

NOTE:
DIMENSIONS ARE IN MM TOLERANCES
ONE PLACE DECIMAL: ±0.5

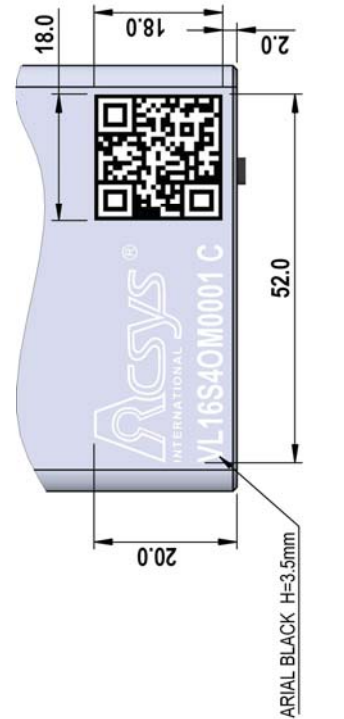

	VL1BLE
	VL1BLE PADLOCK
DWG. NO.	VL1-0826-FC-S4-00-AC-40
REV	S0
A4	SCALE: 1:1
DO NOT SCALE DRAWING	
SHEET 2 OF 4	

Mechanical

Form Factor: VL1BLE
Shackle Type: 8 mm diameter, 40 mm height, hardened, none-removable
Dimensions: 60 x23 x 107 mm
Weight: 240g
Environment:
Outdoor usage (protection dust, damage to LED, button and USB connector)
Ingress Protection (IP): IP65
Relative Humidity: 0 to 95% (without condensation)
Operational Temperature: Low -10°C, High +60 °C
Storage Temperature: Low -20 °C, High +80 °C
Material: hardened carbon steel shackle, Brushed aluminum padlock body
Plating:
 Shackle: nickel+chrome plating
 Body: anodized
 Product shall pass and remains functional after 96H salt spray test according to EN16864

Markings: Logo and serial number on the body

Certification:

- EN12320 or EN16864 minimum 1132 Grade 2 (please refer to target and Quality Plan)
- CE, FCC
- ROHS

Life Expectancy: 100,000 openings

Warranty: 1-year limited warranty against manufacturer defects

Suggest MSRP: TBD (commercial/marketing)

NOTE:

Flat battery: an external micro USB power device will be used to power up immediately
Shipping lithium battery: the battery will be shipped assembled with the product. Logistics will confirm the battery certificate requirements and whether it has to be connected with the circuit during shipping of the product.

Electronic

Platform: Acsys Telecom

Technology: Bluetooth 4.0 and 4.0 above BLE Low power consumption

Encryption: AES 128-bit

Audit Trail: Access records of usage and shackle open/close (1000)

Sensor: Detect shackle open/close

LED indicator:

Bluetooth and functionality status

Battery power status indicator (status is also broadcasted through the APP)

Battery charging status indicator

Battery Type: Removable rechargeable lithium

Battery Usage: 0.5 year (1 year target)

Battery Life: 2 years (before replacement)

Battery Charging Port: Micro USB

Battery capacity: 420mAh at least.

Emergency launch: When battery is disabled due to voltage drop under valid level-
 a. if battery has already damaged and it do not able to recharged, the lock must be available to launch for unlocking.

b. if battery still be healthy and able to recharged, the lock must be available to launch for unlocking.

Firmware version: Firmware inside lock should be 100% compatible with the API reference documentation which OKLOK delivered to ACSYS previously (Bluetooth Lock Communication Protocol version F). Any private protocol modification is not allowed.

Charging current: 500mA at least(According to USB2.0 standard).

Advertising name must be 'ONDLock'.

	VL1BLE
	TITLE:
DWG. NO.	VL1-0826-FC-S4-00-AC-40
REV	S0
SCALE: 1:2	DO NOT SCALE DRAWING
A4	SHEET 3 OF 4

PROPRIETARY AND CONFIDENTIAL: THE INFORMATION CONTAINED IN THIS DRAWING ARE THE SOLE PROPERTY OF ACSYS. ANY REPRODUCTION IN PART OR AS A WHOLE WITHOUT THE WRITTEN PERMISSION OF ACSYS IS PROHIBITED.

UNIT BOX

(SCALE 1:2)

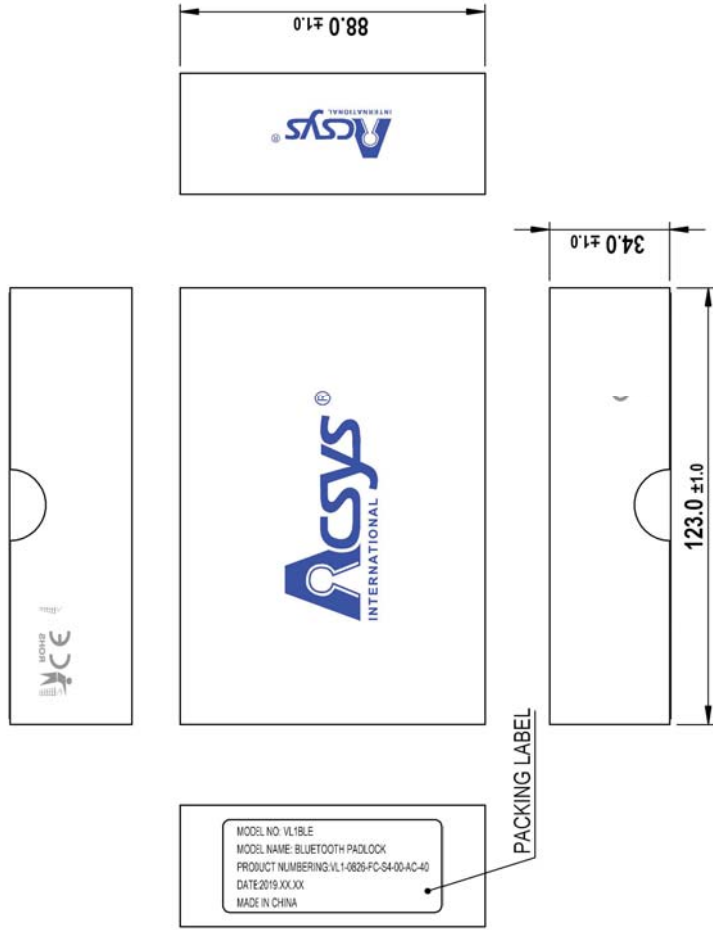

CARTOON BOX

(SCALE 1:8)

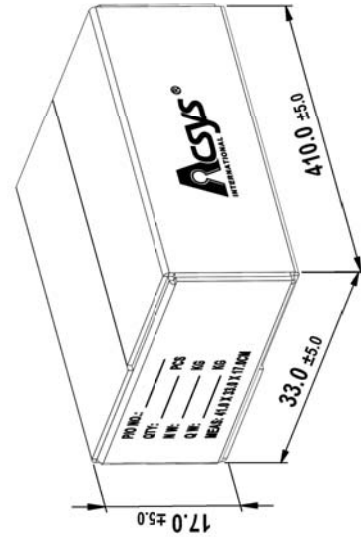

NOTE:
PACKING METHOD: 50PCS BLUETOOTH PADLOCK PRODUCT FOR EACH CARTOON BOX.



TITLE:

VL1BLE PADLOCK

DWG. NO.

VL1-0826-FC-S4-00-AC-40

REV

S0

A4

SCALE: 1:5

DO NOT SCALE DRAWING

SHEET 4 OF 4