

onn.

36" 2.1 Soundbar User Manual



We'd love to hear from you. Scan with your Walmart app and let us know what you think.

Battery Replacement for the Remote Control the First Step 01

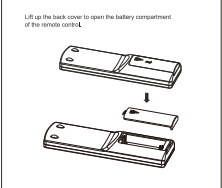

Battery Replacement for the Remote Control the Second Step 02

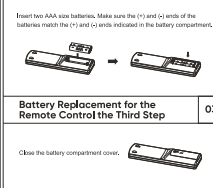

Battery Replacement for the Remote Control the Third Step 03



Remote Control Operation Range

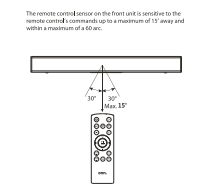

LED Screen Activity

- LED Screen activity
- Bluetooth is paired: the screen display "PAIRED"
- Bluetooth is paired: the screen display "PAIRED"
- Bluetooth disconnected: the screen display "UNPAIRED"
- Output: the screen display "OPTICAL"
- Input: the screen display "HDMI ARC"
- HDMI ARC: the screen display "HDMI ARC"

Adjusting the Volume

- Press VOL +/- on the left or the right control to adjust the channel's volume range (0 to 100 dB).
- Press VOL +/- on the left or the right control to adjust the channel's volume range (0 to 100 dB).

Service

How to get service:

- Call 1-800-4-A-S-O-N-N.
- Visit our website at www.onn.com.
- Visit our store at www.onn.com.

Warranty

Walmart, Inc. Limited Warranty

DEFECTIVE PRODUCT WARRANTY

What's in the Box?

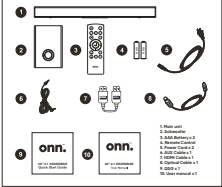

Get to Know Your 36" 2.1 SOUNDBAR

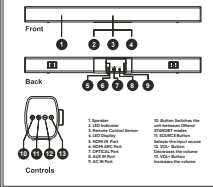

Get to Know Your 36" 2.1 SOUNDBAR

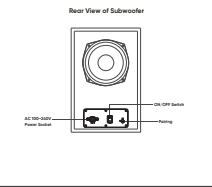

Remote Control Overview

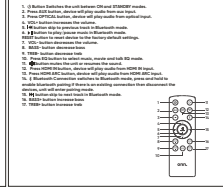

Using the HDMI IN or HDMI ARC connection

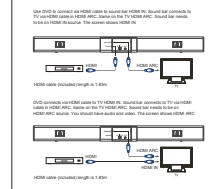

Using the AUX or Optical Connection

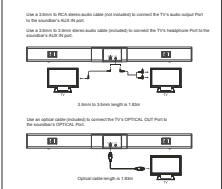

Bluetooth Connection and 2.1 Connection

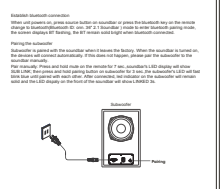

Using the Bluetooth Connection

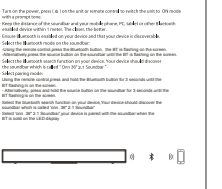

Connecting to the Power Outlet

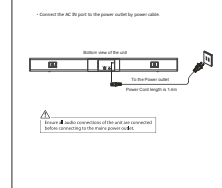

Product Wall Mounting the First Step 01

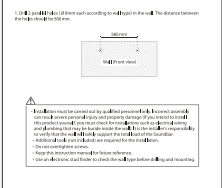

Product Wall Mounting the Second Step 02

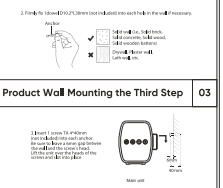

Product Wall Mounting the Third Step 03

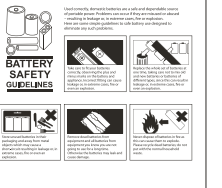

Safe Warnings

- Do not use the product in a wet or damp environment.
- Do not use the product near water.
- Do not use the product near heat sources.
- Do not use the product near flammable materials.

Specifications

Model	Dimensions	Weight
ONN-SB36	36" x 2.1"	15.5 lbs
ONN-SB36	36" x 2.1"	15.5 lbs

IMPORTANT SAFETY INSTRUCTIONS

- Read the manual carefully before using the product.
- Do not use the product if it is damaged.
- Do not use the product if it is not working properly.

Some DOs and DON'Ts on the safe use of equipment

- DO: Use the equipment in a safe and sound manner.
- DO: Use the equipment in a safe and sound manner.
- DO: Use the equipment in a safe and sound manner.

Hints and Tips

- Use the equipment in a safe and sound manner.
- Use the equipment in a safe and sound manner.
- Use the equipment in a safe and sound manner.