

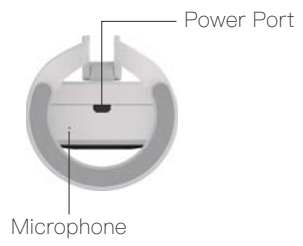

amarey Home Camera S102
User Manual



1.Status of indicator

Solid red	Power on
Quick flashing green	Waiting for Wi-Fi Connectin
Slow flashing green	WiFi connection
Solid green	Connecting is successful

2.What's in the Box

- amarey Home Camera S102
- Micro USB cable
- Quick Start Guide
- Power Adapter

3. Install amarey app

- Please search "amarey app" in Google Play or Apple Store.
- Please download from amarey official web: www.iamarey.com.
- Please scan the QR code as below to download and install.



4. Wi-Fi Connection

Step 1: Power on the Camera, add a new device by ① or ②, and **select camera.**

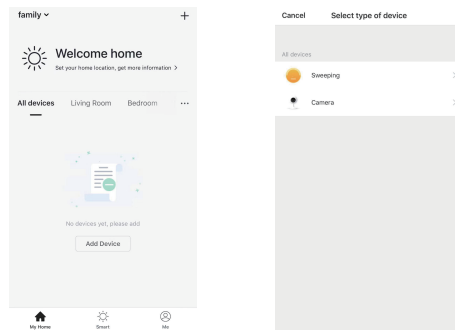

Step 2: ①-Select the net-pairing method.
②-QR code net-pairing method.
③-SmartConfig net-pairing method.

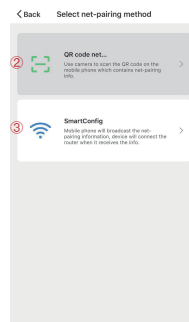
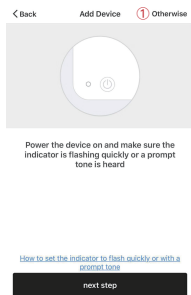

- Step 3: Connect to Wi-Fi network.
- ①-Enter the password of the Wi-Fi network.
 - ②-Change the Wi-Fi network.

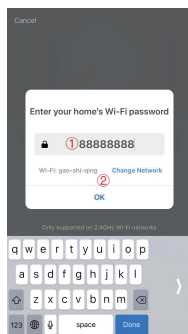

QR code net-pairing method

After enter the password and confirm there will be a QR code on your phone.

- ①-Place the QR code towards to the camera lens wait for scanning.
- ②-If you hear “Connecting, please wait”, click “Heard the beep”
- ③-If you hear nothing please press “Heard nothing at all” for help.

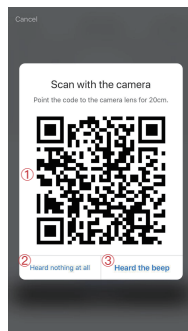

SmartConfig net-pairing method

After enter the Wi-Fi password and press “OK”, you will hear “Connecting, please wait”

Step 4: Waiting for Wi-Fi connection. When you hear “Connecting is successful” means your camera connect to Wi-Fi network successfully.

- ①-Please wait a second for your phone to connect the camera.
- ②-It will forward to the camera setting page automatically then you can enjoy your S102.

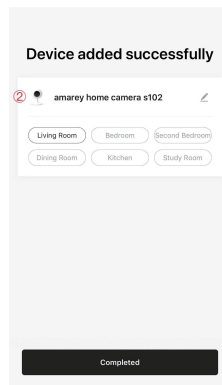

If connection is failed like the picture please reset the device by press and hold the reset button until you hear “Resetting is successful” and reconnect the Wi-Fi network.

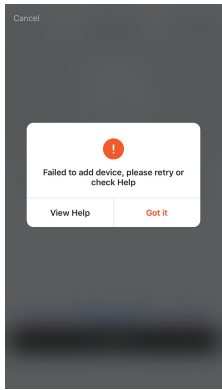

5. Reset

- Please use pin to press and hold the "Reset" button until you hear the hint tone "Resetting is Successful."
- Please reconnect the Wi-Fi as the instruction.



6. Wi-Fi connection tips

- The camera can only support 2.4G Wi-Fi network, can't support 5G Wi-Fi network.
- If you enter wrong Wi-Fi password the camera will be reset automatically then you can reconnect to Wi-Fi.
- If the Wi-Fi signal is not well, please reset the camera with the pin and reconnect to Wi-Fi.
- If you want to change the Wi-Fi network please reset the device by press and hold the reset button until you hear "Resetting is successful" and reconnect to the Wi-Fi network you want.
- If the phone is far away from the camera and router, the net-pairing probably be failed. Please make sure that the device, the phone and the router are closed to each other.

- If the devices that connect to the router reach the limit please try to turn off some devices' Wi-Fi and configure the camera again.
- If you want to add the camera to another phone, please remove the device from the app first and use another phone to add the device.
- If the camera is online, and you remove the device from your App, the camera will be reset automatically and need to reconnect to the Wi-Fi network.
- If the camera is offline, and you remove the device from your App, please power on the camera it will try to connect to the Wi-Fi network that paired last time. If net-pairing is successful the camera will be reset automatically, if failed, please reset the camera by press and hold the reset button and reconnect to the Wi-Fi network as the instruction.

7. Privacy statement

We're committed to being open and honest about how we use data. We will always ask for permission before sharing personally identifiable information, like your email address, and we work hard to keep your data safe. Go to <https://iamarey.com> to learn more about our Privacy Policy.

8. Safety Instruction

 Dispose in accordance with applicable legislation.

The WEEE symbol means that your amarey Home Camera must be disposed of separately from general household waste. When amarey Home Camera reaches its end of life, take it to a designated waste collection point in your area for safe disposal or recycling. By doing this, you'll conserve natural resources, protect human health and help the environment.

9.Customer Service



Facebook:@amarey.robot
Twitter:@amareyrobot
Email: support1@iamarey.com
For online support, visit www.iamarey.com/

FCC Statement

Any Changes or modifications not expressly approved by the party responsible for compliance could void the user's authority to operate the equipment.

This device complies with part 15 of the FCC Rules. Operation is subject to the following two conditions: (1) This device may not cause harmful interference, and

(2) This device must accept any interference received, including interference that may cause undesired operation.

FCC Radiation Exposure Statement:

This equipment complies with FCC radiation exposure limits set forth for an uncontrolled environment .This equipment should be installed and operated with minimum distance 20cm between the radiator& your body.