

Kube Audio Clock II

Charging Station with
Bluetooth Audio and Alarm Clock



User Guide

Please read these instructions completely
before operating this product.

FCC ID: 2AR3M-KS2

Model Name: KS2 Qi100

INTRODUCTION

Getting to Know Your Alarm Clock

FRONT/LEFT SIDE

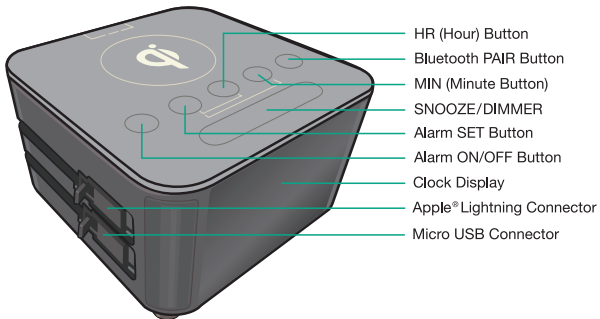

INTRODUCTION

Getting to Know Your Alarm Clock

REAR/RIGHT SIDE

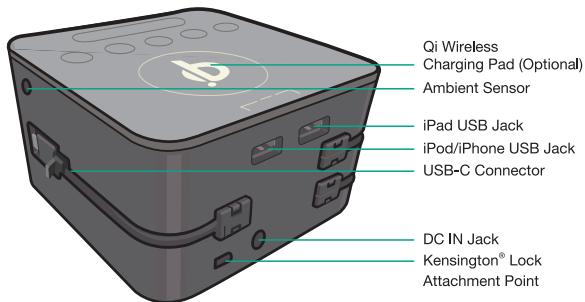

Getting to Know Your Alarm Clock

BOTTOM

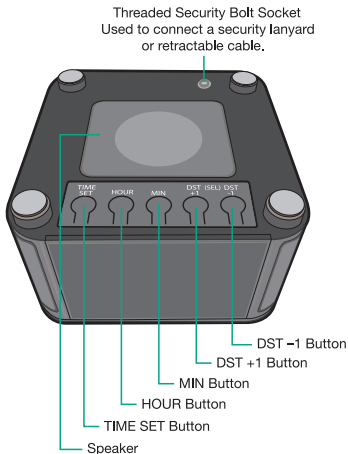

OPERATION

AC Connection

- 1 Insert the 12VDC/4A plug into the DC In jack on the rear of the unit.
- 2 Plug AC adapter into 100-240v (50-60hz) wall outlet. The clock will display the time.

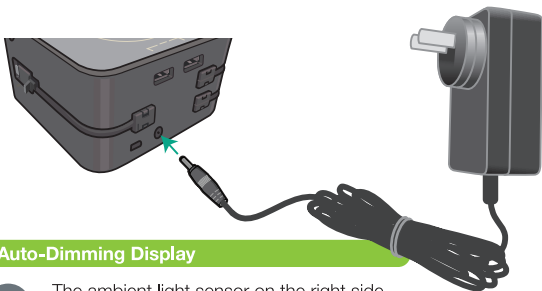

Auto-Dimming Display

- 1 The ambient light sensor on the right side of the unit will dim the clock display when it detects the ambient light is low if the unit is clear of obstructions. Display brightness can also be adjusted via the SNOOZE/DIMMER button. There are 4 settings (100,75, 50, and 25%) for a lit room, and 4 settings (75, 50, 25%, and OFF) for a dark room.



OPERATION

Setting the Time

- 1 To set the time, turn the unit upside down. Press and release the TIME SET button on the bottom of the unit; the time will flash in the display.

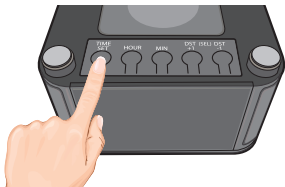

- 2 Within 3 seconds, press the HOUR button to set the hour, making sure to set the correct AM/PM.



- 3 Within 3 seconds, press the MIN button to set the minutes. When done, wait a few seconds and the clock will stop flashing. Note: if the IR app has been used to program the unit, the bottom buttons will be disabled. To enable the bottom buttons press and hold SET and MIN together for 5 seconds. The display will indicate Lb.on (Lower buttons ON).

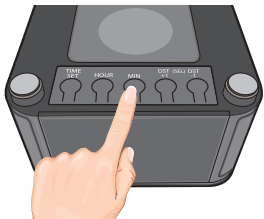

OPERATION

DST (Daylight Saving Time)

- 1 To change the time for Daylight Savings Time, press the DST+ or DST- buttons to adjust the time by 1 hour.

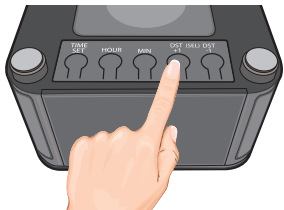

Manual Setting Mode

- 1 Hold SET + HR for 5 seconds to enter setting mode. Press SET to set year, month, date, 12/24 hr mode, hour, min, DST zone and 1-day/7-day alarm mode. Use HR & MIN as + and -. A short press of the SNOOZE button will return to normal time display.



OPERATION

Setting the Alarm Time

- 1 Press the Alarm ON/OFF button. The current alarm time will be displayed. To change the alarm time, press the SET and HR buttons together to set the hours. The Alarm icon will flash in the display.



- 2 Press the SET and MIN button together to set the minutes. When done, wait a few seconds and the Alarm icon will stop flashing.



- 3 To activate the alarm, press the Alarm ON/OFF button once; the unit will beep and the Alarm icon will appear in the display.

OPERATION

Turning Off the Alarm

1

When the alarm is sounding, press the Alarm ON/OFF button to turn it off. It will NOT be set for the next day. If desired, reset alarm following the instructions above.



IMPORTANT ALARM NOTE:

By default (**1-day alarm option**), the alarm will only be activated for one day, then the alarm icon will go off. To reset the alarm each day in this mode, press the Alarm ON/OFF button again. The alarm will be reset and the icon will be displayed. If the **7-day alarm option** has been set (see 'Manual Setting Mode' on page 8), the alarm will repeat daily until de-activated with Alarm ON/OFF button.

Snooze

1

While the alarm is sounding, press the SNOOZE button; the alarm will turn back on automatically 10 minutes later. You can repeat the Snooze function up to three times.

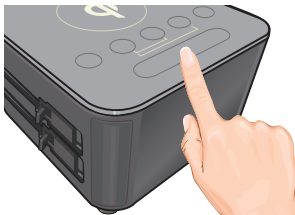

OPERATION

Pairing Via Bluetooth

- 1 Press and release the Bluetooth button on the top of the unit; the button will flash blue and white.



- 2 On the Bluetooth device, enable Bluetooth and select **Kube Audio Clock** from the Device List. It may take a few seconds to appear.

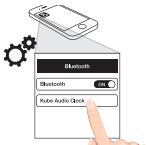

- 3 Some Bluetooth devices will ask you to accept the connection. If the units are paired properly, you will hear the word “connected” and “BT” will appear on the display.



- 4 Start playback on the external device. Adjust the volume using the external device's Volume buttons.

CHARGING

Charging Via Qi Wireless Charging (Optional model)

1

Designed with inductive charging capabilities, this unit allows you to place your **Qi compatible** device on top of the unit for wireless charging. It's that simple! Make sure your device is **Qi compatible** or utilizes a Qi case or other Qi charging option (both available separately), then place the unit on the Qi Wireless Charging logo (orientation as per diagram).

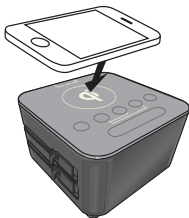

Charging Via Built-in Cables

1

Charge up to three devices using the built-in Charging Cables. Simply pull out the desired connector and insert it into your device.

Apple® Lightning Connector

Used for charging Apple devices that feature a Lightning jack.

Micro USB Connector:

Used for charging devices that utilize the Micro USB jack.
Many Android devices.

USB-C Connector:

Used for charging many of the latest smartphones and accessories.

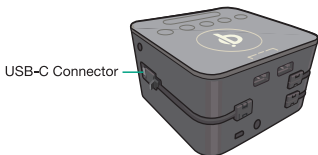
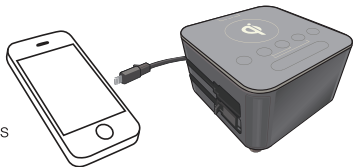

CHARGING

Charging Via USB Ports

1

Charge up to two additional devices using the two USB ports on the rear of the unit.

Each outlet has its own intelligent auto-configuring USB circuit that allows any device to charge properly.

These ports are labeled, “iPod/iPhone” (1A) and “iPad” (2.4A) but can be used to connect most USB cables in order to accommodate different connections.

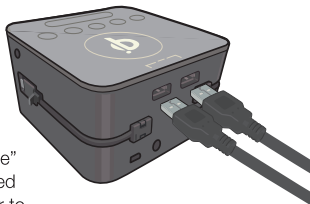

CHARGING CABLES:

The charging cables are replaceable if they become damaged.

Caution: Charging cables do not stretch.

KUBE SYSTEMS

www.kubesystems.com

FCC Caution.

This device complies with part 15 of the FCC Rules. Operation is subject to the following two conditions:

- (1) This device may not cause harmful interference, and
- (2) this device must accept any interference received, including interference that may cause undesired operation.

Any Changes or modifications not expressly approved by the party responsible for compliance could void the user's authority to operate the equipment.

Note: This equipment has been tested and found to comply with the limits for a Class B digital device, pursuant to part 15 of the FCC Rules. These limits are designed to provide reasonable protection against harmful interference in a residential installation. This equipment generates uses and can radiate radio frequency energy and, if not installed and used in accordance with the instructions, may cause harmful interference to radio communications. However, there is no guarantee that interference will not occur in a particular installation. If this equipment does cause harmful interference to radio or television reception, which can be determined by turning the equipment off and on, the user is encouraged to try to correct the interference by one or more of the following measures:

- Reorient or relocate the receiving antenna.
- Increase the separation between the equipment and receiver.
- Connect the equipment into an outlet on a circuit different from that to which the receiver is connected.
- Consult the dealer or an experienced radio/TV technician for help.

This equipment complies with FCC radiation exposure limits set forth for an uncontrolled environment. This equipment should be installed and operated with minimum distance 20cm between the radiator & your body.