

ZT-WE01

User Guide

High-quality stereo bluetooth headphone

ZT-WE01

Please keep and read this manual carefully before use the headphone.

Note the following items:

- 1.Please use the reasonable control of the time and the volume of the headphone.
- 2.If the environment (such as thrunder storm) are potentially dangerous, please stop using to ensure safety.
- 3.Don't use the headphones to listen to music or calling or while driving in potentially dangerous environment, in order to avoid distracting.
- 4.Place the headphone out of the reach of children to avoid improper use may caused deadly danger.
- 5.Do not watering inside the headphone, to avoid sound or electronic damage.
- 6.Continue to increase the volume should be avoided cause you do not hear the sound around,such as tinnitus or turn up the volume to high, please transferred to the appropriate volume.
- 7.Feels obvious discomfort, irritation or other adverse reactions, should stop using immediatly.

Warning:

- 1.While in charging process please don't use, to avoid electrocuted
- 2.Built-in rechargeable battery is not removable. Do not try to remove battery from headphone, otherwise it could be damaged.

Charging:

- 1.While charging ,the headphone power will be shuted down.
- 2.Plug micro usb in the headphone USB jack, then connect with computer usb hub or adaptor. red led lights are always bright.
- 3.Charging time is 2 hours; Blue lights are always bright after full electricity.

Frequently question :

Button have no function:Please use the palyer witch is the smart phone's player .Can't start : take off the USB charging.

ZT-WE01

Function Buttons:

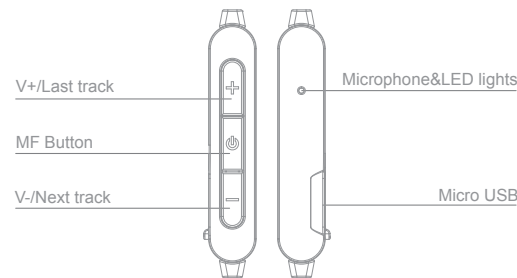

Package list

Stereo Bluetooth Headphone 1PC ZT-WE01 User Manual 1PC
USB Charging Cable 1PC

ON & OFF:

- 1.In the OFF state, press MF button for 2 seconds (Blue LED flash while "POWER ON" voice prompts).
- 2.In the ON state, press MF button for 3 seconds (red LED lighted on while "POWER OFF" voice prompts).

Bluetooth pairing steps:

- 1.Connect Bluetooth headphone to your moblie (or other device used for connection) in the range of 1m
- 2.In the OFF state, press MF button for 5 seconds ,noted "POWER ON" and "Pairing"then open the Bluetooth function of your mobile.
- 3.Search and choose "ZETVA WE01"to connect.

PS. NOTE:

- 1.If headphone had paired ,under the off states press MF button" for 2 seconds to power on it will reconnect the last used device automatically , also if the headphone have no device to reconnect ,after 10 seconds it enter the pairing mode automatically, it good at use a new device to pair, absolutely you can press "MF button" for 5 seconds to enter the pairing mode directly then repeat the up.

ZT-WE01

Function Buttons:

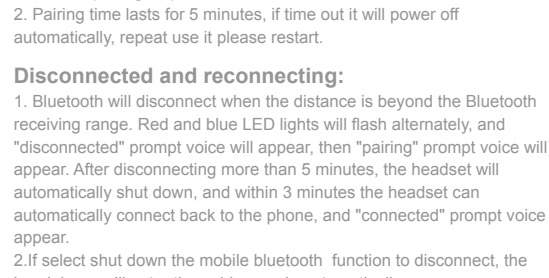

Package list

Stereo Bluetooth Headphone 1PC ZT-WE01 User Manual 1PC
USB Charging Cable 1PC

ON & OFF:

- 1.In the OFF state, press MF button for 2 seconds (Blue LED flash while "POWER ON" voice prompts).
- 2.In the ON state, press MF button for 3 seconds (red LED lighted on while "POWER OFF" voice prompts).

Bluetooth pairing steps:

- 1.Connect Bluetooth headphone to your moblie (or other device used for connection) in the range of 1m
- 2.In the OFF state, press MF button for 5 seconds ,noted "POWER ON" and "Pairing"then open the Bluetooth function of your mobile.
- 3.Search and choose "ZETVA WE01"to connect.

PS. NOTE:

- 1.If headphone had paired ,under the off states press MF button" for 2 seconds to power on it will reconnect the last used device automatically , also if the headphone have no device to reconnect ,after 10 seconds it enter the pairing mode automatically, it good at use a new device to pair, absolutely you can press "MF button" for 5 seconds to enter the pairing mode directly then repeat the up.

ZT-WE01

Function Buttons:

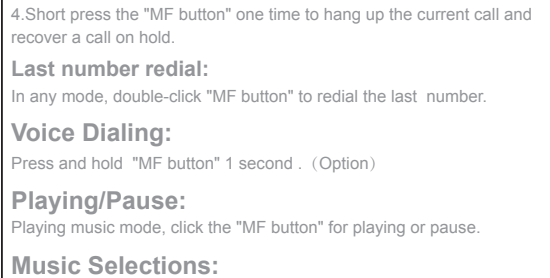

Package list

Stereo Bluetooth Headphone 1PC ZT-WE01 User Manual 1PC
USB Charging Cable 1PC

ON & OFF:

- 1.In the OFF state, press MF button for 2 seconds (Blue LED flash while "POWER ON" voice prompts).
- 2.In the ON state, press MF button for 3 seconds (red LED lighted on while "POWER OFF" voice prompts).

Bluetooth pairing steps:

- 1.Connect Bluetooth headphone to your moblie (or other device used for connection) in the range of 1m
- 2.In the OFF state, press MF button for 5 seconds ,noted "POWER ON" and "Pairing"then open the Bluetooth function of your mobile.
- 3.Search and choose "ZETVA WE01"to connect.

PS. NOTE:

- 1.If headphone had paired ,under the off states press MF button" for 2 seconds to power on it will reconnect the last used device automatically , also if the headphone have no device to reconnect ,after 10 seconds it enter the pairing mode automatically, it good at use a new device to pair, absolutely you can press "MF button" for 5 seconds to enter the pairing mode directly then repeat the up.

ZT-WE01

Function Buttons:

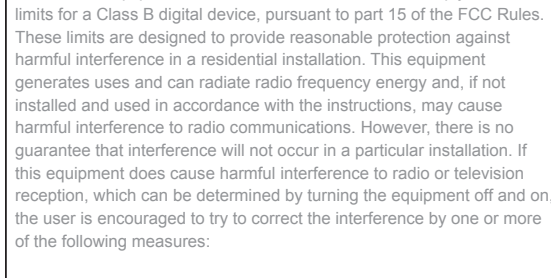

Package list

Stereo Bluetooth Headphone 1PC ZT-WE01 User Manual 1PC
USB Charging Cable 1PC

ON & OFF:

- 1.In the OFF state, press MF button for 2 seconds (Blue LED flash while "POWER ON" voice prompts).
- 2.In the ON state, press MF button for 3 seconds (red LED lighted on while "POWER OFF" voice prompts).

Bluetooth pairing steps:

- 1.Connect Bluetooth headphone to your moblie (or other device used for connection) in the range of 1m
- 2.In the OFF state, press MF button for 5 seconds ,noted "POWER ON" and "Pairing"then open the Bluetooth function of your mobile.
- 3.Search and choose "ZETVA WE01"to connect.

PS. NOTE:

- 1.If headphone had paired ,under the off states press MF button" for 2 seconds to power on it will reconnect the last used device automatically , also if the headphone have no device to reconnect ,after 10 seconds it enter the pairing mode automatically, it good at use a new device to pair, absolutely you can press "MF button" for 5 seconds to enter the pairing mode directly then repeat the up.

NOTE: This equipment has been tested and found to comply with the limits for a Class B digital device, pursuant to part 15 of the FCC Rules. These limits are designed to provide reasonable protection against harmful interference in a residential installation. This equipment generates uses and can radiate radio frequency energy and, if not installed and used in accordance with the instructions, may cause harmful interference to radio communications. However, there is no guarantee that interference will not occur in a particular installation. If this equipment does cause harmful interference to radio or television reception, which can be determined by turning the equipment off and on, the user is encouraged to try to correct the interference by one or more of the following measures:

- Reorient or relocate the receiving antenna.
- Increase the separation between the equipment and receiver.
- Connect the equipment into an outlet on a circuit different from that to which the receiver is connected.
- Consult the dealer or an experienced radio/TV technician for help

Changes or modifications not expressly approved by the party responsible for compliance could void the user's authority to operate the equipment. This device complies with Part 15 of the FCC Rules. Operation is subject to the following two conditions:
(1) this device may not cause harmful interference, and
(2) this device must accept any interference received, including interference that may cause undesired operation.