

PHILIPS

Soundbar 7.1.2

Fidelio B97

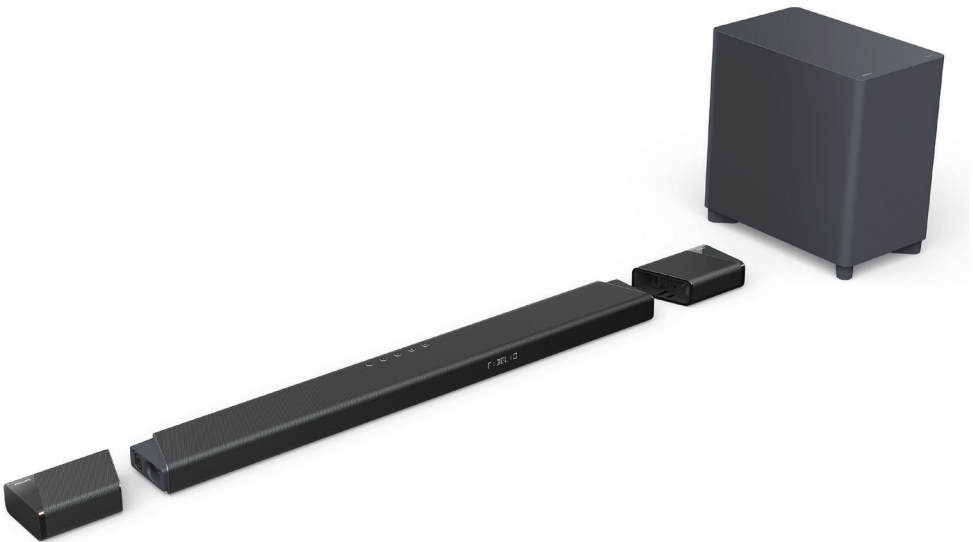

User manual

Register your product and get support at
www.philips.com/support

Contents

Contents	1
-----------------	----------

1 Important	2
Safety	2
Care for your product	3
Care of the environment	3
Compliance	3
Help and support	3

2 Your product	4
What's in the box	4
Main unit	4
Remote control	4
Wireless portable speakers	5
Wireless subwoofer	6
Connectors	6

3 Connect and set up	7
Placement	7
Connect to TV	8
Connect TV or digital devices through HDMI	8
Connect audio from TV or other devices	9
Connect to power	9
Pair up with the subwoofer	9
Pair up with portable speakers	10
Charge portable speakers	10
Connect to Wi-Fi (wireless network)	11

4 Use your product	11
Insert batteries before using the remote control	11
Adjust the volume	11
Choose your sound	12
Dolby Atmos®	13
Play audio through Bluetooth	13
MP3 player	14
Play-Fi wireless surround mode	15

5 Settings	15
Adjust speaker level	15
Set display brightness	15
Auto standby	16
Apply factory settings	16

6 Update software	16
Check software version	16
Update software via USB	16
Update software via Wi-Fi	17

7 Wall mount your product	17
Wall mount	17

8 Specifications	18
-------------------------	-----------

9 Troubleshooting	20
--------------------------	-----------

1 Important

Read and understand all instructions before you use your product. If damage is caused by failure to follow instructions, the warranty does not apply.

Safety

Risk of electric shock or fire!

- Before you make or change any connections, make sure that all devices are disconnected from the power outlet.
- Never expose the product and accessories to rain or water. Never place liquid containers, such as vases, near the product. If liquids are spilled on or into the product, disconnect it from the power outlet immediately. Contact Consumer Care to have the product checked before use.
- Never place the product and accessories near naked flames or other heat sources, including direct sunlight.
- Never insert objects into the ventilation slots or other openings on the product.
- Where the mains plug or an appliance coupler is used as the disconnect device, the disconnect device shall remain readily operable.
- Batteries (battery pack or batteries installed) shall not be exposed to excessive heat such as sunshine, fire or the like.
- Disconnect the product from the power outlet before lightning storms.
- When you disconnect the power cord, always pull the plug, never the cable.
- Use the product in tropical and/or moderate climates.

Risk of short circuit or fire!

- For identification and supply ratings, see the type plate at the back or bottom of the product.
- Before you connect the product to the power outlet, ensure that the power voltage matches the value printed on the back or bottom of the product. Never connect the product to the power outlet if the voltage is different.

Risk of injury or damage to this product!

- For wall mounting, this product must be securely attached to the wall in accordance with the installation instructions. Use only the supplied wall mount bracket (if available). Improper wall mounting may result in accident, injury or damage. If you have any query, contact Consumer Care in your country.
- Never place the product or any objects on power cords or on other electrical equipment.
- If the product is transported in temperatures below 5°C, unpack the product and wait until its temperature matches room temperature before connecting it to the power outlet.
- Parts of this product can be made of glass. Handle with care to avoid injury and damage.

Risk of overheating!

- Never install this product in a confined space. Always leave a space of at least four inches around the product for ventilation. Ensure curtains or other objects never cover the ventilation slots on the product.

Risk of contamination!

- Do not mix batteries (old and new or carbon and alkaine, etc.).
- Danger of explosion if batteries are incorrectly replaced. Replace only with the same or equivalent type.
- Remove batteries if they are exhausted or if the remote control is not to be used for a long time.
- Batteries contain chemical substances, they should be disposed of properly.

Risk of swallowing batteries!

- The product/remote control may contain a coin/button type battery, which can be swallowed. Keep the battery out of reach of children at all times! If swallowed, the battery can cause serious injury or death. Severe internal burns can occur within two hours of ingestion.
- If you suspect that a battery has been swallowed or placed inside any part of the body, seek immediate medical attention.
- When you change the batteries, always keep all new and used batteries out of reach of children. Ensure that the battery compartment is completely secure after you replace the battery.

- If the battery compartment cannot be completely secured, discontinue use of the product. Keep out of reach of children and contact the manufacturer.



This is CLASS II apparatus with double insulation, and no protective earth provided.



AC voltage



Use only the power supplies listed in the user manual.

Care for your product

Use only microfiber cloth to clean the product.

Care of the environment

Disposal of your old product and battery



Your product is designed and manufactured with high quality materials and components, which can be recycled and reused.



This symbol on a product means that the product is covered by European Directive 2012/19/EU.



This symbol means that the product contains batteries covered by European Directive 2013/56/EU which cannot be disposed of with normal household waste.

Inform yourself about the local separate collection system for electrical and electronic products and batteries. Follow local rules and never dispose of the product and batteries with normal household waste. Correct disposal of old products and batteries helps prevent negative consequences for the environment and human health.

Removing the disposable batteries

To remove the disposable batteries, see battery installation section.

Compliance

This product complies with the radio interference requirements of the European Community. Hereby, MMD Hong Kong Limited declares that this product is in compliance with the essential requirements and other relevant provisions of Directive 2014/53/EU. You can find the Declaration of Conformity on www.p4c.philips.com.

Help and support

For extensive online support, visit www.philips.com/support to:

- download the user manual and the quick start guide
- watch video tutorials (available only for selected models)
- find answers to frequently answered questions (FAQs)
- email us a question
- chat with our support representative.

Follow the instructions on the website to select your language, and then enter your product model number:

Alternatively, you can contact Consumer Care in your country. Before you contact, note down the model number and serial number of your product. You can find this information on the back or bottom of your product.

2 Your product

Congratulations on your purchase, and welcome to Philips! To fully benefit from the support that Philips offers (e.g. notification of product software upgrade), register your product at www.philips.com/welcome.

What's in the box

Check and identify the items in the package:

- Soundbar x1
- Wireless portable speaker x2
- Wireless subwoofer x1
- Remote control x1
- Power cord* x2
- Wall mount kit (wall bracket x2, screws x 2, dowel x2)
- Quick start guide
- Warranty card
- Safety sheet

*Power cord quantity and plug type vary by regions.

Main unit

This section includes an overview of the main unit.

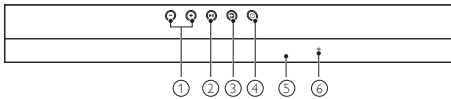









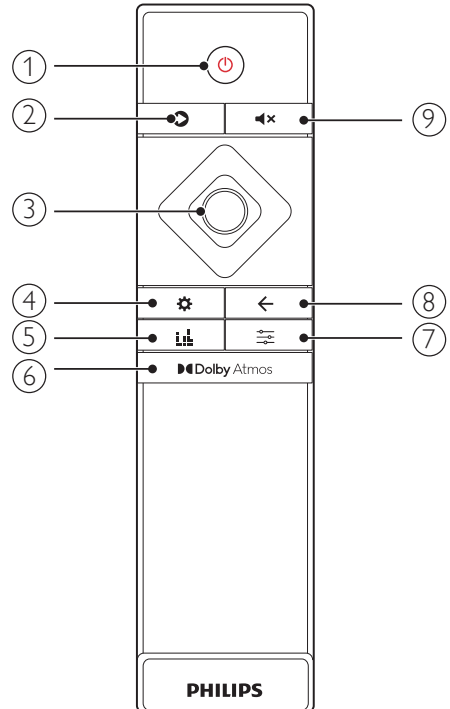

- 1 +/- (Volume)**
Increase or decrease volume.
- 2 ▶|| (Play/Pause)**
Play, pause or resume in Bluetooth/USB playback.
- 3 ↻ (Source)**
 - Press to select an input source for this product.
 - Press and hold for 3 seconds to enter the Bluetooth pairing mode.

- 4 ⏻ (Standby-On)**
Switch this product on or to standby.
- 5 Display panel**
- 6 Power LED indicator**
 - Turns white when in Eco standby (network disconnected).
 - Turns amber when in semi standby (network connected).
 - Blinks fast when in Bluetooth pairing mode.
- 7 Wi-Fi LED indicator**
 - Turns yellow when connected to Wi-Fi.
 - Slowly blinks in yellow when connecting to Wi-Fi.

Remote control

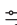
This section includes an overview of the remote control.



- 1  (Standby-On)
Switch this product on or to standby.
- 2  (Source)
Select an input source for this product.
 - **HDMI 1:** Switch your source to the HDMI IN 1 connection.
 - **HDMI 2:** Switch your source to the HDMI IN 2 connection.
 - **E-ARC:** Switch your source to HDMI ARC (E-ARC) connection.
 - **OPTICAL:** Switch your audio source to the optical connection.
 - **AUDIO IN:** Switch your audio source to AUDIO IN connection (3.5mm jack).
 - **USB:** Switch to USB mode.
 - **BT:** Switch to Bluetooth mode.
- 3 **Navigation buttons**
 - Up: Increase volume or select the previous item in the menu.
 - Down: Decrease volume or select the next item in the menu.
 - Left: Skip to the previous track in Bluetooth/USB mode or select level down in the menu.
 - Right: Skip to the next track in Bluetooth/USB mode or select level up in the menu.
 - Center: Play, pause or resume in Bluetooth/USB mode. Confirm a selection.
- 4  (Menu)
Enter the general settings menu.
- 5  (Surround sound)
Select surround sound modes (Movie/Music/Voice/Sport/Custom).
- 6  Dolby Atmos
Select a height effect level for Dolby Atmos.
- 7  (Sound)
Select sound settings (Surround/IMAX/Bass/Treble/Sync).
- 8 
Exit settings.
- 9  
Mute or restore volume.

Wireless portable speakers

This product comes with two wireless portable speakers (left and right).

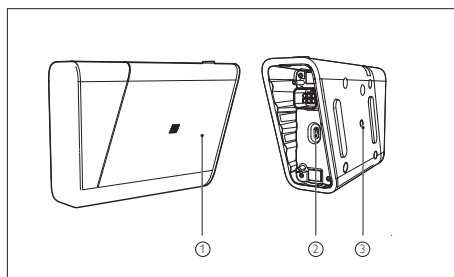

*The illustration above is for overview of the left portable speaker:

1 Speaker LED

- Blinks in red and orange alternatively if the portable speaker is not wirelessly connected to the main unit.
- Lights up white when the portable speaker is wirelessly connected to the main unit, or when the battery capacity is full or more than 30% remaining.
- Lights up red when the battery capacity is less than 30% remaining.
- Blinks red when the battery capacity is less than 10% remaining.
- Lights up orange when the portable speaker is being charged (only for the portable speakers docked into the main unit).

2 USB-C charging port

3 Power button

- Press to turn on the portable speaker if it automatically goes to standby.
- Press and hold to switch the portable speaker to standby.

Wireless subwoofer

This product comes with a wireless subwoofer:

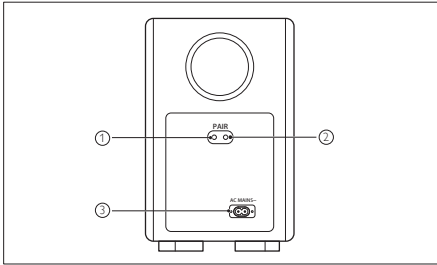

- 1 PAIR (Pair)**
Press and hold to enter the pairing mode between the main unit and the subwoofer.
- 2 Subwoofer indicator**
 - When the power is turned on, the indicator lights up.
 - During wireless pairing between the subwoofer and the main unit, the indicator blinks white quickly.
 - When the pairing succeeds, the indicator lights up white.
 - When the pairing fails, the indicator blinks white slowly.
 - When the wireless connection is disconnected for 1 minute, the indicator turns off.
- 3 AC MAINS~**
Connect to the power supply.

Connectors

This section includes an overview of the connectors available on the main unit.

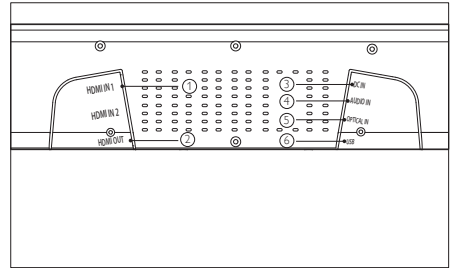

- 1 HDMI IN 1 / HDMI IN 2**
Connect to the HDMI output on a digital device.
- 2 HDMI OUT**
Connect to the HDMI (ARC) input on the TV.
- 3 DC IN**
Connect to the power supply.
- 4 AUDIO IN**
Connect to an audio output (3.5mm jack) on a device.
- 5 OPTICAL IN**
Connect to an optical audio output on the TV or a digital device.

3 Connect and set up

This section helps you connect this product to a TV and other devices, and then set it up. For information about the basic connections of this product and accessories, see the quick start guide.

Note

- For identification and supply ratings, see the type plate at the back or bottom of the product.
- Before you make or change any connections, make sure that all devices are disconnected from the power outlet.

Placement

Place the subwoofer at least 1 meter (3 feet) away from the main unit, and 10 centimeters (4 inches) away from the wall. For best sound effect, position all the speakers towards the seating position and place them close to your ear level (seated).

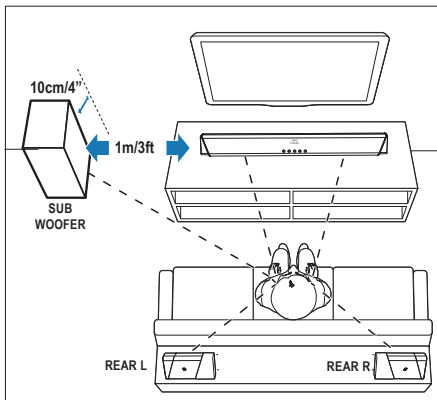

Note

- Surround sound depends on factors such as room shape and size, type of wall and ceiling, windows and reflective surfaces, and speaker acoustics. Experiment with the speaker positions to find the optimum setting for you.

Follow these general guidelines for speakers placement.

- 1 Seating position: This is the center of your listening area.
- 2 Place the main unit in front of the seating position.
- 3 **REAR L** (rear left) and **REAR R** (rear right): Place the wireless portable speakers (surround) to the left and right side of your seating position, either in line with it or slightly behind it.
- 4 **SUBWOOFER** (subwoofer): Place the subwoofer at least 1 meter to the left or right of the TV. Leave about 10-centimeter clearance from the wall.

Dock the portable speakers

You can also dock the wireless portable left and right speakers into the main unit to listen to audio, for example, watching TV shows and news.

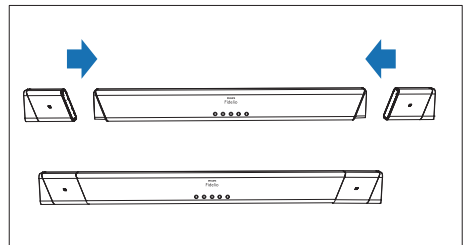

Connect to TV

Connect this product to your TV. You can enjoy audio from TV programs through the soundbar speaker. Use the best quality connection available on your soundbar speaker and TV.

Connect to TV through HDMI (ARC/eARC)

This product supports HDMI with eARC (Enhance Audio Return Channel). eARC is a new function standardized by HDMI 2.1 and supports the latest audio formats in addition to audio formats that are supported with existing ARC (Audio Return Channel). If your TV is HDMI eARC compliant, you can enjoy the TV audio that ARC cannot transfer, such as Dolby Atmos-Dolby TrueHD and DTS:X, or multi-channel LPCM contents, by using a single HDMI cable.

What you need

- A High-Speed HDMI cable.
- Your TV supports both HDMI ARC and HDMI-CEC (see the TV user manual for details).
- For some TV models, enable the external speaker output from the TV setting menu (see the TV user manual for details).

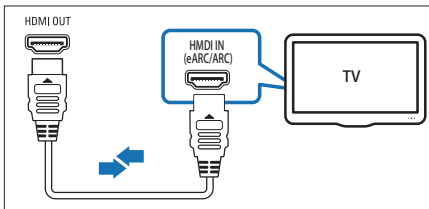

- 1 Using a High Speed HDMI cable, connect the **HDMI OUT** connector on this product to the **HDMI ARC** connector on your TV.
 - The **HDMI ARC** connector on the TV might be labeled differently. For details, see the TV user manual.

- 2 On your TV, turn on the HDMI-CEC operations. For details, see the TV use manual.
- 3 Repeatedly press the source button until **E-ARC** displays on the display panel.

Note

- Your TV must support the HDMI-CEC and ARC function and you must enable them.
- 100% interoperability with all HDMI-CEC devices is not guaranteed.
- Only HDMI 2.1 compatible cables can support the eARC function.
- If your TV is not HDMI ARC compliant, connect an audio cable then enjoy the TV audio through this product.

Connect TV or digital devices through HDMI

If your TV is not HDMI ARC-compliant, connect your soundbar to the TV through a standard HDMI connection. You can also connect a digital device such as a set-top box, DVD/Blu-ray player, or games console to this product through a single HDMI connection. When you connect the devices in this way and play a file or game, the

- video is automatically displayed on your TV, and
- audio is automatically played on this product.

- 1 Using a High-Speed HDMI cable, connect the **HDMI OUT** connector on your digital device to the **HDMI IN 1/2** on this product.
- 2 Connect this product to TV through **HDMI OUT**.

If the TV is not HDMI CEC compliant, select the correct video input on your TV.
- 3 On the connected device, turn on HDMI-CEC operations. For details, see the user manual of the device.

Connect audio from TV or other devices

Play audio from TV or other devices through this product.

Use the best quality connection available on your TV, soundbar, and other devices.

Note

- When this product and TV are connected through HDMI ARC, an audio connection is not required.

Option 1: Connect audio through a digital optical cable

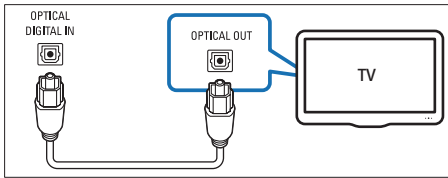

- Using an optical cable, connect the **OPTICAL IN** connector on this product to the **OPTICAL OUT** connector on the TV or other devices.
 - The digital optical connector might be labeled **OPTICAL OUT**, **SPDIF** or **SPDIF OUT**.
- Repeatedly press the source button until **OPTICAL** displays on the display panel.

Option 2: Connect audio through an analog audio cable

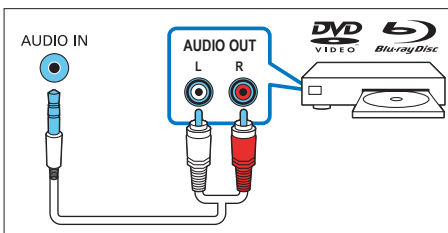

- Using an analog cable, connect the **AUDIO IN** connector on this product to the **AUDIO OUT** connector or analog audio output connectors (red and white) on TV or other devices.
- Repeatedly press the source button until **AUDIO IN** displays on the display panel.

Connect to power

- Before connecting to the AC power cord, make sure that you have completed all other connections.
- Risk of product damage! Make sure that the power supply voltage corresponds to the voltage printed on the back or the underside of the main unit.
- Connect the mains cable to the AC~ socket of the main unit and then into a mains socket.
- Connect the mains cable to the AC~ socket of the subwoofer and then into a mains socket.

Pair up with the subwoofer

Automatic pairing

The wireless subwoofer automatically pairs up with the main unit for wireless connection when you turn on the main unit and the subwoofer:

Determine the status based on the wireless subwoofer indicator:

LED behavior	Status
Fast blink	Subwoofer in pairing mode
Constant on	Connected / Pairing successfully
Slow blink	Connecting / Pairing failed

Note

- Do not press the **PAIR** (Pair) button on the rear of the subwoofer, except for manual pairing.

Manual pairing

If no audio from the subwoofer can be heard, manually pair up the subwoofer:

- 1 Unplug both the main unit and the subwoofer from the mains sockets, then plug them in again after 3 minutes.
- 2 Press and hold the **PAIR** (Pair) button on the rear of the subwoofer for a few seconds.
- 3 Press **⏻** on the main unit or remote control to switch the main unit on.
 - ↳ The indicator on the subwoofer blinks white quickly and **SBW PAIRING** displays on the display panel.
 - ↳ If the pairing succeeds, the indicator on the subwoofer lights up white and **SBW PAIRED** displays on the display panel.
- 4 If the pairing fails, **CHK SBW** displays on the display panel. Repeat the steps above.

Note

- The subwoofer should be within 6 meters from the main unit in an open area (the closer the better).
- Remove any obstacles between the subwoofer and the main unit.
- If the wireless connection fails again, check if there is a conflict or strong interference (e.g. interference from an electronic device) around the location. Remove them and try again.
- If the wireless dis-connection or pairing lasts for 1 minute, the subwoofer automatically switches to standby and the LED on the subwoofer turns off.

Pair up with portable speakers

The portable speakers automatically pair up with the main unit for wireless connection when you turn on the main unit, and the wireless portable speakers,

Manual pairing

If no audio from the portable speakers can be heard, manually pair up the portable speakers.

- 1 Turn on the main unit and the portable speakers.
 - ↳ If the connection to the main unit is lost, the LED on the portable speaker blinks red.
- 2 Dock the portable left and right speakers into the main unit to pair up automatically.
 - ↳ If the pairing succeeds, **SL PAIRED** (surround left speaker) and **SR PAIRED** (surround right speaker) display on the display panel.
- 3 If the pairing fails, re-dock the portable speakers into the main unit.

Charge portable speakers

If the portable left/right speaker is undocked from the main unit, its battery level is indicated by the LED on the speaker:

- Light up white: full battery or more than 20% capacity remaining
- Flash red: low battery level, less than 20% capacity remaining
- Flash red and turn off: near empty, less than 10% capacity remaining

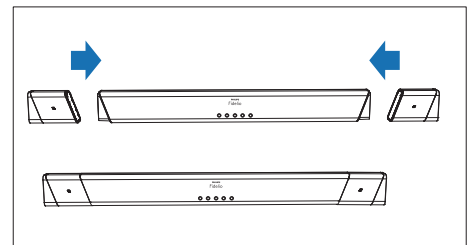

- 1 Dock your portable speakers into the main unit to charge.
- 2 Turn on the main unit.

- ☒ During charging, the LED on the portable speaker lights up red.
- ☒ When fully charged, the LED on the portable speaker turns off.

Note

- You can also charge the portable speakers through the USB-C charging port by using a USB-C charging cable.
- It may take around 2 hours to fully charge the portable speakers.
- Battery performance varies due to many factors including volume, sound setting and media played.

Connect to Wi-Fi (wireless network)

Connect this product to Wi-Fi through the Play-Fi app.

Note

- This product is Wi-Fi enabled by default when turned on.
- Make sure that your wireless router (Wi-Fi) is ready and working properly.
- Make sure that your TV and this product are connected to the same wireless network (Wi-Fi).

- 1 Out of the box, this main unit (Play-Fi module) will boot up as a Wi-Fi AP.
- 2 Connect your mobile device (smartphone, tablet, etc.) to the Wi-Fi network to which this product is connected
- 3 Download and launch the Play-Fi app on your mobile device.



- 4 Follow the instructions in the Play-Fi app to connect this product to your Wi-Fi network.

Wi-Fi LED behavior	Status
Constant on	Connected
Blink	Connecting

4 Use your product

This section helps you use this product to play media contents from all sources.

Before you start

- Make the necessary connections described in the quick start guide and the user manual.
- Switch this product to the correct source for other devices.

Insert batteries before using the remote control

Slide to remove the battery compartment cover, insert 2 AAA batteries (1.5V) with correct polarity, then slide the battery compartment cover back into position.

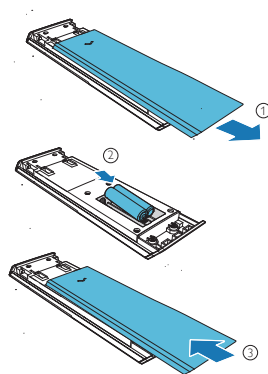

Adjust the volume

Press **+/-** (Volume) to increase or decrease a volume level.

- To mute sound, press **⏏**.
- To restore the sound, press **⏏** again or press **+/-** (Volume).

Choose your sound

This section helps you choose the ideal sound for your video or music.

Sound mode

Select predefined sound modes to suit your video or music.

Press  on the remote control to select a surround sound mode.

- **MOVIE:** Create a surround listening experience. Ideal for watching movies.
- **MUSIC:** Create two-channel or multi-channel stereo sound. Ideal for listening to music.
- **VOICE:** Create sound effect which makes human voice more clear and outstanding for listening.
- **SPORT:** Create an atmosphere as if watching a sports game in a stadium.
- **CUSTOM:** Customize the sound based on your preferences.

Equalizer

Change the low frequency (bass) and high frequency (treble) settings of this product.

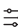
Repeatedly press  to select **BASS** or **TREBLE**, then press the left and right navigation buttons to change the bass or treble level.

IMAX

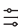
Repeatedly press  to select **IMAX**, then press the left and right navigation buttons to set IMAX mode on or off.

Surround

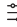
Repeatedly press  to select **SURR**, then press the left and right navigation buttons to select audio upmix options.

- **UPMIX:** Make sure that all speakers are utilized for contents less than 5.1.2 or 7.1.2 speaker configuration.
- **STANDARD:** Original sound.
- **AI SURR:** The media intelligence function of Dolby Atmos for home audio is utilized to drive the vocal enhancement or surround effects.

Dynamic Range Control (DRC)

You can apply dynamic range control to Dolby Digital tracks.

Repeatedly press  to select **DRC**, then press the left and right navigation buttons to turn DRC on, off or auto.

Note

- DRC is not available in USB/BT/AUDIO IN/Play-Fi mode.

Dialogue mode

Dialogue mode improves the clarity of dialogue and vocals in movies, TV programs and podcasts by adjusting the tonal balance of this product.

Repeatedly press  to select **DIALOGUE**, then press the left and right navigation buttons to adjust dialogue level.

Synchronize video and sound

If the audio and video are not synchronized, delay the audio to match the video.

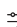
Repeatedly press  to select **SYNC**, then press the left and right navigation buttons to synchronize the audio with the video.

Dolby Atmos®

In addition to horizontal distribution of 5-channel audio, this product also has built-in Dolby Atmos enabled speakers as additional audio channels to generate overhead distribution of audio for powerful delivery of 3D sound immersion and greater reality.

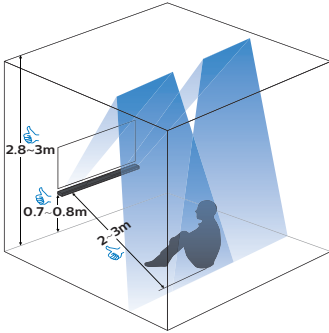

Optimal setup for Dolby Atmos sound

- Place this product at a height of 0.7m-0.8m.
- Ceiling height is 2.8m-3m.
- Listening distance from this product is 2m-3m.
- Ceiling is not made of sound absorbent material.
- Preferably no protrusive objects (such as lighting and decorations) are on the ceiling.

Dolby Atmos® is available only in HDMI mode. For the details of the connection, please refer to “Connect to TV”. Best Dolby Atmos effects may be achieved through the following two use cases.

From your Blu-ray disc player:

- Movie with Dolby Atmos.
- Your Blu-ray disc player is connected to this product via **HDMI IN 1/2** connector.
- On your Blu-ray disc player, enable bitstream/raw audio format for HDMI sound output.
- A high-speed HDMI cable.

From your TV:

- Movie with Dolby Atmos.
- Your TV supports Dolby Atmos bitstream/raw output.
- Your TV is connected to this product via **HDMI OUT** connector.
- A high-speed HDMI cable.

Note

- The full Dolby Atmos experience is only available when the soundbar is connected to the source via a HDMI 2.0 cable.
- The soundbar will still work when connected via other methods (such as a digital optical cable) but these are unable to support all the Dolby features. To ensure full Dolby support, you are strongly recommended to connect via HDMI.

Enjoy Dolby Atmos sound

Press **Dolby Atmos** to select a height surround effects level to best suit your personal taste according to your environment.

- **ATMOS 00**: no height effect.
- **ATMOS 01**: small height effect.
- **ATMOS 02**: medium height effect.
- **ATMOS 03**: big height effect.

Note

- For non-HDMI connections (such as use of USB, Bluetooth, OPTICAL or AUDIO IN), only limited height surround effects are generated.

Play audio through Bluetooth

Through Bluetooth, connect this product with your Bluetooth device (such as an iPhone, iPad, Android phone, or Android pad), and then you can enjoy the audio files stored on the device through the speakers of this product.



Note

- The maximum operational range between this product and a Bluetooth device is approximately 10 meters (30 feet).
- The music streaming may be interrupted by obstacles between the device and this product, such as wall, metallic casing that covers the device, or other devices nearby that operate in the same frequency.
- If you want to connect this product with another Bluetooth device, break the current Bluetooth connection first.

- 1 Repeatedly press the source button to switch the main unit to Bluetooth mode, or press and hold the source button for 3 seconds to enter the Bluetooth pairing mode.
 - ↳ **BT PAIRING** displays on the display panel.
- 2 On the Bluetooth device, turn on Bluetooth, search for and select "**Fidelio B97**" to start connection.
 - ↳ During the connection, **BT** blinks on the display panel.
- 3 Wait until this product beeps.
 - ↳ When the Bluetooth connection succeeds, **BT** displays on the display panel.
 - ↳ If the connection fails, **BT** blinks continuously on the display panel.
- 4 Select and play audio files or music on your Bluetooth device.
- 5 To exit Bluetooth, select another source.
 - When you switch back to Bluetooth mode, Bluetooth connection remains active.

MP3 player

Connect your MP3 player to play your audio files or music.

What you need

- An MP3 player.
- A 3,5mm stereo audio cable.

- 1 Using the 3.5mm stereo audio cable, connect the MP3 player to the **AUDIO IN** connector on this product.
- 2 Repeatedly press the source button until **AUDIO IN** displays on the display panel.
- 3 Press the buttons on your MP3 player to select and play audio files or music.

Play-Fi wireless surround mode

With DTS Play-Fi, your soundbar can be paired with multiple Play-Fi enabled speakers as wireless surround speakers. You can wirelessly listen to the same music in every room of your house.



Note

- The wireless surround mode is set up via the Play-Fi app.
- Play-Fi wireless surround mode is primarily used for HDMI and ARC audio sources.
- In wireless surround mode, the front channel audio of the soundbar may be delayed up to 150ms, therefore this mode is not suitable for gaming where low audio and video latencies are desired.

You can cast music stream to this soundbar via

Apps / OS

- Play-Fi app
- Spotify app
- Chromecast enabled apps
- AirPlay2 (iOS devices)

Voice

- Google Assistant GoogleCast for Audio
- Alexa
- Siri
- Cast from apps that supports GoogleCast for Audio

5 Settings

Adjust speaker level

Repeatedly press **⚙** to enter the settings menu, select the speakers below and press the left and right navigation buttons to adjust the speaker level

- **FRT L** (front left speaker)
- **FRT R** (front right speaker)
- **CTR** (center speaker)
- **TOP L** (top left speaker)
- **TOP R** (top right speaker)
- **SIDE L** (side left speaker)
- **SIDE R** (side right speaker)
- **SBW** (subwoofer)

Set display brightness

Repeatedly press **⚙** to enter the settings menu, select **DIM** and press the left and right navigation buttons to adjust the brightness level of the display panel on this product.

- **HIGH** (high)
- **MID** (medium)
- **LOW** (low)

Display auto off

Repeatedly press **⚙** to enter the settings menu, select **DISP** and press the left and right navigation buttons to select **DISP ON** or **DISP OFF**.

Auto standby

When playing media from a connected device, this product automatically switches to standby if:

- no source button is pressed for 15 minutes, and
- no audio/video playback is detected from a connected device.

Apply factory settings

In case of no response from this product, you can reset this product to the default settings programmed at the factory.

In standby mode, press and hold **VOL +/-** buttons on the main unit simultaneously for 8 seconds until **RESET** displays on the display panel.

When the factory settings restore is complete, the product automatically turns off and restarts.

6 Update software

To get the best features and support, update your product with the latest software.

Check software version

In standby mode, press and hold  and **VOL-** buttons simultaneously for 3 seconds, then press **VOL+/-** to show the next/previous version.

- ↳ The software version number displays on the display panel.

Update software via USB



Caution

- Do not turn off the power or remove the USB flash drive when the software update is in progress because you might damage this product.
- The upgrade time may take around 8 minutes.

- 1 In standby mode, plug the USB flash drive into the USB port of this product.
- 2 Press and hold  and **VOL+** buttons simultaneously for 3 seconds.
 - ↳ “FW UPG” (firmware upgrade) displays on the display panel.
- 3 Wait until the upgrade is completed.
 - ↳ If the upgrade is complete, this product automatically turns off and on again.

Update software via Wi-Fi

Once this product is connected to Wi-Fi, it will receive a periodic over-the-air software update to improve performance. Always upgrade with the latest firmware version to improve the functionality and features of this product.

If a new wireless version is detected, proceed with the wireless upgrade.

↳ "OTA XXXX" displays on the display panel.

7 Wall mount your product

Before you mount your product on the wall, read all safety precautions. (see 'Safety')

Wall mount



Note

- Improper wall mounting may result in accident, injury or damage. If you have any query, contact Consumer Care in your country.
- Secure the wall mount to a wall that can support the combined weight of the product and the wall mount.
- Before wall mount, you need not remove the four rubber feet at the bottom of the main unit, otherwise the rubber feet cannot be fixed back.

Screw length/diameter

Depending on the type of wall mounting this wall mount bracket, make sure that you use screws of a suitable length and diameter:

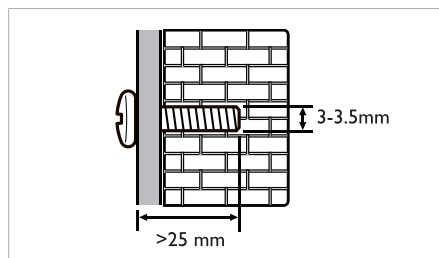

See the illustration on the separate wall mount sheet on how to wall mount the main unit.

- 1) Drill 2 holes on the wall.
- 2) Secure the wall bracket on the wall with the dowels and screws.
- 3) Hang the main unit on the wall bracket.

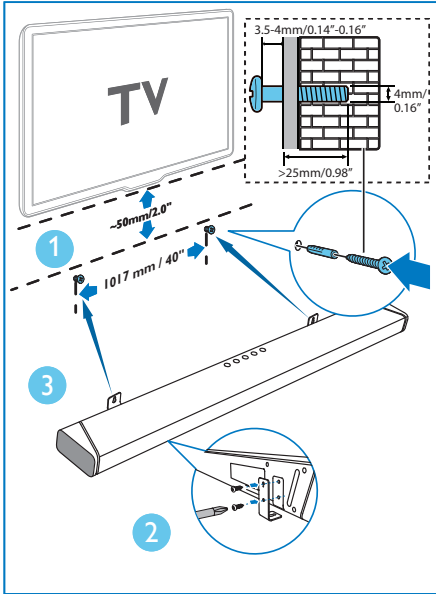

8 Product specifications only for EU

Note

- Specifications and design are subject to change without notice.

Amplifier

- Total output power: 260W RMS (10% THD)
- Frequency response: 20 Hz-20 kHz / ± 3 dB
- Signal-to-noise ratio: >65 dB (CCIR) / (A-weighted)
- Input sensitivity: AUDIO IN: 900 mV

Audio

- S/PDIF Digital audio input:
- Optical: TOSLINK

Bluetooth

- Bluetooth profile: A2DP, AVRCP
- Bluetooth version: 5.0
- Frequency band/Output power: 2402 MHz ~ 2480 MHz / ≤ 8 dBm
- 5.8G wireless frequency range: 5728.35MHz ~ 5825.35MHz
- 5.8G wireless maximum power: 13 dBm

Wi-Fi

- Wi-Fi IEEE 802.11 a/b/g/n
- Frequency band: 2.412 - 2.472 GHz, 5.18 - 5.24GHz, 5.745 - 5.825GHz
- Radio frequency power transmitted: WiFi 2.4G: 13dBm; WiFi 5G: 15dBm; WiFi 5.8G: 14dBm

Main unit

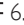
- Power supply: Model (Philips branded AC power adapter): NSA120EC-19063200
- Input: 100-240V~, 50/60 Hz, 2.0 A
- Output: 19 V  6.32 A
- Power consumption: 25 W
- Standby power consumption: <0.5 W
- Audio channel: 7.1.2
- Built-in speakers:
- Central: 2 racetracks full range drivers
- Front speaker: 4 full range drivers + 2 tweeters (L+R)
- Up-firing: 2 full range drivers (L+R)
- Side-firing: 2 tweeters (L+R)
- Rear: 2 racetrack full range drivers (portable)
- Dimensions (W x H x D): 1049 x 120 x 55.6 mm
- Weight: ?kg
- Operating temperature: 0°C - 45°C

Subwoofer

- Power supply: 220-240 V~, 50/60 Hz
- Power consumption: 240 W
- Power consumption: 20 W
- Standby power consumption: <0.5 W
- Frequency response: 40Hz - 120Hz
- Speaker driver: 1 x 8" subwoofer
- Impedance: 3 ohm
- Dimensions (W x H x D): 400 x 230 x 407 mm
- Weight: ?kg
- Operating temperature: 0°C - 45°C

Audio codec format

- HDMI: Dolby Digital, Dolby Digital plus, Dolby Digital EX, Dolby TrueHD, Dolby Atmos, DTS, DTS 96/24, DTS-ES, DTS Digital Surround (5.1-ch), DTS-HD High Resolution Audio, DTS-HD Master Audio, DTS ES, DTS: X
- HDMI eARC: Dolby Digital, Dolby Digital plus, Dolby Digital EX, Dolby TrueHD, Dolby Atmos, DTS, DTS 96/24, DTS-ES, DTS Digital Surround (5.1-ch), DTS-HD High Resolution Audio, DTS-HD Master Audio, DTS ES, DTS: X
- Optical: Dolby Digital, Dolby Digital plus, LPCM 2ch
- Bluetooth: SBC, AAC
- USB: MP3
- Play-Fi: MPEG4 AAC, MPEG4 M4A, MP3, WAV, FLAC, AIFF

Wall mount

- Dimensions
- Weight: xx kg/each

Accessories

- Power adapter for the main unit
- Power cord for the subwoofer
- Quick start guide
- Worldwide warranty card
- Remote control
- Remote control batteries (2 x AAA-R03-1.5V)

9 Troubleshooting



Warning

- Risk of electric shock. Never remove the casing of the product.

To keep the warranty valid, never try to repair the product yourself.

If you have problems using this product, check the following points before you request service. If you still have a problem, get support at www.philips.com/support

Main unit

The buttons on the main unit do not work.

- Disconnect from the power supply for a few minutes, then connect again.

Sound

No sound from the soundbar speaker.

- Connect the audio cable from your soundbar to your TV or other devices. However, you do not need a separate audio connection when:
 - the soundbar and TV are connected through HDMI ARC connection, or
 - a device is connected to the HDMI IN connector on your soundbar.
- On the remote control, select the correct audio input.
- Make sure that the soundbar is not muted.
- Reset this product to its factory settings (see 'Apply factory settings').

No sound from the wireless subwoofer.

- Wireless connect the subwoofer to the main unit.

Distorted sound or echo.

- If you play audio from TV through this product, make sure that the TV is muted.

Audio and video are not synchronized.

- Press  to synchronize the audio with the video.

Bluetooth

A device cannot connect with the soundbar.

- The device does not support the compatible profiles required for the soundbar.
- You have not enabled the Bluetooth function of the device. See the user manual of the device on how to enable the function.
- The device is not correctly connected. Connect the device correctly.
- The soundbar is already connected with another Bluetooth device. Disconnect the connected device, then try again.

Quality of audio play from a connected Bluetooth device is poor.

- The Bluetooth reception is poor: Move the device closer to the soundbar, or remove any obstacle between the device and the soundbar.

Wi-Fi

Wi-Fi connection cannot be established.

- Check the availability of the WLAN network on the router.
- Place the Wi-Fi router closer to this product.
- Make sure the password is correct.
- Check the WLAN function or reboot the modem and Wi-Fi router.

Dolby Atmos

Cannot achieve outstanding Dolby Atmos effects.

- For non-HDMI connections (such as use of USB, Bluetooth, OPTICAL or AUDIO IN), limited height surround effects are generated. See the section of 'Dolby Atmos' about how to achieve best Dolby Atmos effects.

Play-Fi

Cannot discover the Play-Fi supported devices from the app.

- Make sure the device is connected to the Wi-Fi.

Cannot play Play-Fi music.

- Certain network service or contents available through the device may not be accessible in case the service provider terminates its service.



IMAX, IMAX ENHANCED are trademarks of IMAX Corporation.

DOLBY ATMOS

Manufactured under license from Dolby Laboratories. Dolby, Dolby Atmos, Dolby Audio, Dolby Digital Plus, Pro Logic, and the double-D symbol are trademarks of Dolby Laboratories.



For DTS patents, see <http://patents.dts.com>. Manufactured under license from DTS Licensing Limited. DTS, the Symbol, & DTS and the Symbol together, DTS:X, and the DTS:X logo are registered trademarks and/or trademarks of DTS, Inc. in the United States and/or other countries. © DTS, Inc. All Rights Reserved.



The terms HDMI and HDMI High-Definition Multimedia Interface, and the HDMI Logo are trademarks or registered trademarks of HDMI Licensing LLC in the United States and other countries.

Bluetooth

The Bluetooth word mark and logos are registered trademarks owned by the Bluetooth SIG, Inc. and any use of such marks by MMD Hong Kong Limited is under license. Other trademarks and trade names are those of their respective owners.



The Wi-Fi CERTIFIED Logo is a certification mark of Wi-Fi Alliance®.



AirPlay, iPad, iPhone, iPod, iPod classic, iPod nano and iPod touch are trademarks of Apple Inc., registered in the U.S. and other countries. iPad Air and iPad mini are trademarks of Apple Inc. "Made for iPod", "Made for iPhone" and "Made for iPad" mean that an electronic accessory has been designed to connect specifically to iPod, iPhone, or iPad, respectively, and has been certified by the developer to meet Apple performance standards. Apple is not responsible for the operation of this device or its compliance with safety and regulatory standards.

Please note that the use of this accessory with iPod, iPhone or iPad may affect wireless performance.

AirPlay works with iPhone, iPad, and iPod touch with iOS 4.3.3 or later; Mac with OS X Mountain Lion or later, and PC with iTunes 10.2.2 or later.



The Spotify Software is subject to third party licenses found here: www.spotify.com/connect/third-partylicences. For more information about Spotify Connect, please visit www.spotify.com/connect



Specifications are subject to change without notice
The Philips trademark and the Philips Shield Emblem are registered
trademarks of Koninklijke Philips N.V. used under license.
Copyright © MMD Hong Kong Limited. Revised Edition © 2020
This product has been manufactured by, and is sold under the responsibility of
MMD Hong Kong Limited is the warrantor in relation to this product.

