

CEILING FAN REMOTE CONTROL OPERATION AND INSTALLATION INSTRUCTIONS

(Please keep this instruction pamphlet.)

IMPORTANT

YOU MUST SET CEILING FAN MANUAL SWITCH TO HIGH SPEED AND LIGHT KIT (IF ANY) TO ON POSITION BEFORE OPERATING REMOTE CONTROL.

IMPORTANT POINTS TO REMEMBER:

1. Read and save these instructions.
2. Please note that all fixed wiring appliances should be installed by a qualified electrician.
3. The supply to the remote control receiver should be connected through a mains switch, i.e. existing wall switch.
4. Disconnect from power supply at wall switch before working on remote control receiver or ceiling fan.
5. Install receiver into the ceiling fan canopy of the fan to ensure proper protection.
6. This unit is to be used for the control of ceiling fan and in an AC120V 60Hz power supply only. (Rating: max. 1.2A for fan motor; max. 100W for tungsten or LED)
7. Do not install in damp locations or immerse into water. (For indoor use only.)
8. Do not pull on or cut leads shorter.
9. Do not drop or bump the unit.
10. PLEASE NOTE: The battery will weaken with age and should be replaced before leaking takes place as this will damage the transmitter. Dispose of used battery properly, keep the battery out of reach of children.
11. CAUTION: To reduce the risk of fire or injury, do not use this product in conjunction with any variable (rheostat) wall control.

INSTALLATION INSTRUCTIONS

CAUTION: INCORRECT WIRE CONNECTION WOULD DAMAGE THIS RECEIVER.

1. Ceiling fan must be set at HIGH speed and light kit (If any) at ON position by pulling the "Pull Switch" after installation.
2. Once the connection has been made, the receiver inserts into the drop rod hanging bracket. The canopy comes up to cover the receiver and bracket.

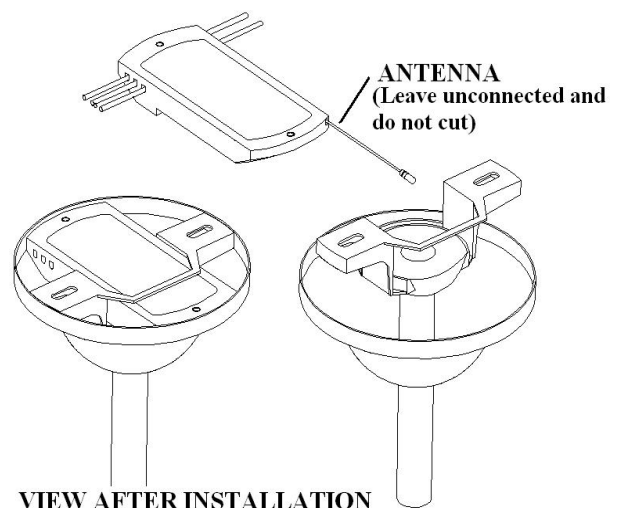
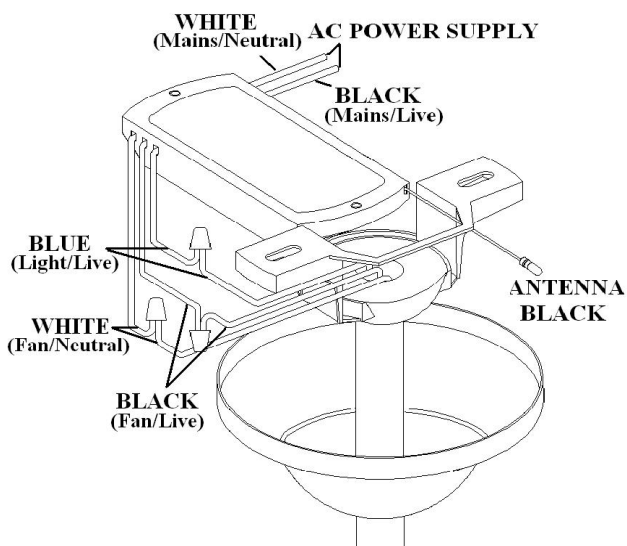

ACTIVATING THE LEARNING PROCESS

1. This unit finished learning process inside manufactory, if replace transmitter or receiver, user need to redo learning process before using this unit. Receiver could remember up to 3pcs transmitter.
2. Open the remote battery cover and install 2pcs DC1.5V/AAA batteries, with the fan power off.
3. After installation is complete, AC power is turned on within 60 seconds, press and hold the LEARN button for 1 second. The light will blink twice then turn off and fan running at medium speed to indicate the pairing process have been completed. Then the transmitter can control the receiver.
4. If user cannot finish the setting within the 60 seconds time frame, the main power must be turned off and re-started again. This will reset the unit. Repeat step 3 until the LEARNING feature is activated as indicated.
5. Please note that the transmitter can learn in multiple receiver, when doing learning process please make sure not learn in other receiver. Suggest to separate power switches of fans in 2 meter range.
6. If you want to clear these pairing transmitters, turn off ceiling fan and turn on within 60 seconds, press and hold the LEARN button over 8 seconds. The lights will blink twice then turn off and fan running at medium speed.

This will indicate the ceiling fan is only controlled by one remote.

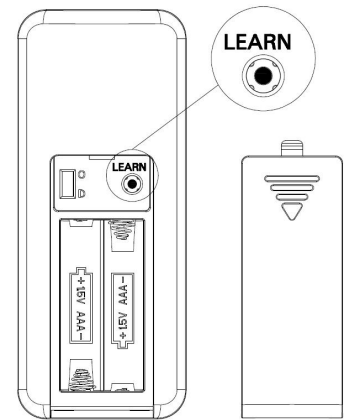

FUNCTIONS OF TRANSMITTER



ON/OFF : Turn on or off ceiling fan.



: Turn on the fan at high speed.



: Turn on the fan at medium speed.





: Turn on the fan at low speed.

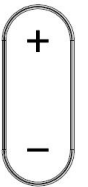

ON/OFF : Turn on or off lights.



: Press  button to brighten lights to the desired level and release. Press  button to dim lights to the desired level and release.



: When lights are on, use this button to select the desired color-temperature.

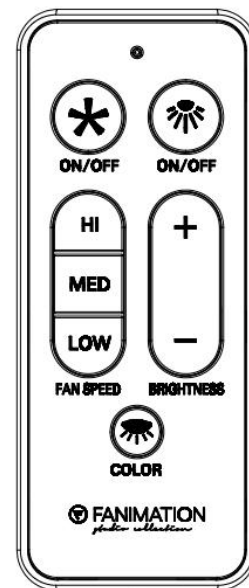

While the battery power is low and LED indicator flashes, please must replace new DC1.5V/AAA batteries.

Installation of Transmitter Wall Mount Holder with two screws.

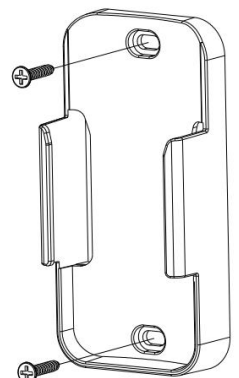

To assure continued FCC compliance:

FEDERAL COMMUNICATIONS COMMISSION INTERFERENCE STATEMENT

This equipment has been tested and found to comply with the limits for a Class B digital device, pursuant to Part 15 of the FCC Rules. These limits are designed to provide reasonable protection against harmful interference in a residential installation. This equipment generates, uses and can radiate radio frequency energy and, if not installed and used in accordance with the instructions, may cause harmful interference to radio communications. However, there is no guarantee that interference will not occur in a particular installation. If this equipment does cause harmful interference to radio or television reception, which can be determined by turning the equipment off and on, the user is encouraged to try to correct the interference by one or more of the following measures:

--Reorient or relocate the receiving antenna. --Increase the separation between the equipment and receiver.
--Connect the equipment into an outlet on a circuit different from that to which the receiver is connected. --Consult the dealer or an experienced radio/TV technician for help.

CAUTION:

To assure continued FCC compliance:

Any changes or modifications not expressly approved by the grantee of this device could void the user's authority to operate the equipment.

FCC ID: 2AQZU-18056

This device complies with Part 15 of the FCC Rules. Operation is subject to the following two conditions: (1) This device may not cause harmful interference, and (2) this device must accept any interference received, including interference that may cause undesired operation.

This equipment complies with FCC radiation exposure limits set forth for an uncontrolled environment.