

SUPER NOTE A6 Agile

QUICK GUIDE V 1.0



Contents

| | |
|----------------------|----|
| Product packing list | 15 |
|----------------------|----|

| | |
|------------------|----|
| Product features | 16 |
|------------------|----|

Operational functions and steps

| | |
|-----------------------------------|----|
| 01-Cover assembly and disassembly | 17 |
|-----------------------------------|----|

| | |
|-----------------------------------|----|
| 02-Introduction of label function | 17 |
|-----------------------------------|----|

| | |
|-------------------------------|----|
| 03-Intorudction of slide menu | 19 |
|-------------------------------|----|

| | |
|---|----|
| 04-Introduction of note taking function | 20 |
|---|----|

| | |
|--------------------------|----|
| 05-Cloud synchronization | 21 |
|--------------------------|----|

| | |
|--|----|
| 06-Introduction of split screen fucntion | 22 |
|--|----|

| | |
|---------------------------------------|----|
| 07-Introduction of note edit function | 23 |
|---------------------------------------|----|

| | |
|----------------|----|
| Specifications | 24 |
|----------------|----|

| | |
|------------|----|
| Attentions | 25 |
|------------|----|

- Above functions are subject to actual product.

Product packing list

Standard packing



- SN A6 ×1



- Electromagnetic pen ×1

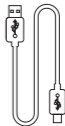

- USB ×1



- Quick guide ×1



- Warranty card ×1

Optional accessory

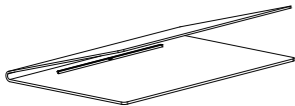

- Cover

Product features

Hardware feature guide

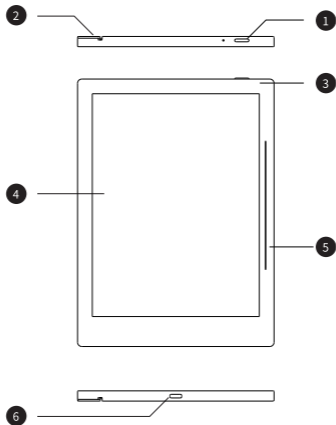

1. Power- Short press on power button to enter sleep/wake up mode. Long press over three seconds to turn on/off the device.
2. Cover guide rail groove- For cover assembly and disassembly.
3. Indicator light
4. Display- E Ink EPD/7.8 inches.
5. Side slide bar- Use finger to slide from top to bottom to activate the label tab menu. Slide from bottom to top to refresh the screen.
6. USB port- Connect to PC for data transfer or battery charging.

Operational functions and steps

01-Cover assembly and disassembly

Assembly by fitting cover's guide rail and device's guide rail groove from top to bottom or vice versa. Same way to remove cover.

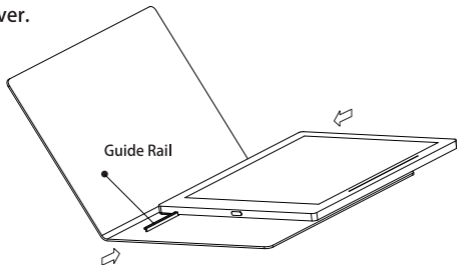

02-Introduction of label function

Use finger to slide from top to bottom to activate label tab menu.

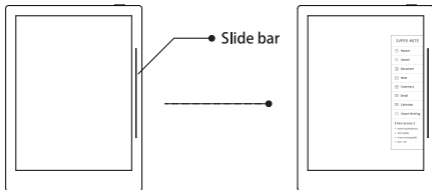

Specifications

Screen “A6-7.8” monochrome digital paperdisplay
1872x1404 resolution (300 DPI)
Partially powered by E Ink Carta technology

Operation System Linux Supernote UI

Memory 32GB internal storage

Eletromagnetic Screen / Stylus Wacom G14 technology

Battery Capacity 2500 mAh
Rechargeable (Type C USB)

Size & Weight 188mm * 138mm * 7.2mm
<245g

Work Temperature 0°C—40°C 32°F—104°F

Attentions

- SFragile Screen. No Extrusion



- Disassembly only by the Professionals



-
- Keep Away from Liquid



- Keep Away from Strong Magnetic and Strong Electrostatic Fields



- Screen is fragile, keep away from extrusion, bump, drop, sharps.
- Keep away from strong magnetic and strong electrostatic fields to avoid any damage.
- Please do not disassemble the device, warranty only provided by professionals.
- Please keep away from severe environments such like high/low temperatures, dry, humidify, smoke and dust.
- The device is not waterproof, please avoid water and other liquids.
- The Company shall not be liable for damage or deletion of in-flight data due to personal abnormal operation or other unexpected circumstances, neither any indirect loss.

Attentions

FCC:

Warning: Changes or modifications to this unit not expressly approved by the party responsible for compliance could void the user's authority to operate the equipment.

Note: This equipment has been tested and found to comply with the limits for a Class B digital device, pursuant to Part 15 of the FCC Rules. These limits are designed to provide reasonable protection against harmful interference in a residential installation. This equipment generates, uses and can radiate radio frequency energy and, if not installed and used in accordance with the instructions, may cause harmful interference to radio communications. However, there is no guarantee that interference will not occur in a particular installation. If this equipment does cause harmful interference to radio or television reception, which can be determined by turning the equipment off and on, the user is encouraged to try to correct the interference by one or more of the following measures:

Reorient or relocate the receiving antenna.

Increase the separation between the equipment and receiver.

Connect the equipment into an outlet on a circuit different from that to which the receiver is connected.

Consult the dealer or an experienced radio/TV technician for help.

Attentions

The device has been evaluated to meet general RF exposure requirement.

The device can be used in portable exposure condition without restriction.

IC Caution.

RSS-Gen Issue 5, Amendment 1, March 2019" & "CNR-Gen 5e
Amendement 1, mars 2019:

This device contains licence-exempt transmitter(s)/receiver(s) that comply with Innovation, Science and Economic Development Canada's licence-exempt RSS(s). Operation is subject to the following two conditions:

1. This device may not cause interference. 2. This device must accept any interference, including interference that may cause undesired operation of the device.

L' émetteur/récepteur exempt de licence contenu dans le présent appareil est conforme aux CNR d' Innovation, Sciences et Développement économique Canada applicables aux appareils radio exempts de licence. L' exploitation est autorisée aux deux conditions suivantes :

Attentions

1. L' appareil ne doit pas produire de brouillage;
2. L' appareil doit accepter tout brouillage radioélectrique subi, même si le brouillage est susceptible d' en compromettre le fonctionnement.

The device has been evaluated to meet general RF exposure requirement.

The device can be used in portable exposure condition without restriction.

le dispositif a été évalué à satisfaire l'exigence générale de l'exposition aux rf.

l'appareil peut être utilisé dans des conditions d'exposition portatif sans restriction.

- This Class B digital apparatus complies with Canadian ICES-003.
- Cet appareil numérique de la classe B est conforme à la norme NMB-003 du Canada.

SUPER NOTE

Supernote For Those Who Write

More functional operation - manual
Follow WeChat official account or official website



[Http://www.supernote.com](http://www.supernote.com)

+86 400-921-7470 (Monday to Friday 9:00-18:00)

