

Veise

User Guide

VE008 Smart Lock



Scan the QR code
to download the
Smart Life App



Please fully read and understand this manual
before using and keep this manual for future reference.



INSTALLATION VIDEO

Please watch this video first and use this manual as a guide.

Go to www.iveise.com/videos to watch installation video.

If you have any questions, contact us at **+1(855)400-3853**

 (Monday-Friday 9:00-5:00pm PST)

USER GUIDE

How to Lock / Unlock	03	STEP 3: Install exterior assembly	12
How to change lock mode	05	STEP 4: Install interior assembly	13
STEP 1: Prepare the door and check dimensions	08	STEP 5: Install battery	15
STEP 2: Install the latch and strike	09	APP Guide	18

AT A GLANCE

Exterior Assembly

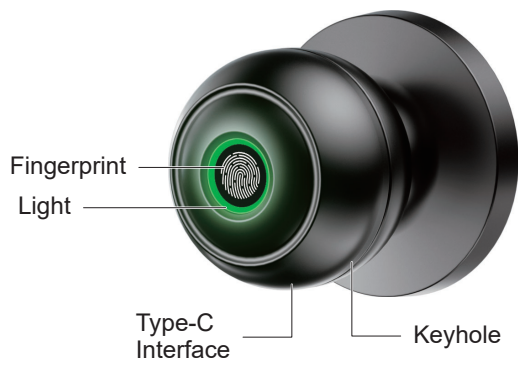

Interior Assembly



HOW TO LOCK / UNLOCK

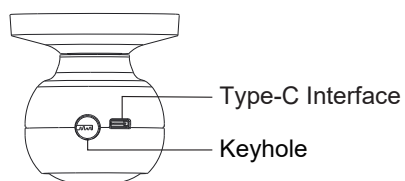

• Key To Unlock

Insert the key into the keyhole located at the edge of the Exterior Knob and turn the key 120° to unlock and turn the Exterior Knob to open the door.



• Fingerprint unlock

Put finger on the sensor to unlock the knob.

Note: Fingerprint only use to unlock the Knob, it can't be used to lock the Knob.

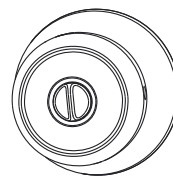

• Auto-lock

In the Normal & Privacy mode, after unlocking with the fingerprint, the door knob automatically locks in 5 seconds.

FACTORY DEFAULT SETTINGS

Restore the Factory Setting

Rotate the thumb turn from the circular mark to the unlock sign on the left and then return the thumb turn to the circular mark, after repeating this operation 5 times, perform the same operation to the right for 5 times.

After that, you will hear the long beep and the fingerprint identification area will flash green.

After reset, any fingerprint can unlock the lock. Please add a phone administrator ASAP.

Settings	Factory Defaut
Lock Mode	Passage Mode
Auto Lock	5 seconds
Silent Mode	Disabled
Fingerprint Capacity	20



⚠ IMPORTANT: Resetting the lock will delete all stored fingerprints.

HOW TO CHANGE LOCK MODE

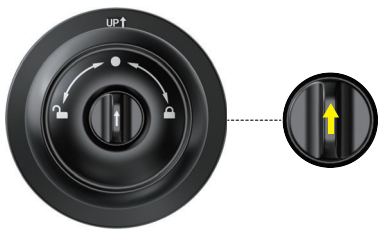

• Normal Mode

As the figures shows, rotate the thumb turn to circular mark above the thumb turn to switch to normal mode. In normal mode, the door knob will automatically lock in 5 seconds after fingerprint unlocking.

Both members and administrators can unlock with their fingerprints.

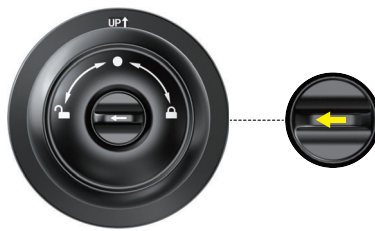

• Passage Mode

As shown at right, rotate the thumb turn to unlock sign on the left to activate passage mode. After activating passage mode, the door knob is always unlocked.

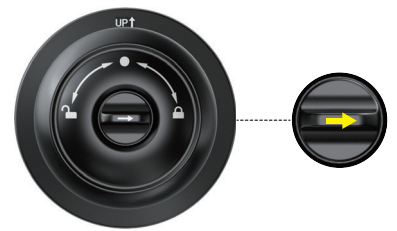









• Privacy Mode

As shown in the figures, rotate the thumb turn to lock sign on the right to activate privacy mode. Both members and administrators can unlock via the App. **Only the administrators' fingerprints can unlock.**

PARTS LIST

 If any parts are missing or damaged, please contact us at [+1\(855\)400-3853](tel:+1(855)400-3853).

<p>A Exterior Knob x1</p> 	<p>B Latch x1</p> 	<p>C Strike x1</p> 
<p>D Dust Cover x1 (optional)</p> 	<p>E Latch&Strike screws x4</p> 	<p>F Interior Knob x1</p> 
<p>G Long Screws x2</p> 	<p>H User Manual x1</p> 	<p>I Backup Key x2</p> 

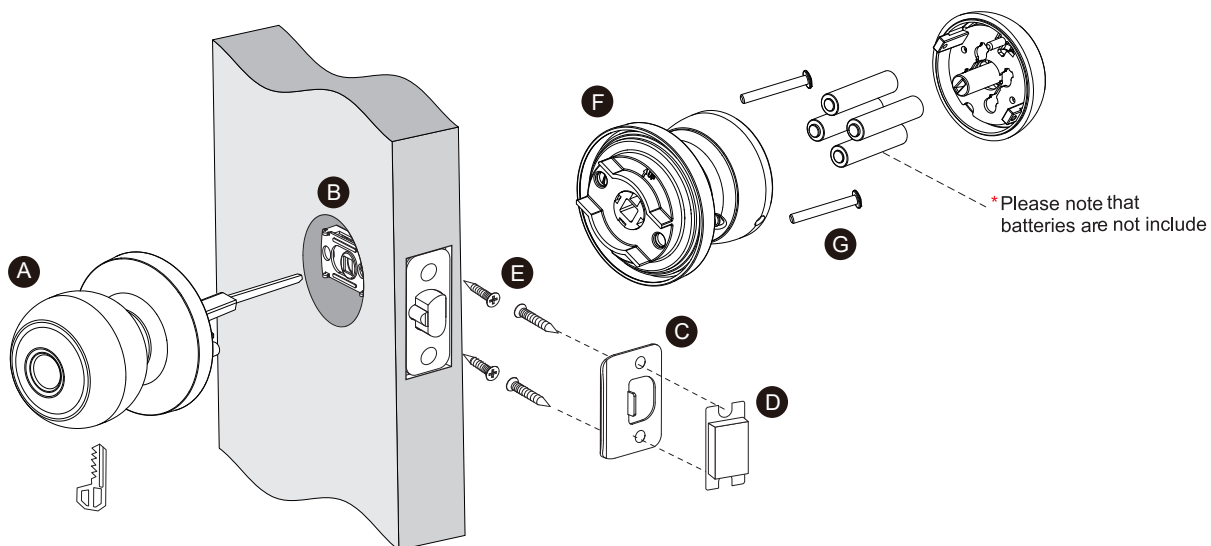

STEP 1: PREPARE THE DOOR AND CHECK DIMENSIONS

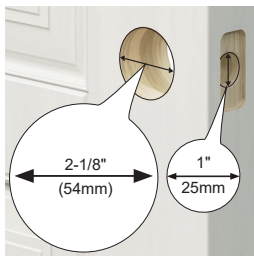

A

Measure to confirm that the hole in the door is 2-1/8" (54mm). Measure to confirm that the hole in the door edge is 1" (25mm).



B

Measure to confirm that the backset is either 2-3/8" or 2-3/4" (60 or 70mm).

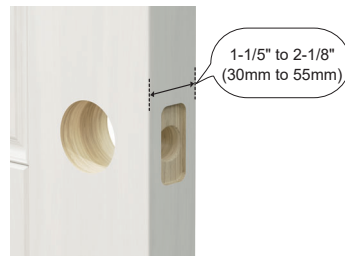

C

Measure to confirm that the door is 1-1/5" to 2-1/8" (30mm to 55mm) thick.

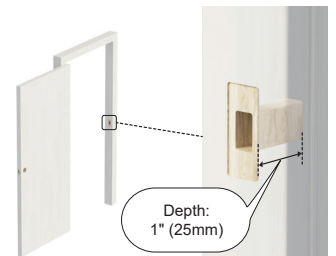

D

Make sure the hole in the door frame is drilled a minimum of 1" (25mm) deep, to leave enough space for the latch to extend into the door frame when the door is closed.

STEP 2: INSTALL THE LATCH AND STRIKE

A Latch backset adjustment

Backset is the distance from the door edge to the center of the hole in the door. The latch is provided with adjustable design which can fit either 2-3/8" (60mm) or 2-3/4" (70mm) backset.

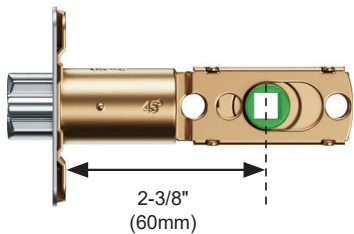
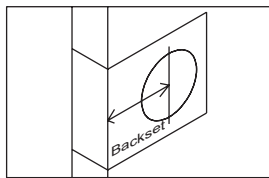

If the backset of your door is 2-3/8" (60mm), no need to adjust the latch.

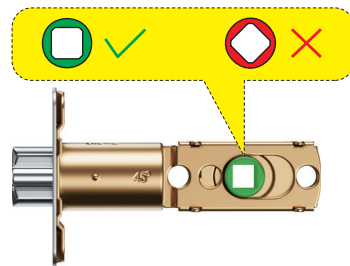

If the backset of your door is 2-3/4" (70mm), please adjust the latch as shown in below images.

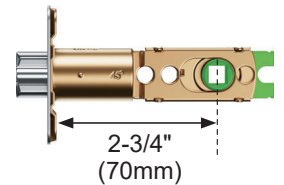
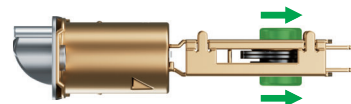

STEP 2: INSTALL THE LATCH AND STRIKE

B Install the latch

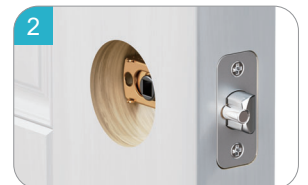
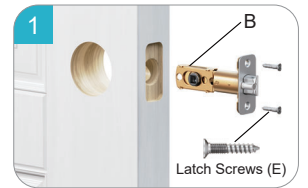
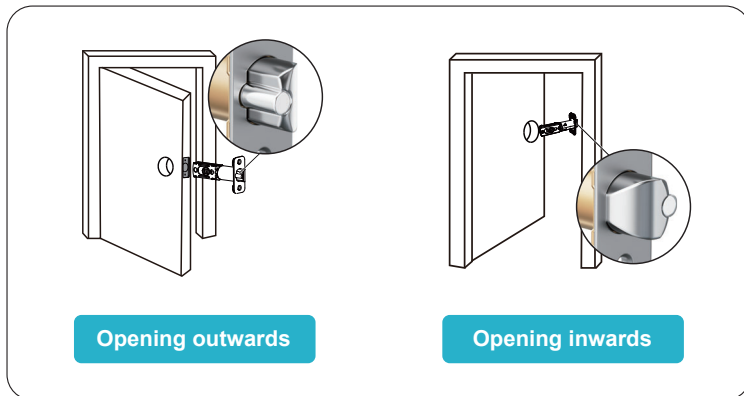

STEP 2: INSTALL THE LATCH AND STRIKE

C Install strike on the door frame.

⚠ IMPORTANT:

Make sure the hole in door frame is drilled a minimum of 1" (25mm) deep.

Strike screws(E)

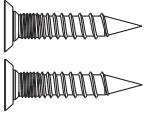

(Actual Size)

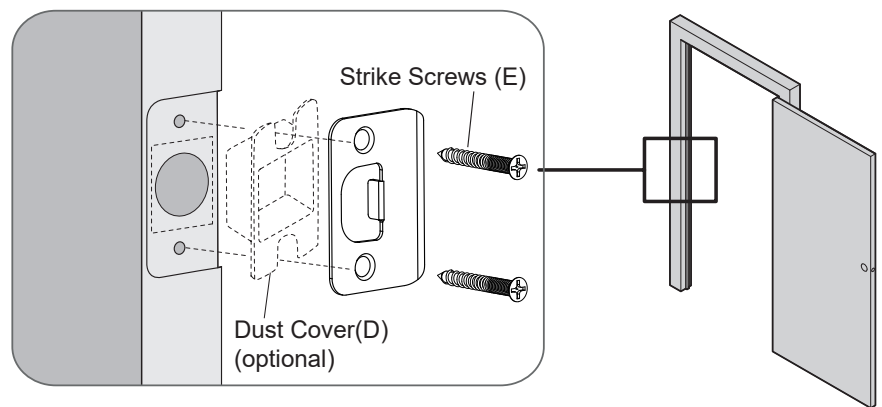

STEP 3: INSTALL EXTERIOR ASSEMBLY

Route the cable over the latch, the 2 rod bolts going through the round holes on the latch, and insert the torque blade going through the square hole.

Note: The "UP" label mark on the rosette facing up, and the keyhole facing down.

 Rotate and keep the torque equalizer vertical.



STEP 4: INSTALL INTERIOR ASSEMBLY

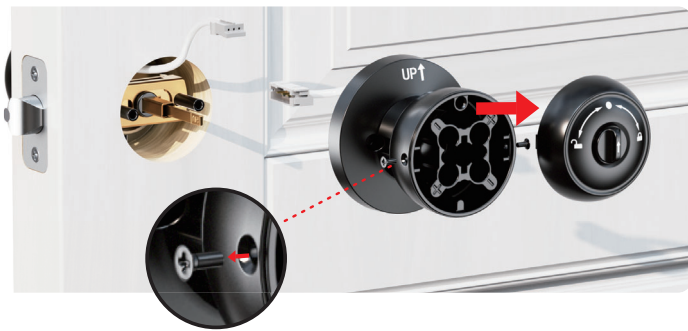

- A** Loosen the screws on the interior Knob and remove the battery cover.

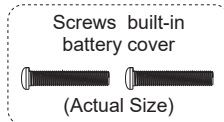

- B** Insert the cable connector to the socket. Push the connector in firmly until it is completely attached.

STEP 4: INSTALL INTERIOR ASSEMBLY

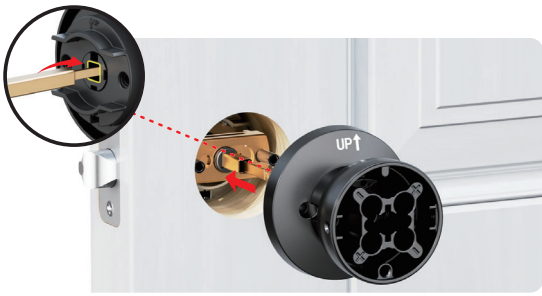

- C** The tailpiece going through the square hole on the interior assembly;
Note: The "up" mark on the rosette facing up.

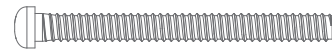

Long Screws(G) x 2
(Actual Size)

- D** Insert the Long Screws into the circular holes and tighten them to secure the rosette.

STEP 5: INSTALL BATTERY

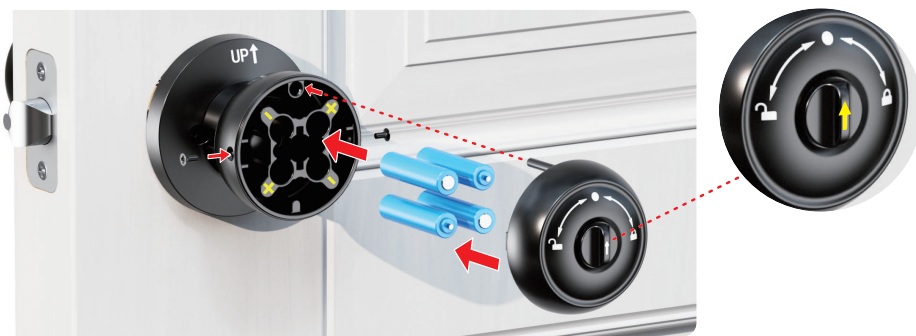

- E** Insert 4 AAA alkaline batteries and put on the battery cover (the battery cover pillar should be inserted into the corresponding hole), secure the battery cover with two screws.
Keep the thumb vertical, facing up and towards the circular mark.

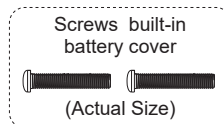

Please install the battery correctly according to the positive and negative poles as shows.

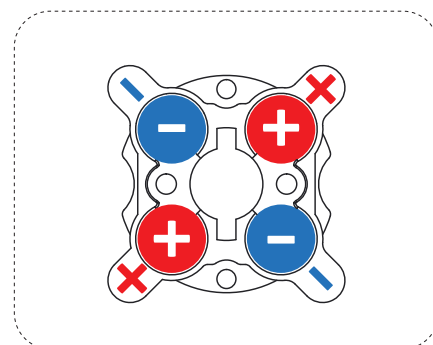

HOW TO UNLOCK THE KNOB, WHEN THE BATTERY DEAD.



• Key To Unlock

Insert the key into the keyhole at the edge of the Exterior Knob and turn key 120° to unlock, then turn the Exterior Knob to open the door.

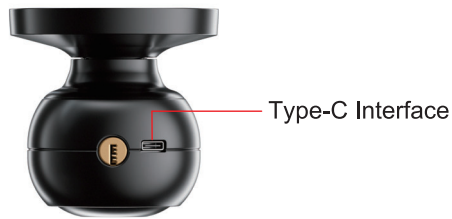

• Emergency power supply

1. Power on the Knob by connecting the Knob to a power bank via the Type-C interface on the edge of the Exterior Knob.
2. Unlock the Knob and replace the battery as soon as possible.

Note: The Type-C interface is only used to unlock the Knob in an emergency, it can't be used to recharge the battery.

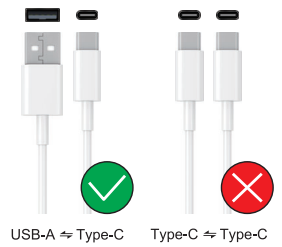

⚠ ATTN:
Please use USB-A ⇌ Type-C cable for charging or emergency power supply (as the top left figure shows).

DEFINITIONS

Action	Buzzer	Indicator
Power on	Beep once	Inactive
Fingerprint added successfully	Long Beep	Stay green for a while
Unlocking successful	Beeps once	Blinks green once
Unlocking failure	Beeps twice	Blinks red once
Low battery warning	Beeps once (after using fingerprint or App to unlock)	Blinks green then blinks red (after using fingerprint or App to unlock)
Resetting successful	Long Beep	Blinks green once

HOW TO REGISTER

Download “smart life” App in Google Play or App Store.

Notes:

The smart life is required to operate the lock. After the lock is properly installed, make sure this step is performed by the lock owner.



Scan QR code to download smart life App

PAIRING YOUR LOCK

⚠ You may need to tap on the fingerprint sensor to wake up the lock.

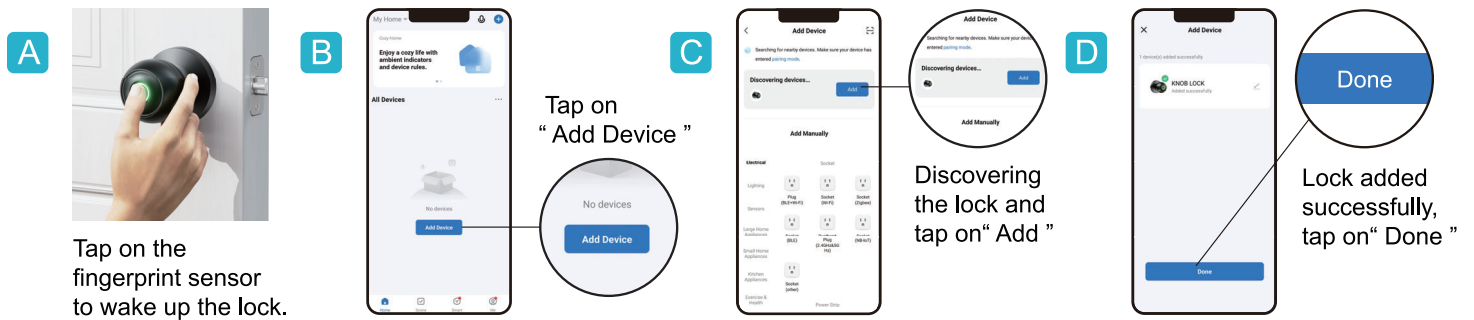

Note: Please do not tap on the fingerprint sensor for several times or hold it for 5 seconds, the lock will lock and unlock repeatedly and the green light flashes repeatedly. If it happens, tap the fingerprint sensor once and the green light flashes twice to return the normal mode.

FINGERPRINTS

A

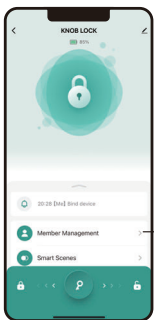

Tap on "Member Management".

B

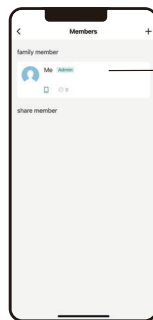

Choose the member and tap on it.

C

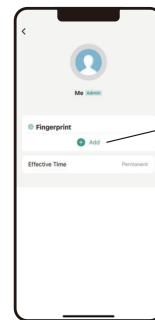

Tap on "+ Add".

D

Follow the instruction in the App and Complete fingerprint addition.

FCC warning statements:

This equipment has been tested and found to comply with the limits for a Class B digital device, pursuant to part 15 of the FCC Rules. These limits are designed to provide reasonable protection against harmful interference in a residential installation. This equipment generates, uses and can radiate radio frequency energy and, if not installed and used in accordance with the instructions, may cause harmful interference to radio communications. However, there is no guarantee that interference will not occur in a particular installation. If this equipment does cause harmful interference to radio or television reception, which can be determined by turning the equipment off and on, the user is encouraged to try to correct the interference by one or more of the following measures:

- Reorient or relocate the receiving antenna.
- Increase the separation between the equipment and receiver.
- Connect the equipment into an outlet on a circuit different from that to which the receiver is connected.
- Consult the dealer or an experienced radio/TV technician for help.

Caution: Any changes or modifications to this device not explicitly approved by manufacturer could void your authority to operate this equipment.

This device complies with part 15 of the FCC Rules. Operation is subject to the following two conditions: (1) This device may not cause harmful interference, and (2) this device must accept any interference received, including interference that may cause undesired operation.

The device has been evaluated to meet general RF exposure requirement.