

# Alfred

## DB2 Series

FCC ID:2A0Y4-DB2BLEZWUS  
IC ID:24242-DB2BLEZWUS

### Programming Instructions

FCC caution  
Federal Communication Commission (FCC) Radiation Exposure Statement

When using the product, maintain a distance of 20cm from the body to ensure compliance with RF exposure requirements.

FCC statements:  
This device complies with part 15 of the FCC rules. Operation is subject to the following two conditions:

- (1) This device may not cause harmful interference, and
  - (2) this device must accept any interference received, including interference that may cause undesired operation.
- NOTE: The manufacturer is not responsible for any radio or TV interference caused by unauthorized modifications or changes to this equipment. Such modifications or changes could void the user's authority to operate the equipment.

NOTE: This equipment has been tested and found to comply with the limits for a Class B digital device, pursuant to part 15 of the FCC Rules. These limits are designed to provide reasonable protection against harmful interference in a residential installation. This equipment generates uses and can radiate radio frequency energy and, if not installed and used in accordance with the instructions, may cause harmful interference to radio communications. However, there is no guarantee that interference will not occur in a particular installation. If this equipment does cause harmful interference to radio or television reception, which can be determined by turning the equipment off and on, the user is encouraged to try to correct the interference by one or more of the following measures:

- Reorient or relocate the receiving antenna.
- Increase the separation between the equipment and receiver.
- Connect the equipment into an outlet on a circuit different from that to which the receiver is connected.
- Consult the dealer or an experienced radio/TV technician for help.

IC Notice:  
This Class B digital apparatus complies with Canadian ICES-003. Cet appareil numérique de la classe B est conforme à la norme NMB-003 du Canada.

This device complies with Canada Industry licence-exempt RSS standard(s). Operation is subject to the following two conditions: (1) this device may not cause interference, and (2) this device must accept any interference. Including interference that may cause undesired operation of the device.

CAN ICES-3 (B)  
Le présent appareil est conforme aux CNR d'Industrie Canada applicables aux appareils radio exempts de brouillage. L'exploitation est autorisée aux deux conditions suivantes :

- (1) l'appareil ne doit pas produire de brouillage;
- (2) l'utilisateur de l'appareil doit accepter tout brouillage radioélectrique subi, même si le brouillage est susceptible d'en compromettre le fonctionnement.

NMB-3 (B)  
Alfred INC. reserves all rights for the final interpretation to this instruction.  
All design and specifications are subject to change without notice

### Warnings

Failure to follow these instructions could result in damage to the product and void the factory warranty.  
The accuracy of the door preparation is critical for the proper functioning and security of this product. Misalignment can cause performance degradation and lessening of security.

Finish Care: This lockset is designed to provide the highest standard of product quality and performance. Care should be taken to ensure a long-lasting finish. When cleaning is required use a soft, damp cloth. Using lacquer thinner, caustic soaps, abrasive cleaners or polishes could damage the coating and result in tarnishing.

**CAUTION**  
**IMPORTANT: Do not install batteries until the lock is completely installed on door.**

1. Master PIN Code(4~10 digit): Default master PIN code is "12345678", please modify it after installation.
2. User PIN Code Number: User PIN codes can be set up with PIN code numbers (00-19).
3. User PIN Code(4~10 digit): User PIN codes can be set up only through Master PIN code. Each User PIN code has only one PIN Code Number.

### Introduction

The Alfred DB2 combines a robust lockset with a contemporary electronic aesthetic.

Users benefit from an interactive touch screen that makes day-to-day access effortless, as well as offering voice-guided programming for simple updates to user information in the event of staffing changes or security breaches. Alfred DB2 is engineered for quick and easy installation and fits in place of a standard deadbolt lock door prep.

If this is an Wireless-enabled lock, it needs to be located within 50-100 feet of another network controller(Gateway). That distance is influenced by objects between the lock and the controller and may be extended depending on proximity to other network devices. Also, if the lock is connected to a network controller, it is recommended that it is programmed through the centralized user interface(PC or hand-held device) to ensure communication between the lock and the controller unit.

### Parts Illustrations

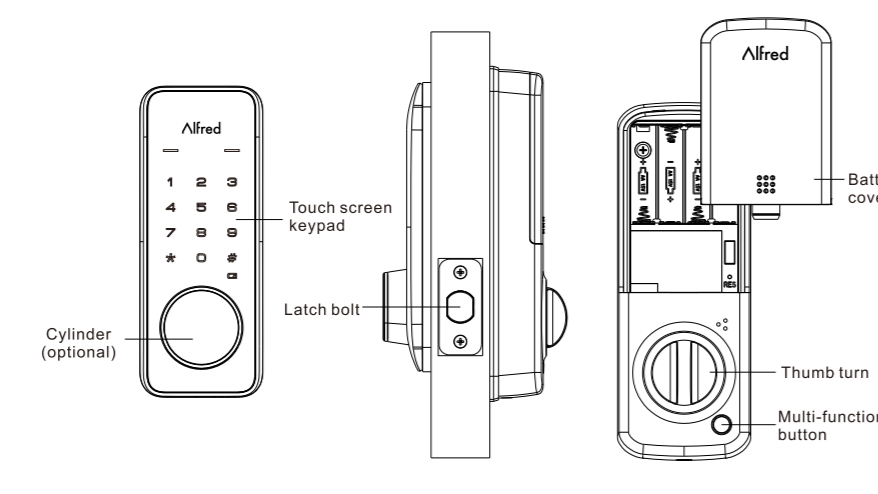

Item	Specifications	Remarks
Outside escutcheon	DB2: 162mm(L) x 68mm(W) x 14.5mm(H) DB2-B: 172mm(L) x 68mm(W) x 14.5mm(H)	Operation temperature: -20~60℃
Inside escutcheon	200mm(L) x 77mm(W) x 46mm(H)	
Battery	AA alkaline battery x4 (Operating voltage: 3.8~6.0V)	Last up to one year (10 times open/close per day)

### Programming

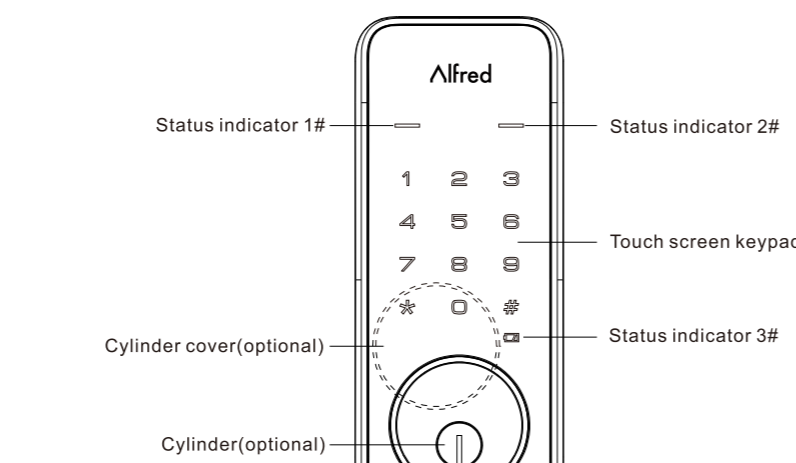

Status Indicators  
1#. Door secured  
2#. Door opened  
3#. Low battery Warning

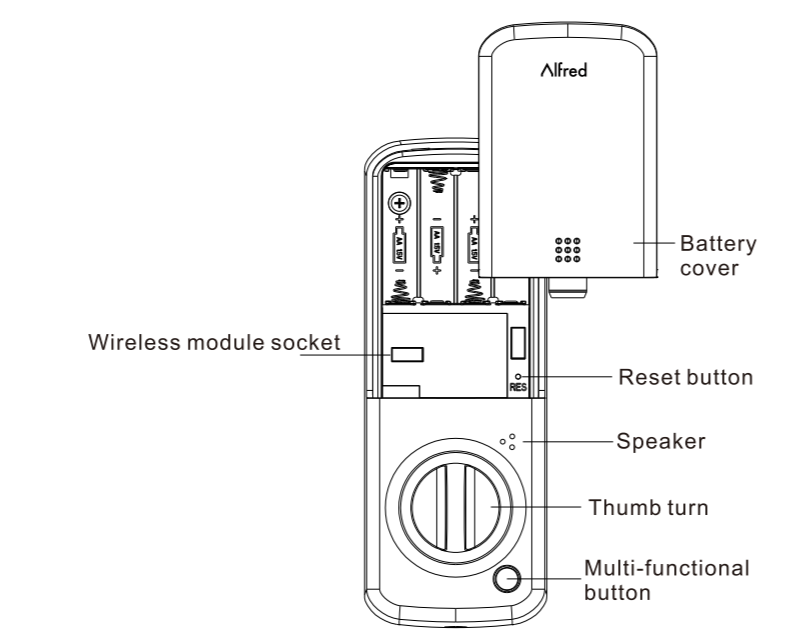
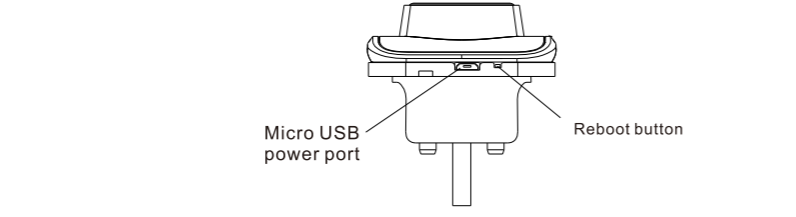

**CAUTION**

1. You can operate following the voice guide.
2. Master and User PIN code have 4-10 digits, the default Master PIN code is [12345678]. Please change it prior to programming of the lock.

### Definitions

**Master Mode:**  
The Master Mode could be entered by entering "\*" + Master PIN Code + # to programming the lock.

**Master PIN code:**  
The Master PIN Code is used for programming and for feature settings.

**CAUTION**

The default **Master PIN Code** must be changed after installing. The Master PIN Code will also operate the lock in **Away Mode**.

**Auto Re-lock:**  
After successful PIN Code entry and the unit unlocks, it will automatically re-lock after a default of 30 seconds.

**Manual Mode:**  
Auto Re-lock function could be adjusted to Manual Mode. In Manual Mode the lock could be locked only by pressing any key for 2 seconds from outside or using thumb turn from inside.

**One Touch Re-lock:**  
When the bolt is retracted, activating the keypad and press any key for 2 seconds will extend the bolt(during Auto Re-Lock duration or when Manual Mode is enabled)

**Shutdown Time:**  
The lock will shutdown for a default of 5 mins and not allow operation after the wrong code entry limit(10 times) has been met. When the unit is in Shutdown, the screen will flash when you are trying to use keypad.

**Away Mode:**  
This feature is enabled by the **Master PIN Code** in **Master Mode**. It restricts all user PIN code access, except **Master PIN code**. This feature will disabled automatically after entering **Master PIN Code** from outside. If someone unlock the unit by using thumb turn, the lock will alarm for 1 min and send a message to user's hand-held device for warning(requires wireless module).

**Silent Mode:**  
Enabling Silent Mode shuts off the code confirmation tone playback for use in quiet areas. Silent mode is selected in the **Voice setting** of **Master Mode**.

**Status LED:**  
Located on outside escutcheon.

**User PIN code:**  
The User PIN code operates the lock. Maximum number of user PIN codes is 20.

**Wrong Code Entry Limit:**  
After a specified number of unsuccessful attempts at entering a valid PIN code the lock will shut down and not allow operation. Wrong code entry limit is 10 times.

**Reboot button:**  
When the system crash down, the lock could be restart by pressing Reboot button on outside escutcheon.

**Reset button:**  
After holding the Reset button for at least 3 seconds, the lock will be restored to factory default settings, all user credentials will be deleted.

**Privacy mode:**  
After holding the multi-functional button for 3 seconds, the lock will be set to Privacy mode. It restricts all user PIN code access, except Master PIN code. This feature will disabled automatically after entering Master PIN Code from outside, or someone unlock the unit by using thumb turn or override key(optional).

### Factory Default

Settings	Factory Defaults
Master PIN Code	12345678
Auto Re-lock	Enabled
Speaker	Enabled
Auto Re-lock time	30 Seconds
Wrong Code Entry Limit	10 times
Shutdown Time	5 mins
Voice guide language	English

### Lock Operation

#### -Change Default Master PIN Code

1. Touch the screen with your hand to activate.
2. Enter "\*" twice and the 8-digit default Master PIN Code(12345678) followed by "#". Lock Response: Digit 1-8 on keypad light up.
3. Enter "1". Lock Response: All keys on keypad light up.
4. Enter new 4-10 digit Master PIN Code followed by "#" twice(2). Lock Response: Voice guide.

#### -Add Up User PIN Codes

- User PIN codes can only be programmed through the Master PIN Code.
1. Touch the screen with your hand to activate.
  2. Enter "\*" twice and the Master PIN Code followed by "#". Lock Response: Digit 1-8 on keypad light up.
  3. Enter "2". Lock Response: All keys on keypad light up.
  4. Enter The User Number to be registered(00-19) followed by "#". Lock Response: Digit 1-8 on keypad light up.
  5. To continue adding users, do previous steps from 1-4 again.

**CAUTION**

When registering User PIN Codes, the code must be entered within 10 seconds or time expires. No matter setting succeed or failed, the process won't completed and stay at current stage, you can press "\*" to return to previously menu.

#### -Delete User PIN Code

- User PIN codes can only be programmed through the Master PIN Code.
1. Touch the screen with your hand to activate.
  2. Enter "\*" twice and the Master PIN Code followed by "#". Lock Response: Digit 1-8 on keypad light up.
  3. Enter "3". Lock Response: All keys on keypad light up.
  4. Enter The User Number or User PIN code to be deleted(00-19) followed by "#". Lock Response: Digit 1-8 on keypad light up.
  5. To continue deleting users, do previous steps from 1-4 again.

**CAUTION**

When deleting User PIN Codes, the User Number must be entered within 10 seconds or time expires. No matter setting succeed or failed, the process won't completed and stay at current stage, you can press "\*" to return to previously menu. Deleting all User PIN codes could be done only by pressing Reboot button in battery box.

### Lock Operation

#### -Auto Re-lock enable/disable

- Auto Re-lock feature can only be programmed through the Master PIN Code.
1. Touch the screen with your hand to activate.
  2. Enter "\*" twice and the Master PIN Code followed by "#". Lock Response: Digit 1-8 on keypad light up.
  3. Enter "4". Lock Response: Digits 1 and 2 on keypad light up.
  4. Enter "1" to enable, enter "2" to disable. Lock Response: Voice guide

#### -Silent Mode(Speaker enable/disable)

- Silent Mode feature can only be programmed through the Master PIN Code.
1. Touch the screen with your hand to activate.
  2. Enter "\*" twice and the Master PIN Code followed by "#". Lock Response: Digit 1-8 on keypad light up.
  3. Enter "5". Lock Response: Digits 1 and 2 on keypad light up.
  4. Enter "1" to enable, enter "2" to disable.

#### -Enable Away Mode

- Away Mode feature can only be programmed through the Master PIN Code.
1. Touch the screen with your hand to activate.
  2. Enter "\*" twice and the Master PIN Code followed by "#". Lock Response: Digit 1-8 on keypad light up.
  3. Enter "6" to enable.

**CAUTION**

Away Mode will be disabled automatically after entering Master PIN Code from outside or someone unlock the unit by using thumb turn or override key(optional).

#### -Bluetooth settings

Bluetooth feature can only be programmed through the Master PIN Code. Refer to Bluetooth setting introduction.

#### -Function extension settings (optional)

Network features are included in function extension, can only be programmed through the Master PIN Code. Refer to Network setting introduction.

**CAUTION**

If the lock is connected to a network controller, it is recommended that it is programmed through the centralized user interface(PC or hand-held device) to ensure communication between the lock and the controller.

### Feature Programming Through Menu Mode using Master PIN Code

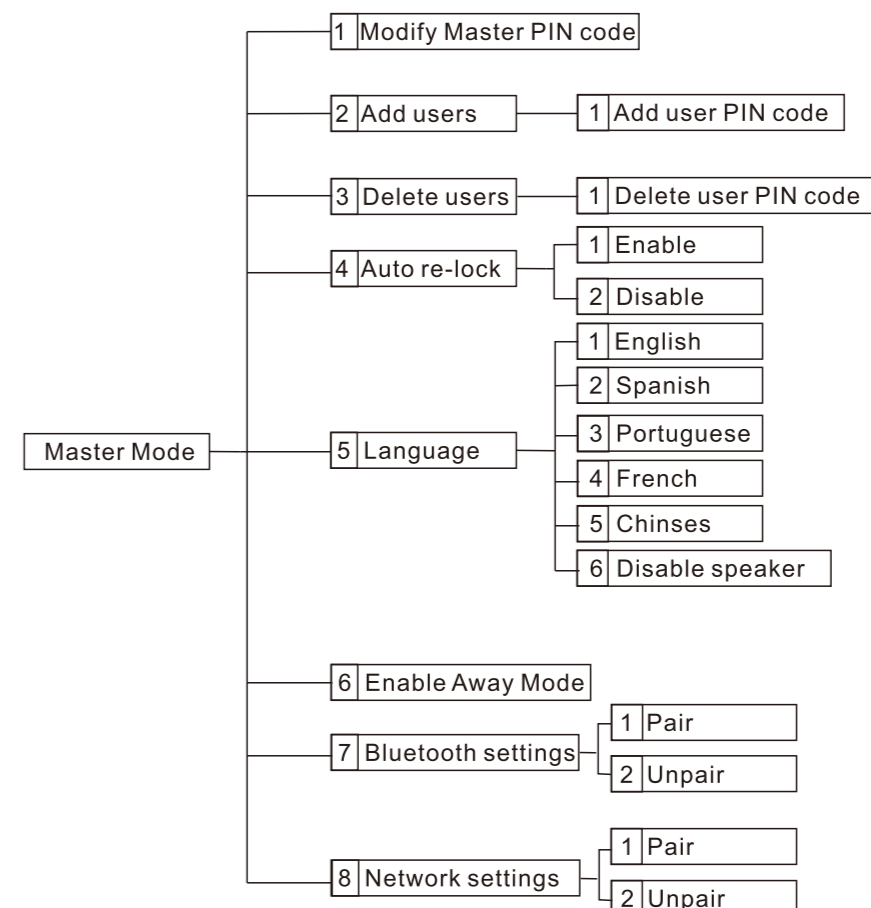

### How to use

#### Unlock the door

1. **Unlock the door from outside**  
- Use PIN code key  
- Fake PIN → UP → #  
- User PIN code → #
2. **Unlock the door from inside**  
- Open/close button  
- Push the open/close button on the main escutcheon.  
- Manual open/close knob  
- Turn the knob on the main escutcheon.

#### Lock the door

1. **Lock the door from outside**  
**Auto mode**  
- In Auto mode, the door is locked automatically.
- Manual mode**  
- Just touch any keypad for more than 2 seconds

### How to use

#### Lock the door

2. **Lock the door from inside**  
**Auto mode**  
- In Auto mode, the door is locked automatically.
- Manual mode**  
- In Manual mode, the door is locked by pushing Open/close button or turning the knob.

#### Enable Privacy Mode

3. **Enable Privacy Mode**  
- As locking the door, push Open/close button for 3 seconds, and any type of opening verification from outside is not available.  
- If any normal opening from inside, this mode is cleared.

#### Unlock with Fake PIN Code

4. **Unlock with Fake PIN Code**  
- Fake PIN → UP → #  
- User can prevent PIN code exposure from strangers.  
- \* and # key is not available for Fake PIN code.

#### Micro USB emergency power supply and Reboot button

5. **Micro USB emergency power supply and Reboot button**  
- Power bank(Micro USB)  
- Micro USB power port  
- Reboot button  
- Door lock can be connected to micro USB power bank when battery wears out.  
- Door lock can be restarted by press Reboot button when crash down.

#### Bluetooth pairing instruction

- Operations on lock
1. Touch the screen with your hand to activate.
  2. Enter "\*" twice and the Master PIN Code followed by "#". Lock Response: Digit 1-8 on keypad light up.
  3. Enter "7" to set up Bluetooth.
  4. Enter pairing/unpairing mode in APP follow the pairing/unpairing guide.
  5. Enter "1" to pair the lock or enter "2" to unpair the lock.

#### Function extension instruction(Z-wave,remote control, etc)

1. Follow the user guide of your hub to enter learning mode.
  2. Operate on lock following guide below.
    - 2.1. Touch the screen with your hand to activate.
    - 2.2. Enter "\*" twice and the Master PIN Code followed by "#". Lock Response: Digit 1-8 on keypad light up.
    - 2.3. Enter "8" to set up function extension.
    - 2.4. Enter "1" to pair, or, enter "2" to unpair.
- CAUTION**  
When joining a network your controller may or may not be aware of any previously saved user codes stored in the lock. It is recommended that all user codes be deleted from the lock prior to joining a network.