

FCC WARNINGS

This device complies with part 15 of the FCC rules. Operation is subject to the following two conditions: (1) this device may not cause harmful interference, and (2) this device must accept any interference received, including interference that may cause undesired operation.

Caution: Changes or modifications not expressly approved by the party responsible for compliance could void the user's authority to operate the equipment.

NOTE: This equipment has been tested and found to comply with the limits for a Class B digital device, pursuant to part 15 of the FCC Rules. These limits are designed to provide reasonable protection against harmful interference in a residential installation. This equipment generates uses and can radiate radio frequency energy and, if not installed and used in accordance with the instructions, may cause harmful interference to radio communications. However, there is no guarantee that interference will not occur in a particular installation. If this equipment does cause harmful interference to radio or television reception, which can be determined by turning the equipment off and on, the user is encouraged to try to correct the interference by one or more of the following measures:

- Reorient or relocate the receiving antenna.
- Increase the separation between the equipment and receiver.
- Connect the equipment into an outlet on a circuit different from that to which the receiver is connected.
- Consult the dealer or an experienced radio/TV technician for help

Radiation Exposure Statement

The device has been evaluated to meet general RF exposure requirement. The device can be used in portable exposure condition without restriction.

ADDITIONAL WARNINGS

- **WARNING:** To prevent fire or shock hazards, do not expose this unit to rain or moisture.
- **WARNING :** Where the mains plug or appliance coupler is used as the disconnect device, such disconnect device shall remain readily operable.
- Lithium batteries, like all rechargeable batteries, are recyclable and should be recycled or disposed of according to state and local guidelines. They should never be disposed of in normal household waste and they should never be incinerated, as they might explode. Contact your local government for disposal or recycling practices in your area.
- This product meets and complies with all Federal regulations.
- **To avoid hearing damage**, make sure that the volume on your music player is turned down before connecting your earbuds. After placing earbuds in/on your ears, gradually turn up the volume until you reach a comfortable listening level.



WARNING : This product can expose you to chemicals including lead, which is known to the State of California to cause cancer and birth defects or other reproductive harm. For more information go to www.P65Warnings.ca.gov.

International Support

To download this User's Guide in English, Spanish, or French, or to get answers to frequently asked questions, visit the support section at:
www.iLiveElectronics.com

Para descargar este Manual del Usuario en Inglés, Español y Francés, o para obtener respuestas a preguntas frecuentes, visite la sección de apoyo en:
www.iLiveElectronics.com

Pour télécharger ce guide de l'utilisateur en Anglais, Espagnol ou Français, ou pour obtenir des réponses à des questions fréquemment posées, consultez la rubrique d'assistance sur:
www.iLiveElectronics.com

Contact Information

Website: www.iLiveElectronics.com
Email Support: prodinfo@dpiinc.com
Email Parts: partsinfo@dpiinc.com
Phone Support: 1-888-999-4215

Warranty

For Warranty Information and the most up-to-date version of this User's Guide, go to:
www.iLiveElectronics.com.



**Protect for Today
Sustain for Tomorrow**

Specifications are subject to change without notice.

Copyright © 2019 Digital Products International (DPI, Inc.)
All other trademarks appearing herein are the property of their respective owners.

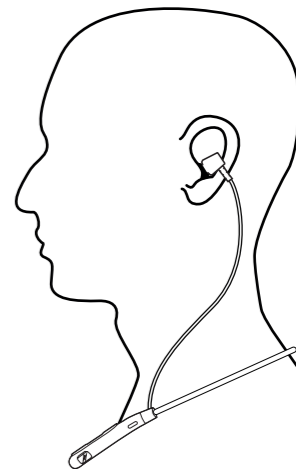

Wireless Stereo Headset

User's Guide for Model IAEB109-2327-01

Features

- Bluetooth Wireless 5.0: range 49 feet
- Foldable memory neck band holds any shape
- Voice prompts announce earbud operations
- Built-in microphone
- Neck band controls
- Micro-USB port for battery recharge
- Built-in rechargeable battery
- Battery life: approx. 6 hrs at 100% volume

Includes

- 3 pairs of eartips - small / medium / large
- Micro-USB to USB charging cable
- User's guide

Overview & Controls

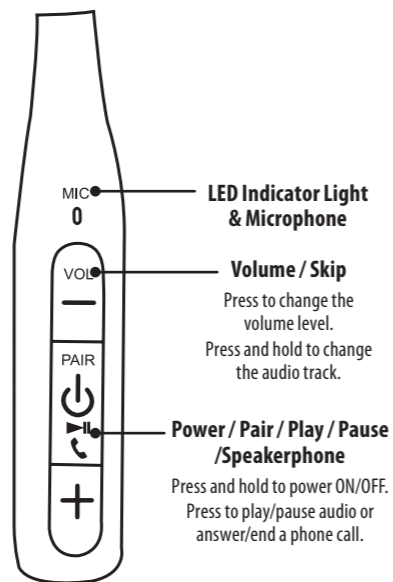

Charging the Battery

Initial charge time is approximately 2 hours. Charge fully before use.

- Pull back the cover on the Micro-USB charging port and connect it to the USB port of a powered on computer or USB power adaptor (not included) to charge.

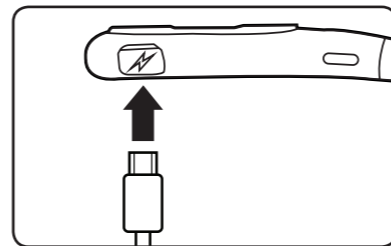

Power Status	Indicator Light
Power ON	Flashing blue light
Low Battery	Flashing red light
Charging	Solid Red light
Finished Charging	Solid Blue light

Bluetooth Connection

1. This unit features automatic device pairing and is ready to pair as soon as it powers on. Power on the headset by pressing and holding the **Power button**, then a voice will announce, "Power ON." The headset is ready to pair.
2. To connect to the headset, open the Bluetooth Settings menu on your smartphone or tablet and select **IAEB109** from the list. If need be, refer to the user manual for your device for more specific instructions on Bluetooth pairing.
3. When successfully connected, a voice will announce, "Bluetooth connected." Use your smartphone or tablet to select and play media. Use the controls on your device or the headset to play, pause, or skip audio, and adjust the volume.
4. After initial pairing, the headset will automatically connect to the last device used whenever powered on. To pair to another device, begin with the unit powered OFF, then press and hold the **Power/Pair button** on the headset and connect to it using the new device.

Playing Audio Wirelessly

1. After connecting Bluetooth, use the controls on the connected device to select and play audio.
2. Use the controls on the unit or the connected Bluetooth device to play, pause, or skip audio, and adjust the volume level.

Using the Speakerphone

1. To accept a call, press the **Speakerphone** button or use the controls on the connected phone.
2. To end a call, press the **Speakerphone** button or use the controls on the connected phone.

Troubleshooting

If the earbuds should become unpaired or will not connect normally, open your device's Bluetooth Settings Menu and follow these steps.

- Disconnect, then reconnect to the earbuds.
- If the problem persists, delete the earbuds from the list of available devices ("Forget This Device").
- Turn Bluetooth OFF then ON again, and repeat the **Bluetooth Connection** steps.