

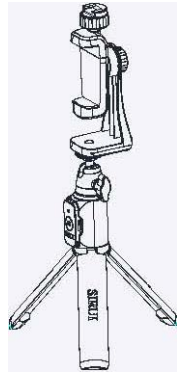

ic Equipment

Instructions

TSH-01X Table-Top Tripod



1. Know the Product

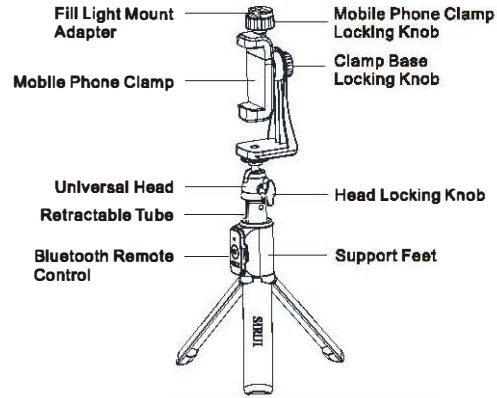

2. Use of Table-Top Tripod

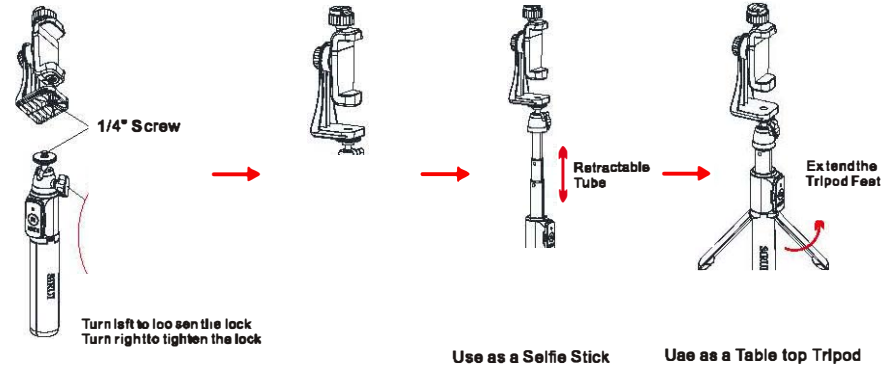

3. Use of Mobile Phone Clamp

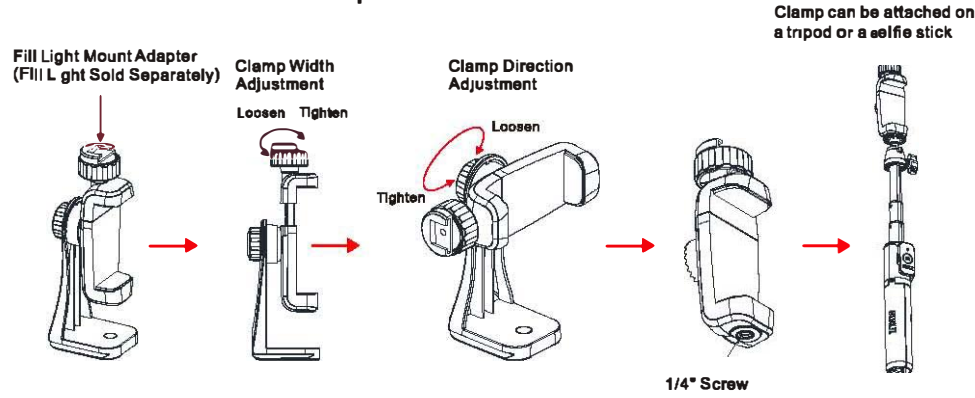

4. Use of Bluetooth Remote Control

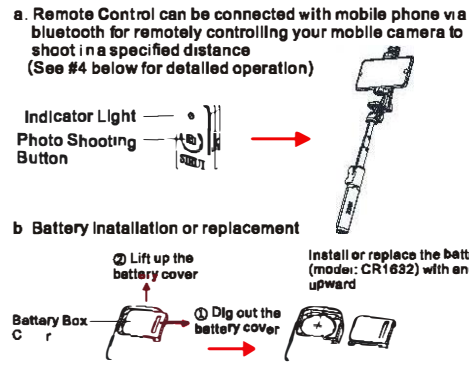

1 Know the Product (fig 1)

The Table-top Tripod is composed of a Support Feet, Mobile Phone Clamp, and a Bluetooth Remote Control.

2. Use of Table-Top Tripod (fig.2)

The product can be used as a Selfie Stick or a Table-top Tripod. The height of it can be adjusted as desired.

3. Use of Mobile Phone Clamp (fig.3)

The Clamp of product can hold a mobile phone with size within 4-6 inches. The mobile phone held on the Clamp can be adjusted for its direction by turning the locking knob behind the Clamp. The Clamp can be attached to a tripod or selfie stick.

4. Use of Remote Control (fig 4)

- Bluetooth Function:** Press and hold the "Bluetooth" button for 4 seconds, when the indicator light of it is flashing, the Remote Control will enter the search mode for connecting device via bluetooth (bluetooth signal name: SIRUI). The Indicator Light will be off after it's connected.
- Shooting Function:** Press the "Shoot" button for photography. Long press on the button is useless.
- Sleep Mode:** The Remote Control will enter the Sleep Mode when it's not operated within 5 minutes, or can not be connected with any device via bluetooth within 2 minutes.
- Wake Mode:** When the Remote Control is in the Sleep Mode, press the "Wake" button to re-connect to the last device automatically via bluetooth. When it's connected, the Indicator Light will flash once, otherwise it will enter the Sleep Mode again.
- Low Power Indicator:** When the button type battery in the Remote Control is in low power, the indicator will start to alarm, and the LED light will flash every 0.5 second, the Remote Control will turn off automatically after 10 seconds.

Caution:

- Do not exceed the recommended load limit of the head and/or tripod. (Please refer to product specifications.)
- Please make sure that the locks are securely tightened when in use.
- This product should not be used in environments that exceed the following conditions (-40 ~ +100°C / -40 ~ +212°F). And, when used in damp, dirty or dusty environments, please clean and dry thoroughly after use to assure proper functioning in the future. It is not recommended to expose this product to seawater. If exposed, please clean with mild soap and warm water and towel dry.
- Please keep from high temperatures and direct exposure to bright sunlight for extended periods of time.
- Please do not leave the equipment alone in a public place which can be an inconvenience or hazard to others.
- To protect your camera gear please remove it from the tripod/bell head when transporting from place to place.
- Please use a soft towel with warm water and mild soap to clean the locking system and gliding parts when necessary. Towel dry before storing the tripod.
- Under most situations, there is no need to lubricate any parts of this product. The addition of most lubricants will gum up the mechanisms and reduce their normal gliding characteristics. Please call or email us if you have any questions or special needs.
- Please keep this product away from all electrical power sources.

Specifications are subject to change without notice

WARRANTY CARD / INFORMATION

Dear SIRUI Customer, Thank you for your purchase of SIRUI Professional Products! SIRUI warrants that your purchase is free from defects in materials and workmanship under normal use during the Limited Warranty Period. The Warranty begins on the original date of purchase on your sales receipt and is not transferable. If service is required, a copy of the sales receipt must be included with an explanation of the problem.

Product	Warranty Length
Table Top Tripod	1 year

Model _____ Date _____
Store _____ Serial Number: _____

Warranty coverage can differ from region to region. Please see the contact information below for product registration, information and service for the region the product was purchased in.

SIRUI 1 Year Limited Warranty of the product. This warranty shall be limited to repair, adjustment and/or replacement at SIRUI or its authorized distributor's option, of defect or damage, free of charge (except the cost of transportation to the distributor/service center). Responsibility is limited to the actual cost of the item. Call or Email with questions and service before sending any product to the center in your region. Below is a listing of contact information for Product Registration Service Inquiries and Questions. SIRUI will not be responsible for expenses or inconveniences, or consequential damages to equipment, or by breach of any expressed or implied warranty.

Limitations
Warranty is nontransferable. This warranty covers all defects encountered in normal use of the equipment and does not apply in the following cases:
1. If the equipment has been serviced by other than an authorized SIRUI Service Center.
2. Damage to the equipment is due to modification (including but not limited to the removal of ball head clamps) overloading, mishandling, abuse, accident, sand, corrosives, water damage* or not following operating instructions.
3. No valid proof of purchase is provided.
4. Damage caused by acts of nature (including but not limited to fire, floods, earthquakes).

Warranty Address and Contact Information
(Please contact the seller or the local distributor where the product was purchased for warranty issues or questions and before any product is sent.)

1 Guangdong SIRUI Optical Co., Ltd
The Third Industrial District Wugulahan Town Zhongshan City Guangdong China
Tel: 0086-760-86897373 Fax: 0086-760-86207082
Http://www.sirui.com E-mail: info@sirui-photo.com
Service Hotline: 0086-400-830-2299

2 SIRUI USA, LLC
Add: 29 Commerce Court Verona, NJ 07044
www.sirui.com
Service: Toll Free 888-373-0829 E-mail: info@sirui.com
FOR PRODUCTS PURCHASED IN THE USA PLEASE SEE
For full details on USA Warranty Terms and Limitations
www.sirui.com/warranty.html
To register products: www.sirui.com/productregistration.html

3 Focus Nordic AB
Fortechne c support, service or repairs, please contact
Sweden: info@focusnordic.se www.focusnordic.se
Norway: info@focusnordic.no www.focusnordic.no
Denmark: info@focusnordic.dk www.focusnordic.dk
Finland: info@focusnordic.fi www.focusnordic.fi
Iceland: info@focusnordic.is www.focusnordic.is
Latvia: info@focusnordic.lv www.focusnordic.lv
Estonia: info@focusnordic.ee www.focusnordic.ee
Lithuania: info@focusnordic.lt www.focusnordic.lt
Poland: info@focusnordic.pl www.focusnordic.pl

4 SIRUI Europe GmbH (European Service Center)
Add: Fredericiestr. 2 14059 Berlin Germany
Phone: +49 221 94 99 54 50 E-mail: info@sirui.de
(Please contact the seller or your local distributor for warranty issues.)

5 TSE Imaging BV
Add: Argonweg 135 1362AD Almere The Netherlands
Telephone: +31 (0)36 8450348 E-mail: service@tseimaging.nl
(Exclusive Distributor for Netherlands, Belgium, Luxembourg)
www.sirui-photo.nl

6. 대왕엔터프라이즈
한국 총판, 기술지원 및 보증서비스 제공.
서울특별시 중구 남대문로 10 1층
Tel: 02 752-3304 Fax: 02-774 9903
www.sirui.co.kr loweprokr@gmail.com



Guangdong SIRUI Optical Co., Ltd

Address: The Third Industrial District, Wugulahan Town, Zhongshan City, Guangdong, China
Tel: 0086-760-86897373 Fax: 0086-760-86207082 Service Hotline: 0086-400-8302299
E-mail: info@sirui-photo.com Http://www.sirui.com P.C: 528458

TSH-01X Table-Top Tripod Data Chart

Section	Max Dia. (mm/inches)	Weight (kg/lb)	Max Loading (kg/lb)
TSH-01KX	4 16.3/0.72	0.23/0.51	0.3/0.66lb
	4 18.3/0.72	0.23/0.51lb	0.3/0.66lb
TSH-01WX	4 12.9/0.51	0.23/0.51lb	0.3/0.66lb
	4 12.9/0.51	0.23/0.51lb	0.3/0.66lb

FCC Statement

This equipment has been tested and found to comply with the limits for a Class B digital device, pursuant to Part 15 of the FCC Rules. These limits are designed to provide reasonable protection against harmful interference in a residential installation. This equipment generates uses and can radiate radio frequency energy and, if not installed and used in accordance with the instructions, may cause harmful interference to radio communications. However, there is no guarantee that interference will not occur in a particular installation. If this equipment does cause harmful interference to radio or television reception, which can be determined by turning the equipment off and on, the user is encouraged to try to correct the interference by one or more of the following measures:

- Reorient or relocate the receiving antenna.
- Increase the separation between the equipment and receiver.
- Connect the equipment into an outlet on a circuit different from that to which the receiver is connected.
- Consult the dealer or an experienced radio/TV technician for help.

This device complies with part 15 of the FCC Rules. Operation is subject to the following two conditions:

(1) This device may not cause harmful interference, and (2) this device must accept any interference received, including interference that may cause undesired operation.

Changes or modifications not expressly approved by the party responsible for compliance could void the user's authority to operate the equipment.