



Instructions

Swift P1 Gimbal



SIRUI Website

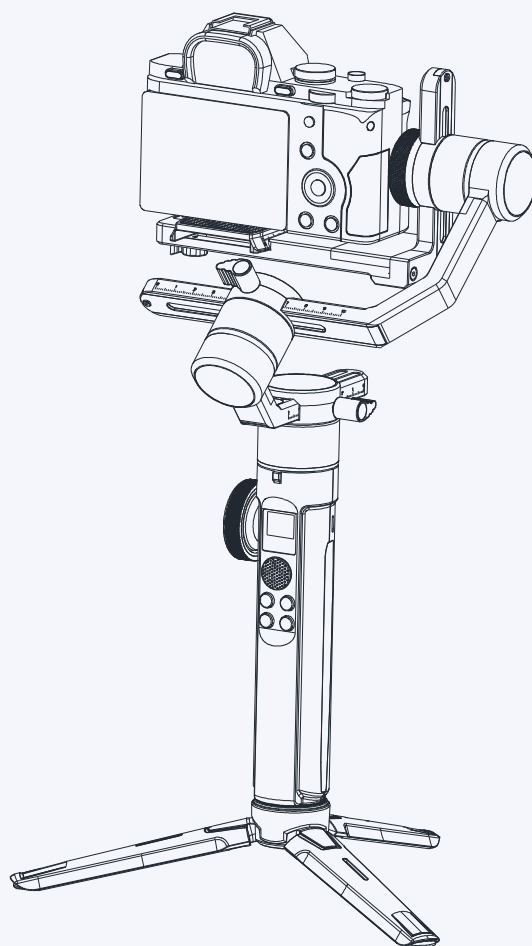

GUANGDONG SIRUI OPTICAL CO.,LTD.

Add: The Third Industrial District, Wuguishan Town, Zhongshan City,
Guangdong, China (Zip Code: 528458)

Tel: 86-760-88897373 Fax: 86-760-88207062

E-mail: info@sirui-photo.com Website: www.sirui.com

Know the SIRUI Swift P1

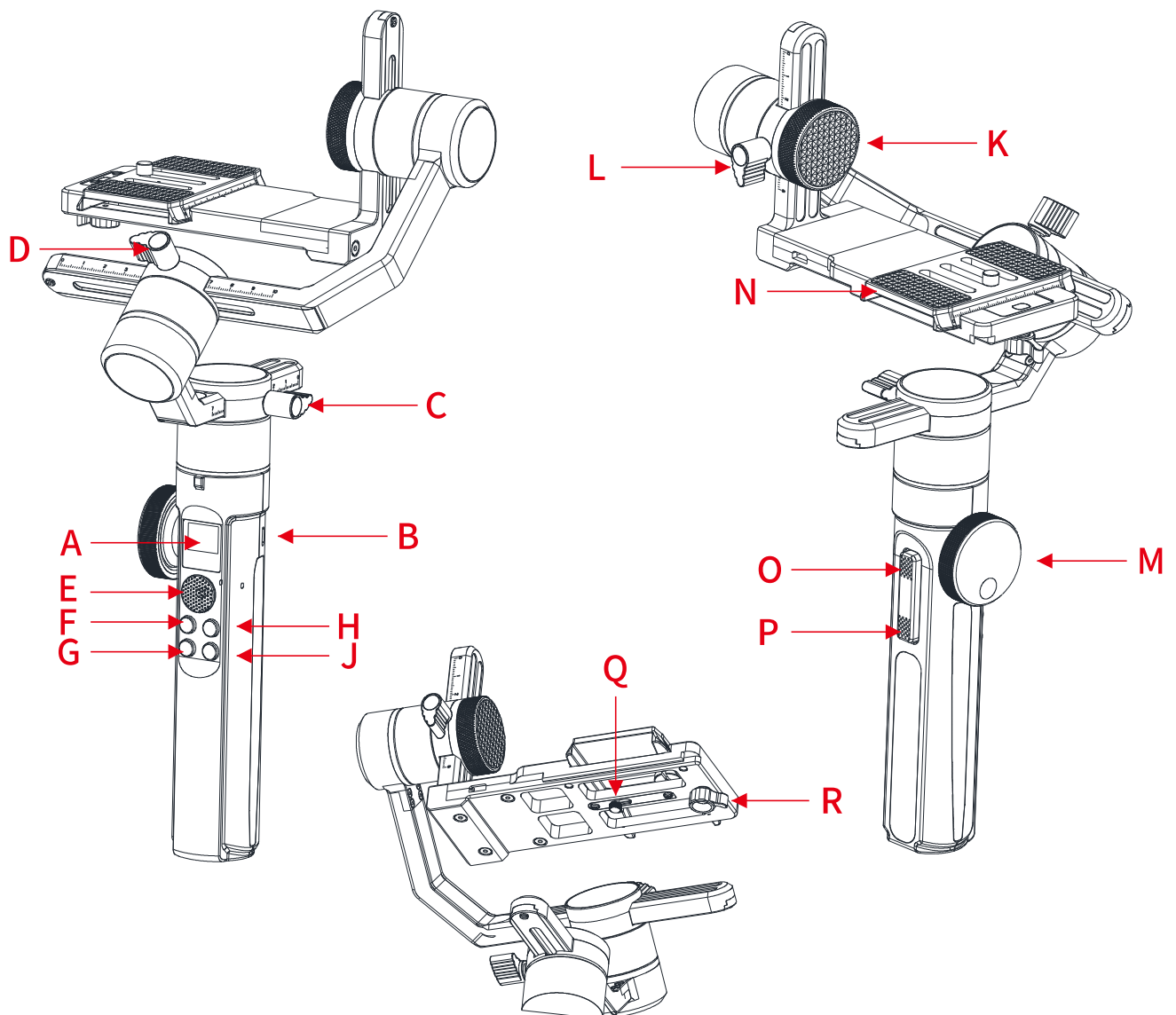

- A. OLED Screen
- B. USB Port
- C. Panning Balance Buckle
- D. Rolling Balance Buckle
- E. Tilting/Panning Control Knob
- F. Shutter Button (connection to the camera is required)
- G. Focusing Button (connection to the camera is required)
- H. Mode Switch Button

- J. Power Switch/Motor Force Switch
- K. Camera Regulating Knob
- L. Tilting Balance Buckle
- M. Wheel Dial
- N. Quick Release Plate
- O. Function Key 1
- P. Function Key 2
- Q. QR Plate Anti-slip Screw Lock
- R. QR Plate Security Buckle

※Camera is not included.

Included:

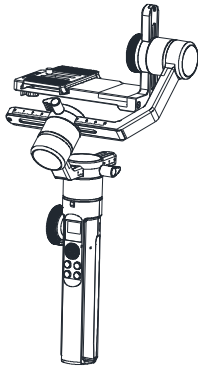

Swift P1 Gimbal x 1

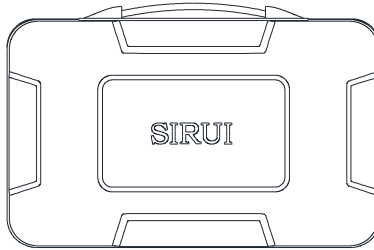

Protective Case x 1



Tripod x 1



Phone Clamp × 1

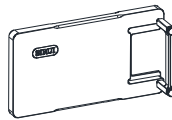

Camera Clamp × 1

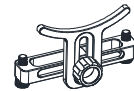

Camera Lens
Support Bracket × 1

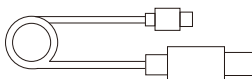

Camera Cables × 4
(Compatible with Sony, Panasonic,
Fuji and Olympus cameras)

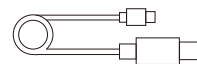

USB Cable x 1

1. Charge and Power on/off the Gimbal

Before use, plug the USB cable provided into the mini USB port on the handle and the other end to a power source to charge for 2.5 to 3 hours. The charging status will be displayed on the OLED UI.

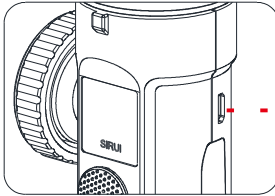

- - - USB Charging Port
(5V 2A)

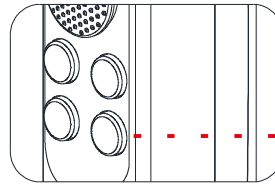

- - - Press and hold the Power
Switch 3 seconds to turn
on/off the Gimbal.

2. Attach the camera to the Gimbal

 It is recommended to power off the Gimbal before attaching or balancing the camera.

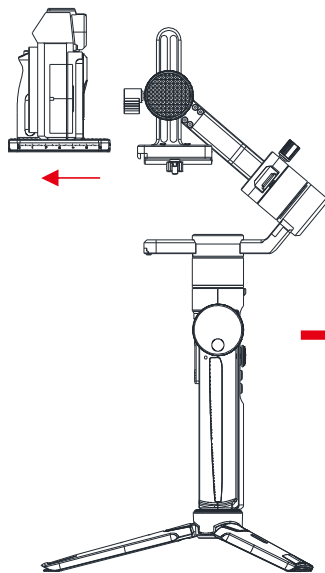

① Remove the quick release plate to attach to the camera

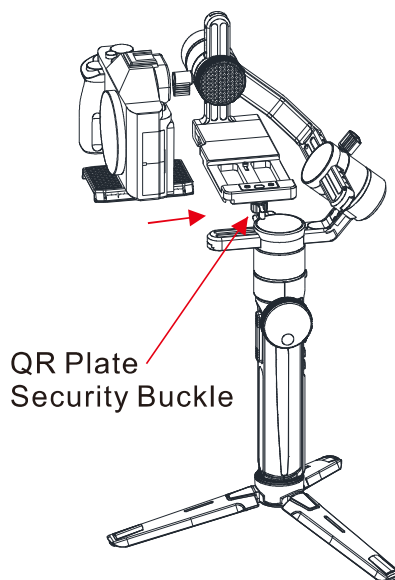

② Push the camera with the quick release plate into the camera mounting platform then secure with the QR Plate security buckle.

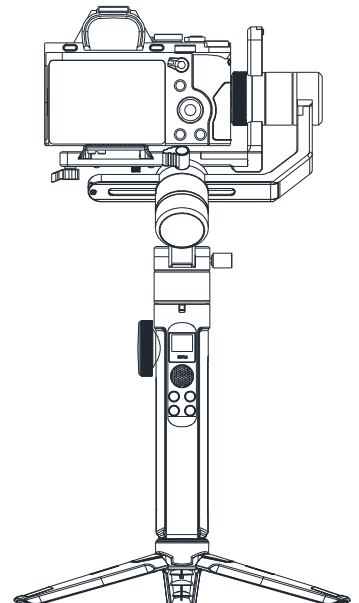

③ Attachment is completed.

Balance the camera:

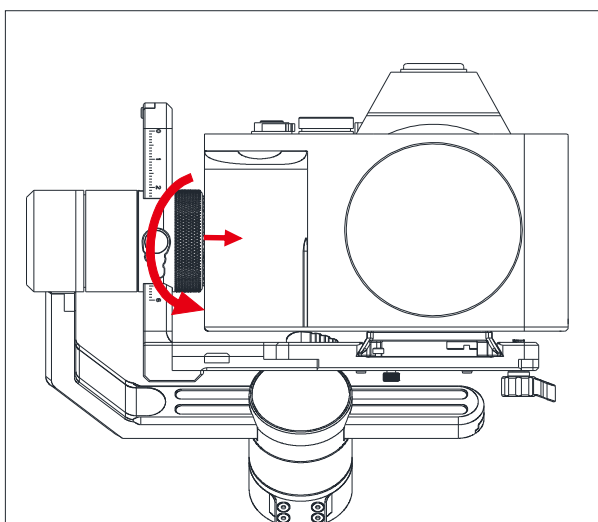
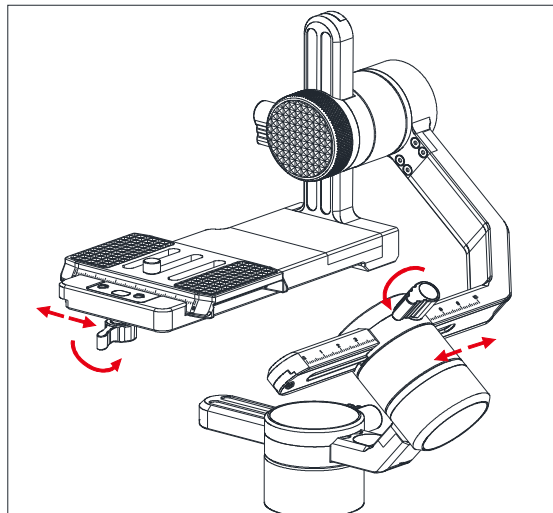
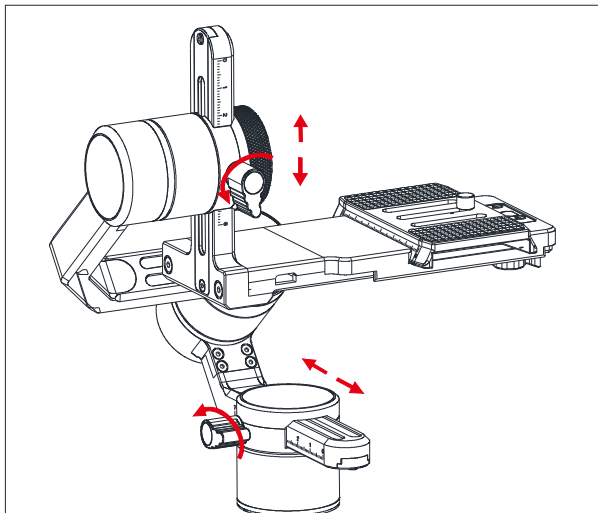

Note: The Gimbal will not function properly if the camera is not balanced.

Install the lens support bracket:

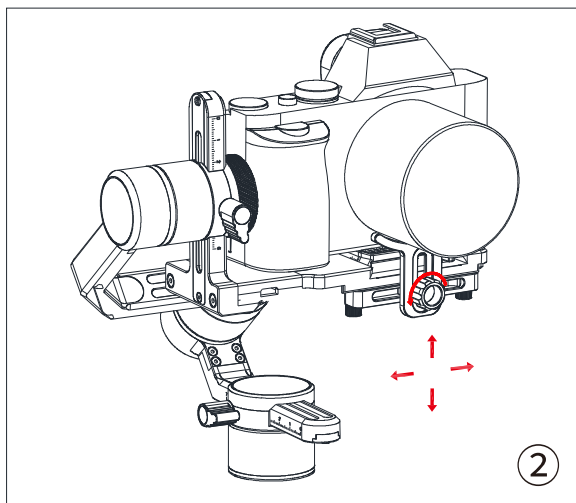
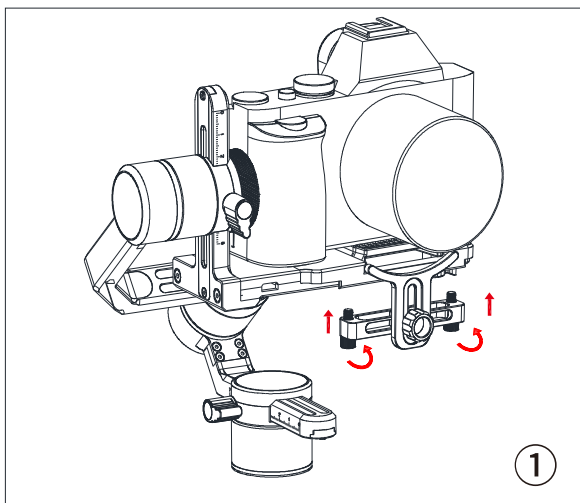

Note: Stabilize the long camera lens with the mounting bracket.

3. Operation

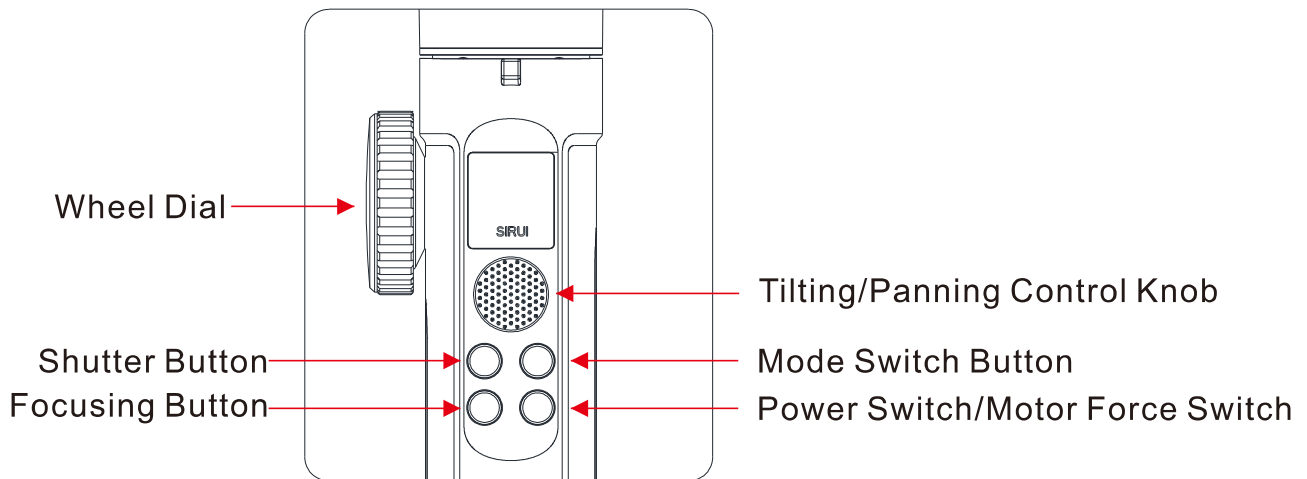

- To power up or off the Gimbal, press and hold the Power Switch for 3 seconds.
- Press the shutter button to control shooting when connected to the camera.
- Press the focusing button to control focusing when connected to the camera.



Motor Force Switch

Press the Motor Force Switch to activate the feature and select in one of 3 motor force levels: high force moment for heavier cameras, medium for mirrorless cameras small or general in size, low level for card cameras. Lower the force moment level if the Gimbal with the equipment attached vibrates when powering up.

※Increase the motor force to improve stability.



TL Tilting-Following Locked

Switch to lock the Tilting-Following feature while actively tracking the shooting object as you pan and roll the Gimbal.



TF Tilting-Following

Press the mode switch button to unlock tilting-following mode for active triaxial Track (tilting-rolling-panning).



L Locked

Lock the Active Triaxial Track.



PV POV (point of view)

Switched for POV shots.

Wheel Dial: Press down the wheel dial to switch shooting motion modes:



Zoom

Turn the dial to zoom when connected to the camera.



P Panning Motion

Turn the dial to control panning.



T Tilting Motion

Turn the dial to tilt the Gimbal.

Function Keys located on the back of the Gimbal handle:

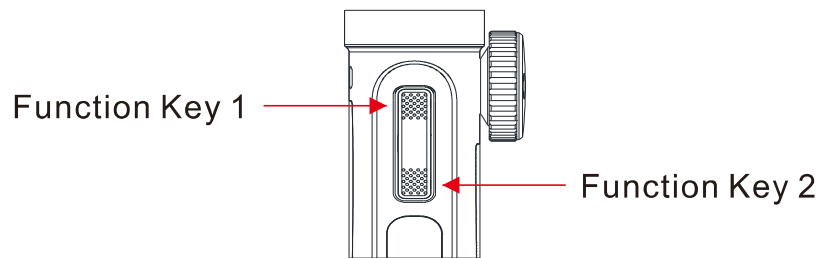

Function Key 1:

Press and hold down the upper Function Key 1 to activate the "Panning-Following" mode. Track the shooting objects actively as you pan the Gimbal and the phone quickly or proceed to move on to the next scene.

Function Key 2:

Press and hold down the lower Function Key 2 to switch between "Tilting-Following" and "Locked" modes.

Press the Function Key 2 twice to reset all axes.

Icons Displayed on the UI:



Bluetooth Connection:

This Bluetooth icon will flash when no longer connected.



Battery Level:

This battery indicator shows the current battery state and will flash when the battery level is low.



M-BLK Flash:

When blocked during use, M-BLK will flash on the OLED. To correct this, respond within 2 minutes by checking that the Gimbal Motor operation is blocked then press the Function Key 2 twice to resume operation. The Gimbal will otherwise automatically power off.



Battery Charging:

This indicates that the battery is charging while powered off. Refer to the OLED User Interface for the charging level status.



Warning: The Gimbal will automatically power off as you plug the USB cable into the USB port to charge when the Gimbal powers on. You can cancel the Auto Power-off in the App.

Specifications of the Swift P1

Product	Gimbal for Cameras	Static Battery Life to Battery Runtime	9 Hours
Model	SIRUI Swift P1	Operating Temperature	-10°C to 45°C/ 14°F to 113°F
Size	337x190x52.4mm/ 13.3x7.5x2.1inches	Max Load Capacity	900g / 1.98lbs
Weight	800g/1.76lbs	Tilting Range	330°
Charging Voltage/Current	5V/2A	Rolling Range	160°
Battery Capacity	5000mAh	Panning Range	620°

Compatible Cameras:

Brand	Model	Shooting Control via the P1 Gimbal	Compatible Lenses
Sony	Rx100 Series	Video Recording Auto Focus Electronic Zoom	×
	Alpha 9 Alpha 7R IV Alpha 7R III Alpha 7R II Alpha 7 III Alpha 7 II Alpha 7 Alpha 7S II Alpha 6500 Alpha 6400 Alpha 6300 Alpha 6000 Alpha 5100		Sonnar T*FE 35MM FE 28-70mm F3.5-5.6 FE 28mm E 35mm F1.8 OSS E 20mm F2.8 APS-C E 16mm F2.8 APS-C E 10-18mm F4 OSS ASPC FE 50mm F2.8 FE 28mm F2 FE 50mm F1.8 FE 35mm F1.8 ※Compatible with lenses lighter than 290g/0.64lbs and smaller than 72.5×83cm / 28.54×32.68inches
Panasonic	GH Series	Photograph Video Recording Auto Focus	H-X015GK/GKC H-H020AGK/AGKC H-H025GK H-X025GK/GKC H-F008GK/GKC
	G Series GX Series GF Series	\	
Fujifilm	X-H1	Photograph Video Recording Auto Focus	XF 16mm F2.8 XF 14mm F2.8 XF 18mm F2 XC 15-45mm F3.5-5.6
	X-T Series	\	
Olympus	E-M1 Mark II E-M5 Mark II E-M10 Mark III	Photograph Auto Focus	12mm F2 17mm F1.8 25mm F1.8 9-19mm F4-5.6 12-50mm F3.5-6.3 12-42mm F3.5-5.6 EZ 12-42mm F3.5-5.6 II R
	PEN-F E-PL9	\	
Canon	EOS M6 EOS M50 EOS M100	\	EF-M 11-22mm f/4-5.6 IS STM EF-M 15-45mm f/3.5-6.3 IS STM EF-M 22mm f/2 STM

Note:

To shoot via the Gimbal, connect the camera cables to the Gimbal and power up the Gimbal before turning the camera on.

1. The form will be updated without prior notice when the firmware releases.
2. The camera models not listed will be added based on the market feedback.

Cautions

1. Please avoid placing the Gimbal into fire or near hot substances or liquid.
2. Please avoid dropping or striking the product which may damage the Gimbal.
3. Please charge the Gimbal with battery chargers in accordance with safety regulations.
4. Do not attempt to disassemble, repair or modify the Gimbal as this will void the warranty.
5. Do not clean the Gimbal with cleaning products as this may damage the product.
6. Attempting to force the Gimbals movement may damage the product and void the warranty.
7. The Gimbal will not function properly when moving over the limit position. To recover the Gimbal, position the Gimbal manually then press down the power switch to turn on the Gimbal.

WARRANTY CARD/INFORMATION

Dear SIRUI Customer,

Thank you for your purchase of SIRUI Professional Product! SIRUI warrants that your purchase is free from defects in materials and workmanship under normal use during the Limited Warranty Period. The warranty starts on the date of purchase as indicated on your original sales receipt and is non transferable. If service is required, a copy of the sales receipt must be include with a detailed explanation of the problem.

Product	Warranty Length
SIRUI Swift P1 Gimbal	1 year

Model: _ _ _ _ _ Date: _ _ _ _ _

Store: _ _ _ _ _ Serial Number: _ _ _ _ _

Warranty coverage can differ from region to region.

Please see the contact information below for product registration, information and service for the region the product was purchased in.

SIRUI 1 Year Limited Warranty of the product. This warranty shall be limited to repair, adjustment and/or replacement at SIRUI or its authorized distributors option, of defective parts, free of charge (except the cost of transportation to the distributor/service center). Responsibility is limited to the actual cost of the item. Call or Email with questions and service before sending any product to the center in your region. Below is a listing of contact information for Product Registration, Service Inquiries and Questions. SIRUI will not be responsible for expenses or inconveniences, or consequential damages to equipment, or by breach of any expressed or implied warranties.

Limitations:

Warranty is non-transferable.

This warranty covers all defects encountered in normal use of the equipment and does not apply in the following cases:

1. If the equipment has been serviced by other than an authorized SIRUI Service Center.
2. Damage to the equipment caused by modification, overloading, mishandling, abuse, accident, sand*, corrosives, water damage* or by not following recommended use as instructed.
3. No valid proof of purchase is provided.
4. Damage caused by acts of nature (including, but not limited to fires, floods or earthquakes).
5. Scratches produced by normal wear and tear or damages caused by improper storage in extreme temperatures or humidity.
6. Batteries and other consumable parts are not in warranty.
7. Damage related to improper use with other third party products.
8. Any attempt to access circuitry or by using non SIRUI replacement batteries.

Note: This product is intended for personal home use. This product is not intended for commercial use and will not be covered under warranty.

Warranty Address and Contact Information:

(Please contact the seller or the local distributor where the product was purchased for warranty issues or questions and before any product is sent.)

1. Guangdong SIRUI Optical Co., Ltd.

The Third Industrial District, Wuguishan Town, Zhongshan City, Guangdong, China

Tel: 0086-760-88897373 Fax: 0086-760-88207062

Http://www.sirui.com E-mail: info@sirui-photo.com

Service Hotline: 0086-400 830 2299

Complaint Hotline: +86-181 6563 9388

(Monday to Friday: 8:15am~12:15pm, 14:00pm~18:00pm)

2. SIRUI USA, LLC

Add: 29 Commerce Court Verona, NJ 07044

www.sirui.com

Service: Toll Free 866-373-0829 E-mail: info@sirui.com

FOR PRODUCTS PURCHASED IN THE USA PLEASE SEE:

For full details on USA Warranty Terms and Limitations:

<https://www.siruiusa.com/warranty.html>

To register products: <https://www.siruiusa.com/product-registration.html>

3. European Service Center

Add: SIRUI Optical GmbH • Ernst-Augustin-Str. 1a • 12489 Berlin • Germany

Phone: +49 30 991 94 94 00 • Email: Info@siruioptical.eu

※ The company reserves the right to upgrade products and modify product specifications without prior notice. Please accept our apologies for any inconvenience we may have caused.

FCC Statement

This equipment has been tested and found to comply with the limits for a Class B digital device, pursuant to part 15 of the FCC Rules. These limits are designed to provide reasonable protection against harmful interference in a residential installation. This equipment generates, uses and can radiate radio frequency energy and, if not installed and used in accordance with the instructions, may cause harmful interference to radio communications. However, there is no guarantee that interference will not occur in a particular installation. If this equipment does cause harmful interference to radio or television reception, which can be determined by turning the equipment off and on, the user is encouraged to try to correct the interference by one or more of the following measures:

- Reorient or relocate the receiving antenna.
- Increase the separation between the equipment and receiver.
- Connect the equipment into an outlet on a circuit different from that to which the receiver is connected.
- Consult the dealer or an experienced radio/TV technician for help.

Caution: Any changes or modifications to this device not explicitly approved by manufacturer could void your authority to operate this equipment.

This device complies with part 15 of the FCC Rules. Operation is subject to the following two conditions: (1) This device may not cause harmful interference, and (2) this device must accept any interference received, including interference that may cause undesired operation.

RF Exposure Information

The device has been evaluated to meet general RF exposure requirement. The device can be used in portable exposure condition without restriction.