

Accessories

Please make sure the following items are included with your LED TV. If any items are missing, contact your dealer.

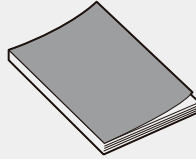

Remote Control



Owner's
Instructions

Introduction

Features

- TV adopts 43" TFT LED display screen
- Zero X radiation complies to green environment protection requirement
- Connect to computer directly to realize TV/monitor combo.
- USB 2.0
- 16:9 wide screen
- Auto tuning and fine tuning
- HDMI input
- Component Compatible (480i; 480P; 576i; 576P; 720P; 1080i; 1080P)
- Programmable sleep timer
- Wide range voltage input
- No-signal automatic power off

Basic Functions

Input terminals used for external equipment connection

- 1 x Antenna jack
- 1 x AV input (The multiplexing of AV and COMPONENT)
- 1 x SPDIF output
- 1 x RJ-45 NET Input
- 1 x Headphone output
- 2 x USB inputs
- 3 x HDMI inputs

Introduction

Specifications

Model	SC-4320NTV	
Display size	43" Diagonal (max.)	
LED panel resolution	3840X2160	
Speaker output power	2*8Ω10W	
Power supply	110-240V~, 50/60Hz	
TV receive system	Digital: ATSC Analog: PAL-M/PAL-N/NTSC-M	
Frequency range	Digital: Antenna:2-69 Cable:1-135 Analog: Antenna:2-69 Cable:1-135	
Video in	PAL/NTSC	
Power consumption	90W	
Standby consumption	≤ 1W	
Antenna input	75 ohms, unbalanced	
Controller power	DC 3V (Two AAA size batteries)	
Dimensions (LxWxH)	TV with stand	971.5x222.3x614.6mm
	TV without stand	971.5x82.3x568.9mm
Weight (Net weight)	TV with stand	7.62Kg
	TV without stand	7.5Kg
Work temperature	0°C-40°C	

NOTES:

- Design and specifications are subject to change without notice.
- Weight and Dimension shown are approximate.

Stand and wall-mounting instructions (optional)

How to assemble the stand

If you need to remove or assemble the stand please read the following instructions.

- Before attaching/detaching the stand, make sure to turn off the TV.
- Before performing work, spread cushioning over the base area to lay the LED TV on. This will prevent it from being damaged.

Assembling instruction:

Put the television on the table, fix the stands with screws given in the carton.

- Step1: Take out two stands from package, and insert them into bottom of TV;
Step2: Take out four screws provided with TV set and tighten them into screw holes;

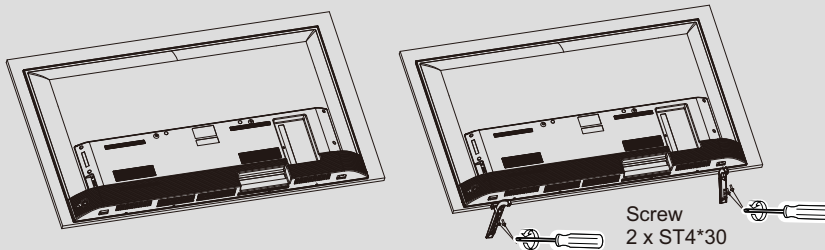

- To disconnect the stand from the TV, perform the above steps in reverse order.

Wall mounting instructions:

Wall mounting instructions(optional):

Your LED TV is able to accommodate wall mounting with the use of a wall mount bracket (not supplied with LED TV, please contact your local hardware store) and the mounting holes on the back of the unit. We recommend removing the TV stand prior to wall mounting the TV. Please see previous page for instructions on removing the stand.

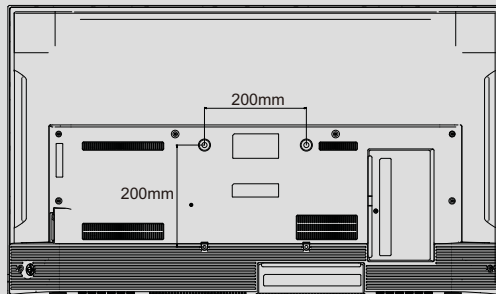

- This Quasar TV is compatible with a 200mm x 200mm mounting hole pattern.
- 2 pcs of type M6 screws and 2 pcs of type ST4 screws are required for installing the wall mount bracket to your Quasar TV. Do not use screws that are longer than 10 mm. Screws that are too long may cause damage to the inside of the TV set.

Note:

The product and illustrations in this user's manual is only for explanation purposes and may vary depending on model.

General Description

Overview of back panel

You can connect the TV with video devices such as DVD/VCD player, VCR and video camera to enjoy the high quality picture.

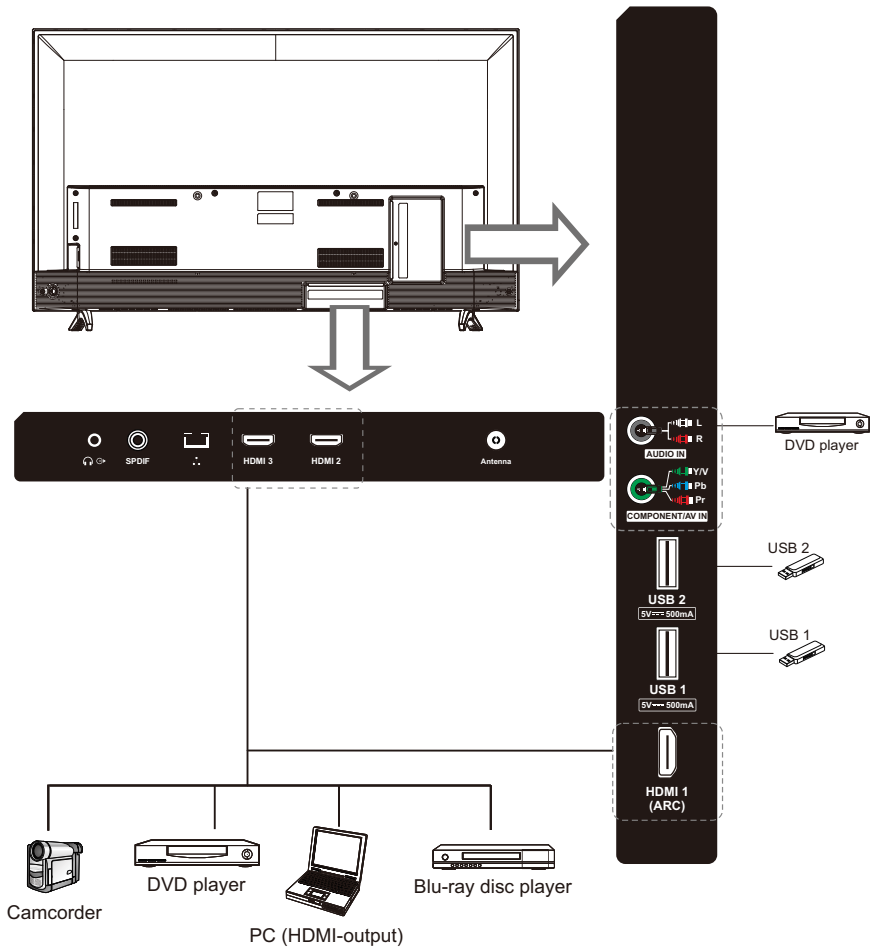

Note:

The product and illustrations in this user's manual is only for explanation purposes and may vary depending on model.

General Description

Overview of front panel

The buttons on the lower-left panel control your TV's basic features, including the on-screen menu. To use the more advanced features, you must use the remote control.

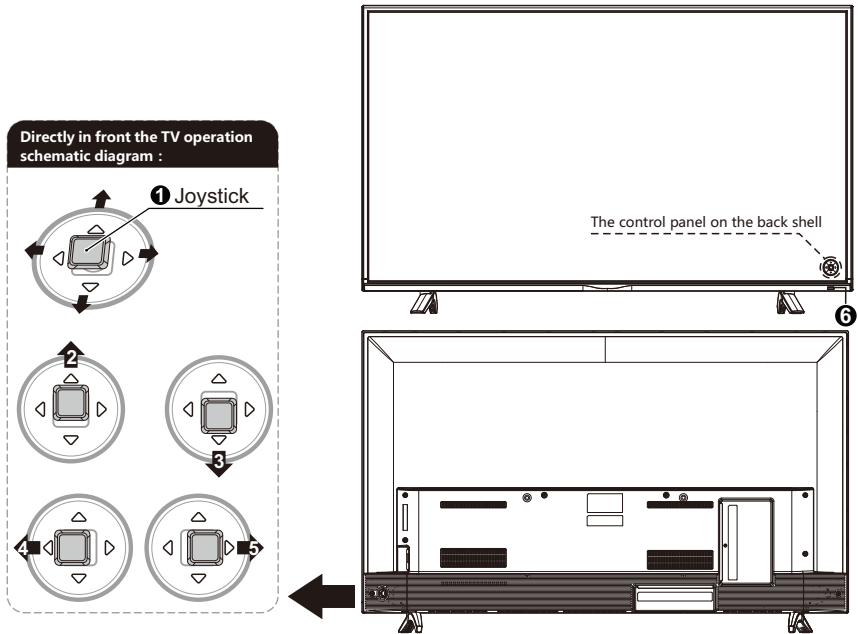

- 1** □ Centre Press this button on the control panel one time as CONFIRM at any menu. Press and hold this button to display FUNCTION menu at any menu. Press and hold this button to turn on TV when it is in standby mode.
- 2** ↑ Up Push one time: Use to select menu item if menu on TV. Use to go to last channel when watching TV.
- 3** ↓ Down Push one time: Use to select the next menu item if menu on TV. Use to go to next channel when watching TV. Push and hold this button to return to the last page.
- 4** ← Left Push one time: Use to select the left menu item if menu on TV. Use to decrease volume when watching TV.
- 5** → Right Push one time: Use to select the right menu item if menu on TV. Use to increase volume when watching TV.
- 6** Remote control sensor / Power indicator

Note:

The product and illustrations in this user's manual is only for explanation purposes and may vary depending on model.

General Description

Overview of Remote Control

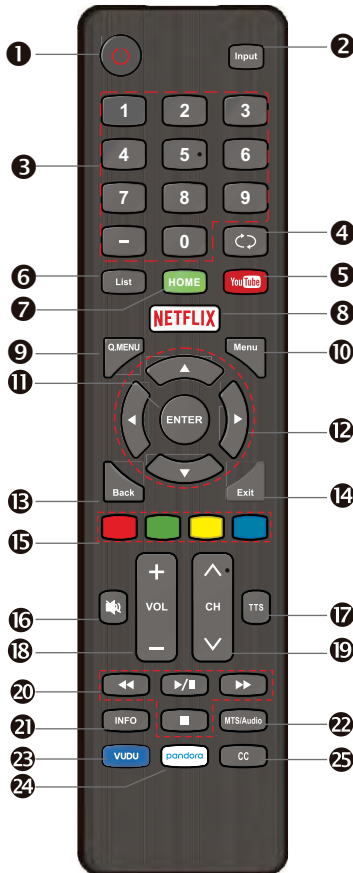

Loading batteries:

- 1) Remove the lid of the battery compartment.
- 2) Insert 2 size AAA batteries with polarities as indicated inside the compartment.
- 3) Replace the lid.

Note:

- 1) A loading of batteries should be last one year under normal use.
- 2) If you don't intend to use the remote control for a long period of time, remove batteries to avoid damage due to leakage.
- 3) Do not mix old and new batteries or different types.
- 4) Do not throw batteries into fire or water.
- 5) The batteries (battery pack or batteries installed) should not be exposed to excessive heat such as sunshine, fire or the like.