

# 3-in-1 Dog Training Collar User Manual

Thank you for selecting our dog training collar. You may have a kind of partnership with your pet, so as to create a harmonious and happy time together. Our mission is to provide safe tools and technologies for your pet, so that it can be trained successfully.

## Safety Information

### Warning:

If your dog is aggressive or likely to have offensive behaviors, then please do not train it, because an aggressive dog may cause severe damages or even death to its owner and others. Supposing that you are not sure whether this product is suitable for your dog, please consult your veterinarian or the certified dog trainer. The remote dog training collar is only applied to healthy dogs. Thus, you are kindly suggested to bring your dog to the veterinarian so as to check whether it is safe before using the dog training collar.

### Caution:

Please pay attention to the risk of skin injuries, and read the manual carefully. It is of vital importance to have the appropriate collar because a loose collar may lead to inconsistencies in performance. Besides, wearing the collar too long or too tight may result in skin injuries, for example, the dog's skin may be reddened firstly and then suffer pressure ulcer (commonly known as bedsores). The following notices will help to keep your pet safe and comfortable. Millions of pets feel cozy while touching the collar, but some are sensitive to the contact pressure.

- Avoid putting the collar on your dog for more than 12 hours every day.
- Try to relocate the collar on your pet's neck every 1 or 2 hours, in order to make sure your pet can wear it comfortably and correctly.
- Operate in line with the instructions of this manual and inspect the coordination with your pet to prevent excessive pressure.
- Never touch the electronic collar, which may cause excessive pressure to the contact point.
- Clean the dog's neck and the collar's contact point with damp cloth every week.
- Check whether there are symptoms like rash or ulcer in the contact part every day. In case of rash or ulcer, stop using the collar until the skin is healed. For illness lasting for more than 48 hours, please go to the veterinarian for help.

## Functions of the Remote Control

1. Antenna
2. LED Lamp
3. Emission Signal Blue Light/Charging Red Light
4. Display Screen
5. Horn Button
6. Electric Shock Button
7. Vibration Button
8. 1/2 Channel Button
9. Lighting Button
10. Minus Button
11. Plus Button
12. Type C Charge Couple

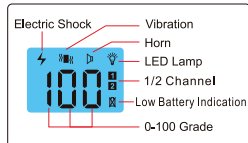
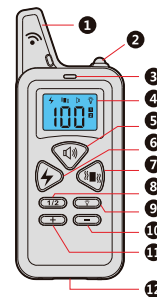

## Functions of the Receiver

13. Electric Shock Contact Head
14. Working Indication Blue Light and Charging Red Light
15. Power and Matching Button
16. Charge Couple
17. Collar Installation Opening

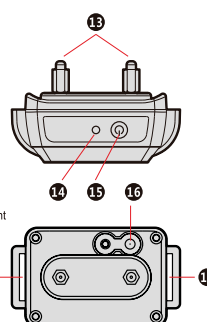

## Functional Operations of the Remote Control



1. Horn Button: Press it as long as 2 seconds to start up the remote control, then press again shortly to issue the horn order, and then press it for a filter longer for giving out the continuous horn order. (For starting up the remote control, you can only press the horn button as long as 2 seconds. No press within 2 minutes will lead to automatic shutdown.)
2. Vibration Button: Press it to enter the Vibration Mode, press it again to issue the vibration order, and then press it for longer for giving out the continuous vibration order. Press the button to add 1 to the figure, and press it longer to add continuously; press the button to subtract 1 from the figure, and press it longer to subtract continuously.
3. Electric Shock: Press it to enter the Electric Shock Mode, press it again to issue the electric shock order, and then press it for longer for giving out the continuous electric shock order. Press the button to add 1 to the figure, and press it for longer to add continuously; press the button to subtract 1 from the figure, and press it for longer to subtract continuously.
4. Press the button to switch the receiver.
5. Lighting button: In any status, press this button to turn on the lighting lamp, and press it again to turn it off; pressing the button can switch the lighting lamp between On and Off.

Note:  
 \* The buttons and can only be used to adjust the strength of vibration and electric shock. When the figure is subtracted to 0, it will turn to 100, and when it is added to 100, it will turn to 0.  
 \* The backlight will be on for 12 seconds after each press on the button, and then it will be off. No press on the button within 2 minutes or charging will lead to automatic shutdown.  
 \* At the instant of connecting the battery, the backlight, working and charging indicator light will be on, and the LCD will be displayed on full screen.

## Functional Operations of the Receiver

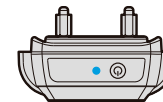

1. Tap the button once to start up / shut down (beep 3 times when starting up, and beep twice when shutting down).
2. The blue indicator light will flicker twice every 10 seconds after starting up, which means that the light is on at present. The blue indicator light is normally off in the shutdown mode!
3. In the starting up mode, the systematic working indicator light (blue) will be on after receiving the signal, at the same time, the horn / electric shock / vibration can be operated.
4. Press the button for 5 seconds, then the buzzer will give out a long beep once (the sound lasts for 1 second), at this time, the receiver enters the matching mode. After receiving any code conforming with rules, the receiver will latch and only receive the signals from this transmitter since then, while any signal from other transmitters will be blocked out. Only by rematch can the receiver receive signals from other transmitters.
5. If the receiver does not receive any signal within 10 seconds or is at rest, then it will shut down automatically after 10 minutes.

Note: At the instant of starting up, the buzzer, working and charging indicator light will work for 1 second and then stop.



### Horn Test:

- Press the horn button to test the horn's functions;
- The receiver will beep, indicating that the beeping function is normal.



### Static Electric Shock Function Test:

- Fix the suite of the tested lamp on the receiver's contact point;
- Press the electric shock button;
- The lamp is on, signifying that the electric shock function is normal.

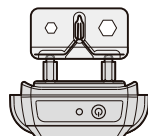

### Vibration Test:

- Press the vibration function button.
- The receiver vibrates, showing that the vibration function is normal.

Reminder: The grade under horn mode is unable to be adjusted and it will be set as zero by default.

## Install the Collar Receiver

- The appropriate tautness and installation position of collar belt are rather important to the effective training.
- The contact point must directly touch the pet's skin under its neck.

## To ensure proper cooperation with your pet, please follow the steps below:

- Make sure that the collar belt has been fastened well;
- Let your pet stand in a comfortable way (A);
- Put the collar receiver on the pet's neck near its ears, and make the contact point under your pet's neck align with its skin (B);
- The collar shall be in a good fit and be loose enough, taking one-finger between the belt and your pet's neck as the best distance (C).



### Reminder:

- Sometimes you need to trim the dog hair at the contact point, in order to ensure consistency between the contact positions.
- Do not shave all the hair at the dog's neck, since it will increase risks of skin irritation.
- Check the collar's tautness regularly, which will bring more comfort to your pet.

## Charging Connection

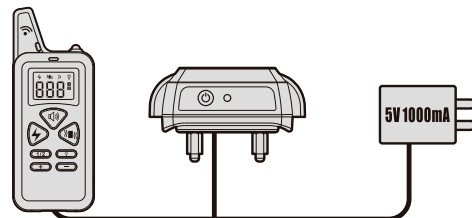

## Charging Description:

1. Charge the remote control and receiver;
2. Remote control: Please fully charge the remote control and receiver before using this product. The red indicator light flickers when charging, and it will be normally on after full charging;
3. Receiver: The red indicator light flickers when charging, and it will be normally on after full charging;
4. The charging period is 3 to 4 hours.

To provide your dog with comfort and safety, please ensure that the conductive screw cover is on the stainless steel probe as follows:

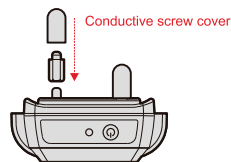

### Note:

In need of testing the light and static electric shock, please remove the screw cover first. When you put the receiver on your dog, please install the conductive screw cover back. (The conductive screw cover can transmit the static shock!)

## Frequently Asked Questions

### Is the collar receiver waterproof?

Yes, the receiver is completely waterproof.

### Is the remote control transmitter waterproof?

No, the remote control transmitter must be far away from water.

### How long can I continuously provide vibration or electric shock for my pet?

You can use the vibration or static vibration, and press the button for longer to keep continuous vibration. It is suggested that any vibration shall not last for more than 10 seconds. Frequent electric shock is not suggested. Please contact your coach or veterinarian to discuss the frequency that your pet can accept.

### What shall I do if my dog suffers from redness or inflammation on its neck?

Stop using this product for at least 48 hours. If the illness continues for more than 48 hours, please consult the veterinarian.

### Can I tie the leather belt to the receiver collar?

No, this will cause the contact point to stick tightly to your dog's neck.

### If necessary, please use a separate collar.

### When shall I charge the remote control and receiver?

Remote control: If the low-battery symbol blinks at the bottom of the LCD (Liquid Crystal Display), it signifies that the power is lower than 30%, then please charge in time. Receiver: If the indicator light is not on in time of starting up, it indicates that the battery is dead and please charge it in time.

| Size    | Neck Girth (IN) | Chest Girth (IN) | Back Length (IN) | Weight (LBS) | Breed                                  |
|---------|-----------------|------------------|------------------|--------------|--|
| X-small | 7.8-8.6         | 9.8-11.8         | 7.4              | 1-10         | Chihuahua, Yorkshire, Terrier          |
| Small   | 7.8-9.4         | 11.4-14.4        | 9.0              | 11-25        | Poodle, pomeranian                     |
| Medium  | 9.0-11.0        | 13.7-16.5        | 11.0             | 26-40        | Shih Tzu, Maltese Dog                  |
| Large   | 10.6-12.2       | 16.1-18.5        | 12.2             | 41-70        | Miniature Schnauzer, Pekingese         |
| Large   | 11.8-13.3       | 18.1-20.8        | 13.7             | 71-90        | English Cocker Spaniel                 |
| Large   | 12.9-14.5       | 20.4-23.2        | 15.7             | 91-110       | Beagle                                 |
| X-Large | 16.9-18.9       | 29.9-33.0        | 23.6             | N/A          | Husky                                  |
| X-Large | 18.5-20.4       | 34.6-38.1        | 23.6             | N/A          | Labrador Retriever                     |
| X-Large | 20.4-24.4       | 36.2-39.3        | 27.5             | N/A          | Golden Retriever, Old English Sheepdog |

Packing List: Transmitter / Receiver / Data Charging Cable / Power Adapter / Electric Shock Test Lamp / Collar / Manual  
 Battery Description: 500mAh batteries are respectively installed in the transmitting terminal and receiving terminal, with the stand-by time longer than 3 months.

### ***FCC Notice***

This device complies with Part 15 of the FCC Rules. Operation is subject to the following two conditions:

(1) This device may not cause harmful interference, and (2) this device must accept any interference received, including interference that may cause undesired operation.

NOTE 1: This equipment has been tested and found to comply with the limits for a Class B digital device, pursuant to part 15 of the FCC Rules. These limits are designed to provide reasonable protection against harmful interference in a residential installation. This equipment generates, uses and can radiate radio frequency energy and, if not installed and used in accordance with the instructions, may cause harmful interference to radio communications. However, there is no guarantee that interference will not occur in a particular installation. If this equipment does cause harmful interference to radio or television reception, which can be determined by turning the equipment off and on, the user is encouraged to try to correct the interference by one or more of the following measures:

- Reorient or relocate the receiving antenna.
- Increase the separation between the equipment and receiver.
- Connect the equipment into an outlet on a circuit different from that to which the receiver is connected.
- Consult the dealer or an experienced radio/TV technician for help.

NOTE 2: Any changes or modifications to this unit not expressly approved by the party responsible for compliance could void the user's authority to operate the equipment.