



# Xiaoyan Life Kit quick start

**Xiaoyan Home Center**  
**Model:TERNCY-GW01**



## Xiaoyan Home Center

Home Center is a ZigBee coordinator accessory. It bridges access to other ZigBee endpoint accessories. It has a virtual switch service "Permit Join", which is in control of if ZigBee endpoint devices are allowed to join its ZigBee network.



Indicator Light



Reset Button  
LAN Cable Interface  
Power Supply

## Install



Apply power to Home Center.

## Install

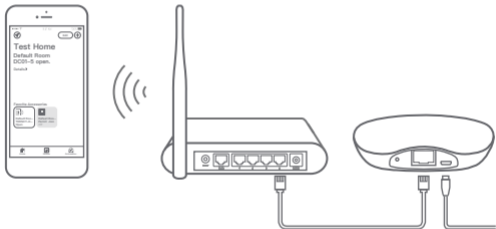

Connect network cable to Home Center, and connect your iOS devices to the WiFi on the same router.

## Setup Home Center in Xiaoyan App



1. Start Xiaoyan app.
2. Select Device tab at the bottom of the app.
3. Click the "+" sign at the top right corner.
4. Click "Add Home Center Accessory".
5. Scan the label on the back of the Home Center.

# Setup Home Center in Home App

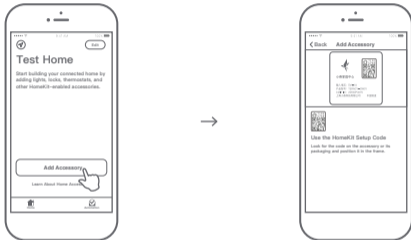

1. Start Home app.
2. Click "Add Accessory".
3. Scan the label on the back of the Home Center.

## Indicator Light State



Indicator Light

State	Green LED ON	Working normally
	Yellow LED Flashing	Connecting to network
	Yellow LED ON	About to reset to factory default
	Yellow/Green/Blue LEDs blinks	Performing OTA upgrading

## Reset to Factory Default

Press and hold the Reset button for about 5 seconds till the Yellow LED starts blinking, release the Reset button. The device will be reset to factory default settings in about 30 seconds.

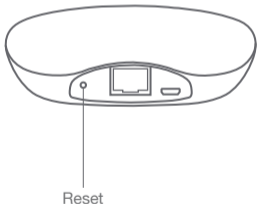



## FCC Statement

Any Changes or modifications not expressly approved by the party responsible for compliance could void the user's authority to operate the equipment.

This device complies with part 15 of the FCC Rules. Operation is subject to the following two conditions: (1) This device may not cause harmful interference, and

(2) This device must accept any interference received, including interference that may cause undesired operation.

## FCC Radiation Exposure Statement:

This equipment complies with FCC radiation exposure limits set forth for an uncontrolled environment. This equipment should be installed and operated with minimum distance 20cm between the radiator & your body.

Note: This equipment has been tested and found to comply with the limits for a Class B digital device, pursuant to part 15 of the FCC Rules. These limits are designed to provide reasonable protection against harmful interference in a residential installation. This equipment generates, uses and can radiate radio frequency energy and, if not installed and used in accordance with the instructions, may cause harmful interference to radio communications. However, there is no guarantee that interference will not occur in a particular installation. If this equipment does cause harmful interference to radio or television reception, which can be determined by turning the equipment off and on, the user is encouraged to try to correct the interference by one or more of the following measures:

- Reorient or relocate the receiving antenna.
- Increase the separation between the equipment and receiver.
- Connect the equipment into an outlet on a circuit different from that to which the receiver is connected.
- Consult the dealer or an experienced radio/TV technician for help.