



Thank you for selecting Globe as your smart home solution. With proper care, this product will provide years of pleasure and enjoyment.

SMART STRIP LIGHT

SAVE THESE INSTRUCTIONS

CAUTION IMPORTANT SAFETY INSTRUCTIONS

CAUTION: This strip light has a 2 year manufacturer warranty from date of purchase. If the strip light fails within that time, please contact our customer care team, or visit our website to submit a warranty request. This warranty is void if the product is misused in any way. This replacement is the only option available and liability for incidental or consequential damages are expressly excluded. Please see remaining CAUTION text for proper use.

For use only in 100-240V/50-60hz circuits. Risk of electrical shock. Do not open, no user-serviceable parts inside. This device is not intended for use with emergency exit fixtures or emergency exit lights, photocells and electronic timers. This device is intended for indoor use or weather protected fixtures. Do not use where directly exposed to water. Minimum operating temperature is -20°C (-4°F).

This device complies with Part 15 of the FCC rules. Operation is subject to the following two conditions: (1) this device may not cause harmful interference, and (2) this device must accept any interference received, including interference that may cause undesired operation. Any changes or modifications not expressly approved by the manufacturer could void the user's authority to operate the equipment.

WARNING: Changes or modifications to this unit not expressly approved by the party responsible for compliance could void the user's authority to operate the equipment. NOTE: This equipment has been tested and found to comply with the limits for a Class B digital device, pursuant to Part 15 of the FCC Rules. These limits are designed to provide reasonable protection against harmful interference in a residential installation. This equipment generates, uses and can radiate radio frequency energy and, if not installed and used in accordance with the instructions, may cause harmful interference to radio communications. However, there is no guarantee that interference will not occur in a particular installation. If this equipment does cause harmful interference to radio or television reception, which can be determined by turning the equipment off and on, the user is encouraged to try to correct the interference by one or more of the following measures: Reorient or relocate the receiving antenna. Increase the separation between the equipment and receiver. Connect the equipment into an outlet on a circuit different from that to which the receiver is connected. Consult the dealer or an experienced radio/TV technician for help.

RF EXPOSURE

The equipment complies with FCC radiation exposure limits set forth for an uncontrolled environment. This device should be installed and operated with minimum distance 20cm between the radiator and your body.

USER MANUAL NOTICE FOR LICENSE-EXEMPT RADIO APPARATUS

This device complies with Industry Canada license-exempt RSS standard(s). Operation is subject to the following two conditions: (1) this device may not cause interference, and (2) this device must accept any interference, including interference that may cause undesired operation of the device. CAN ICES-005(B)

RADIATION EXPOSURE STATEMENT:

This equipment complies with IC radiation exposure limits set forth for an uncontrolled environment. This equipment should be installed and operated with minimum distance 20cm between the radiator and your body.

FCC RESPONSIBLE PARTY

Globe Electric
2264 East 6th Street
San Bernardino, CA 92410
www.globe-electric.com

Since 1932, Globe has taken pride in offering products of the highest quality, and a level of service unparalleled in the industry. Should you encounter any difficulties, have any questions or simply wish to offer us your valuable feedback, you may contact us in the following ways:
Toll Free Telephone: 1-888-543-1388 (North America Only) / Toll Free Fax: 1-800-668-4562 (North America Only)
E-Mail: info@globe-electric.com
Mail: Globe Electric Customer Service Department
150 Oneida, Montreal, Quebec, Canada H9R 1A8
Please visit our website to discover other quality Globe products: <http://www.globe-electric.com>



Globe Suite™ Guide

Scan with your mobile device

FEATURES

- Flexible.
- Dimmable: 1% - 100%.
- 3000 K color temperature.
- Color Changing: full spectrum of RGB colors.
- Music sync feature: pulse your lights to the beat of the music.
- Select the color of your preference for different segments of the strip light.
- Interactive light patterns.
- Automate controls by setting routines.
- Pair with a virtual assistant to control the device with your voice.
- Create smart scenes with other Globe smart products to automate your home. Visit our website for more details: globe-electric.com/smart

SPECIFICATIONS

LED	3000 K
12 V	RGB colors
10mm wide, 5m long (16.4ft)	music synchronization
power cord: 1m (3.4ft)	20 color synchronizable segments
wireless type: 2.4GHz	cuttable
wireless standard: IEEE 802.11b/g/n	indoor use only
wireless range: 50m	input: 100-240V AC, 50/60Hz, 0.45A
standby wattage: 0.5W	output: 12V DC, 1A, 12W

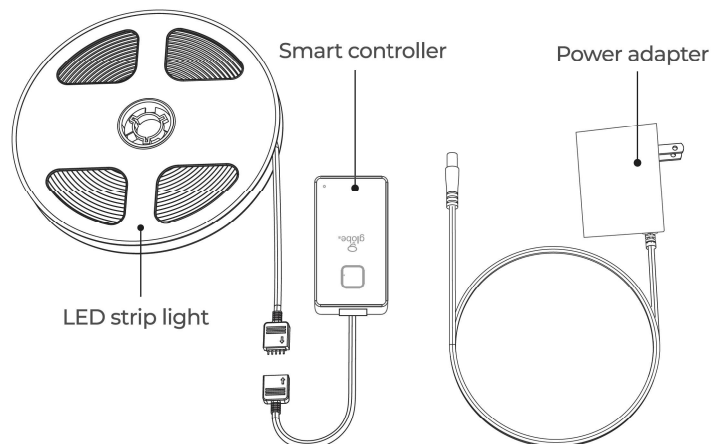

PRE-INSTALLATION

Planning Installation

Compare all parts with the "Hardware Included" section. If any part appears missing or damaged, do not install this product and contact the Customer Service team at 1-888-543-1388 or e-mail to info@globe-electric.com.

Tools Required



phillips head screwdriver



pencil

Hardware Included

NOTE: Hardware is not shown to actual size.

Item	Quantity
LED strip light	1
smart controller	1
power adapter	1
adhesive tape	1
mounting bracket	8
screws	16

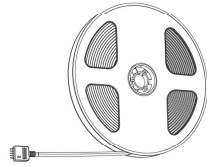

LED strip light



smart controller



power adapter

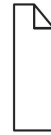

adhesive tape



mounting brackets



screws

MOUNTING INSTRUCTIONS

Step 1

Connect the LED Strip Light with the controller to the power adapter.

Step 2

Before mounting, plug the power adapter into an outlet and follow the "Connecting Instructions" (next page).

Step 3

Once the device has been connected successfully, select your mounting location and ensure the surface area is clean.

Warning: the mounting brackets included for added stability are not to be used on monitors, TVs or any electronic devices.

Step 4

Remove the liner from the back of the strip light to expose the adhesive.

Step 5

Mount the strip light.

Step 6

Use the included adhesive tape to secure the smart controller.

Step 7

For added stability, use the included mounting brackets with the screws.

Warning: the mounting brackets are not to be used on monitors, TVs or any electronic devices.

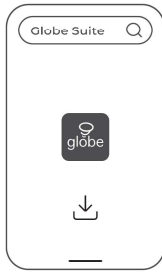

1

Download the Globe Suite™ app

Make sure your mobile device is running **iOS 9.0/watchOS 2.0/Android™ 4.4 or higher.**

- Download the **Globe Suite™** app from the iOS or Android store.
- Use your email to create an account and log in.

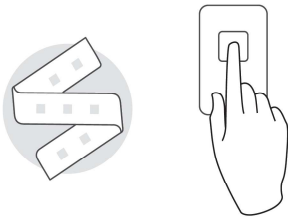

2

Set your smart strip light in pairing mode

- Plug your Smart strip light into the outlet.
- The light on the smart strip light should be **blinking rapidly**.

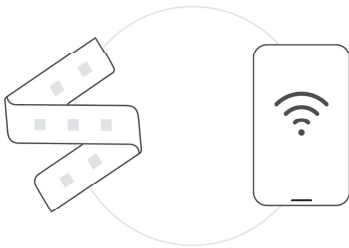

3

Connect to the Globe Suite™ app

On your mobile device, please ensure all requested permissions are enabled: **Wi-Fi, Bluetooth, Location Services.**

- Select the "+" icon in the top right of the Globe Suite™ app home screen.
- If the light is flashing rapidly, the "Scan" mode will detect your strip light within a few seconds. When discovered, select the strip icon, and tap on "Next."
- Enter your Wi-Fi credentials correctly.

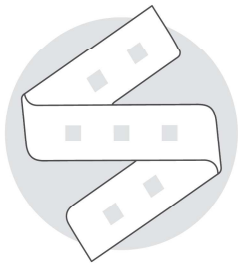

4

Your smart strip light is ready!

- Name your device and choose which room to place it in.
- You can now control your smart strip light directly from the Globe Suite™ app.
- Still need help? Select the "How do I set device into pairing mode" link on the "Scan" page and follow the in-app instructions or view the video.
- Or check out the QR code and look for the short instructional video.

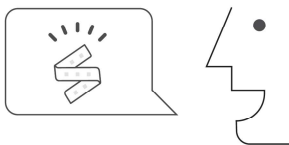

5

Set up voice assistance

- On the home screen, select "Profile," and select "Integration." Choose your voice assistant and follow the instructions within the app.
- Create Siri Shortcuts (for iOS)
 - On the home screen, select "Smart Scenes," then select the "+" icon to add a Trigger Scene.
 - Once completed, select "Add to Siri" and add the phrase to Siri Shortcuts.
 - *Please note that the exact phrase must be said to execute the Trigger Scene with Siri*

CONTROLLING THE SMART STRIP LIGHT THROUGH THE APP



White

Select your “white” option and adjust the brightness.



Color

Select the preferred color and choose between applying it to the entire strip or to specific segments of the strip light.



Mood

Select Moods to discover interactive color transitions with unlimited combinations.



Routines

Control timers and schedules.



Music

Select this function to let your strip light react to sounds.



Settings

For more information and configurations.

BASIC CONTROL

Power

Turn your smart strip light on or off directly.

ROUTINES

Timer

Set a countdown for your smart strip light to turn on or off once the timer runs out

Add a new schedule

Set a time and date for your smart strip light to either turn on or off to create additional routines that fit your specific needs.

GLOBE SUITE™ APP FEATURES

Device offline notification

Select to receive a notification if your smart strip light goes offline.

Device sharing

Share access to your connected device with another Globe Suite™ app user.

Device grouping

Group multiple Globe Suite™ smart strips together to control them in unison, rather than individually.

Add to home screen

Create a widget on your phone and/or tablet's home screen for easy access to the smart strip light.