

# PBT865 User Guide

(Front)



## Wireless Headphones PBT865 User Manual

### Getting Started

#### CAUTION

- **THIS IS NOT A TOY, Please keep away from children**
- Keep away from water and extreme temperatures
- Low power may cause poor Bluetooth connection or sound distortion
- Do not overcharge the battery

#### In the Box

- PBT865 - **Wireless Headphones** (x1)
- Micro-USB Charging Cable (x1)
- 3.5 mm Auxiliary Cable (x1)
- User Manual (x1)

#### Location of Controls

1. [▶/⏪] Button:  
(**Quick Press**) Play/pause, answer/end phone call  
(**Double Quick Press**) Dial last outgoing number  
(**Long Press**) Reject incoming phone call
2. [V+ / V-] Button:  
(**Long Press**) Increase volume  
(**Quick Press**) Skip to next track
3. [▶/V- / V+] Button:  
(**Long Press**) Decrease volume  
(**Quick Press**) Skip to previous track
4. [⏻] Button:  
(**Long Press**) Power ON/OFF
5. Micro-USB Charging Port
6. 3.5 mm Auxiliary Input Port
7. LED Indicator
8. Microphone



Questions?  
Need some help?  
This manual will help you  
enjoy your new product



or visit us at:  
[SouthernTelecom.com](http://SouthernTelecom.com)  
Click on "Product Support"

#### Location of Controls (cont'd)

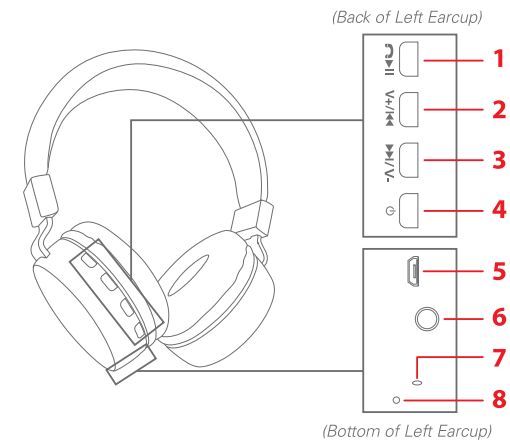

### Using the Headphones

#### Charging the Headphones

Plug the small end of the supplied micro-USB cable into the micro-USB charging port on the bottom of the headphones. Plug the large end into the USB port on a computer, a USB charging device, or **5V USB adapter** (not included) and plug into a wall socket.

The LED indicator will **turn RED** while charging and turn OFF when fully charged.

On low power, a voice will be heard indicating that the headphones need to be charged.

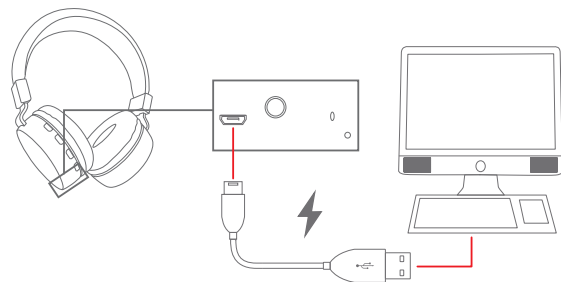

Make sure you charge your headphones for at least **2 - 3 hours** before using them for the first time.

#### Powering ON/OFF

- Turn the headphones ON/OFF by long pressing the [⏻] button. A voice will indicate that the headphones are powered ON. They will automatically re-pair to any nearby previously-paired device.

#### Phone Calls

- Quick press the [▶/⏪] button to answer an incoming phone call.
- Quick press the [▶/⏪] button to end a current phone call.
- Double quick press the [▶/⏪] button to dial the last outgoing number.
- Long press the [▶/⏪] button to reject an incoming phone call.

#### Playing Music

To enjoy music on your headphones, make sure that they are properly connected via Bluetooth or a 3.5 mm aux cable. If you are connecting for the first time, please consult the **Pairing the Headphones** or **Using with a Wired Device** section on the next page.

#### Playing/Pausing Music

- Quick press the [▶/⏪] button to pause/resume playback.

#### Skipping Songs

- Quick press the [V+ / V-] and [▶/V-] buttons to skip tracks.

#### Adjusting the Volume

- Long press the [V+ / V-] and [▶/V-] buttons to adjust the volume.

#### Pairing the Headphones

1. Power the headphones ON. The LED indicator will **flash RED and BLUE**.

2. Set your mobile device to search for Bluetooth devices. When it appears, select **PBT865-HP** from the list of found devices.

3. Once successfully paired, a voice will be heard and the LED indicator will **turn solid BLUE**.

#### On iOS or Android Devices

- Go to Settings -> Bluetooth  
(Make sure Bluetooth is turned ON)

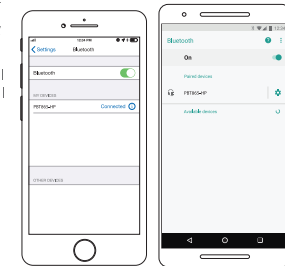

The screenshots above are typical of many Bluetooth-enabled devices in the market today and are used to assist in the explanation of the pairing process. Your Bluetooth-enabled device's interface and interaction with the headphones may differ slightly from the illustrations above.

#### Using with a Wired Device

Plug one end of the included 3.5 mm auxiliary cable into the 3.5 mm auxiliary input port on the bottom of the headphones. Plug the other end into the headphone jack on your device.

Legal Information

READ CAREFULLY AND SAVE FOR FUTURE REFERENCE

FCC Information

This equipment has been tested and found to comply with the limits for a Class B digital device, pursuant to part 15 of the FCC Rules. These limits are designed to provide reasonable protection against harmful interference in a residential installation. This equipment generates, uses and can radiate radio frequency energy and, if not installed and used in accordance with the instructions, may cause harmful interference to radio communications. However, there is no guarantee that interference will not occur in a particular installation. If this equipment does cause harmful interference to radio or television reception, which can be determined by turning the equipment off and on, the user is encouraged to try to correct the interference by one or more of the following measures:

- Reorient or relocate the receiving antenna.
• Increase the separation between the equipment and receiver.
• Connect the equipment into an outlet on a circuit different from that to which the receiver is connected.
• Consult the dealer or an experienced radio/TV technician for help.

Caution: Any changes or modifications to this device not explicitly approved by manufacturer could void your authority to operate this equipment.

This device complies with part 15 of the FCC Rules. Operation is subject to the following two conditions: (1) This device may not cause harmful interference, and (2) this device must accept any interference received, including interference that may cause undesired operation.

Radio Frequency Exposure Information

The device has been evaluated to meet general RF exposure requirement. The device can be used in portable exposure condition without restriction.

WARNING Li-ion Battery Inside

This product is fitted with a Li-Ion battery. Do not damage, open, or dismantle the battery and do not use it in damp and/or corrosive conditions. Use only with compatible chargers. Never dispose of batteries in a fire, and never expose them to high temperatures. Do not expose the product to temperatures exceeding 60°C (140°F).



Rain/Moisture Warning

- Do not expose the unit to extreme temperatures (heat or cold), open flames, etc.
• Do not submerge in water deeper than 1 meter.
• Do not open this product or attempt to repair the unit yourself should it not be working.

Rating Label Definitions

Direct current



Comply with Waste Electrical and Electronic Equipment (WEEE) Directive (2012/19/EU)



The product is in compliance of energy efficiency.



This symbol indicates that information could be exchanged between wireless devices such as personal digital assistants (PDAs), mobile phones, laptops, computers, printers and digital cameras via a secure, low-cost, globally available short-range radio frequency band. The Bluetooth word mark and logos are owned by Bluetooth SIG, Inc.

Warranty Information

This product as supplied and distributed new by AIT, Inc. ("AIT") to the original consumer purchaser is warranted by AIT against defects in material and workmanship for a period of one year from your date of purchase ("Warranty"). In the unlikely event that this product is defective, or does not perform properly, you may within one year from your original date of purchase return it to the authorized service center for repair or exchange.

TO OBTAIN WARRANTY SERVICE:

- Go to our website portal to receive an SRO number.
• Provide proof of the date of purchase within the package (dated bill of sale).
• Prepay all shipping costs to the authorized service center, and remember to insure your return.
• Include a return shipping address (no R.O. Boxes), a telephone contact number, and the defective unit within the package.
• Describe the defect or reason you are returning the product.

Your product will be repaired or replaced, at our option, for the same or similar model of equal value if examination by the service center determines this product is defective. Products received damaged as a result of shipping, will require you to file a claim with the carrier.

The shipping address of the authorized service center is:

AIT, Inc.
Customer Service Dept. 36
c/o Southern Telecom
400 Kennedy Drive
Sayreville NJ 08872

For further customer service:
SouthernTelecom.com
Click on Product Support

IN NO EVENT WILL AIT, ITS MANUFACTURERS, DISTRIBUTORS OR PLR IP HOLDINGS, LLC BE LIABLE FOR ANY INCIDENTAL, DIRECT, INDIRECT, SPECIAL, PUNITIVE OR CONSEQUENTIAL DAMAGES (SUCH AS, BUT NOT LIMITED TO, DAMAGES FOR LOSS OF PROFITS, BUSINESS, SAVINGS, DATA OR RECORDS) RELATED TO THIS PRODUCT. EXCEPT AS STATED HEREIN, NO OTHER WARRANTIES SHALL APPLY.



PLR IP Holdings, LLC, its licensees and affiliates, fully support all electronic waste initiatives. As responsible stewards of the environment, and to avoid violating established laws, you should properly dispose of this product in compliance with all applicable regulations, directives or other governmental in the area where you reside. Please check with local authorities or the retailer where you purchased this product to determine a location where you can appropriately dispose of the product.

Polaroid, Polaroid & Pixel, Polaroid Color Spectrum, and Polaroid Classic Border Logo are trademarks of PLR IP Holdings, LLC, used under license.



Printed in China
v1. 09-2018