



# QUICK START GUIDE



KNOG.COM

## CONTENTS

WHAT'S IN THE BOX .....	3
ENABLE PAIRING .....	4
SET-UP KNOG APP .....	5
CONNECT DEVICE .....	6 - 7
ARMING & DISARMING SCOUT .....	8 - 10
CONNECTING TO Find My .....	11
CHARGING .....	12
DISABLE FindMy .....	13
FACTORY RESET .....	14
SERIAL NUMBER LOOK-UP .....	15

## WHATS IN THE BOX

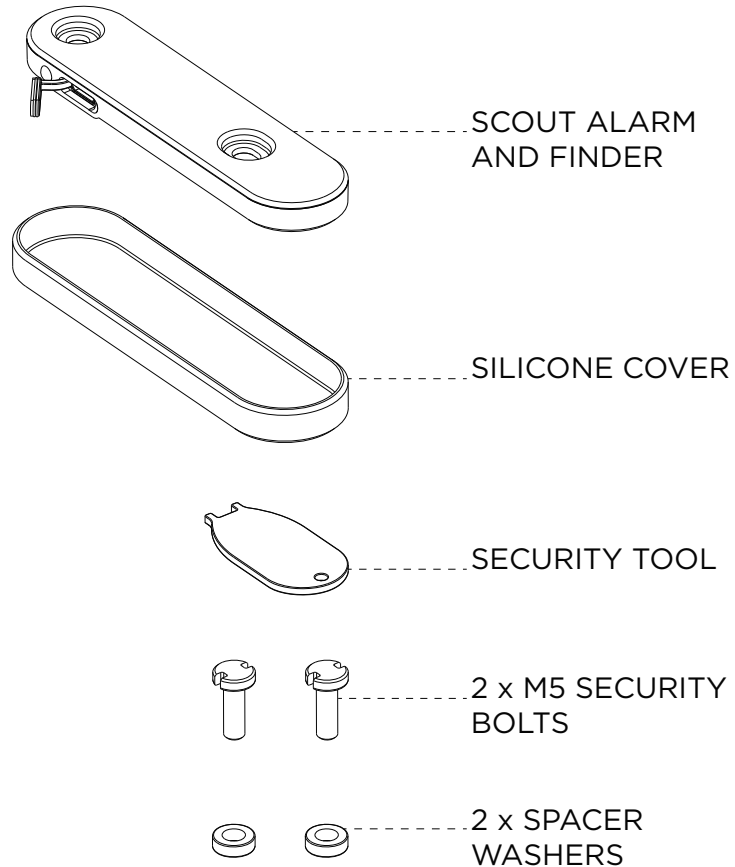

## ENABLE PAIRING

Before you can pair the scout to your phone, connect the Scout to a USB charger with a standard USB-C charging cable.

*\*Factory reset the device if it has been previously paired.  
See page 14 for instructions on how to factory reset your scout device.*

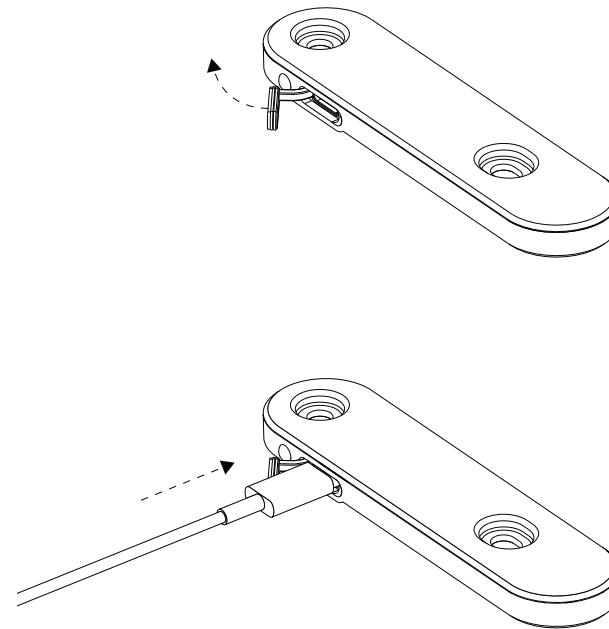

## SET-UP KNOG APP

1. Find and install the Knog app from the app store

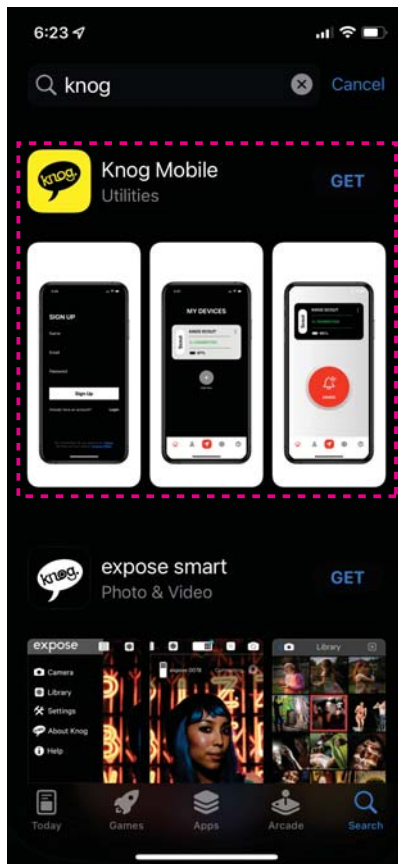

P.5

2. Enter your information to create your profile

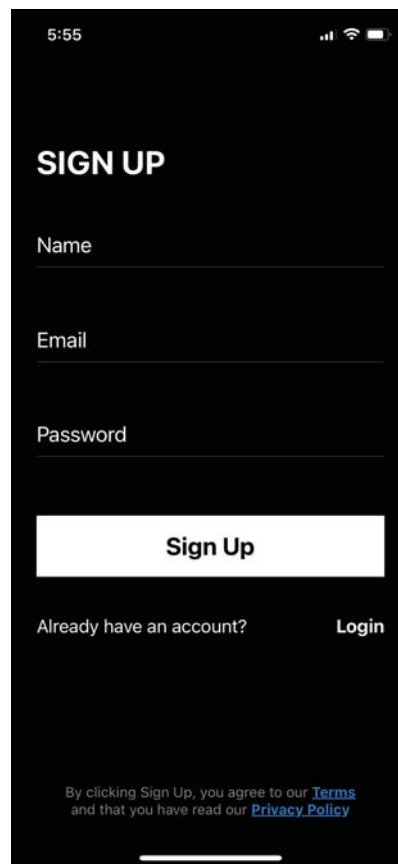

## REGISTER DEVICE

3. Make sure your Scout is powered, charged and in range. Click on the + button to search for the scout.

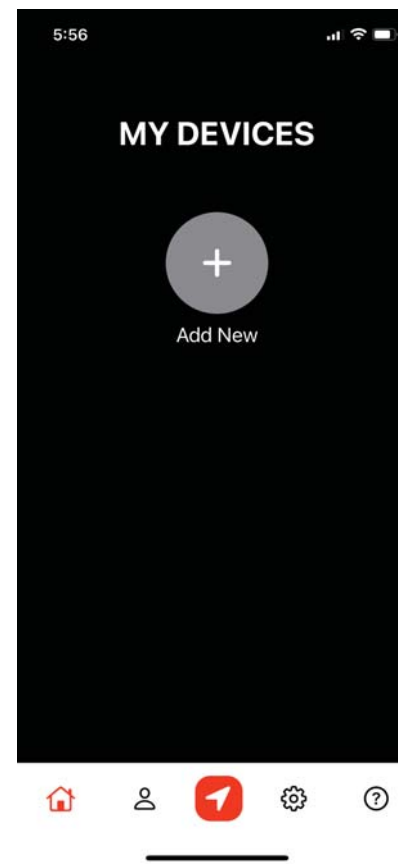

4. Select device to add "Knog Scout"

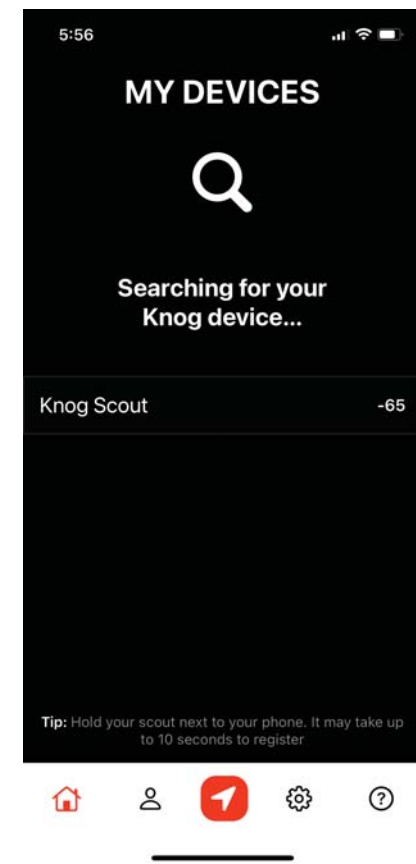

P.6

## DEVICE CONNECTED

5. Choose a name for your Scout

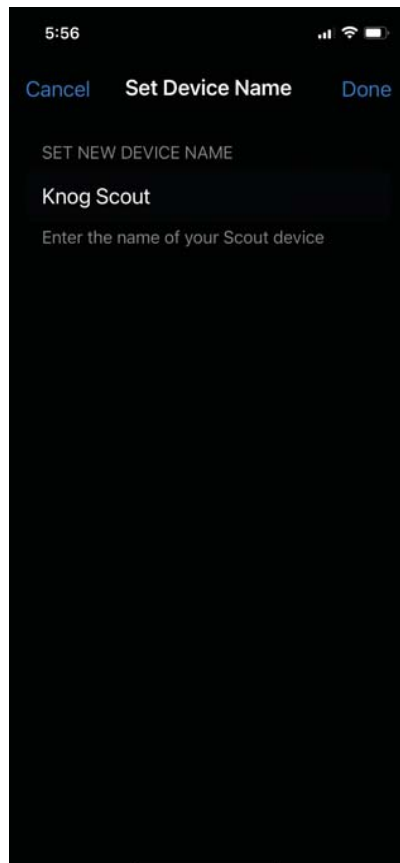

P.7

6. Knog Scout Connected

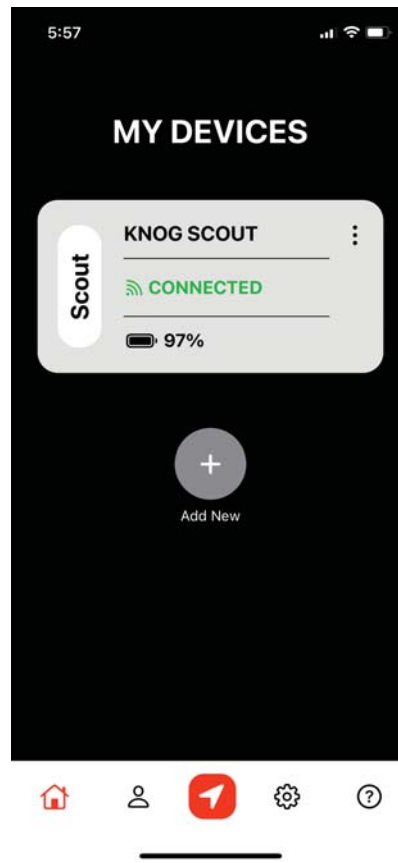

## ARMING + DISARMING FROM PHONE

1. To arm Scout make sure the phone is in range. The Scout should show connected. Click the black button on screen to arm the Scout



2. The Button will now show the Scout is Armed. To disarm, ensure the scout is in range, and press the red button on screen

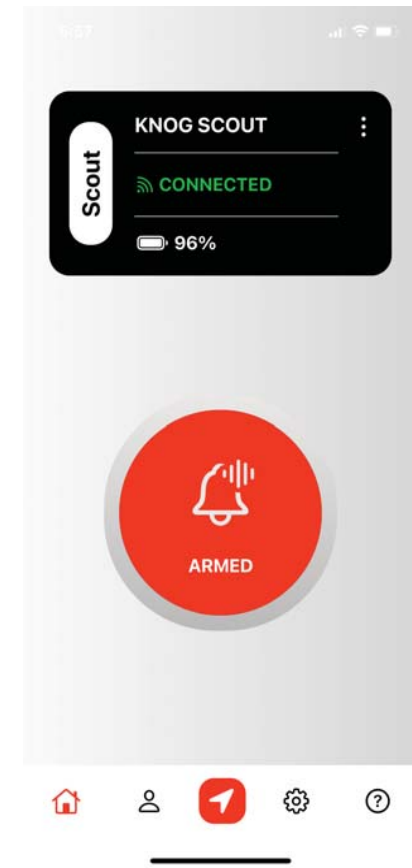

P.8

## ARMING FROM SCOUT

1. To arm Scout make sure the phone is in range and the Knog app is active on the phone.

2. Click the button on the Scout to arm it.

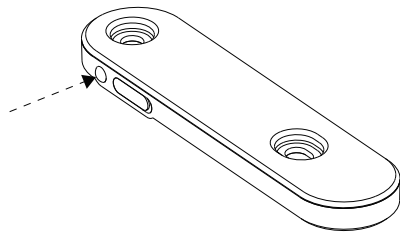

The Scout LEDs will now flash until it is armed.

**Note: Scout cannot be armed unless phone is in very close range.**

P.9

The button on the phone will be yellow whilst arming.

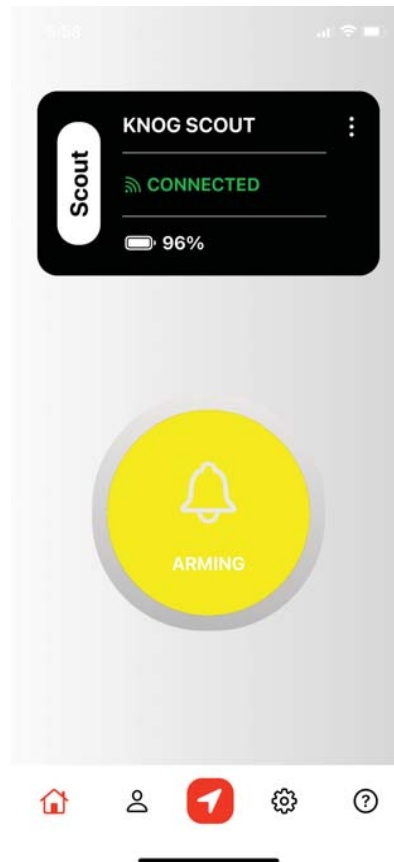

## DISARMING FROM SCOUT

1. To disarm Scout make sure the phone is in range and the Knog app is active on the phone.

2. Click and hold the button on the Scout to disarm it.

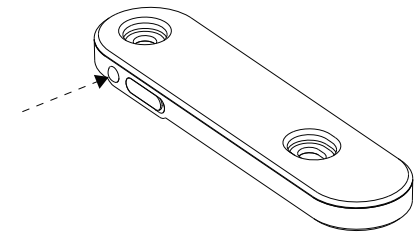

**Note: Scout cannot be disarmed unless phone is in very close range.**

P.10

## CONNECTING FIND MY

1. Open the Find My app by pressing the red arrow button at the bottom of the screen\*

\*To use the Apple Find My app to locate this item, the latest version of iOS, iPadOS, watchOS, or macOS is recommended.

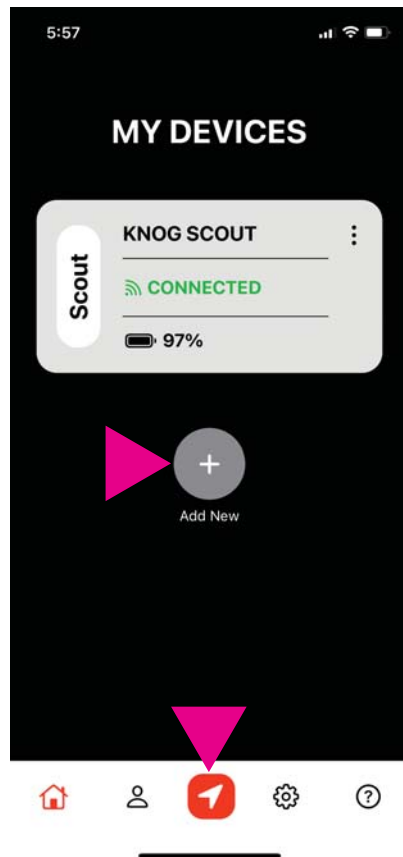

2. Press 'Add New Item'  
3. Select 'Add Other Item'  
4. When Scout appears, press to connect to Find My. Select and name your Scout

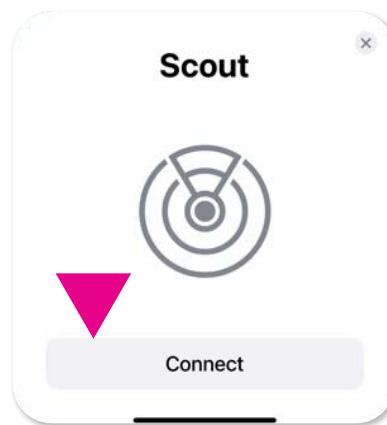

## CHARGING

1. Open USB door seal

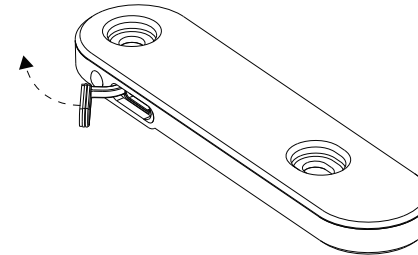

2. Plug in USB-C cable to Charge.

The charging indicator will be red while charging, and green when charging is complete.

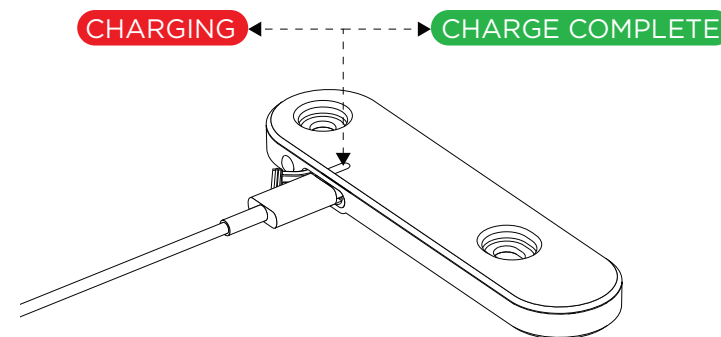

## DISABLE Find My

1. Turn the Scout upside down and place on an horizontal surface (such as a table).
2. Press and hold the button for 30 seconds until 4 short beeps are heard.

This procedure will stop sharing the location of the Scout.

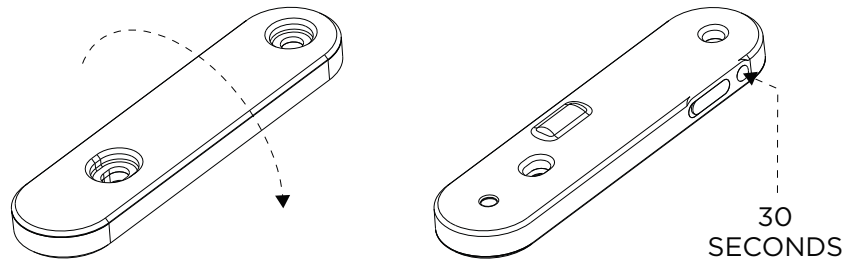

## FACTORY RESET

1. Turn the Scout upside down and place on an horizontal surface (such as a table).
2. Press and hold the button, while plugging in a USB-C cable. Continue to hold the button for 10 seconds, until 4 short beeps are heard.

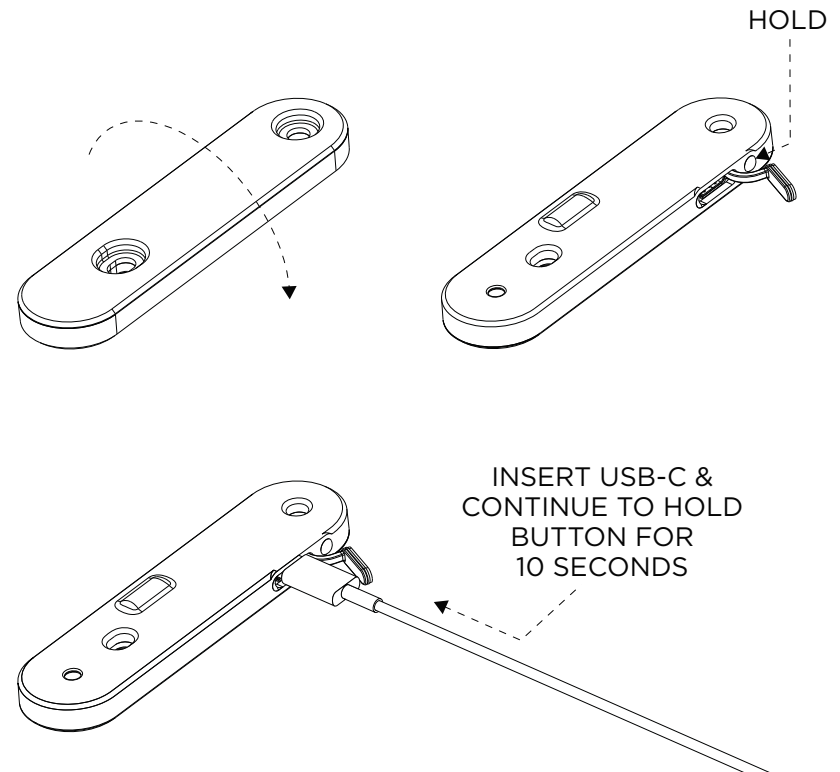

## SERIAL NUMBER LOOK-UP

The Apple Find My app can be used to lookup the serial number of an unknown scout in your possession.

1. In the Find My app, select Identify found item, when the unknown Scout is nearby.
2. Select the item from a list of nearby items, then press continue.

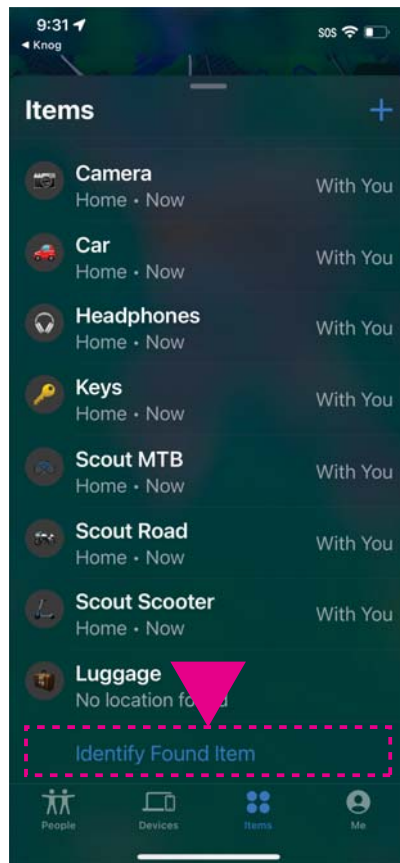

P.15

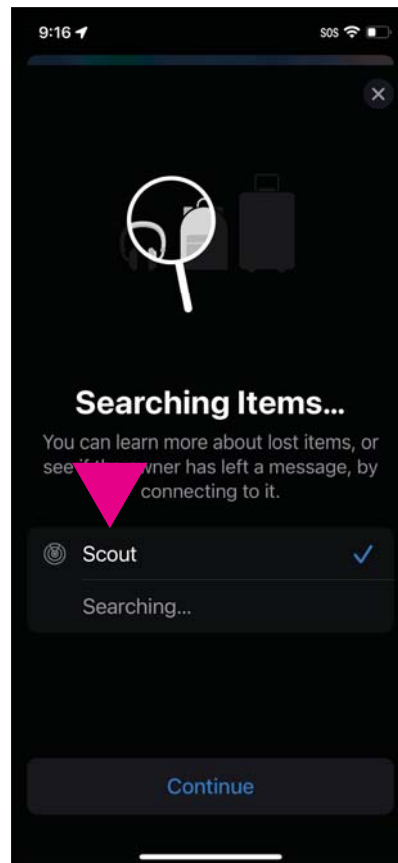

3. When the following page is displayed, press the button on the Scout, then select 'Continue On Website'

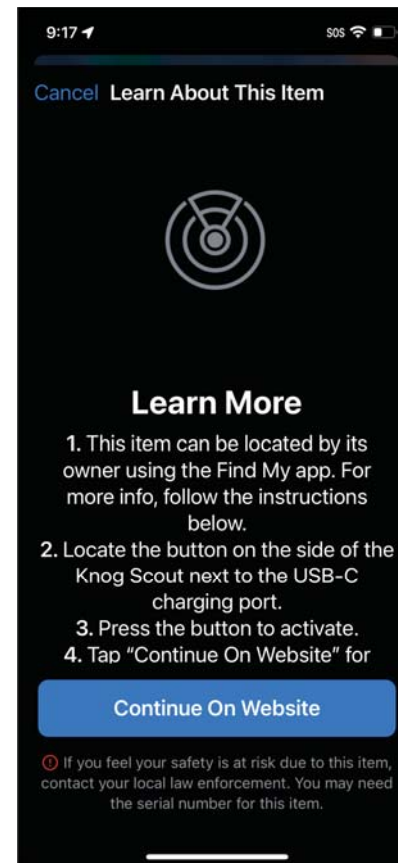

4. A page similar to this should be displayed with the Scout serial number. If the device has been set to lost mode, a message and contact details from the owner may also be displayed here.

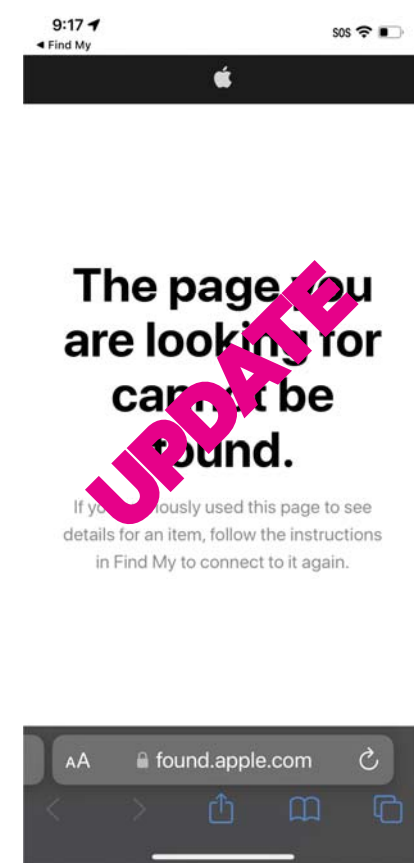

P.16





KNOG.COM



Use of the Works with Apple badge means that a product has been designed to work specifically with the technology identified in the badge and has been certified by the product manufacturer to meet Apple Find My network product specifications and requirements.  
Apple is not responsible for the operation of this device or use of this product or its compliance with safety and regulatory standards.

#### FCC WARNING

Any changes or modifications not expressly approved by the party responsible for compliance could void the user's authority to operate the equipment.

NOTE: This equipment has been tested and found to comply with the limits for a Class B digital device, pursuant to Part 15 of the FCC Rules. These limits are designed to provide reasonable protection against harmful interference in a residential installation. This equipment generates, uses, and can radiate radio frequency energy and, if not installed and used in accordance with the instructions, may cause harmful interference to radio communications. However, there is no guarantee that interference will not occur in a particular installation.

If this equipment does cause harmful interference to radio or television reception, which can be determined by turning the equipment off and on, the user is encouraged to try to correct the interference by one or more of the following measures:

- Reorient or relocate the receiving antenna.
- Increase the separation between the equipment and receiver.
- Connect the equipment into an outlet on a circuit different from that to which the receiver is connected.
- Consult the dealer or an experienced radio/TV technician for help.

The device has been evaluated to meet general RF exposure requirement. The device can be used in portable exposure condition without restriction.



FCC ID: 2AQPf-12998

#### FCC COMPLIANCE STATEMENT

This device complies with part 15 of the FCC Rules. Operation is subject to the following two conditions:  
(1) this device may not cause harmful interference,  
and (2) this device must accept any interference received, including interference that may cause undesired operation.

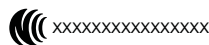
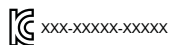
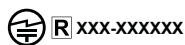
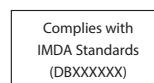

TRA  
REGISTERED NO.: XXXXXX/XX  
DEALER NO.: XXXXXX/XX