

Grow Care Thermometer

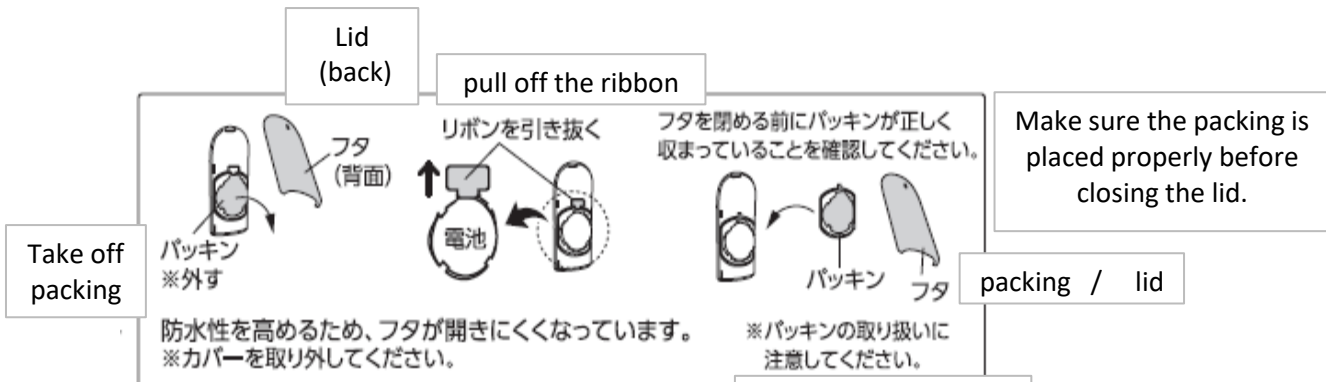
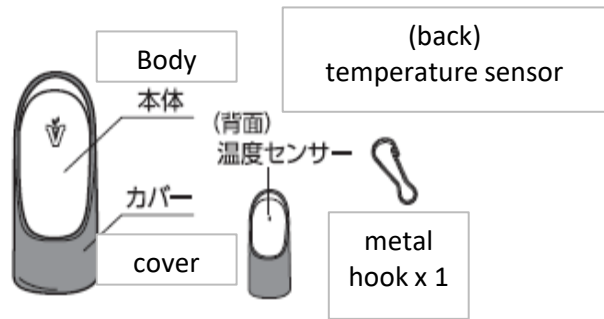

The lid is tightly attached in order to achieve better water resistant.
* Please take off the cover

* Take care of the packing carefully

1) Download APP and pairing
1. Download the APP and register phone iOS 9 / Android 4.3 or later

* At the time of registration, you may see an error message. Please go to the setting page of your phone and change setting to accept the APP

① アプリのダウンロードとペアリング
1. アプリのダウンロードと登録
iPhone iOS 9 / Android Phone 4.3以上



※アプリをダウンロードする際、エラーメッセージが表示される場合があります。その際はスマートフォンの設定を変更してください。

(2019年9月1日現在)

2.メールアドレスとパスワードの登録

※ピンコードを記載したメールが受信できるように設定してください。
※迷惑メールとして識別されることがあります。メールが届かない場合は、「迷惑メール」をご確認ください。

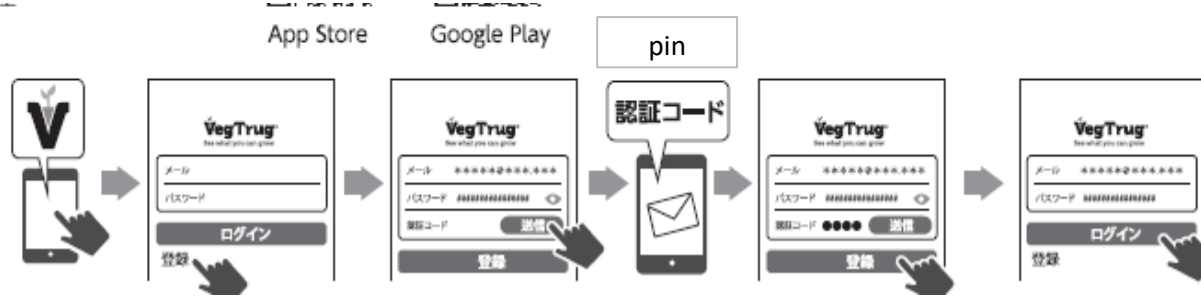

2. Registration of e-mail address and password.

* Please change setting your phone to receive an e-mail for pin code.
* Such e-mail may be classified as "spam mail". Please also check your "spam mail" box.



3.本体とスマートフォンのペアリング

3. Paring device and phone

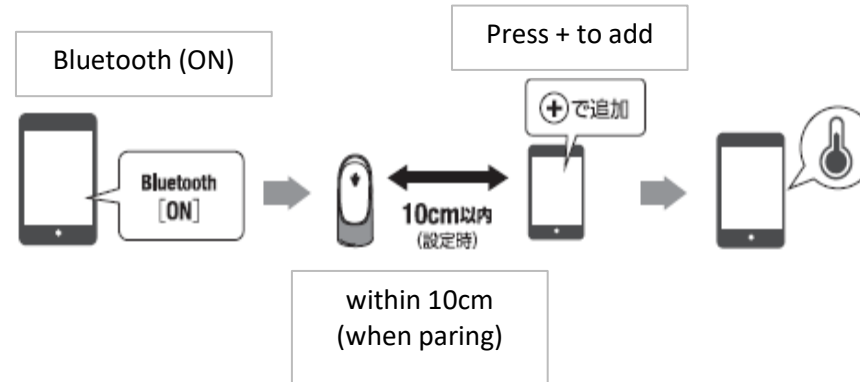

②植物をデータベースから選ぶ

アプリに登録されている6000種以上の植物から、育てたい植物を選びます。

2) Choose your plants from the database

* You can choose your plants from more than 6,000 plants in the database

③雨などのかからない場所に設置する

付属のナスカンを取り付け、温室や軒下などの

3) Place the device in a greenhouse or any place where rain or much water won't

雨のかからない場所に設置します。
使用環境温度：-10°～50°



contact the device.

Working temperature : -10 - 50 degree Celsius

About 10 m max.
(no obstacles between)

× 禁止

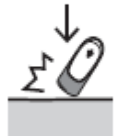

落下などによる
衝撃



水没させない



本体に直接
水をかけない



地面に置かない
壁につけない

ご注意

- 1.電池を子供の手の届く範囲に放置しないでください。
- 2.雨や水がかかると、誤動作の原因となります。
- 3.長期間使用しない場合は、電池を取り外して保管してください。
- 4.温度の差が大きい場合、正確な数値がでるまで時間がかかります。

X Warning !!

Avoid impact from falling
Don't submerge the device
Don't water directly to the device
Don't place the device directly on the ground or attach to a

仕様

サイズ:幅2.8×奥行1.5×高さ6.7cm
材質:PC/ABSアロイ、シリコンゴム
防滴:生活防水

※雨が直接かからない場所でご使用ください。

電源:ボタン電池(CR2032) 1個

Specification

Dimension : W2.8 x D1.5 x H 6.7 cm
Materials : PC / ABS alloy, Silicon rubber
Water resistant : practical water resistant

* Make sure to place the device where rain won't directly contact.

FCC Warning

This device complies with part 15 of the FCC Rules.

Operation is subject to the following two conditions:

- (1) This device may not cause harmful interference, and
- (2) this device must accept any interference received, including interference that may cause undesired operation.

NOTE:

This equipment has been tested and found to comply with the limits for a Class B digital device, pursuant to Part 15 of the FCC Rules. These limits are designed to provide reasonable protection against harmful interference in a residential installation. This equipment generates, uses and can radiate radio frequency energy and, if not installed and used in accordance with the instructions, may cause harmful interference to radio communications. However, there is no guarantee that interference will not occur in a particular installation. If this equipment does cause harmful interference to radio or television reception, which can be determined by turning the equipment off and on, the user is encouraged to try to correct the interference by one or more of the following measures:

- Reorient or relocate the receiving antenna.

- Increase the separation between the equipment and receiver
- Connect the equipment into an outlet on a circuit different from that to which the receiver is connected.
- Consult the dealer or an experienced radio/TV technician for help.

Changes or modifications not expressly approved by the party responsible for compliance could void the user's authority to operate the equipment.

The distance between user and products should be no less than 20cm

株式会社タカショー ホームユース事業部

〒642-0017 和歌山県海南市南赤坂 20-1 お客様ご相談受付電話 0120-51-4128
URL : <http://homeuse.takasho.co.jp>

MADE IN CHINA
T-150919

Takasho Co., Ltd. Home Use Division
20-1 Minami-Akasaka, Kainan, Wakayama, Japan
642-0017

URL : <http://homeuse.takasho.co.jp>

Customer service tel : 0120-51-4128