

DIGITAL WIRELESS BACKUP CAMERA SYSTEMS

◀ Camera and Monitor ▶



Mold :SWD-M502630CS

BEFORE INSTALLATION PLEASE READ THE MANUAL

What's in the Box?



NOTE: The contents included may be different based on the kit you purchased. Please take the actual product as standard

- 01 5inch Monitor
- 02 Camera
- 03 Sticker
- 04 Bracket
- 05 Car Charger
- 06 Power Cable
- 07 USB
- 08 Antenna and screws
- 09 Trapezoidal bracket



Introduction



- ▼ Please read all of the installation instructions carefully before installing the product. Improper installation will void manufacturer's warranty.

Thank you very much for purchasing a Rear View Backup Camera System. With this manual you will be able to properly install and operate the unit.

The Backup Camera System is intended to be installed as a supplement aid to your standard rear view mirror that already exists in your vehicle. The Backup Camera System should not be used as a substitute for the standard rear view mirror or for any other mirror that exists in your vehicle. In some jurisdictions, it is unlawful for a person to drive a motor vehicle equipped with a TV viewer or screen located forward of the back of the driver's seat or in any location that is visible, directly or indirectly, to the driver while operating the vehicle.

Monitor Operation

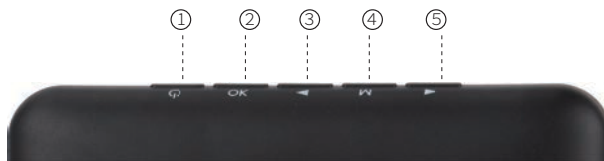
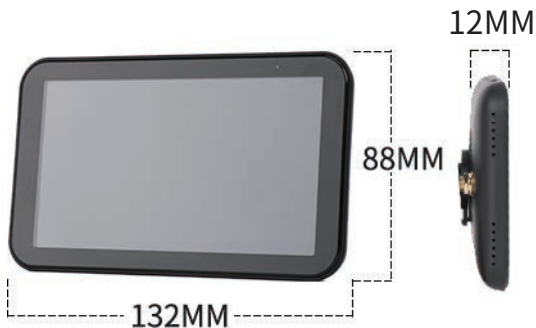

| Product name | SWD-502630CS | |
|--------------|-----------------------------|--|
| Key 1 | Power key | Switch on/off |
| Key 2 | ① Confirm key | ② Card insertion Start Pause key |
| Key 3 | ① Enter menu Left selection | ② reduce ③ Car ruler ④ In adjustment mode Position of the vehicle gauge |
| Key 4 | ① Menu key | ② Return key |
| Key 5 | ① Enter menu Right Select | ② plus ③ Short press to switch channels |

Camera Size



Box Size

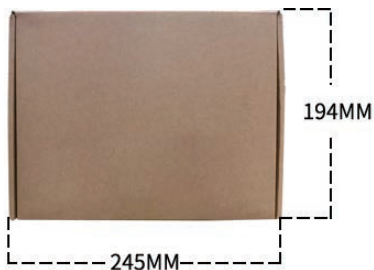

The Packing Box
is Hard and not
Easy to Wear

Installation Diagram



► Monitor Installation

Choose a monitor location in your vehicle that does not block your view and complies with local laws for safe driving. Do not place in an area where it might interfere with driving.



Camera Placement Diagram

► Camera Installation

Suitable Installation Position



Connection mode of accessories



- 1** Connect the display to the bracket



- 2** Connect the display to the ladder bracket

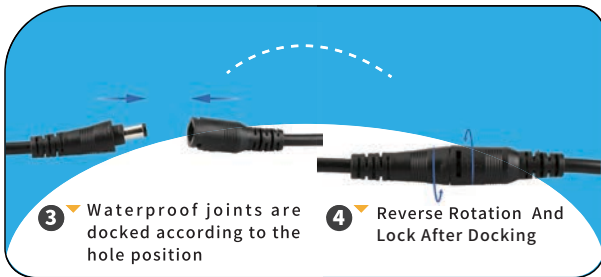

- 3** Waterproof joints are docked according to the hole position

- 4** Reverse Rotation And Lock After Docking

▼ The above is the correct connection mode. Please operate carefully during installation and removal to avoid damage

Pairing the Camera and Monitor

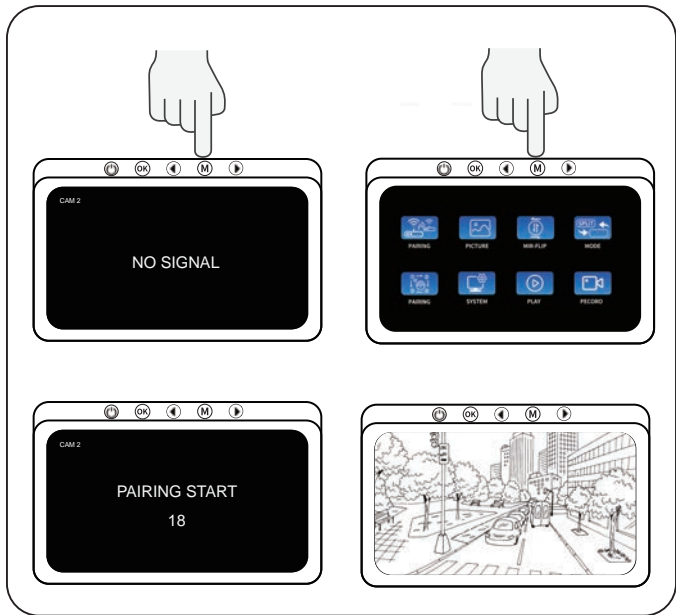

- ▼ **NOTE:** when you need pairing, please confirm the circuit is properly connected and powered. If you need to pairing multiple cameras, please switch to the corresponding channel.

Specifications



| | |
|------------------------------|-----------------|
| Power Supply | DC12V to 36V |
| Wireless Frequency | 2.4 GHz |
| Wireless Range | 500m(open area) |
| Delaying Time | <200ms |
| Operating temperature | -20°C ~ 80°C |

CAMERA

| | |
|--------------------------|-----------------|
| Image Sensor | 1/3 inch |
| Waterproof Rating | IP 68 |
| View Angle | 100°[H] 130°[D] |
| Camera Pixel | 1000TVL |

MONITOR

| | |
|--------------------------|----------------------|
| LCD Size | 5 inch IPS |
| Resolution | 1280(H) x 720(V) |
| Contrast | 500:1 |
| Brightness | 500cd/m ² |
| Response Time | 25ms |
| Power Consumption | <500mA |

Troubleshooting



| Problem | Solution |
|-------------------------------|---|
| Monitor Won't turn on | Check the cigarette lighter has 12V-36V DC Output Check the fuse in the Cigarette socket adapter |
| Camera and Monitor won't pair | Check if the camera is receiving power |
| | Make sure to follow the instructions to operate the Pairing |
| Weak Signal | Check if the camera and monitor antennas are installed |
| | Distance between camera and monitor is too great. Reduce distance between camera and monitor |
| | Large dense objects could be obscuring the signal. If possible, move the objects |
| | Interference from overhead power lines may be affecting the signal |
| | Try unpairing and pairing |
| Night Vision is poor | The night sensor on the camera may be dirty or obstructed |
| | Ensure the camera is installed at least 2 inches away from rear lights |
| Dark Picture | Check whether brightness and contrast are adjusted correctly |

FCC Warning Statement

Changes or modifications not expressly approved by the party responsible for compliance could void the user's authority to operate the equipment. This equipment has been tested and found to comply with the limits for a Class B digital device, pursuant to Part 15 of the FCC Rules. These limits are designed to provide reasonable protection against harmful interference in a residential installation. This equipment generates uses and can radiate radio frequency energy and, if not installed and used in accordance with the instructions, may cause harmful interference to radio communications. However, there is no guarantee that interference will not occur in a particular installation. If this equipment does cause harmful interference to radio or television reception, which can be determined by turning the equipment off and on, the user is encouraged to try to correct the interference by one or more of the following measures:

- Reorient or relocate the receiving antenna.
- Increase the separation between the equipment and receiver.
- Connect the equipment into an outlet on a circuit different from that to which the receiver is connected.
- Consult the dealer or an experienced radio/TV technician for help.

This device complies with part 15 of the FCC Rules. Operation is subject to the following two conditions: (1) This device may not cause harmful interference, and

(2) this device must accept any interference received, including interference that may cause undesired operation.