

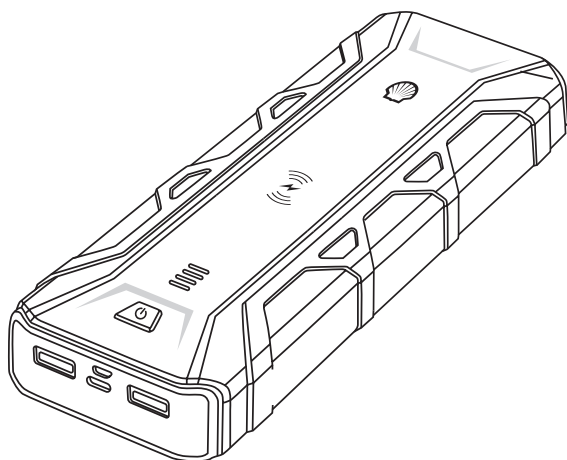

Model | Modèle | Modelo

SH916WC



**PORTABLE POWER
JUMP STARTER
CHARGEUR PORTATIF
DÉMARREUR D'APPOINT
BATERÍA PORTÁTIL
ARRANCADOR PARA AUTOMÓVIL**

User guide | Guide de l'utilisateur | Guía de usuario

DOCKET	D10117	DESCRIPTION Instruction booklet SH916WC Jump Starter EngFrSp		DIE LINE	COLORS	PRINT FINISHING
BRAND	Shell			DIE LINE DO NOT PRINT	<div>4/C PROCESS</div> <div>1 COLOR BLACK</div>	<div><input checked="" type="checkbox"/></div> MATT
MODEL #	SH916WC					<div><input type="checkbox"/></div> GLOSSY
ITEM # OR SKU #	60004	<div>DIMENSION</div> <div><div><div>L</div><div>H</div></div><div><div><div><div></div><div></div><div></div></div></div><div>Open spread 21 cm</div><div>Length 10.5 cm</div><div>Height 15 cm</div></div></div>		SPOT COLORS		
CUSTOMER	AmazonCom					
ARTWORK DATE	April 5, 2023					
ARTWORK TYPE	Instruction booklet					
<div><div>Camelion®</div></div>		DO NOT ALTER, COPY OR USE ANY OF THIS ARTWORK WITHOUT PERMISSION OF CAMELION		CONTACT		PREPARED BY SW, cD

Contents

English.....	4-17
Contact us.....	49
Français	18-33
Contactez-nous.....	49
Español.....	34-48
Contacto con nosotros	49

For Your Safety

Thank you for choosing this Shell product. Please read the following instructions and keep them for future reference. This instruction manual contains important information on safe operation and use. To ensure long life and performance reliability, please operate and maintain as per the instructions on this sheet.

Product Details

Jump Starter

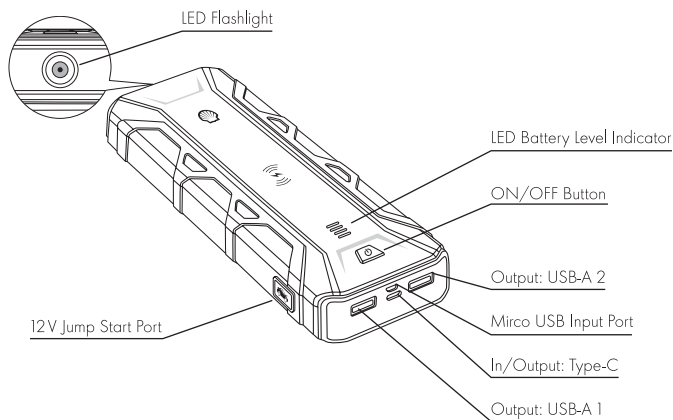

Smart Jumper Cable

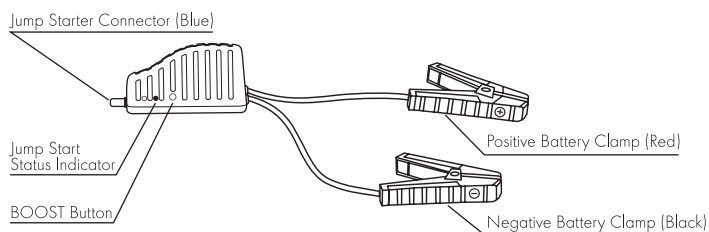

Package Includes

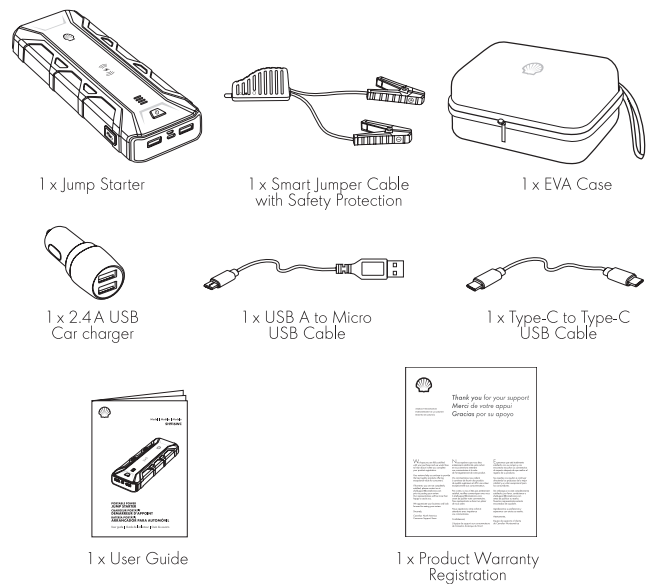

Product Features

Designed for vehicles with 7.0 L gasoline and 3 L diesel engines
 10 levels of safety protection
 Integrated with dual USB output ports, Type-C fast charging input/output port and 10W wireless charging
 Integrated LED flashlight with 4 light settings:
 Flashlight, SOS, White Flood Light, and Red Alert Strobe

Operating Instructions

IMPORTANT! CHARGE IMMEDIATELY AFTER PURCHASE, AFTER EACH USE AND EVERY THREE MONTHS, OR WHEN THE BATTERY LEVEL FALLS BELOW 50%, TO PROLONG THE INTERNAL BATTERY LIFE.

Charging the Jump Starter

1. Connect the Type-C cable provided in this package to the Type-C port of the jump starter or connect the Micro USB cable provided in this package to the Micro USB port of the jump starter

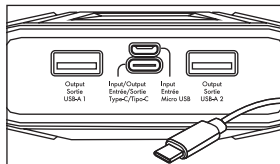

2. Connect the other end of the Type-C cable/Micro USB cable to a certified USB power adapter or the car charger that is provided in this package to begin charging.

Note: Use a PD18W adaptor (sold separately) to quickly recharge the jump starter. PD 18W adaptor is 3 times faster than a regular charger (compared with 5W charger).

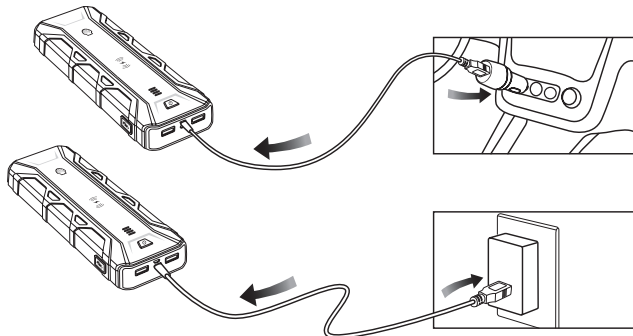

Charging the Jump Starter

3. The LED will start flashing. The charging level is indicated by the LED battery level indicator. Please refer to table A below for charging status.
4. When charging is completed, the LED indicator will stop flashing.
5. Disconnect the charger from the outlet and remove the charging cable from the charger and the jump starter.

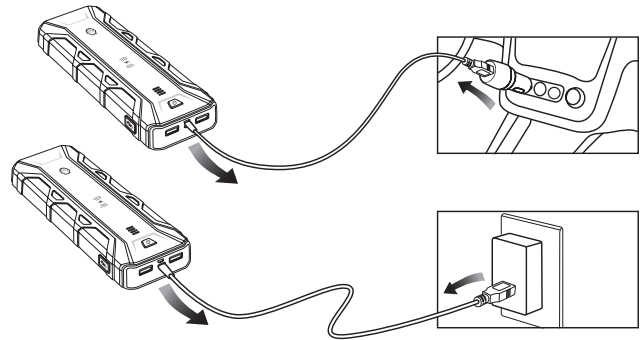

Table A

LED Battery Level Indicator	LED Status	Battery Capacity
	First light flashing.	0% to 25%
	First light solid, and the second light flashing.	25% to 50%
	First two lights solid, and the third light flashing.	50% to 75%
	First three lights solid, and the forth light flashing.	75% to 100%
	All four lights are solid.	100% fully charged

Note: Please contact customer service when more than one LED light flashes at the same time or when the first LED light flashes rapidly.

Jump Starting Vehicle

The jump starter is intended to jump start vehicle with gasoline or diesel engine using a 12 V battery.

Before connecting to the battery

- 1. Verify the voltage of the battery. The information can be found in the vehicle's owner's manual.
- 2. Make sure the power loads such as headlamps, air-conditioning and radio are turned off.
- 3. Press the switch to check the internal battery level to ensure that there is sufficient battery capacity to jump start a vehicle. Refer to table B below for more information.

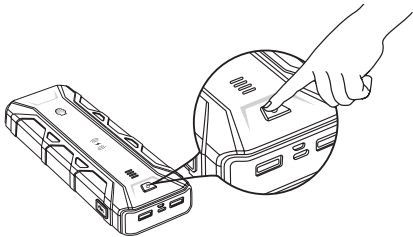
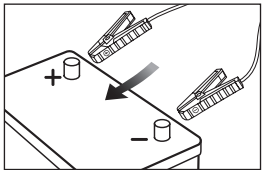
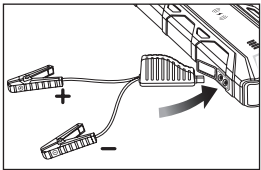

Table B: Required capacity to jump start a vehicle

LED Battery Level Indicator	Battery Capacity	Indications
	75% to 100%	Best condition to jump start a vehicle.
	50% to 75%	The minimum capacity required to jump start a vehicle.
	25% to 50%	Recharge the jump starter before use.
	0% to 25%	

Connecting to the vehicle battery

- 1. Connect the blue connector of the jumper cable to the 12V jump start port of the jump starter.
- 2. Connect the RED battery clamp to the positive (+) and the BLACK battery clamp to the negative (-) terminal on your vehicle's battery.



- 3. A) Once connection is made, the green status indicator light in the jumper cable will turn solid. Only then can you attempt to jump start your vehicle.
Do not jump start more than 4 consecutive times.
B) If the green light does not turn solid or the red light is on or beeping sound is heard, refer to the Troubleshooting table for further actions.

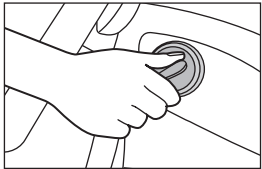
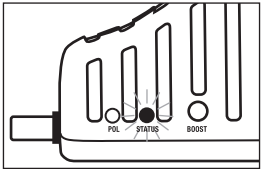

- 4. After the engine starts:
A) Disconnect the battery clamps from the battery terminals and
B) Unplug the jumper cable from the jump starter.

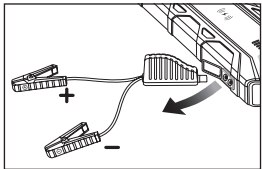
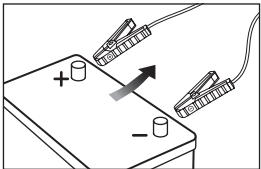

Jump Start
Troubleshooting

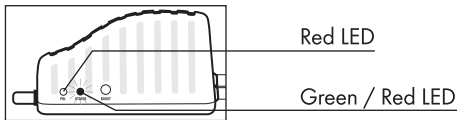

Jumper cable signal			Cause
POL	Status	Sound	
Off	Solid Green	Off	
Off	Red & Green light flashes alternately	Off	Jump started 4 consecutive times within 10 minutes.
Off	Red light flashes rapidly	Off	Over-voltage protection.
Off	Red light flashes slowly	Off	Over-current protection.
Off	Solid Red	Off	1. High temperature protection.
			2. Voltage of the jump starter is too low / overdischarge protection.
			3. Jumper cable not connected to the jump starter.
Solid Red	Flashing Green	Constant Beeping	Reversed polarity protection. Battery clamps are connected to the wrong polarities of the vehicle battery.
Off	Flashing Green	Off	1. Vehicle's battery cannot be detected.
			2. Short circuit protection.
			3. Vehicle's battery voltage is too low or cannot be detected.

Solutions
Jump start the vehicle.
Do not jump start more than 4 times. Disconnect the clamps from the vehicle's battery. Unplug the jumper cable from the jump starter. Consult a mechanic.
Disconnect the jump starter and jumper cable from the vehicle. The vehicle's battery voltage is higher than applicable. This product is suitable for 12V battery only.
Disconnect the jump starter and jumper cable from the vehicle. Check and make sure the vehicle starter is not stuck. Wait 30 seconds. Follow jump starting vehicle instructions to jump start the vehicle.
Disconnect the clamps from the vehicle's battery. Unplug the jumper cable from the jump starter. Let the jump starter cool down by putting it in a cool and ventilated place.
Charge the jump starter.
Connect jumper cable to the jump starter before connecting the clamps to the vehicle battery.
Disconnect the clamps from the vehicle's battery. Unplug the jumper cable from the jump starter. Follow jump starting vehicle instructions to jump start the vehicle.
Make sure the clamps are securely connected to the correct polarities of the vehicle's battery
Make sure the clamps are securely connected to the correct polarities of the vehicle's battery
Make sure the clamps are securely connected to the correct polarities of the vehicle's battery. Press "BOOST" on the jumper cable. Solid green LED light will turn on. Jump start the vehicle. *See warning below.

***WARNING** Use "BOOST" with extreme care. Clamps must be tightly connected to the correct polarities of the vehicle's battery before pressing boost button. Spark proof and other safety protections will be disabled after pressing boost button. This mode generates very high current. Sparks will generate when clamps touch or are connected to each other. It may cause damage to the product and the vehicle's electrical system if not used properly. Seek professional assistance if you are not sure about using this mode.

Charging Portable Devices

1. Connect your portable device with one end of the correct USB cable, and insert the other end to one of the output ports: USB-A 1, USB-A 2 or Type-C port, of the jump starter.
- Note:** connect the USB PD compatible device to Type-C port for fast charging.

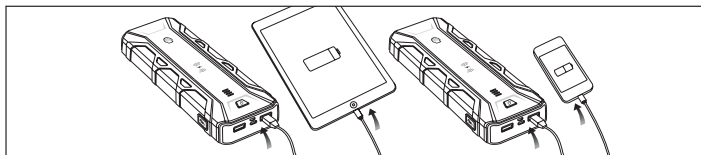

2. Charging will begin as soon as the connections are made.
3. Once the charging is completed, disconnect your portable device and unplug the USB cable from the jump starter.

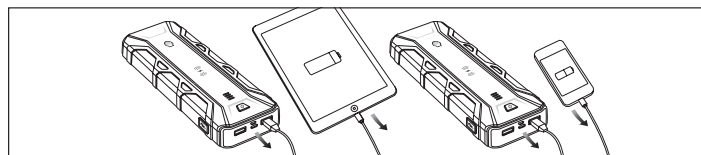

Compatible with: smart phones, tablets, digital cameras, mobile gaming devices, wireless earphones and more.



Wireless Charging

1. Press the power button on the jump starter.
2. Align your portable device to the wireless charging symbol of the jump starter. **Note:** Please ensure that your portable device supports wireless charging when using this function.
3. Once charging is completed, remove your portable device.

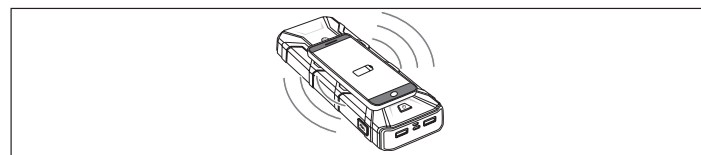

Compatible with: smart phones, tablets, smart watches, bluetooth earbud charging cases and bluetooth headphones



Note: Charging time will vary depending on the portable device and the device's battery capacity.

Using the Flashlight

1. To switch on the flashlight, press and hold the power button for 2 seconds.
2. Press the power button once to toggle through 4 light settings: Flashlight, SOS, White Flood Light, and Red Alert Strobe.

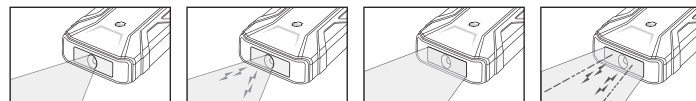

3. Press and hold power button for 2 seconds to switch off the flashlight.

Specifications

Start Voltage	12V
Start Current	600A
Peak Current	1200A
Input	Micro USB: 5V \equiv 2A Type-C: 5V \equiv 3A, 9V \equiv 2A, 12V \equiv 1.5A
Output	USB-A 1: 5V \equiv 2.4A USB-A 2: 5V \equiv 2.4A Type-C: 5V \equiv 3A, 9V \equiv 2A, 12V \equiv 1.5A
Wireless Charger	10W
Battery Type	Lithium-Polymer
Battery Capacity	16000 mAh, 59.2Wh
Charging Temperature	10°C ~ 40°C
Discharging Temperature	-20°C ~ 40°C
Storage Temperature	-20°C ~ 40°C
Dimensions	9.17 × 3.46 × 1.42 in / 233 × 88 × 36 mm
Weight	1.42 lb/645 g (without clamp and USB cable)

This \equiv symbol indicates direct current (DC)

Safety Instructions

Failure to follow the instructions may cause serious injury, death or property damage.
Risk of electric shock, explosion and fire.
Risk of explosive gases.
Do not attempt to jump start your vehicle more than four consecutive times. If the vehicle does not start after four consecutive attempts, consult a mechanic.
The product may become warm under extended high-power operation.
Do not disassemble, modify or repair this product.
Do not destroy product by crushing or cutting.
Do not expose the product to fire, rain, snow, sunlight and heat.
Keep this product away from water and other liquids.
Keep this product in a dry place. Do not allow the product to get wet.
Use the product in a well-ventilated area. Do not operate in explosive atmospheres such as areas of flammable gas, dust and liquid.

Safety Instructions

Do not use this product in the event of electrolytic liquid leaks, strange odours, overheating, color change or when any other peculiar occurrence is detected.

Handle the product with care. Do not use the product when it is damaged. Do not operate with damaged jumper cable or clamps.

Clean this product only with a dry cloth. Avoid using cleaning product with rough or chemical substances.

Do not look directly into the light as it may cause serious eye injuries.

This car jump starter is for use with petrol or diesel engine vehicles using a 12V battery only. The use of this jump starter on a vehicle that does not have a 12V battery may cause serious damage to the vehicle, the jump starter, and/or serious injury to the user. Refer to the owner's manual of the vehicle for the battery voltage.

The product should not be charged while in contact with flammable material like textiles.

When charging the jump starter, use the USB cable and car charger/adaptor that are provided in the package (accessories included in the package vary depending on the model). When using a different USB cable, charger, or adaptor, make sure it is certified according to the safety standards in your country/region.

Use the accessories that are provided in the package. Shell is not responsible for any damage or injury when using accessories that are not provided by us.

Connect the jump starter only with the jumper cable provided in this package.

Do not put the jump starter directly above the vehicle battery during jump starting.

Do not jump start a vehicle while recharging the internal battery.

Do not allow the clamps to touch each other.

Keep out of reach of children.

Personal Precautions

Wear adequate eye protection and protective clothing when working near a vehicle battery.

Do not smoke or allow a spark or flame near the battery or engine.

Remove all metal objects such as rings, bracelets, and watches.

Have plenty of fresh water and soap nearby in case of battery acid contact with eyes, skin or clothing.

If battery acid comes in contact with the skin or clothing, immediately wash with soap and water. If the acid enters the eye, immediately flood eye with running cold water for at least 10 minutes and seek immediate medical attention.

Beware not to drop metal items on the battery. It might cause sparks or short circuit the battery.

Consider having someone nearby to come to your aid in case of emergency.

Incompatible or damaged vehicle batteries may explode when used with this product.



Caution

This device complies with part 15 of the FCC Rules. Operation is subject to the following two conditions: (1) this device may not cause harmful interference, and (2) this device must accept any interference received, including interference that may cause undesired operation. This equipment has been tested and found to comply with the limits for a Class B digital device, pursuant to part 15 of the FCC Rules. These limits are designed to provide reasonable protection against harmful interference in a residential installation. This equipment generates, uses and can radiate radio frequency energy and, if not installed and used in accordance with the instructions, may cause harmful interference to radio communications. However, there is no guarantee that interference will not occur in a particular installation. If this equipment does cause harmful interference to radio or television reception, which can be determined by turning the equipment off and on, the user is encouraged to try to correct the interference by one or more of the following measures: reorient or relocate the receiving antenna; increase the separation between the equipment and receiver; connect the equipment into an outlet on a circuit different from that to which the receiver is connected; consult the dealer or an experienced radio/TV technician for help. Any changes or modifications not expressly approved by the manufacturer could void the user's authority to operate the equipment.

WARNING: This product can expose you to chemicals including lead, which is known to the State of California to cause cancer and birth defects or other reproductive harm. For more information, go to www.p65warnings.ca.gov.

Battery Disposal

The product contains a Li-ion/rechargeable battery which must be recycled or disposed of separately from household waste. Dispose of batteries according to your local environmental laws and guidelines.

Warranty

Shell warrants that this product (the "Product") will be free from defects in material and workmanship for a period of two (2) years from the date of purchase (the "Warranty Period"). For defects reported during the Warranty Period, Shell will, at its discretion, and subject to Shell's product support analysis, either repair or replace defective Product. Replacement parts and products will be new or serviceably used, comparable in function and performance to the original part and warranted for the remainder of the original Warranty Period. SHELL'S LIABILITY HEREUNDER IS EXPRESSLY LIMITED TO REPLACEMENT OR REPAIR OF THE PRODUCT. TO THE MAXIMUM EXTENT PERMITTED BY LAW, SHELL SHALL NOT BE LIABLE TO ANY PURCHASER OF THE PRODUCT OR ANY THIRD PARTY FOR ANY SPECIAL, INDIRECT, CONSEQUENTIAL OR EXEMPLARY DAMAGES,

Warranty

INCLUDING BUT NOT LIMITED TO, LOST PROFITS, PROPERTY DAMAGE OR PERSONAL INJURY RELATED IN ANY WAY TO THE PRODUCT HOWSOEVER CAUSED, EVEN IF SHELL HAD KNOWLEDGE OF THE POSSIBILITY OF SUCH DAMAGES. THE WARRANTIES SET FORTH HEREIN ARE IN LIEU OF ALL OTHER WARRANTIES, EXPRESS, IMPLIED, STATUTORY OR OTHERWISE, INCLUDING, WITHOUT LIMITATION, THE IMPLIED WARRANTIES OF MERCHANTABILITY AND FITNESS FOR A PARTICULAR PURPOSE, AND THOSE ARISING FROM COURSE OF DEALING, USAGE OR TRADE PRACTICE. IN THE EVENT THAT ANY APPLICABLE LAWS IMPOSE WARRANTIES, CONDITIONS OR OBLIGATIONS THAT CANNOT BE EXCLUDED OR MODIFIED, THIS PARAGRAPH SHALL APPLY TO THE GREATEST EXTENT ALLOWED BY SUCH LAWS.

This Limited Warranty is made solely for the benefit of the original purchaser of the Product from Shell or its approved reseller or distributor and is not assignable or transferable. To make a warranty claim, the purchaser must: (1) request and obtain a return merchandise authorization ("RMA") number and return location information (the "Return Location") from Shell Support by emailing shellsupport@camelionna.com or by calling 1.833.990.2624; and (2) send the Product, including RMA number and receipt to the Return Location provided. DO NOT SEND IN PRODUCT WITHOUT FIRST OBTAINING AN RMA FROM SHELL SUPPORT. THE ORIGINAL PURCHASER IS RESPONSIBLE (AND MUST PREPAY) ALL PACKAGING AND TRANSPORTATION COSTS TO SHIP PRODUCTS FOR WARRANTY SERVICE. NOTWITHSTANDING THE ABOVE, THIS LIMITED WARRANTY IS VOID AND DOES NOT APPLY TO PRODUCTS THAT: (a) were misused, mishandled, subjected to abuse or careless handling, accident, improperly stored, or operated under conditions of extreme voltage, temperature, shock, or vibration beyond Shell's recommendations for safe and effective use; (b) improperly installed, operated or maintained; (c) are/were modified without the express written consent of Shell; (d) have been disassembled, altered or repaired by anyone other than Shell; (e) had defects which were reported after the Warranty Period. THIS LIMITED WARRANTY DOES NOT COVER: (1) normal wear and tear; (2) cosmetic damage that does not affect functionality; or (3) Products where the Shell serial and/or lot number is missing, altered, or defaced.

Our goods come with guarantees that cannot be excluded under the Australian Consumer Law. You are entitled to a replacement or refund for a major failure and for compensation for any other reasonably foreseeable loss or damage. You are also entitled to have the goods repaired or replaced if the goods fail to be of acceptable quality and the failure does not amount to a major failure.

Subject to your rights under the Australian Consumer Law, Shell will not be responsible for any compensation of damages or loss of profits that are not covered under this Warranty.

