

Bluetooth®

User Guide



T30-S

Motorcycle 4-Way Conference Intercom

Table of Contents

Introduction	Page 1
Packet Contents	Page 2
Install Instructions	Page 3
Charging	Page 5
General Operation Instructions	Page 5
FM Operation	Page 8
Universal Pairing and Using	Page 9
Bluetooth Intercom Talk	Page 10
Technical Specifications	Page 16
Certification	Page 16

Introduction

Thank you for choosing the T30-S Motorcycle 4 Riders full-duplex stereo Bluetooth wireless helmet headsets, designed for installing into most open-face, flip-front and full-face style helmets.

With the T30-S, you can call hands-free on your Bluetooth mobile phone, listen to music or voice instructions of GPS navigation, and activate wireless intercom for rider to rider or rider to passenger intercom talk within range of 2100 meters(Depending on terrain conditions).

The T30-S is compliant with Bluetooth Specification V4.2 supporting the following profiles: Headset Profile(HSP), Hands-Free Profile(HFP), and Advanced Audio Distribution Profile (A2DP), and Audio Video Remote Control Profile(AVRCP) and Audio Gateway (AG). It supports universal pairing with most Bluetooth headsets on the market. The user can activate Siri or S-Voice from the main unit for voice dialing and other voice commands. The FM radio tuner is built into the main unit and allows for station scanning.

Superior audio fidelity has been achieved with our high fidelity, non-ported, and ultra-slim helmet HD speakers. This headset also provides the industry's best combination of wind and ambient noise reduction with the miniature boom microphone.

Please read this User Manual carefully before using this product.

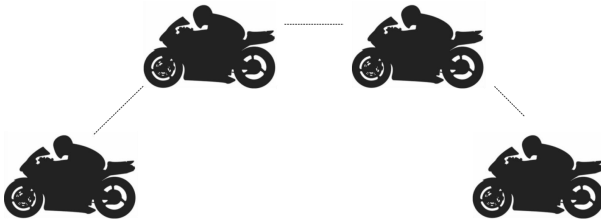

Four Riders Full Duplex Intercom



How It Works

2: Packet Content



HIFI Speaker and Microphone

Type C USB Cable

Clip Mounting Bracket

User Guide

3: Install Instructions

1:Locate the helmet at the left and clean it up

2:Peel off the 3M rubber protective film

3:Apply pressure to the metal carrier to secure the holder firmly

Note: it takes 24 hours after drying.



Temporary installation method

1:Clip on the left edge of the helmet

2:Remove metal handle after installation

3:If required, use additional anti slip rubber patches

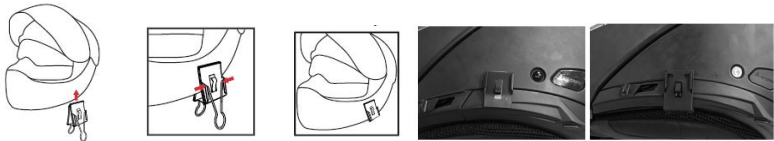

Install host

- 1: Slide T30-S host off the top of the clip and you'll hear a click when it is completely plugged in
- 2: Plug in the Type C headset plug

Headset mounting method

- 1: Stick the left and right horns of the headphones in the position of the left and right ears of the helmet
- 2: Keep the microphone in front of the mouth, Note: microphone holes point to the mouth

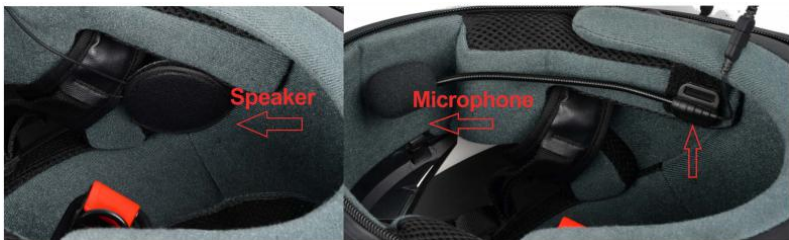

4: Charging

1. You can charge with the Type C USB cable in the package. During charging, red light is on, after full charging, the light will turn blue. It is recommended to recharge the battery before each use. Suggest full charge before each use.
2. Low battery warning: Headset will automatically voice prompt low battery at every 5 minutes to prompt the user to recharge it.
3. Battery state notify: When standby, long press Volume- button 1s to report battery level.

5: General Operation Instructions

Power on /Power off

Press and hold the Intercom button and Phone button for 2seconds to Power on or Power off T30-S.



Pairing with Gps Or Cell phone and Use

Pairing with Cell Phone or GPS and Using

Mobile Phone/GPS pairing steps

1. When power off, press Phone button for approx 6S, blue and red light flashing, headset enter mobile phone pairing mode. Open the phone Bluetooth, search for “T30-S”, then click on the phone connection pair.

Answer phone calling:

The unit will automatically answer the incoming call after 12 seconds. Or press Phone button to answer the incoming phone call immediately.

Reject incoming call:

When have incoming calls, double press Phone button 2 times to reject within 12s.

End phone calling:

During talking, short press Phone button to end the call.

Voice dial:

When phone standby, double press Volume - button to make voice dialing (The phone itself must have voice dialing function)

Last number redials:

When cell phone standby, double press Volume + button to make last number redialing.

Memory connects with cell phone:

Once pairing with cell phone, when power on again, headset will re-connect with mobile automatically. Or in case disconnect during standby mode, short press Phone button will connecting again.

Connect third party calls:

When connecting two cell phones, during phone call with first cell phone and second cell phone dial in, can double press Phone two times to answer the second cell phone and hold the first cell

phone conversation. When finish the second cell phone conversation, will back to the conversation with fist cell phone.

Reject third party calls:

When connecting two cell phones, during phone call with first cell phone and second cell phone dial in, can short press button Intercom to reject the second cell phone.

Music Control:

Press the Phone button to play and pause the music. When playing music, double press Volume + button to go to next track, double press Volume - button to go to previous track.

Music Sharing:

The T30-S that is playing music can share the music to another T30-S. When T30-S is playing music, double-click the phone button of T30-S_1, T30-S_1 enters the music sharing state. When T30-S_2 is in standby mode, double-click the phone key of T30-S_2, T30-S_2 will query and connect T30-S_1, and then play it automatically T30-S_1's music

Stop Music Sharing:

When the T30-S is in the music sharing state, double-click the phone key on the device to end the music sharing.

Voice Volume Control:

Short press Volume + button or Volume- button adjust the voice volume. Or while music or talking state, long press Volume+ button or Volume - button adjust the voice volume.

6: FM RADIO

Turn on/off radio

When in standby mode, press and hold button Phone 1 seconds to turn on FM radio. Press and hold it again for 1 seconds to turn off FM radio.

FM Radio Station Search

While in FM mode, double press Volume + button or Volume - button two times to search a next/previous FM channel.

Preset and store up to 6 FM radio stations

In FM radio mode, when a favorite station is found, double press Phone button to save, a beep tone will sound. Preset and store up to 6 FM radio stations. Once 6 stations have been saved, saving a new station will overwrite the oldest saved station. Press Phone button to rotate between each saved station.

7: Universal Pairing and Using



Power on other brand Bluetooth device into pairing suitable, meanwhile T30-S at standby mode, press and hold button Intercom for 1 seconds, red and blue light flashing, then press button Intercom ,the blue light flashing. After pair successful, the blue light slows down.

After paired, while T30-S at standby mode, press Volume+ and Volume- button at the same times, T30-S reconnect with Bluetooth headset which connected before and start talking.

While in talking mode, short press Phone button to end it.

8: Bluetooth Intercom Talk

The T30-S can be paired with other T30-S for up to a total of 4 units for full duplex Bluetooth intercom.

Pairing Two T30-S headsets and talk



Step 1: Power on unit 1 and unit 2, press and hold unit 1 and unit 2 Intercom Button for 1s, red and blue light flash alternately, then press Intercom button on either unit, the blue light flashing. After pair successful, the blue light slows down.

Step 2: After pair finished, Short press **Intercom** button on either unit, it will start intercom. During Intercom talking, short press Intercom button or Phone button to exit intercom mode.

Pairing Three T30-S headsets and talk

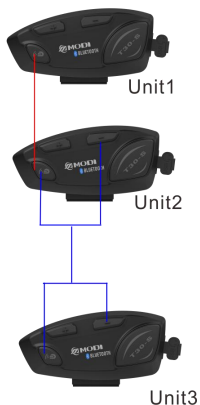

Step 1: Power on unit 1 and unit 2, press and hold unit 1 and unit 2 **Intercom** Button for 1s, red and blue light flash alternately, then press Intercom button on either unit, the blue light flashing. After pair successful, the blue light slows down.

Step 2: Power on unit 2 and unit 3, press and hold unit 2 and unit 3 **Intercom and Volume -** button for 1s, red and blue light flash alternately, then press Intercom button on either unit, the blue light flashing. After pair successful, the blue light slows down.

Step 3: After pair finished, Short press **Intercom** button on unit1 or unit2, it will start intercom between unit1 and unit2.

Step 4: After pair finished, **double press Intercom** button on unit2 or unit3, it will start intercom between unit2 and unit3.

During Intercom talking, short press Intercom button or Phone button to exit intercom mode.

Pairing Four T30-S headsets and talk



Step 1: Power on unit 1 and unit 2, press and hold unit 1 and unit 2 **Intercom** Button for 1s, red and blue light flash alternately, then press Intercom button on either unit, the blue light flashing. After pair successful, the blue light slows down.

Step 2: Power on unit 2 and unit 3, press and hold unit 2 and unit 3 **Intercom and Volume -** button for 1s, red and blue light flash alternately, then press Intercom button on either unit, the blue light flashing. After pair successful, the blue light slows down.

Step 3: Power on unit 3 and unit 4, press and hold unit 3 and unit 4 **Intercom** Button for 1s, red and blue light flash alternately, then press Intercom button on either unit, the blue light flashing. After pair successful, the blue light slows down.

Step 4: After pair finished, Short press **Intercom** button on unit1 or unit2, it will start intercom between unit1 and unit2.

Step 5: After pair finished, **double press Intercom** button on unit2 or unit3, it will start intercom between unit2 and unit3.

Step 6: After pair finished, Short press **Intercom** button on unit3 or unit4, it will start intercom between unit3 and unit4.

During Intercom talking, short press Intercom button or Phone button to exit intercom mode.

Clear internal intercom pairing record:

Press and hold Volume+ and Volume- button for 2s, red light flash 3 times, then Clear all internal intercom pairing records.

9: Technical specifications:

1. Bluetooth 4.2 Support : HSP,HFP,A2DP,AVRCP, AGHSP
2. Working hours: 15 hours
3. Standby time: 300 hours
4. Charging time: 3 hours
5. Battery: lithium containing rechargeable lithium battery 650mAH, 3.7v
6. Dimensions: 43g
7. Weight: 85mm*40mm*26mm
8. Certification : CE, FCC, TELEC

NOTE: This equipment has been tested and found to comply with the limits for a Class B digital device, pursuant to part 15 of the FCC Rules. These limits are designed to provide reasonable protection against harmful interference in a residential installation. This equipment generates uses and can radiate radio frequency energy and, if not installed and used in accordance with the instructions, may cause harmful interference to radio communications. However, there is no guarantee that interference will not occur in a particular installation. If this equipment does cause harmful interference to radio or television reception, which can be determined by turning the equipment off and on, the user is encouraged to try to correct the interference by one or more of the following measures:

- Reorient or relocate the receiving antenna.
- Increase the separation between the equipment and receiver.
- Connect the equipment into an outlet on a circuit different from that to which the receiver is connected.
- Consult the dealer or an experienced radio/TV technician for help Changes or modifications not expressly approved by the party responsible for compliance could void the user's authority to operate the equipment. This device complies with Part 15 of the FCC Rules. Operation is subject to the following two conditions: this device may not cause harmful interference, and this device must accept any interference received, including interference that may cause undesired operation.



MADE IN CHINA
Web: www.winnerelec.com
E-mail: sales@winnerelec.com