

NavAtlas



NA1BT

INSTALLATION/OWNER'S MANUAL
Digital Bluetooth® Controller

CONTROLLER MOUNTING

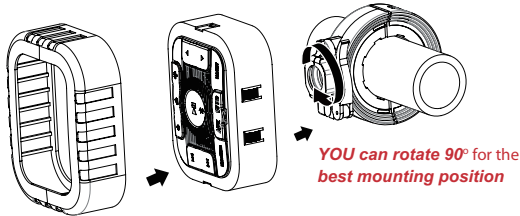

ROLLBAR / CAGE MOUNT

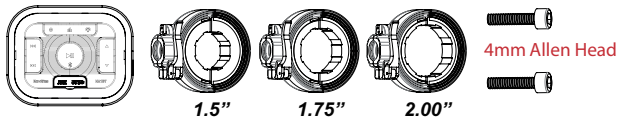

FLUSH MOUNT

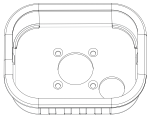

- 1) Always check mounting depth before cutting
- 2) Use the flush bezel as template
- 3) Cutout hole exactly
- 4) Insert flush mount bezel, push side tabs outwards
- 5) Use optional silicon glue to give extra hold
- 6) Insert **CONTROLLER**

SURFACE MOUNT

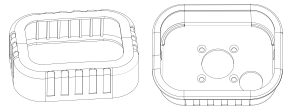

- 1) Check mounting depth before drilling
- 2) Use the flush bezel as template
- 3) Drill or cut wire hole exactly
- 4) Insert rubber trim around flush bezel, screw in place
- 5) Insert **CONTROLLER**

<p>TOOLS NEEDED: - Crimp Tool - Wrench or Pliers - 4mm Allen Wrench</p>	<p>OPTIONAL TOOLS NEEDED: - Hand saw or Jigsaw</p>
---	--

UNIVERSAL INSTALLATION

AFTERMARKET SYSTEM

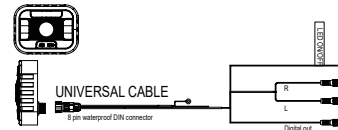

POWER

- RED - 12V+ACC
- BLACK - CHASSIS GROUND
- BLUE - OPTIONAL LED CONTROL

AUDIO

- RED RCA - ANALOG RIGHT
- WHITE RCA - ANALOG LEFT
- GREY RCA - DIGITAL CO-AXIAL OUTPUT

ANALOG INSTALLATION W/AFTERMARKET AMPS

WHEN USING AFTERMARKET AMPLIFIERS WITH SOUNDBARS, YOU MUST USE ANALOG CABLES FOR DASYI CHAIN FUNCTION TO WORK. A2A CABLE(SOLD SEPARATELY) IS REQUIRED FOR ANALOG AUDIO OUTPUT TO WORK IN THIS SETUP.

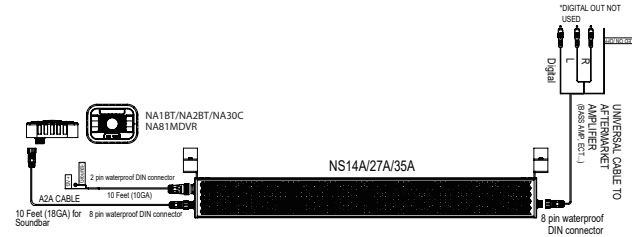

EXAMPLE OF DAISY CHAIN DIGITAL CONFIGURATIONS FOR ANY VEHICLE

*OPTIONAL ACCESSORIES ARE D2Y AND D2D CABLES (SOLD SEPARATELY)

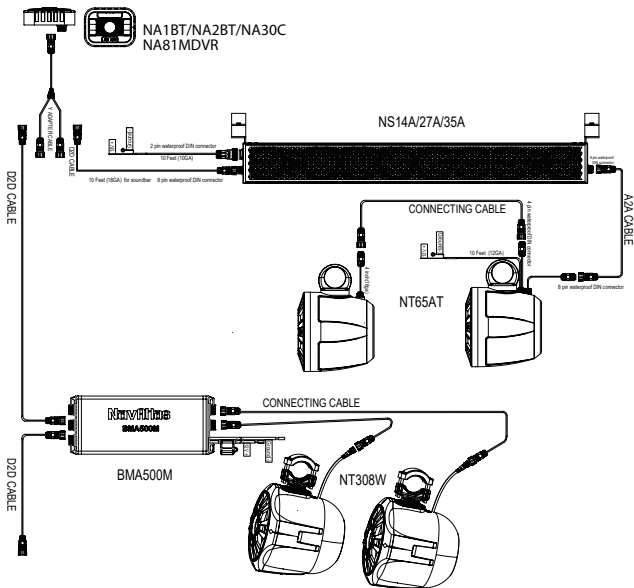

OUTPUT CAN CONNECT TO ANY MODEL
(NS14A/27A/35A, NT650AT, BMA500M, ECT...)

GETTING STARTED

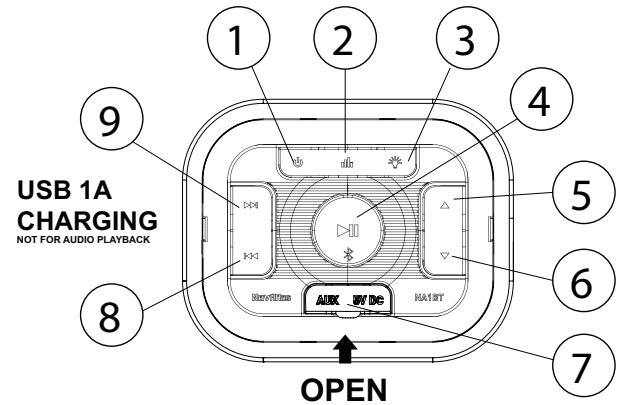

USB 1A CHARGING
NOT FOR AUDIO PLAYBACK

OPEN

NOTE: TO AVOID WATER DAMAGE, PLEASE KEEP AUX/USB COVER CLOSED WHEN NOT IN USE.

- 1 POWER ON
- 2 EQ MODES: FLAT - LOW - MID - HIGH*
- 3 LED LIGHT ON/OFF
- 4 PLAY/PAUSE/MUTE
- 5 VOLUME UP
- 6 VOLUME DOWN
- 7 AUX INPUT/USB CHARGING
- 8 PREVIOUS TRACK
- 9 NEXT TRACK

***NOTE:** WHEN USING EQ MODES, SOME MUSIC CAN DISTORT AT MAX VOLUME ON CERTAIN PHONES/DEVICES

BLUETOOTH OPERATION

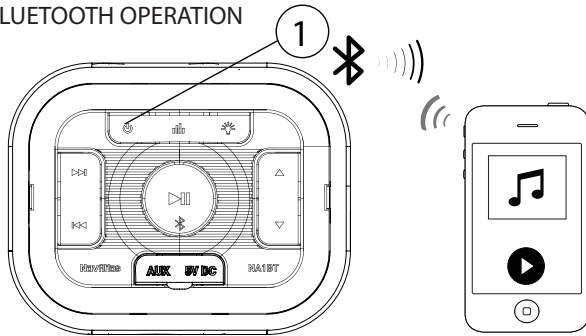

PAIRING & DISCOVERING A NEW BLUETOOTH CONNECTION

1) Power on the **CONTROLLER** by short-pressing the (1) **Power button**

NOTE: You have 2 minutes before you must restart this procedure over again.

2) The **CONTROLLER** is now in pairing mode:

ANDROID users:

- Go into the **Settings Menu** of your device
- Enter the **Bluetooth Menu**
- TURN ON Bluetooth** and press **SCAN**
- "NA1BT" will now be displayed under **AVAILABLE DEVICES**

iOS users:

- Go into the **Settings Menu** of your **iOS** device
- Enter the **Bluetooth Menu**
- TURN ON Bluetooth**
- "NA1BT" will now be displayed

3) If **NA1BT** is not seen, repeat the above steps to refresh the "**Device List**"

4) When the connection is successful a tone will be heard, and the **Bluetooth** LED indicator will light solid, you are now ready to stream music from your player to the **CONTROLLER**

BLUETOOTH OPERATION

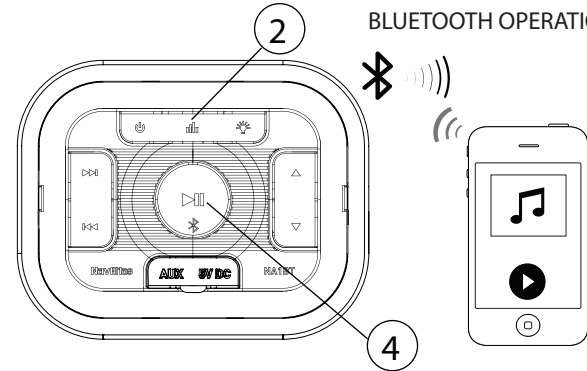

RECONNECTION

1) Power on the **CONTROLLER** and your last paired device Bluetooth.

2) Ensure you are within range of the **CONTROLLER**, the unit will now automatically reconnect

3) If the device is out of range from the **CONTROLLER**, it will disconnect automatically:

- The **CONTROLLER** will reconnect automatically to your device when in range

4) If your device was previously paired with the **CONTROLLER**, but it wasn't the last paired device:

- Ensure no other devices are currently paired
- Enter the **Bluetooth Menu** on your device being paired
- "NA1BT" will display under **AVAILABLE DEVICES**
- Choose the "**NA1BT**" to reconnect

4) Long press (2) **EQ button** 3~6 seconds, reset paired device list.

5) Long press (4) **PLAY/PAUSE button** 3~6 seconds, enter pairing mode.

NOTE: Some devices may require a manual **Bluetooth** reconnection once the devices **Bluetooth** is powered **OFF / ON** and/or back in range

STREAMING MUSIC

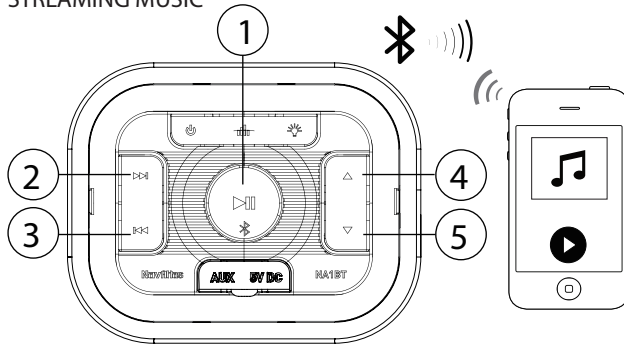

BLUETOOTH OPERATION

- 1) Press the **1** **PLAY/PAUSE** once to start playing music or press the **PLAY** button from your devices touch screen
- 2) To skip songs or advance, press the **2** **NEXT TRACK** button
- 3) To select the previous song, press the **3** **PREVIOUS TRACK** button

VOLUME CONTROL

- 4) To raise the volume press the **4** **VOLUME UP** button or use your devices control
- 5) To lower the volume press the **5** **VOLUME DOWN** button or use your devices controls

NOTE: Some devices use an independent volume control, for most devices the volume control on the controller will adjust the phone volume, in other cases you will need to raise the phone volume to max in order hear the music clearly.

WARNING: DO NOT USE AUX AND BLUETOOTH AT THE SAME TIME.

***NOTE:** Bluetooth HD Streaming available on devices/phones that support this function/codec

AUX-INPUT

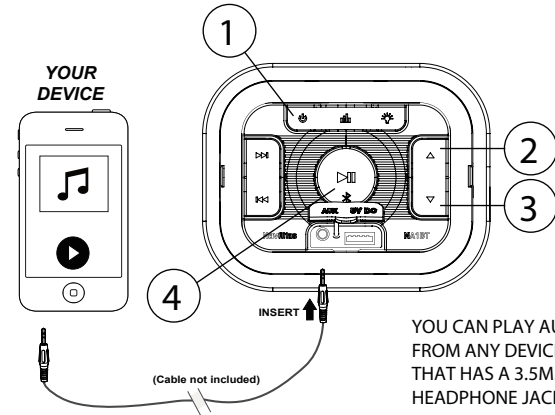

YOU CAN PLAY AUDIO FROM ANY DEVICE THAT HAS A 3.5MM HEADPHONE JACK

CONTROLLER AUX-IN OPERATION

- 1) Power on the **CONTROLLER** by pressing and holding down the **1** **POWER** button for 3 seconds
- 2) Disconnect any paired **Bluetooth** device by turning off **Bluetooth** in your devices **Settings Menu**
- 3) Connect your 3.5mm **AUX-IN** cable located on front side of the **CONTROLLER** to your devices headphone jack
- 4) Route the wire back to **CONTROLLER**, secure your device in a safe location

VOLUME CONTROL

- 5) To raise the volume press the **2** **VOLUME UP** button
- 6) To lower the volume press the **3** **VOLUME DOWN** button

FCC Compliance

This device complies with part 15 of the FCC Rules. Operation is subject to the condition that this device does not cause harmful interference (1) this device may not cause harmful interference, and (2) this device must accept any interference received, including interference that may cause undesired operation.

Changes or modifications not expressly approved by the party responsible for compliance could void the user's authority to operate the equipment.

NOTE: This equipment has been tested and found to comply with the limits for a Class B digital device, pursuant to Part 15 of the FCC Rules. These limits are designed to provide reasonable protection against harmful interference in a residential installation. This equipment generates, uses and can radiate radio frequency energy and, if not installed and used in accordance with the instructions, may cause harmful interference to radio communications. However, there is no guarantee that interference will not occur in a particular installation.

If this equipment does cause harmful interference to radio or television reception, which can be determined by turning the equipment off and on, the user is encouraged to try to correct the interference by one or more of the following measures:

- Reorient or relocate the receiving antenna.
- Increase the separation between the equipment and receiver.
- Connect the equipment into an outlet on a circuit different from that to which the receiver is connected.
- Consult the dealer or an experienced radio/TV technician for help.

To maintain compliance with FCC's RF Exposure guidelines, This equipment should be installed and operated with minimum distance between 20cm the radiator your body: Use only the supplied antenna.

NavAtlas™

Support Line: 1-562-946-7471
9AM-5PM PST Monday-Friday

www.navatlas.com

All rights reserved.

NSA0318-V01
Printed in China