

# D8

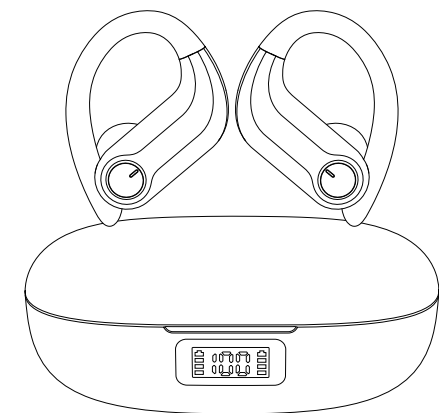

## User Manual

### Customer Service

Email: service@foycoy.cn  
Web: www.foycoy.cn  
WhatsApp: (+86) 1392 3490 475

### Packing List

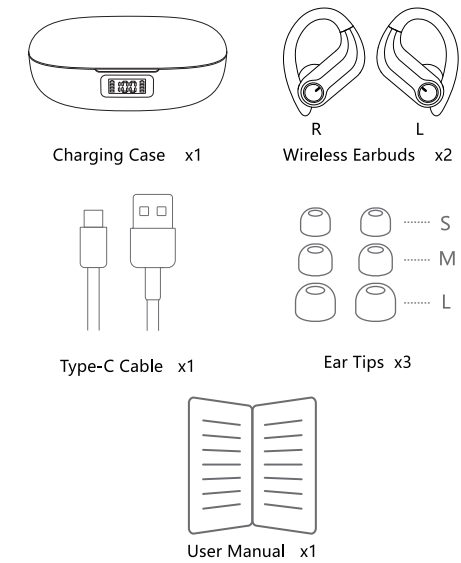

### Overview

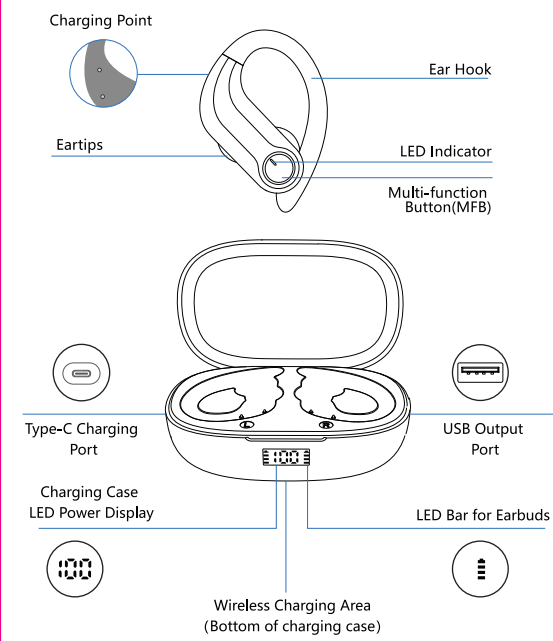

\*Note: Please remove protective films of the LED power display screen and charging point before using them.

### Product Specification

1. Model Name: D8
2. Bluetooth Version: V5.0
3. Supports: A2DP, HFP, HSP, AVRCP
4. Earbuds Size/Weight: 48\*38\*27mm/9g
5. Charging Case Size/Weight: 100\*63\*41mm/127g
6. Charging Port: Type-C
7. Standby Time: 140H
8. Earbud Battery: 70mAh
9. Charging Case Battery: 2600mAh
10. Transmission Rang: 33 feet (without obstacle)

### Power On/Off

**Auto Power On**  
Take the earbuds out from the charging case, they will turn on automatically.

**Auto Power Off**  
Put the earbuds back into the charging case, they will disconnect & turn off automatically.

**Manually Power On**  
If the earbuds are out of the charging case and power off, then press & hold them for 2s, they will power on.

**Manually Power Off**  
In non-music mode or standby mode, press & hold either earbud for 5s, both earbuds will power off at the same time.

### Bluetooth Connection

Prior to first use (or not in use for long time), please fully charge both earbuds and charging case.

#### First Time Pairing

Step 1 - Take twin earbuds out from charging case, they will automatically power on and enter pairing mode.

At this time, led indicator of master earbud will flash Blue & Red light alternately, and the vice earbud led indicator flashes Blue 2 times every 2s.

Step 2 - Activate the Bluetooth setting on your phone, search and connect "D8".

Once connected, the led light of both earbuds goes off.

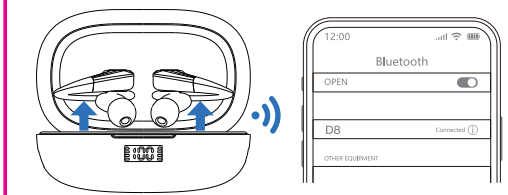

\*Note: If the earbuds are not connected to your device over 5 minutes, the earbuds will power off automatically.

### For Second Time Use

If the earbuds have already connected with your device, and the Bluetooth setting of this device is on, in the second time using, when you take out the earbuds from the charging case, they will connect with your device automatically.

#### Pair with Other Device

D8 sports earbuds have memory function, they usually auto connect with the last paired device.

Thus, if you want to pair them with other device, you should disconnect "D8" from the last paired device, AND forget the pairing record on the last device. Then try to connect it to a new device, it should work properly.

#### Mono Mode (Only Left/Right Earbud is being Used)

You can use one earbud alone, leave another earbud in the charging case.

- When in Dual mode, put one earbud into the charging case.
- Or only take one earbud out of the charging case, then search & connect "D8" on your device.

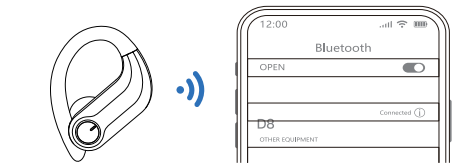

### Factory Restore Settings

#### When should I reset?

- 1) Only one earbud plays music.
- 2) Both earbuds can not work with together.
- 3) Occur connection issues.

#### Follow Steps Below To Reset Earbuds

**Step 1:** Delete the pairing name "D8" on your phone and deactivate the Bluetooth setting of all devices near by the earbuds.

**Step 2:** Put the two earbuds in the charging case, keep them in the charging state.

**Step 3:** Press the MFB button for 8 seconds, then the earbud will flash red & blue light alternately for 3 seconds, which means the both earbuds have reset completely.

**Step 4:** Now, pick up the earbuds to turn them on, activate the Bluetooth setting on your phone search and select "D8" to connect, it should work properly.

If not, please put the earbuds back to the charging case and repeat the steps above.

\*Note: After resetting, the pairing record between the earbuds and all your devices will be cleared. In case there is any unsuccessful message in your pairing process again.

## Earbuds Charging

### To Charge Earbuds

Insert the Earbuds into charging case properly, they will power off & get charged.

Flash during charging;  
Turn off once fully charged.

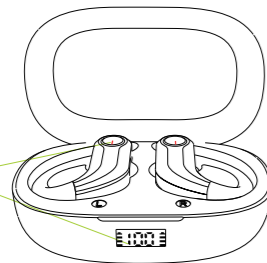

(Earbud's LED light: Red light up means "being charged", Red light off means "fully charged".)

**\*Note:** For the first time charging, please remove the plastic films on the earbuds. charging points.

### Low Battery Alarm

When the battery is less than 10% (and the voltage is lower than 3.4V), a prompt voice "Please charge" will be advised, announce once every 5 minutes and 5 times in total, and then the earbuds will power off as normal.

**Tips:** If the earbuds don't charge or even can't turn on, that may because there is oxidized layer or something else on the charging connector or charging pin.

You can solve this problem by cleaning the magnet connector on the earbuds and charging pin on the charging case with alcohol wipes.

07

## Charging Case Charging

### Type-C Charging

There is a Type-C charging cable in the small black paper box inside the packing box. Please use the provided Type-C cable with a 5V/1A adapter(not included) to charge the charging case.

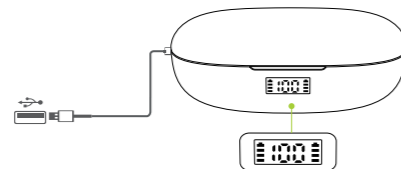

During charging, the charging case power display will show the battery in real time. The number will be displayed as 100 when fully charged.

### Wireless Charging

Easy to charge your charging case without cables, just put the charging case on a wireless charging pad.

If the charging case doesn't start to charge, please try to reposition it. (Wireless Charging Pad Not Included)

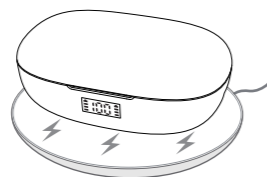

08

## To Charge Your Phone

Fully charged charging case supports charging your mobile phone, connect it to your mobile phone with your charging cable.

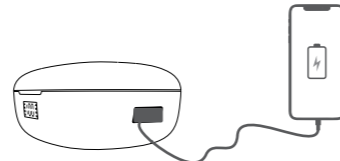

## Multi-Function Operations

### For Call

Answer Call: Click Once  
End Call: Click Once  
Reject Call: Long Press 2S

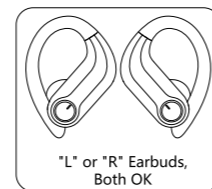

### Voice Assistant

Voice assistants: Quick Triple-Click

**\*Note:** Must in non-music mode or standby mode.



09

## For music

### [Functions on "R" Earbud]

Play/Pause: Click Once  
Next Track: Quick Double-Click  
Volume +: Long Press & Hold

**\*Note:** In mono mode, "R" earbud only supports next song and volume +. You have to go back to the previous song by your phone.

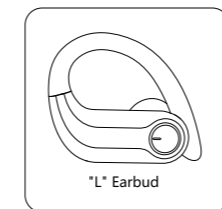
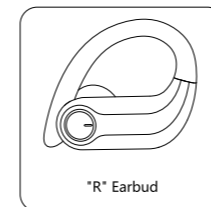

### [Functions on "L" Earbud]

Play/Pause: Click Once  
Next Track: Quick Double-Click  
Volume +: Long Press & Hold

**\*Note:** In mono mode, "L" earbud only supports next song and volume -. You have to go back to the previous song by your phone.

## How to Wear the Earbuds Correctly?

Choose best-fit ear tips, gently push the earbuds into your ears and adjust them to get a comfortable fit.

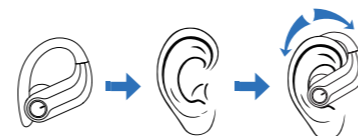

10

## Safety Attention

1. Do not use the earbuds while driving a car, operating machinery or performing other activities that require hearing surrounding sounds.
2. Using earbuds at high to moderate volumes for extended periods of time will result in permanent hearing damage. It is advised you keep volume levels moderate to low at times for your safety.
3. Please avoid use in thundering and raining days to prevent damage or electrical shock.
4. Please keep the earbuds out of extreme heat or humidity, do not use any corrosive cleaner/oil to clean the earbuds.
5. Please avoid disassemble/reassemble the product in case of failure or fire accident.
6. Please keep beyond the reach of kids or pets.
7. Please stop using the device if it causes any discomfort or pain.
8. As the Bluetooth signal cannot transmit in water it is not suitable for swimming or diving. If submerged in water, do not turn the earbuds on until completely dried.

## How to Place the Earbuds?

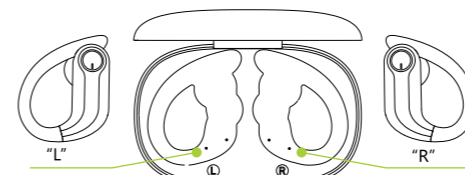

11

## How to sync volume on Android?

To protect users from potential hearing damage, Android's limit on max volume is quite low for Bluetooth audio devices.

If you feel the volume is too low, please access developer options and enable absolute volume, so you'll be able to max the volume at your own volition and to the full capabilities of your Bluetooth earbuds.

(Please scan this QR code to watch a video to learn more details.)



### Find Build Number Firstly

**Android 4.1 and lower:** the Developer options screen is available by default.

**Android 4.2 and higher:** the Developer options in Android phones are hidden, you must enable this screen through Build Number.

**Android 7.1 and lower:** Settings > About Phone > Build Number  
**Android 8.0.0 and Android 8.1.0 :** Settings > System > About Phone > Build Number

### Enable Developer Options

Locate the Build number and tap it about 7 times in succession to enable Developer options. You may also have to tap in your PIN for verification. Once developer options are activated, you will see a message that reads "You are now a developer".

12

Go back to the Settings pane, search Developer options as an entry. At the top of the Developer options screen, you can toggle the options as figure 1.

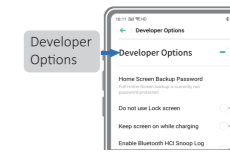

[figure 1]

### Enable Absolute Volume

Scroll down until you reach the Networking section. Once there, enable (toggle ON) the absolute volume option as figure 2.



[figure 2]

**\*Note:** These options in the figures may be different from the device you're using. Typically, the choices depend on the type and model of the device you are working with.

13

NOTE: This equipment has been tested and found to comply with the limits for a Class B digital device, pursuant to part 15 of the FCC Rules. These limits are designed to provide reasonable protection against harmful interference in a residential installation. This equipment generates uses and can radiate radio frequency energy and, if not installed and used in accordance with the instructions, may cause harmful interference to radio communications. However, there is no guarantee that interference will not occur in a particular installation. If this equipment does cause harmful interference to radio or television reception, which can be determined by turning the equipment off and on, the user is encouraged to try to correct the interference by one or more of the following measures:

- Reorient or relocate the receiving antenna.
- Increase the separation between the equipment and receiver.
- Connect the equipment into an outlet on a circuit different from that to which the receiver is connected.
- Consult the dealer or an experienced radio/TV technician for help.

Changes or modifications not expressly approved by the party responsible for compliance could void the user's authority to operate the equipment.

D8使用说明书

尺寸：75\*115mm

材料：128g双铜

工艺：四色印刷，风琴四折啤圆角