



CHANDASUNG TECH

True Wireless Eaphones

CHANDASUNG D65 INSTRUCTION

Customer Support

support@chandasing.com

Tel: +86 755 23597058

We will reply to you within 24 hours and 100% solve your issues

Packaging List



Earphones x2



Charging Case x1



Eartips x6



USB Charging
Cable x1



Manual x1

Wearing

Step 1: Choose the suitable eartips

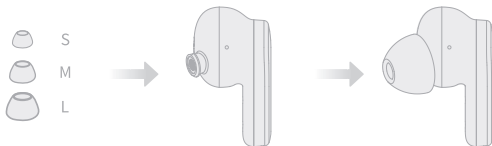

Step 2: Wear it and adjust to a comfortable position

(Please distinguish between the Left and Right earphone)



Power On & Pairing

1. Take out earphones from the charging case, they will start auto pairing immediately



2. Select "D65-L" or "D65-R" whichever can be found from Bluetooth list

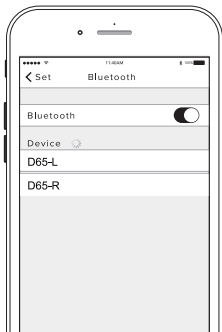

Operation Instructions

Function	Status	Operations
Power on	Powered off	Long press the earphones for 2 seconds
Power on	Charging	Take the earphones out of the charging case
Pairing	Powered off	Auto pairing after power on / take out from the charging case
Voice assistant	Standby / Playing music	Tap the L/R earphones for 3 times
End voice assistant	Standby / Playing music	Tap the L/R earphones for 3 times
Answer the call	Incoming call	Tap the L/R earphone once
End the call	Calling	Tap the L/R earphone once
Reject the call	Incoming call	Tap the L/R earphone twice
Play / Pause	Standby / Playing music	Tap the L/R earphone once
Volume increase	Playing music / Calling	Long press the R earphone
Volume decrease	Playing music / Calling	Long press the L earphone
Previous song	Playing music	Tap the L earphone twice
Next song	Playing music	Tap the R earphone twice
Restore settings	Charging	Keep the earphones in the charging case, long press for 8 seconds
Power off	Powered on	Long press the earphones for 4 seconds when TWS in connection
Power off	Powered on	Put the earphones back into the charging case

Charging

Earphones Charging Status

Earphones white LED light on: Charging

Earphones white LED light off: Fully charged

Note: It takes about 1.5 hours to fully charge the earphones

Charging Case Charging Status

The digital display on the charging case will indicate the charging status and realtime power volume

Note: It takes about 1.5-2 hours to fully charge the charging case

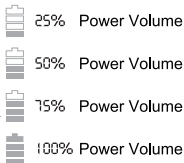
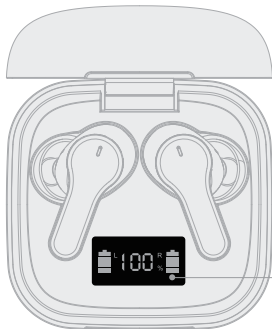

Wireless Charging Supported

We recommend you to use wireless charging pad with Qi certificate

Note: It takes about 2 hours to fully charge the charging case



Note

Please follow below steps when both earphones fail to pair with each other or occur connection related issues

1. Place both earphones to charging case and must remain charging
2. Keep the earphones in the charging case, long press for 8 seconds to restore the factory settings
3. Delete the "D65-L" and "D65-R" Bluetooth name from your phone and turn off the Bluetooth
4. Take out both earphones from the charging case
5. Turn on Bluetooth and click "D65-L" or "D65-R" whichever can be found on your Bluetooth list

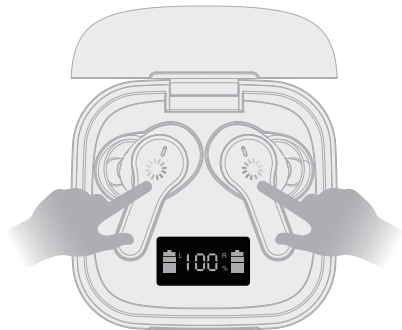

Safety Instruction

Using earphones at high to moderate volumes for extended periods of time will result in permanent hearing damage. It is advised that you keep volume levels moderate to low at all times for your safety.

Do not use while driving, cycling, operating machinery or performing other activities that require hearing surrounding sounds.

Do not use earphones in thunderstorm weather, the earphones may not work properly in the bad weather condition, and may increase the risk of being hit by lightning.

Earphones may not work properly under high temperature or high humidity conditions.

Do not use any corrosive cleaner/oil to clean the earphones. If the earphones come in contact with liquids, quickly wipe away. If submersed in the water, do not turn the earphones on until it is completely dried.

Tips: Warranty void if the earphones submersion in the water. Man-made damage and lost are not covered under warranty. Keep the earphones and the packaging out of reach of children.

Q&A

Q: Why the music cuts in and out sometimes?

A: Please make sure there is no obstacle between the earphones and your device. Please make sure there is no Microwave oven / Wifi transmitter around you, which are more likely to produce electromagnetic interference and result in signal interruption.

Note: Please keep your phone and the master earphones as close as possible to ensure a more stable Bluetooth connection.

Q: What should I do if the earphones stop charging?

A: We recommend you to charge the earphones by using our cable. If our cable do not work, please try to use another charging cable or power source to charge the earphones.

Q: How to contact CHANDASUNG Customer Service Team?

A: If you have any issue with the product, please contact us via support@chandasung.com. We will reply to you within 24 hours and 100% solve your issue.

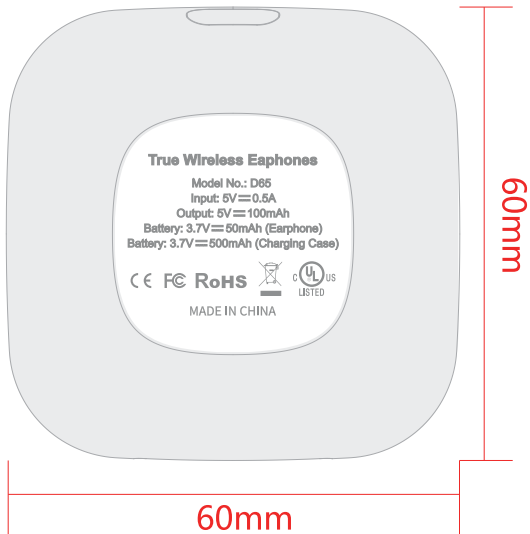

LABEL位置图

FCC STATEMENT :

This device complies with Part 15 of the FCC Rules. Operation is subject to the following two conditions:

- (1) This device may not cause harmful interference, and
- (2) This device must accept any interference received, including interference that may cause undesired operation.

Warning: Changes or modifications not expressly approved by the party responsible for compliance could void the user's authority to operate the equipment.

NOTE: This equipment has been tested and found to comply with the limits for a Class B digital device, pursuant to Part 15 of the FCC Rules. These limits are designed to provide reasonable protection against harmful interference in a residential installation. This equipment generates uses and can radiate radio frequency energy and, if not installed and used in accordance with the instructions, may cause harmful interference to radio communications. However, there is no guarantee that interference will not occur in a particular installation. If this equipment does cause harmful interference to radio or television reception, which can be determined by turning the equipment off and on, the user is encouraged to try to correct the interference by one or more of the following measures:

Reorient or relocate the receiving antenna.

Increase the separation between the equipment and receiver.

Connect the equipment into an outlet on a circuit different from that to which the receiver is connected.

Consult the dealer or an experienced radio/TV technician for help.

RF warning statement:

The device has been evaluated to meet general RF exposure requirement. The device can be used in portable exposure condition without restriction.