

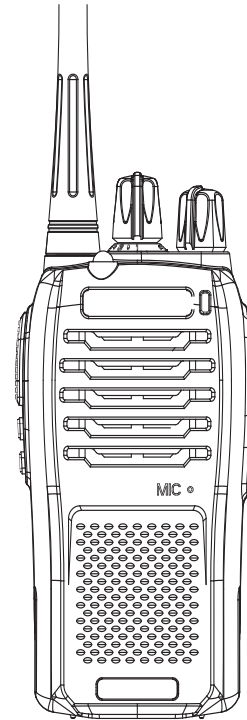

MADE IN CHINA

USER'S MANUAL



(US)

CONTENTS

- Control and Function01
- Unpacking and Inspecting02
- What's in the Box02
- Choice of Battery02
- Using the Micro-USB charger02
- Battery Capacity Maintenance02
- Open the Battery Door03
- Installing the Battery03
- Attaching the Belt Clip (Figure 1)03
- The Antenna Information (Figure 2)03
- Installing the Earpiexe (Figure 3)04
- Micro-USB Charger (Figure 4)04
- Monitor Function04
- Scanning Channel04
- Voice Operated TX04
- CTCSS / DCS04
- SOS Alarm Function04
- Push-to-talk Timeout Timer04
- Automatic Power Save05
- Low Battery Alert05
- Computer Programming05
- Appendix05
- Troubleshooting05
- Warnings06

Control and Function

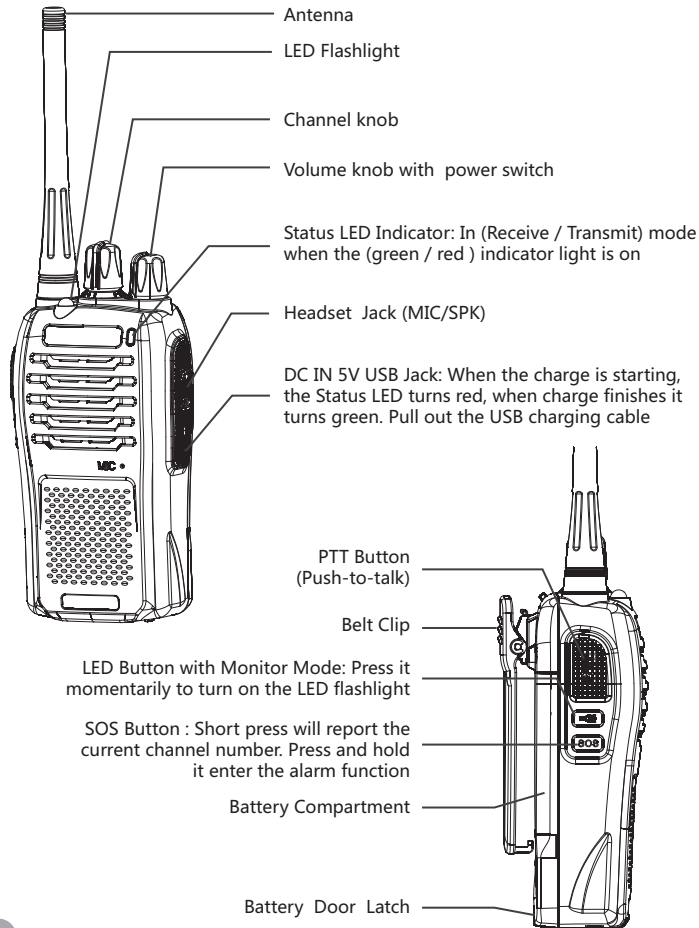

1

Unpacking and Inspecting

Please check the packaging of your radio for any signs of damage. Carefully open the box, and confirm you received the items listed below. If you find the radio or the included accessories are damaged or lost, immediately contact your dealer.

What's in the Box

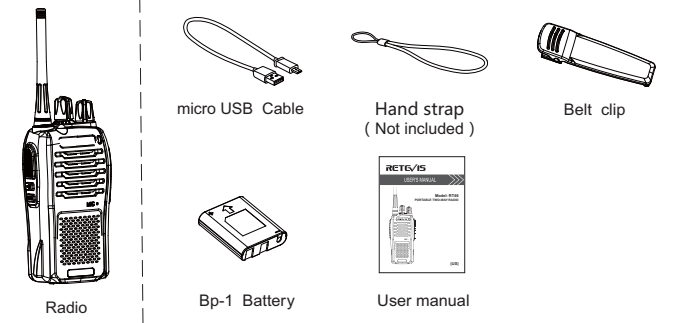

Choice of Battery

Radio can use BP-1 rechargeable battery pack or 3xAA alkaline batteries.

Using the Micro-USB charger

The micro-USB charges is handy port that allows you to conveniently charge your BP-1 Li-ion battery pack.

1. Make sure your radio is turned OFF.
2. Connect the AC adaptor to the radio's DC IN 5V.
3. Charge the battery pack for 3 hours. when charge finishes Status LED turns green. pull out the USB charging cable.

Note: If you don't use the supplied Micro-USB charging cable, the radio will make noise.

Battery Capacity Maintenance

1. Charge the batteries at least once every 3 months when not in use.
2. Remove the battery from the radio after using for storage purpose.
3. Store the batteries in temperatures between -20 to 35 and in low humidity Avoid damp conditions and corrosive materials.

2

Open the Battery Door

1. open the Battery door latch ,
2. remove the battery compartment door.

Caution: Exercise care when removing Li-ion or AA

Alkaline batteries. Do not use sharp or conductive tools to remove either of these batteries. Remove the batteries before storing your radio for extended periods of time. Batteries corrode over time and may cause permanent damage to your radio.

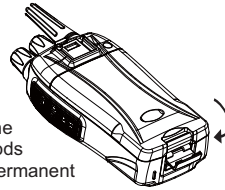

Installing the Battery

1. To remove the battery compartment door, Prepare the batteries.

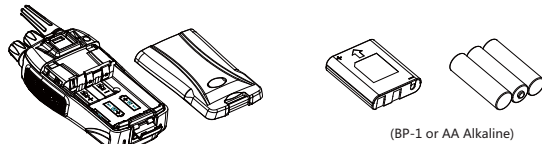

(BP-1 or AA Alkaline)

2. Insert BP-1 Li-ion battery pack or 3 AA Alkaline batteries, Ensuring that the poles are correctly aligned.

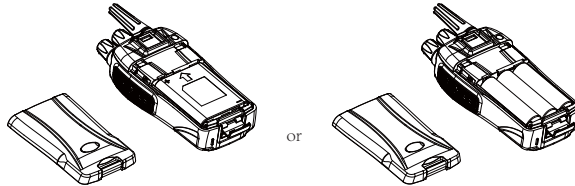

Attaching the Belt Clip (Figure 1)

Attach the belt clip to the radio plate at the back of the radio until the clip clicks in place.

The Antenna Information (Figure 2)

The antenna is fixed antenna and can not be disassembled.

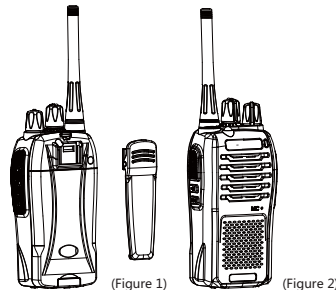

(Figure 1)

(Figure 2)

Installing the Earpiece (Figure 3)

Open the cover of the earpiece jack, align the connector and push fully in.

Micro-USB Charger (Figure 4)

As shown in right Figure When the charge is starting, the Status LED turns red, when charge finishes it turns green. Pull out the USB charging cable.

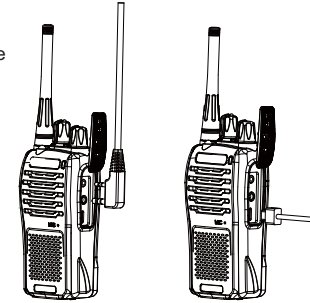

(Figure 3)

(Figure 4)

Monitor Function

Monitor Function Enables you listen for weak signals on the current channel. If necessary, you can press and hold LED button to check for activity on the current channel before you talk. Press and hold SOS Button enter the Monitor mode, release exit the mode.

Scanning Channel

Turn the channel selector to channel 16, the transceiver will automatically detect the activities of scanning channel from 1 to 15.

Voice Operated TX

You can transmit hands-free more reliable with the use of optional headset accessories. Once VOX is turned on, the radio detects your voice and transmits when you speak. (set via software).

CTCSS / DCS

Using these features does not mean that others won't be able to listen in on your transmissions.

They only provide a method to filter out unwanted incoming transmissions.

CTSS/DCS only could be changed via program software.

SOS Alarm Function

Press and hold SOS to activate the alarm function. Press SOS (a short press) again to turn it off.

Push-to-talk Timeout Timer

To prevent accidental transmissions and save battery life, the radio emits a continuous warning tone and stops transmitting if you press the PTT button for 180 continuous seconds.

Automatic Power Save

For better battery life, your radio is designed to switch to power Save mode when there has been no transmissions after 6 seconds. when the radio receive exit Automatic Power Save.

Low Battery Alert

The alert tone sounds every 15 seconds when the battery is low.

Computer Programming

The CTCSS or DCS, TOT, VOX.... only could be programmed by software, The radio kit don't include a programming cable. To attain a data cable, please contact your dealer for it and the soft ware.

Appendix

General	
Frequency Range	462.5500-467.7125MHz
Battery Type	BP-1 1000mAh 3.7V/3xAA Alkaline
Work Temperature	-20 C ~ 60 C
Rated Voltage	5V \pm 1A
Spurious Power	\leq 7.5uw
Sensitivity (Receiver)	-122dBm (12dB SINAD)

Troubleshooting

Symptom	Ution
The radio doesn't start.	Change or recharge the battery . Remove the battery and reinstall it .
The battery dies quickly.	Purchase a new battery Recharge the battery.
Others can't hear your transmission	Change your CTSS or DCS Settings to match your peers. Move in closer.



Operation

General Specifications

Frequency Allocation and Compatibility

A = Channel No. for 22 Channel Models

B = Frequency in MHz

C = Power Output

A	B	C
1	462.5625	High
2	462.5875	High
3	462.6125	High
4	462.6375	High
5	462.6625	High
6	462.6875	High
7	462.7125	High
8	467.5625	Low
9	467.5875	Low
10	467.6125	Low
11	467.6375	Low
12	467.6625	Low
13	467.6875	Low
14	467.7125	Low
15	462.5500	High
16	462.5750	High
17	462.6000	High
18	462.6250	High
19	462.6500	High
20	462.6750	High
21	462.7000	High
22	462.7250	High

WARNING

This device complies with part 15 of the FCC Rules. Operation is subject to the following two conditions: (1) This device may not cause harmful interference, and (2) this device must accept any interference received, including interference that may cause undesired operation.

 **WARNING**

IMPORTANT NOTE:

Note: This equipment has been tested and found to comply with the limits for a Class B digital device, pursuant to part 15 of the FCC Rules. These limits are designed to provide reasonable protection against harmful interference in a residential installation. This equipment generates, uses and can radiate radio frequency energy and, if not installed and used in accordance with the instructions, may cause harmful interference to radio communications. However, there is no guarantee that interference will not occur in a particular installation. If this equipment does cause harmful interference to radio or television reception, which can be determined by turning the equipment off and on, the user is encouraged to try to correct the interference by one or more of the following measures:

- Reorient or relocate the receiving antenna.
- Increase the separation between the equipment and receiver.
- Connect the equipment into an outlet on a circuit different from that to which the receiver is connected.
- Consult the dealer or an experienced radio/TV technician for help.

SAFETY INFORMATION

Your wireless hand-held portable transceiver contains a low power transmitter. This product sends out radio frequency (RF) signals when the Push-to-Talk (PTT) button is pressed. The device is authorized to operate at a duty factor not to exceed 50%. In August 1996, the Federal Communications Commissions (FCC) adopted RF exposure guidelines with safety levels for hand-held wireless devices. To control your exposure and ensure compliance with the general population or uncontrolled environment exposure limits, keep the radio at 2.5 cm away from the face, use non-approved accessories may cause the radio to exceed RF exposure limits.

Any Changes or modifications not expressly approved by the party responsible for compliance could void the user's authority to operate the equipment.



Avoid Burns

Small Parts. Not for children under 3 years.



Turn off your radio power in the following conditions:

- Turn off your radio before removing (installing) a battery or accessory or when charging battery.
- Turn off your radio when you are in a potentially hazardous environments: Near electrical blasting caps, in a blasting area, in explosive atmospheres (flammable gas, dust particles, metallic powders, grain powders, etc.).
- Turn off your radio while taking on fuel or while parked at gasoline service stations.

To avoid electromagnetic interference and/or compatibility conflicts

- Turn off your radio in any facility where posted notices instruct you to do so, hospitals or health care facilities (Pacemakers, Hearing Aids and Other Medical Devices) may be using equipment that is sensitive to external RF energy.
- Turn off your radio when on board an aircraft. Any use of a radio must be in accordance with applicable regulations per airline crew instructions.

Note:

- Pacemakers

Defibrillators or other Implanted Medical Devices Persons with pacemakers, Implantable Cardioverter-Defibrillators (ICDs) or other active implantable medical devices (AIMD) should:

- ALWAYS keep the radio more than 15cm from their pacemaker when the radio is turned on.
- Consult with their physicians regarding the potential risk of interference from radio frequency transmitters, such as portable radios (poorly shielded medical devices may be more susceptible to interference).
- Turn the radio OFF immediately if they have any reason to suspect that interference is taking place.
- Do not carry the radio in a chest pocket or near the implantation site, and carry or use the radio on the opposite side of their body from the implantable device to minimize the potential for interference.

- Hearing Aids

Some digital wireless radios may interfere with some hearing aids. In the event of such interference, you may want to consult your hearing aid manufacturer to discuss alternatives.

- Other Medical Devices

If you use any other personal medical device, consult the manufacturer of your device to determine if it is adequately shielded from RF energy. Your physician may be able to assist you in obtaining this information.



Protect your hearing:

- Use the lowest volume necessary to do your job.
- Turn up the volume only if you are in noisy surroundings.
- Turn down the volume before adding headset or earpiece.
- Limit the amount of time you use headsets or earpieces at high volume.
- When using the radio without a headset or earpiece, do not place the radio's speaker directly against your ear.

Note:

Exposure to loud noises from any source for extended periods of time may temporarily or permanently affect your hearing. The louder the radio's volume, the less time is required before your hearing could be affected. Hearing damage from loud noise is sometimes undetectable at first and can have a cumulative effect.



**Avoid Burns
Antennas**

- Do not use any portable radio that has a damaged antenna. If a damaged antenna comes into contact with the skin when the radio is in use, a minor burn can result.

Batteries (If appropriate)

- When the conductive material such as jewelry, keys or chains touch exposed terminals of the batteries, may complete an electrical circuit (short circuit the battery) and become hot to cause bodily injury such as burns. Exercise care in handling any battery, particularly when placing it inside a pocket, purse or other container with metal objects.

Long transmission

- When the transceiver is used for long transmissions, the radiator and chassis will become hot.



Safety Operation

- Forbid

- Do not use charger outdoors or in moist environments, use only in dry locations/conditions.
- Do not disassemble the charger, that may result in risk of electrical shock or fire.
- Do not operate the charger if it has been broken or damaged in any way.
- Do not place a portable radio in the area over an air bag or in the air bag deployment area. The radio may be propelled with great force and cause serious injury to occupants of the vehicle when the air bag inflates.

- To reduce risk

- Pull by the plug rather than the cord when disconnecting the charger.
- Unplug the charger from the AC outlet before attempting any maintenance or cleaning.
- Contact Retevis for assistance regarding repairs and service.

- Use of Communication Devices While Driving

- Always check the laws and regulations on the use of radios in the countries and areas where you drive.
- Give your full attention to driving and to the road.
- If available, use the hands-free facility.
- If driving conditions or regulations require it, pull off the road and park before making or answering a call.

EU Importer:
Name: Germany Retevis Technology GmbH
Address: Uetzenacker 29,38176 wendeburg