

THINBE

USER MANUAL

Table Of Contents

01	Before Use.....	3
02	Composition and Features.....	4
	Specification and Composition / Identification and Features	
03	Prohibition and Caution.....	8
	Prohibition / Caution	
04	How to Use.....	9
	How to Use THINBE / Level Instruction / How to Charge / Use Precautions	
05	Maintenance.....	13
	Before defining malfunction	
06	Product Warranty Letter.....	14
	Letter of Warranty.....	
	Contents of Warranty	

Copyright© 2018 Attibe Beauty Corporation

The products described in this document are protected by various domestic and international intellectual property rights, including industrial property law and copyright, and unauthorized copying or use of the document is prohibited without a written consent from Attibe Beauty.

01_ Before Use

■ Before use the product,

1. Start from a low level which is suitable for the person's condition. Steady using of the product is more important.
2. You may feel sting depending on the intensity. If you don't use RF Cream, the feeling of stimulation may be increasing. Also, there might be a difference of abdomen stimulation depending on the amount of the fat in the area.
3. If the device isn't contacted to abdomen or if you perform a long time treatment on same area, you may feel a little sting.
4. Before use, please apply enough amount of RF Cream.
5. You may feel the stimulation is getting soft when you keep using the device. This is a natural result of that the muscle keeps exercising. In this case, please use the device with higher level.
6. Some mark like bruise may occur due to the strong stimulation after a long treatment. Do not use the device on same area for a long time and please move the use area.
7. There may be muscle movement after the treatment for a while due to the exercising effect.

02_ Composition and Features

■ Specification

Input Power	100-240VAC, 50/60 Hz, 1.5A
Hz / Voltage	990Hz~1,010Hz / 16V~40v (5 Level)
Battery	3.7V / 1800mAh
Bluetooth	Bluetooth 4.2 Low Energy
Auto Timer	Automatic power-off after 10 mins of treatment
Size	W 11.5 x D 11.5 x H 9 cm

■ Composition

Product composition is as follows:

Main body (1 SET), Micro-USB (5Pin) (1 SET), Cradle (1 SET)



Main body



Micro-USB (5Pin)



Cradle

■ Identification and Features

Main Body (Front)

- 1 Power/LED Button: Turn On/Off
- Push it more than 2 seconds
LED Color: - Push it to change color
- Basic status: Red LED
- 2 Battery Remains:
Low – Flickering Red light
Charging – Red light
Full charge – Green light
- 3 Level Button: Level change
- Basic status: Level 1
- Push ▷: 1 → 2 → 3 → 4 → 5
- Push ◀: 5 → 4 → 3 → 2 → 1
- 4 Mode Button: Push it to change mode
- Soft → Hard or Hard → Soft
- 5 Level Display: Current Hz Level
- Basic statue: Level 1



Main Body (Back)

- 1 Pole: Electrostimulation occurs the area.
Apply RF Cream on your skin before use.
- 2 LED: 3 Color LED (Red, Yellow, Blue) offers skin protection and sterilization effect.
Red: Skin Elasticity Yellow: Skin Shine
Blue: Sterilization effect
- 3 Human Body Sensing: It decides Hz output depending the body contact condition.
With body sensing: → Auto On
Without body sensing → Auto Off

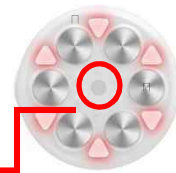

Main Body (Side)

- 1 Battery Charging Socket: Charging the internal battery by putting battery charging cable in this socket.



03_ Prohibition and Caution

■ Prohibition

Do not use the product, if any of following conditions you are in.

- ⊘ Pregnant woman
- ⊘ Patient with dermatitis
- ⊘ Heart and facial area
- ⊘ Person with metal allergy
- ⊘ Patient with atopic dermatitis
- ⊘ Person with abnormal reaction to electrostimulation
- ⊘ Person with telangiectasia
- ⊘ Person who had (metallic) implant or

⚠ Caution

Do not use the product along with the following medical equipment. Accident and malfunction of the equipment may cause serious injury.

- Implantable medical devices such as a pace maker
- Electrical life-support equipment such as heart and lung machine
- Mounted medical devices such as electrocardiograph

04_ How to Use

■ How to Use THINBE

This device provides two modes:

Soft mode (5 level): Muscle exercising

Hard mode (5 level): Muscle training by triple power slimming care
1~2 level of each mode are designed for soft area such as arms and legs. For abdomen and back, please use from level 3. It is required to apply RF Cream on use area before treatment.

1) Soft mode (For muscle exercising)

- Before treatment, apply enough amount of RE Cream to use skin area.
- Turn on the device by pushing power button more than 2 seconds.
- Hard mode will be displayed when you turn on the device.

Push the power button and change to Soft mode.

- Adjust power level with ◀ ▶ LEVEL button.
- If the device is contacted with the body, you will hear alarm sound and the treatment will be started after one second. At the same time, LED will turn on for beauty purpose.
- Recommend treatment time is 10 minutes for each area. After that, the device will be automatically turned off.
- After treatment, please turn off the device, remove RF Cream at the

bottom of the device, and then, keep or charge it.

2) Hard mode (For training muscle with triple power slimming care. It has a similar effect with twisting muscle. So there may be a personal difference in the feeling of pain.)

- Before treatment, apply enough amount of RE Cream to use skin area.
 - Turn on the device by pushing power button more than 2 seconds.
 - Hard mode will be displayed when you turn on the device.
 - Adjust power level,
 - If the device is contacted with the body, you will hear alarm sound and the treatment will be started after one second.
 - The weak areas like arms and thighs may be too sensitive for stimulation.
- Please start with 1~2 level so that you can be slowly get used to it.
- There are five levels of exercise.

■ Level Instruction

LEVEL 1 1~2level are designed for soft areas such as arms and legs. At first, please test the intensity of frequency and increase level gradually.

LEVEL 2 Perform the treatment on areas such as arms and legs after getting used to the stimulation.

LEVEL 3 You can use this level for abdomen and back while you are getting used to the stimulation. This mode offers a little strong exercising stimulation on fat areas like abdomen.

LEVEL 4 자This mode is for full muscle exercising after getting used to the stimulation. From level 4, treatment over 10 minutes may cause trouble to your body. Please must have break during treatment

LEVEL 5 This is a strong stimulation mode. Some people may feel sting and in this case, please apply enough RF Cream and closely contact the pole to your abdomen. (If the stimulation is too strong, please lower the degree of abdomen contact.)

※ Power will be automatically turned off for safety reasons due to overcurrent, overdischarge of battery and auto off function (after 10 minutes).

■ How to Charge

1. When you charge the device, battery charging display will turn on and it starts to charge. It will change to green light when the device is fully charged. Even it is fully charged, it takes time to recharge again after using for a while.
2. This device is out of factory with 50% charging. Please recharge the device when you receive it. If the charging level is too low due to natural electric discharge, it may take some time to recharge the device.
3. If you leave the device without charging more than 3 months, there is a possibility that it may not be turned on due to overdischarge of the battery. In this case, please recharge the device before use.
4. If the device cannot be turned on or immediately be turned off, and battery charging display is flickering, it means that the battery is discharged. In this case, please recharge the device. Recharging time will be longer than the usual.

■ Use Precautions

- ⚠ Please remove RF Cream from the device before and after use. Remained RF Cream will be dried, transparent and unseeable. And it will make the stimulation weaker and change the color of pole.
- ⚠ This device is not waterproof product. Please wipe it out with soft wet tissue. You cannot wash or use the device in the water.
- ⚠ Especially, must avoid using this device in the water. It may cause powerful electric shock.
- ⚠ Follow the use time and frequency in the manual.
- ⚠ If your body is wet after shower, please remove the moisture before use.
- ⚠ Stop using the device if you feel any abnormality in your body or skin.
- ⚠ Keep the device away from children and do not use on children.
- ⚠ Do not use the device on the areas such as heart, face, head. (It may cause a shock due to the strong stimulation.)
- ⚠ Turn off the device after use.
- ⚠ You cannot use the device during charging.
- ⚠ Do not disassemble, modify and repair the device (It will cause a direct malfunction.)
- ⚠ If the device is damaged or has a malfunction, please contact A/S center or the supplier for the inspection and repair.
- ⚠ If there is any extraordinary reaction to RF Cream, stop using the Cream.

■ Connect and Use the Bluetooth

1. My Attibe application is downloaded through the Google Store or App Store, and after the download, the membership process will proceed

Sign Up

attibe

ID example@hironic.com

password *****

reconfirm password

phone +82 | 1031150221 Acpt

certification Number Acpt

Next

2. If you launch the app after registering, you will be presented with a list of Bluetooth products as below. After clicking on the Thinbe product and connect it when you run the device. (The following is an example of the ACZERO product.)



3. If the device is connected properly, the connection completion pop-up opens, and if it is not connected, the non-connectable pop-up opens

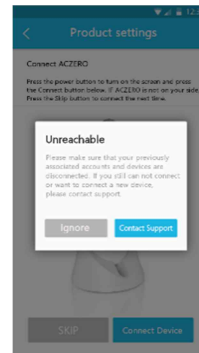
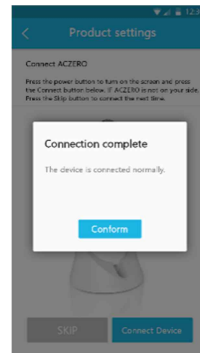

4. Data provided through Bluetooth include cumulative usage time, start time of use, date of use, treatment start time on the used day, and treatment end time on the used day .

Cumulative Count	Cumulative usage time	Usage time	Date	Time Start	Time Stop
1	6'00"	6'00"	20150601	09:42	09:48
2	9'00"	3'00"	20150602	10:26	10:29
3	12'00"	3'00"	20150602	18:33	18:36

05_Before defining malfunction

When the stimulation is too week or can't feel anything

- Didn't you use RF Cream? Or did you apply enough amount?
Perform the treatment after applying enough amount of RF Cream.
- Was the device closely contacted with your skin?
Closely contact the device with your skin and use.
Check charging alarm lamp and charge the device.
- Is there a foreign substance on the pole?
Wipe the substance out.
- Is the stimulation level set to 1~2?
Adjust the level.

When you feel a sting

- Didn't you apply RF Cream before use or Did you use other material?
Apply enough amount of Cream. Use the RF Cream.
- Does your skin have an infection?
If there is a wound or a little infection on your skin, please stop using the device.

When you feel an abnormality on your skin

- Do you use the device too long?

Reduce the use time. (Recommendation: 10 minutes)

- Do you use too strong level?

Lower the level.

- Has the pole area been contaminated?

Wipe the pole area with a soft cloth.

[When it doesn't work or there is a malfunction after a great shock](#)

- Please contact A/S Center. (1522-7599)

Contents of Warranty

- If the device goes wrong due to the fault of manufacturing within the warranty period, we will offer you a free repair or reward for it according to consumer injury compensation rule.

- In the case of below, we will offer you a charged repair even if the warranty period isn't expired.

- Usage for alternate purpose or Breakdown due to careless handling

- Breakdown or damage caused by repairing or modifying the device which was not made by our A/S Center

- Natural disaster (Breakdown due to fire, sea wind, flood, etc.)

- Breakdown or damage

due to the intention or
fault of the customer
Using the device without
respect to the manual
instruction

[Vendor](#) Attibe Beauty
Corp.

3rd Fl., Myeonghwa Bldg., 12, Dosan-daero 8-gil, Gangnam-gu, Seoul
[Homepage](#) www.attibe.com

FCC Information

This device complies with part 15 of the FCC Rules. Operation is subject to the following two conditions :

- (1) This Device may not cause harmful interface, and
- (2) This device must accept any interference received, including interference that may cause undesired operation.

Note: This equipment has been tested and found to comply with the limits for CLASS B digital device, pursuant to Part 15 of FCC Rules. These limits are designed to provide reasonable protection against harmful interference when the equipment is operated in a commercial environment This equipment generates, uses and can radiate radio frequency energy and, if not installed and used in accordance with the instructions, may cause harmful interference to radio communications. However, there is no guarantee that interference will not occur in a particular installation. If this equipment does cause harmful interference to radio or television reception, which can be determined by turning the equipment off and on, the user is encouraged to try correct the interference by one or more of the following measures:

- 1.1. Reorient or relocate the receiving antenna.
- 1.2. Increase the separation between the equipment and receiver.
- 1.3. Connect the equipment into an outlet on a circuit different from that to which receiver is connected.
- 1.4. Consult the dealer or experienced radio/TV technician for help.

WARNING

Changes or modifications not expressly approved by the manufacturer could void the user's authority to operate the equipment.

"CAUTION : Exposure to Radio Frequency Radiation.

Antenna shall be mounted in such a manner to minimize the potential for human contact during normal operation. The antenna should not be contacted during operation to avoid the possibility of exceeding the FCC radio frequency exposure limit.