



■ 外表面视图 □ 内表面视图

版本	变更描述	变更日期	设计师
A01	更新LOGO、专色、增加WEEE信息	2020.2.20	袁蓉辉

UGREEN

USB Bluetooth® Adapter
MANUAL

Model: CM109 | FIN: 30722 30723

English

Thank you for purchasing the UGREEN products. For optimum operation, please read this instruction carefully before use.

Product Details

How it Works

Driver Installation

This product is compatible with Windows XP, Vista/Win7/8/10, etc., does not work for Apple Mac OS.

The driver needs to be installed under Win8 operating system. Compatible with Bluetooth 5.0 and backward versions.

Insert the provided driver CD into your computer CD-ROM, or download the driver installation package "Bluetooth 4.0 CSR".

30443/30524/30722/30723" from Download Center of official website: <https://www.ugreen.com/driver/>. This is an installation instruction for Windows 7.

1. Start the installation by clicking the setup.exe file.

2. Select the language and click OK.

3. Click Next.

4. Confirm that you agree with the terms of the License Agreement and click Next.

5. Select the installation directory (recommended to use the preset) and click Next.

6. Select the discovery mode. Discovery ON select the device type. Laptop or PC/Desktop. You may keep the original values of options of SCMS-T. Click Next.

7. Click Install.

8. Click Finish.

9. Restart your computer.

10. Insert Bluetooth dongle to USB port of the computer and you will find a Bluetooth icon in the notification area which means the driver has been installed successfully.

Notes:

- If there is no Bluetooth icon in the notification area, and please restart your computer again or reinstall the driver according to the above steps.

Pairing

- Click with right button to the Bluetooth icon in the notification area and select Show Bluetooth Devices.

Click Add Device and select, for example, Audio/Video device.

Make sure that the device is visible during the searching. Select the found device from the list and click Next.

Click Add Device and select, for example, Audio/Video device.

Select a device to connect with this computer.

After finishing the pairing click Finish.

During the pairing you may be prompted to enter the pairing code. You must enter the identical code to both devices. If you gain the exceptions that do not enable to enter a code, please, try to use the combination of 0000 or 1234, or have a look at the manual of the paired device.

Deutsch

Vielen Dank für den Kauf der UGREEN Produkte. Für einen optimalen Betrieb bitte lesen Sie diese Anweisung sorgfältig vor Gebrauch.

Bedienblende

wie es funktioniert

Installation

Dieses Produkt ist kompatibel mit Windows XP, Vista/Win7/8/10, usw., nicht unterstützt Apple Mac OS.

Systeme unter Win8 müssen Driver installieren, für Windows 8 / 8.1 / 10 Systeme müssen keine Treiber installiert werden. Kompatibel mit Bluetooth 5.0 und früheren Versionen.

Legen Sie die mitgelieferte Treiber-CD in die CD-ROM Ihres Computers ein oder laden Sie das Treiber-Installationspaket "Bluetooth 4.0 CSR".

30443/30524/30722/30723" vom Download Center der offiziellen UGREEN Website herunter: <https://www.ugreen.com/driver/>. Dies ist eine Installationsanleitung für Windows 7.

(Bitte sehen Sie nach den Betriebsanleitung Bild von englische Version)

- Starten Sie die Installation durch Klicken die setup.exe Taste
- Wählen Sie die Sprache und klicken Sie auf OK.
- Klicken Next/Weiter.
- Bestätigen Sie, dass Sie mit den Bedingungen der Lizenzvereinbarung zustimmen, und klicken Sie auf akzeptiere darin Next/Weiter).
- Wählen Sie das Installationsverzeichnisempfohlen, die Voraussetzung zu veranschaulichen klicken Sie auf Next (Weiter).
- Wählen der Discovery-Modus, Discovery ON (Discovery EN): Wählen Sie den Gerätyp, Laptop oder PC / Desktop. Sie können ursprünglichen Werte der Optionen von SCMS-T halten. Klicken Sie auf Next/Weiter).
- Klicken Sie auf Install/Installieren).
- Klicken Finish/Fertig stellen).
- Neustarten Ihrem Computer.

10. Einstecken Sie das Bluetooth Adapter an USB-Port des Computers wurde im Infobereich ein Bluetooth Symbol gefunden, die bedeutet der Treiber wurde erfolgreich installiert.

Hinweise:

- Wenn kein Bluetooth-Symbol im Infobereich ist/bitten Sie neustarten den Computer, oder das Laufwerk neu installieren nach den oben genannten Schritten.

Pairing

- Klicken mit der rechten Taste auf das Bluetooth-Symbol im Infobereich und wählen Sie Show Bluetooth Devices/Anzeigen Bluetooth-Geräte).
- Klicken Gerät hinzufügen und wählen Sie zum Beispiel Audio/Video device/Audio / Video Gerät).
- Stellen Sie sicher, dass das Gerät während den Such sichtbar ist. Wählen Sie die herausgefunden Gerät aus der Liste und klicken Sie auf Next/Weiter).
- Nach der Paarung klicken Sie auf Fertig.

Während der Paarung können Sie den Pairing-Code einzugeben aufgefordert. Sie müssen den gleichen Code auf beiden Geräten eingeben. Wenn Sie wollen die Kopfhörer zu den Bluetooth Adapter ein Peridant bilden und einen Code nicht eingeben, bitte versuchen Sie die Kombination von 0000 oder 1234 zu verwenden, oder einen Blick in die Bedienungsanleitung des gekoppeltes Gerät.

Français

Merci d'avoir acheté le produit de UGREEN Afin de garantir le fonctionnement optimal et la sécurité, veuillez lire attentivement ce manuel avant l'utilisation.

Les Détails du Produit

Fonction

Installation du Driver

Ce produit est compatible avec Windows XP, Vista/Win7/8/10, etc., ne soutient pas Apple Mac OS.

Pas besoin d'installer le pilote pour les systèmes Windows 8 / 8.1 / 10. Compatible avec Bluetooth 5.0 et versions antérieures.

Insérez le CD fourni dans le CD-ROM de votre ordinateur ou téléchargez le package d'installation "Bluetooth 4.0 CSR".

30443/30524/30722/30723" sur le site officiel UGREEN: <https://www.ugreen.com/driver/>. C'est une instruction d'installation pour Windows 7.

« Consultez les images en anglais, s'il vous plaît »

- Démarrer l'installation en cliquant sur le fichier setup.exe.
- Sélectionner la langue et cliquer sur Next / Suivant ».
- Cliquez sur Next / Suivant ».
- Confirmer que vous êtes d'accord avec les termes du contrat de licence et cliquez sur Next / Suivant ».
- Sélectionner le mode de découverte. Découverte ON / Découverte ON : sélectionner le type de dispositif : ordinateur portable ou bureau, SCMS-T : Vous pouvez conserver les valeurs d'origine des options. Cliquez sur Next / Suivant ».
- Cliquez sur le bouton Install / Installer ».
- Cliquez sur le bouton Finish / Terminer ».
- Redémarrer votre ordinateur.
- Renforcez l'adaptateur Bluetooth dans un port USB libre de votre PC et où vous pouvez trouver l'icône Bluetooth 4.0 CSR.

Bluetooth dans la zone de notification, cela signifie que le driver réussit à être installé.

Attention :

- S'il n'y a pas d'icône Bluetooth dans la zone de notification, vous pouvez redémarrer votre ordinateur ou réinstaller le driver selon les étapes ci-dessus.

Couplage

- Cliquez avec le bouton droit sur l'icône Bluetooth dans la zone de notification et sélectionnez Show Bluetooth Devices « Afficher Bluetooth Dispositifs ».
- Cliquez sur Add Device « Ajouter Dispositif » et sélectionnez, par exemple, Audio/Video device « Audio/Video Dispositif ».
- Assurez-vous que le dispositif est visible au cours de la recherche. Sélectionnez le dispositif découvert dans la liste et cliquez sur Next / Suivant ».
- Après avoir terminé l'appariement, cliquez sur Terminer.

Español

Gracias por elegir UGREEN productos. Por favor lee las instrucciones detenidamente antes de usarlo para su óptimo funcionamiento.

Detalles del producto

Cómo funciona

Instalación

El presente adaptador es compatible con sistemas como Windows XP, Vista/Win7/8/10, etc., no funciona con Apple Mac OS.

No hace falta instalar el driver para sistemas Windows 8 / 8.1 / 10. Compatible con Bluetooth 5.0 y versiones anteriores.

Inserte el CD del driver adjunto en el CD-ROM de su ordenador o descargue el paquete del driver "Bluetooth 4.0 CSR".

7. Haga clic en Install/Instalar).

8. Haga clic en Finish/Instalar).

9. Reinicie tu ordenador.

10. Conecta el Bluetooth dongle al puerto USB del ordenador / y encontrarás un icono de Bluetooth en la barra de notificación, lo cual significa que ya tienes el driver programa instalado con éxito.

Notas:

- Si en la barra de notificación no aparece el Bluetooth icono, haga clic en el botón de reiniciar el ordenador o reinstalar el driver programa según las instrucciones detalladas arriba.

Configuración para emparejamiento

- Haga clic en el botón derecho del Bluetooth icono en barra de notificación y seleccione Show Bluetooth Devices/Mostrar Bluetooth Dispositivos).
- Haga clic en Add Device/Agregar un Dispositivo y seleccione el correspondiente.
- Asegúrese de que el dispositivo está configurado y en modo visible en proceso del descubrimiento. Seleccione el correcto dispositivo detectado desde la lista y después haga clic en Next/Siguiente para continuar.

Después del emparejamiento haga clic en Finish/Instalar).

Al emparejar se le pedirá que introduzca el código de emparejamiento, en este caso, leen que introduzca el mismo código en ambos dispositivos. Si estás emparejando auriculares que no permitan ingresar el código, haga a favor de intentar la combinación de 0000 o 1234, y también echar un vistazo al manual del dispositivo pendiente de emparejar.

Italiano

Grazie per acquistare i prodotti UGREEN. Per operazione ottimale e sicurezza, si prega di leggere attentamente le istruzioni prima di utilizzare.

Dettagli Prodotto

Come Funziona

Installazione del Driver

Questo prodotto è compatibile con Windows XP, Vista/Win7/8/10, etc., ma non funziona con Apple Mac OS.

Deve installare il driver per il sistema operativo scelto. Non è compatibile con Bluetooth 5.0 e le versioni precedenti.

Inserezze il CD del driver fornito nel CD-ROM del computer o scaricare il pacchetto di installazione del driver "Bluetooth 4.0 CSR".

30443/30524/30722/30723" del centro di download del sito web ufficiale UGREEN: <https://www.ugreen.com/driver/>.

Questa è un'istruzione di installazione per Windows 7.

(Si prega di fare riferimento alla versione inglese delle istruzioni tutte foto operative)

- Avviare l'installazione cliccando su setup.exe.
- Scegliere il linguaggio e cliccare su OK.
- Cliccare su Next/Avanti).
- Confermare che si è d'accordo con i termini del contratto di licenza e cliccare su Next/Avanti).
- Scegliere la cartella di destinazione (consigliato di usare l'impostazione predefinita) cliccare su Next/Avanti).
- Scegliere la modalità individuazione. Discovery ON (Individuazione attivata), selezionare il tipo dispositivo, Laptop o PC/Desktop. Si può mantenere i valori originali delle opzioni di SCMS-T. Cliccare su Next/Avanti).
- Cliccare su Install/Installa).
- Cliccare su Finish/Fini).
- Riavviare il tuo computer.
- Inserire l'adattatore Bluetooth nella porta USB del computer e nell'area di notifica si troverà l'icona di Bluetooth che significa che il driver è stato installato con successo.

Note Bene:

- Se non c'è l'icona Bluetooth nell'area di notifica, si prega di riavviare ancora una volta il tuo computer o reinstallare il driver secondo i passi sopra.

Appairamento

- Cliccare con il tasto destro l'icona Bluetooth nell'area di notifica e selezionare Show Bluetooth Devices/Mostrar dispositivi Bluetooth).
- Cliccare su Add Device/Aggiungere un dispositivo e selezionare, per esempio, Audio/Video device/Dispositivo Audio/Video).
- Assicurarsi che il dispositivo sia visibile durante la ricerca. Selezionare il dispositivo scoperto dall'elenco e cliccare su Next/Avanti).
- Cliccare su Finish/Fini) dopo avere finito l'appairamento.

日本語

ご購入はUGREEN製品をお買い上げいただき、誠にありがとうございます。製品を正しく安全にご使用いただくために、ご使用の前にこのマニュアルをよくお読みください。その他にも重要な説明が記載してあります。

製品仕様

動作ステップ

ドライバのインストール

対応: Windows XP, Vista/Win7/8/10等。対応: Apple Mac OS, Windows 8/8.1/10等のみならず、ドライバインストールも必要ありません。Bluetooth 5.0及びそれ以前のバージョンも対応します。付属のドライバCDをコンピュータのCD-ROMに挿入するか、または、下記UGREENのウェブサイトからダウンロードしてドライバインストール。

インストールを完了してください。

ご注意:

- デバイスの通知欄にはBluetoothアイコンが表示されていなく場合、お使いのコンピュータを再起動してください。あるいは上記の手順に応じて、ドライバを再インストールしてから再インストールしてください。

ペアリング

- 通知欄に表示されているBluetoothアイコンを右ボタンをクリックし、Show Bluetooth Devicesを選択してください。
- 「デバイスを追加」をクリックして選択してください。例えばオーディオ/ビデオデバイス。
- 確認時に、デバイスが検出されていなければクリックしてください。リストから見つけたデバイスを選択し、Next [次へ] をクリックします。
- ペアリングを確認し、Finish [完了] をクリックしてください。
- ペアリング後、ペアリングアイコンのみが表示される可能性があります。また、その場合、両方のデバイスに同じコードを入力してください。その場合、両方のデバイスに0000または1234を入力してください。

IMPORTANT WEEE INFORMATION

This symbol on the product and/or its accompanying documents indicates that, under the new Directive 2002/95/EC on waste electrical and electronic equipment (WEEE), products and their components must be recycled. It is not to be disposed of with other waste. Please do not burn or use for any other purpose.

Disposing of this product correctly will help you reduce environmental pollution and prevent any potential negative effects on human health and the environment, which could otherwise arise from inappropriate waste handling.

Please contact your local authority for further details of your country's separate collection points.

Responsible may be applicable for incorrect disposal of this waste, in accordance with your national legislation.

For professional users in the European Union

Users with professional and/or industrial equipment (EEL), please refer to the manufacturer's instructions for disposal.

For disposal in countries outside of the European Union

This symbol is only valid in the European Union (EU). If you wish to export this product, please contact your local authorities or dealer and ask for the correct method of disposal.

WARRANTY INFORMATION

A limited 2 year warranty applies to all UGREEN products purchased from UGREEN official store or authorized sellers. Please see here to contact us if you have any problems.

CONTACT US

FOR AMAZON MARKETPLACES

NORTH AMERICA

US: support.us@ugreen.com OK: support.us@ugreen.com

EUROPE

DE: support.eu@ugreen.com DE: support.eu@ugreen.com

FR: support.fr@ugreen.com FR: support.fr@ugreen.com

ASIA/AFRICA

JP: support.jp@ugreen.com AU: support.au@ugreen.com

MIDDLE EAST

UA: support.ua@ugreen.com

MOBILE SALES CHANNELS

AMAZON: amazon.us@ugreen.com

LAZADA: lazada.us@ugreen.com

EBAY: ebay.us@ugreen.com

SHOPEE: shopee.us@ugreen.com

WHOLESALE BUSINESS: business@ugreen.com

FCC STATEMENT

This device complies with Part 15 of the FCC rules. Operation is subject to the following two conditions: (1) The device may not cause harmful interference, and (2) the device must accept any interference received, including interference that may cause undesired operation.

Changes to this product that are not approved by the manufacturer are the user's responsibility for compliance with the FCC Declaration of Conformity.

Learn more about the FCC Declaration of Conformity: <https://www.fcc.gov/decl>

UGREEN GROUP LIMITED

www.ugreen.com

support@ugreen.com

EU: support@ugreen.com

FR: support@ugreen.com

+86-755-26655520

ugreen@foxmail.com

ugreen_official

Ugreen Official

Ugreen Building, Longcheng Industrial Park, Longcheng Road, Longcheng, Shenzhen, China

UGREEN is a registered trademark of Ugreen Group Limited. All rights reserved.

RoHS CE FCC

备注:
1. 材质: 70G 书写纸
2. 印刷颜色: 单黑+1专 PANTONE 356C
3. 展开尺寸: 640*160mm
4. 成型尺寸: 80*80 mm
5. 成型工艺: 风琴折
6. 公差范围: ± 1mm

SELECT	TOL		V		EPS		EPE		EPP		BAG		CTN		LABEL	
Dim	A	B	C													
0~6	0.05	0.05	0.10													0.20
6~30	0.10	0.15	0.20	0.50	0.50	0.50	3.00									0.20
30~120	0.15	0.20	0.30	0.50	0.50	0.50	5.00	1.00								0.25
120~300	0.20	0.30	0.40	1.00	1.00	1.00	10.00	1.00	0.30							
300~450	0.25	0.40	0.50	2.00	2.00	2.00	15.00	2.00	0.50							
450~600	0.30	0.50	0.60	3.00	3.00	3.00	20.00	3.00	0.80							
DRAFT TOLERANCE			±0.20°			CRITICAL DIM MARK			*							

SCALE 1:1

UGREEN 绿联 深圳市绿联科技有限公司

SHEET 1/1

物料名称: CM109 30722 30723 说明书 共用

UNIT mm

产品名称

料号

项目工程师

核准

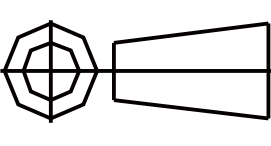

蓝牙适配器

何艳芳

FCC Caution:

This device complies with part 15 of the FCC Rules. Operation is subject to the following two conditions: (1) This device may not cause harmful interference, and (2) this device must accept any interference received, including interference that may cause undesired operation.

Any Changes or modifications not expressly approved by the party responsible for compliance could void the user's authority to operate the equipment.

Note: This equipment has been tested and found to comply with the limits for a Class B digital device, pursuant to part 15 of the FCC Rules. These limits are designed to provide reasonable protection against harmful interference in a residential installation. This equipment generates uses and can radiate radio frequency energy and, if not installed and used in accordance with the instructions, may cause harmful interference to radio communications. However, there is no guarantee that interference will not occur in a particular installation. If this equipment does cause harmful interference to radio or television reception, which can be determined by turning the equipment off and on, the user is encouraged to try to correct the interference by one or more of the following measures:

- Reorient or relocate the receiving antenna.
- Increase the separation between the equipment and receiver.
- Connect the equipment into an outlet on a circuit different from that to which the receiver is connected.
- Consult the dealer or an experienced radio/TV technician for help.

The device has been evaluated to meet general RF exposure requirement. The device can be used in portable exposure condition without restriction.