



MINI RACING

Radio control series

Instruction manual

ITEM NO.2017(series)

6+ ages

Name of product: 1:67 mini racing car

Product features:

PLAYING TIME: 6-10 minutes(equipped with large capacity battery, the car can reach its best effect after charging and discharging several times) ;
REMOTE CONTROL DISTANCE: 6-20 metres;
GREAT PERFORMANCE: reliable frequency selection and strong anti-interference ability.

Preparation:

- 1.Remove the color package and take out the plastic box. Pull the button to the right as arrow 1 pointed, and get the transmitter by the direction of arrow 2.(Graph 1)



Graph 1

- 2.Pull out the antenna as graph 2 shows.

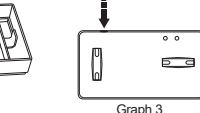

Graph 2

- 3.Insert the antenna into the hole at the top of the transmitter and tighten it. (Graph3)

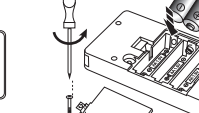

Graph 3

- 4.Open the battery cover, insert 3X1.5V AA battery with correct polarity and replace the battery cover.(Graph4)



Graph 4

- 5.Rip off the tape, pull out the transparent cover. (Graph5)

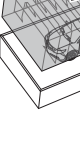

Graph 5

- 6.Open the lock catch.(Graph6)

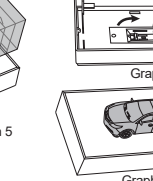

Graph 6

- 7.Drag the car according to the direction, and take out the car. (Graph7)

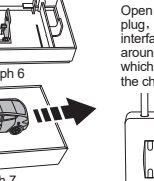

Graph 7

Charge:

Open the charging cover and pull out the charging plug, then insert the plug into the car's charging interface hole, the indicator light will be on, around 7 minutes later, the indicator will be off, which means the car is fully charged, then pull out the charging plug.(Graph 8)

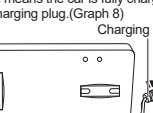

Graph 8

Operation:

1.Introduction of transmitter fuctions. (Graph 9)

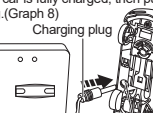

Graph 9

CAUTION:

a).Do not touch the antenna during operation, or the remote control distance will be affected. Breaking antenna needs adults to handle.

b).Due to the inertia and strong power of the car, it cannot stop immediately when running in high speed.

c).If the car becomes apparently slow during operation, this may due to insufficient power, please charge the racing car as this manual describes .

d).When the car is fully charged,please do not recharge the car .

e).The car cannot be charged when the transmitter is lack of power, this happens when the transmitter's indicator light goes dim or be off, please replace the old batteries.

f).Pay attention to the charging plug and interface when you charge the car

g).When not using the car for a long period, make sure the car has more than 50% power, and turn off the car, then remove the batteries from the transmitter.

h).There is a 1.2V (Ni-MH) rechargeable battery inside the racing car, please charge the car under adults's instruction.

i).when removing the package , please make sure there is adult present.

j).Keep this manual for future reference.

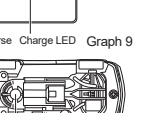

Graph 10

Instruction of the battery

1.The racing car is using 1X1.2V 80MA Ni-MH battery, transmitter is using 3X1.5V AA non-rechargeable batteries.

2.Pay attention to the battery's polarity when installing or replacing the batteries.

3.Non-rechargeable battery cannot be charged.

4.Do not mix with old and new, or different types of batteries.

5.Exhausted batteries must be taken out from the transmitter.

6.Avoid short-circuit.

7.Please remove and load the batteries according to the mark shown on the battery compartment.

8.Chargeable battery can only be charged under the supervision of the adults.

9.Take out the battery from the transmitter when not using the car for a long period.

Battery recycling

Please do not dispose this equipment as daily trash. Exhausted or damaged battery should be put into special designed container.This equipment is composed of electronic component and batteries, they belong to electronic trash, please be familiar with your local trash processing method.

Warning: Changes or modifications to this unit not expressly approved by the party responsible for compliance could void the user's authority to operate the equipment.

NOTE: This equipment has been tested and found to comply with the limits for a Class B digital device, pursuant to Part 15 of the FCC Rules. These limits are designed to provide reasonable protection against harmful interference in a residential installation. This equipment generates, uses and can radiate radio frequency energy and, if not installed and used in accordance with the instructions, may cause harmful interference to radio communications.

However, there is no guarantee that interference will not occur in a particular installation. If this equipment does cause harmful interference to radio or television reception, which can be determined by turning the equipment off and on, the user is encouraged to try to correct the interference by one or more of the following measures:

- Reorient or relocate the receiving antenna.
- Increase the separation between the equipment and receiver.
- Connect the equipment into an outlet on a circuit different from that to which the receiver is connected.
- Consult the dealer or an experienced radio/TV technician for help

The device must not be co-located or operating in conjunction with any other antenna or transmitter.