

# USE

## The remote control

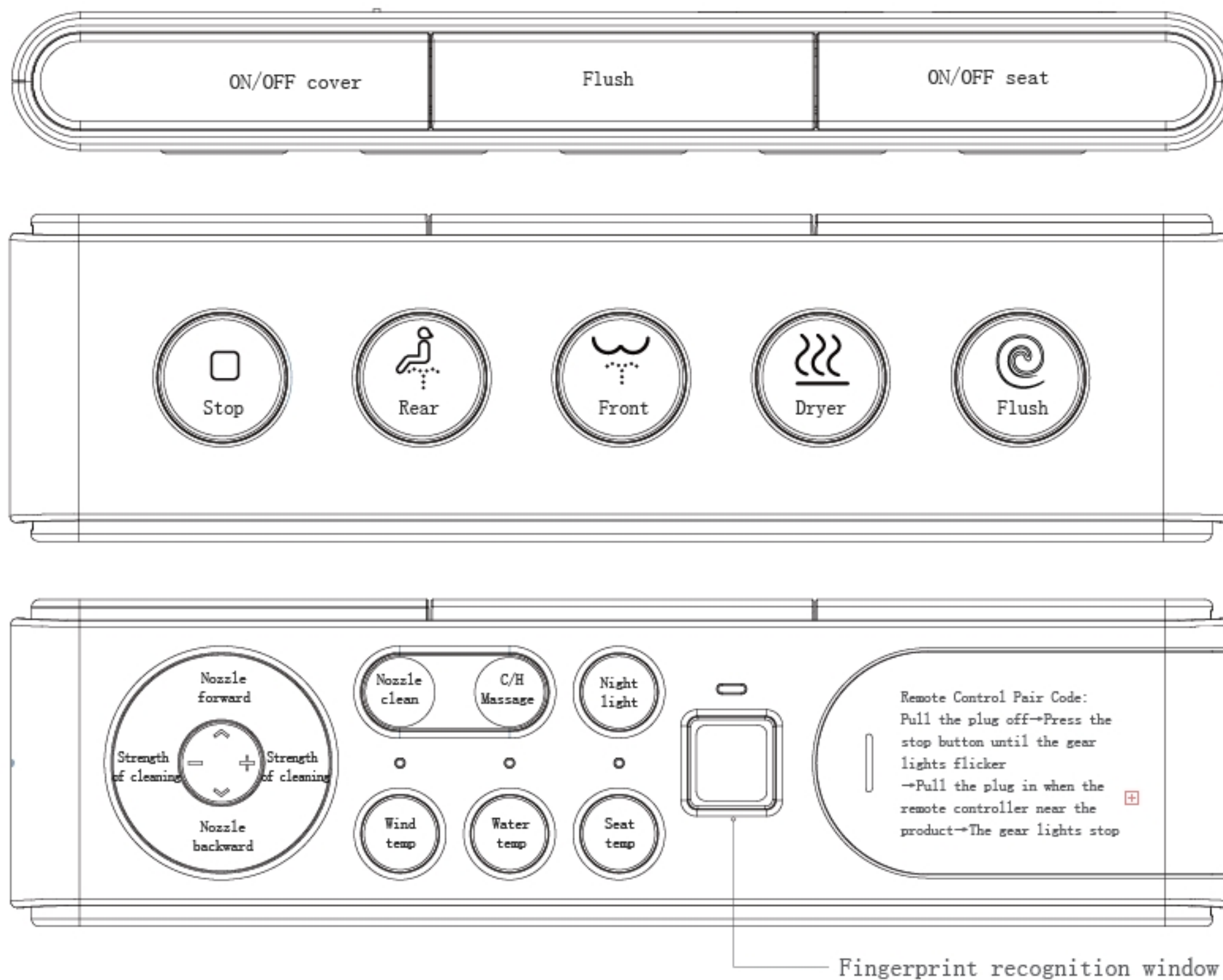

## Wind temperature

Press the "wind temperature" button to adjust the warm air temperature. When pressing the button for the first time, display the current temperature gear. Press the button again, then it will switch the temperature gear, and then it can be

## Water temperature

Press the "water temperature" button to adjust the cleaning water temperature. When pressing the button for the first time, display the current temperature gear. Press the button again, then it will switch the temperature gear, and then it can be

## Seat temperature

Press the "seat temperature" button to adjust the seat temperature. When pressing the button for the first time, display the current temperature gear. Press the button again, then it will switch the temperature gear, and then it can be set

## Cold / hot massage

In the cleaning mode, press the hot and cold massage button to realize alternating hot and cold cleaning of water temperature. ※ this function can only be turned on/off for hot and cold massage during buttocks cleaning and women washing.

## Flush

Press the "flush" button to flush the product

## Strength of cleaning

When the cleaning intensity needs to be changed, please press the "+" button or the "forward rotation" button, and press the "-" button or the "backward rotation" button to

## Nanometer antibacterial

Anti-bacterial materials should be used for seat, upper cover of the whole machine and cleaning nozzle.

## Stop

To stop the function of buttocks cleaning or women washing, press " " button or short press the knob button.

※ hip cleaning and women's washing, with automatic stop function after

## Rear cleaning

Press the "Rear" button. The cleaning water spurts out from the front of the nozzle, cleaning the buttocks in the previous way. Press again to

## Front cleaning

Press the "Front" button. Clean water spurts out from the front end of the nozzle, cleaning women's private places in the past. Press again to close reciprocating cleaning.

## Warm air drying

Press the "dryer" button. Dry cleaned areas.

## Nozzle forward

Press the "nozzle forward" button. The nozzle position can be adjusted

## Self-cleaning nozzle

Start the nozzle self-cleaning action every time the tube is stretched/returned.

## Leave the seat flush

When setting up the seat, there is no flushing command after cleaning, and the ceramic flushing command will be carried out after 6S leaving

---

# WARNING

## FCC Statement

This equipment has been tested and found to comply with the limits for a Class B digital device, pursuant to Part 15 of the FCC Rules. These limits are designed to provide reasonable protection against harmful interference in a residential installation. This equipment generates uses and can radiate radio frequency energy and, if not installed and used in accordance with the instructions, may cause harmful interference to radio communications. However, there is no guarantee that interference will not occur in a particular installation. If this equipment does cause harmful interference to radio or television reception, which can be determined by turning the equipment off and on, the user is encouraged to try to correct the interference by one or more of the following measures:

- Reorient or relocate the receiving antenna.
- Increase the separation between the equipment and receiver.
- Connect the equipment into an outlet on a circuit different from that to which the receiver is connected.
- Consult the dealer or an experienced radio/TV technician for help.

This device complies with part 15 of the FCC Rules. Operation is subject to the following two conditions:

(1) This device may not cause harmful interference, and (2) this device must accept any interference received, including interference that may cause undesired operation.

Changes or modifications not expressly approved by the party responsible for compliance could void the user's authority to operate the equipment.

This device complies with part 15 of the FCC Rules. Operation is subject to the following two conditions: (1) This device may not cause harmful interference, and (2) this device must accept any interference received, including interference that may cause undesired operation.