

MBH583 IM

SIZE: 70x158mm

MAGNAVOX

TRUE WIRELESS
SOFT HOOKS

OWNER'S MANUAL

MODEL: MBH583

FCC NOTICE:

This equipment has been tested and found to comply with the limits for a Class B digital device, pursuant to Part 15 of the FCC Rules. These limits are designed to provide reasonable protection against harmful interference in a residential installation. This equipment generates, uses and can radiate radio frequency energy and, if not installed and used in accordance with the instructions, may cause harmful interference to radio communications. However, there is no guarantee that interference will not occur in a particular installation. If this equipment does cause harmful interference to radio or television reception, which can be determined by turning the equipment off and on, the user is encouraged to try to correct the interference by one or more of the following measures:

- Reorient or relocate the receiving antenna.
- Increase the separation between the equipment and receiver.
- Connect the equipment into an outlet on a circuit different from that to which the receiver is connected.
- Consult the dealer or an experienced radio/TV technician for help.

FCC STATEMENT

1. This device complies with Part 15 of the FCC Rules.
Operation is subject to the following two conditions:
(1) This device may not cause harmful interference, and
(2) This device must accept any interference received, including interference that may cause undesired operation.
2. Changes or modifications not expressly approved by the party responsible for compliance could void the user's authority to operate the equipment.

LOCATION OF CONTROLS

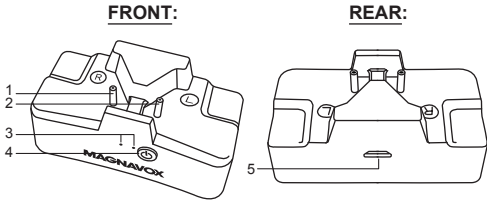

1. Charging Port for R (Right) Earbud
2. Charging Port for L (Left) Earbud
3. Charging Station Indicators
4. ⏻ Button
5. Micro USB Port (For charging only)

EARBUDS:

1. Charging Port
2. Microphone
3. Earbud Indicators
4. - Button
5. + Button
6. Multi-function Button

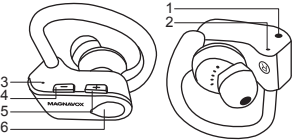

POWER SOURCE

The Charging Station and Earbuds equipped built-in Li-ion rechargeable battery; recharge it before use or when it is drained as below.

Charging Station:

1. Connect the Micro USB Plug from the supplied USB Connection Cable to the Micro USB Port on the rear of Charging Station.
2. Connect the full sized USB Plug from the supplied USB Connection Cable to the USB Port on the Computer or USB Charger. (Computer and USB Charger NOT supplied).
3. When charging, the Red Charging Indicators on the front of Charging Station will blink. When charging is complete, it will stop blinking.

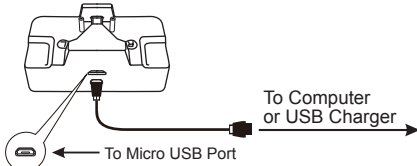

Earbuds:

1. Place the L (Left) Earbud into the L (Left) Charging Port.
2. Place the R (Right) Earbud into the R (Right) Charging Port as shown in the right drawing:
3. Press and release the ⏻ Button to start charging, press and release the ⏻ Button again to stop charging.
 - When charging, the Blue Indicator on the front of Charging Station will illuminate.
 - The Red indicator on each Earbud will illuminate. When charging is complete, it will turn off.

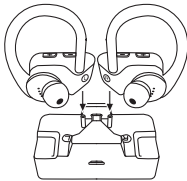

Notes:

1. The charging time period of Left and Right earbuds may vary. It is normal.
2. When charging the Charging Station, you can also charge the Earbuds through the station at the same time.
3. Your battery will last longer if you're following these simple guidelines for caring and storing:
 - A. Before first time use, charge the Charging Station and Earbuds approximately 2 hours until there are fully charged.
 - B. Recharge and store the Charging Station and Earbuds within the temperature range of 5°C~35°C (40°F~95°F).
 - C. Do not charge longer than 24 hours. Excessive charging or running until battery completely flat will damage battery. Battery life will be extended if you keep the battery fully charged.
 - D. Battery life naturally shortens slowly over time.
 - E. The rechargeable battery incorporated in this product is not user replaceable.

OPERATION:

To use the L Earbud alone (Mono mode):

- For first time pairing to the L Earbud to the BT Device (or repair to a new BT Device) alone (Mono mode), follow the steps below:
1. Recharge the Earbud as previously instructed.
 2. Take out the L Earbud from the Charging Station to power on, the Red and Blue indicators on the Earbud will illuminate and blink.

3. Power on the external BT Device and enter to BT searching mode. Start pairing following the on screen instructions from the external BT Device.

Note:

When the external BT Device searches for the unit, the BT device name "MBH583" will appear on the BT Device Name List on your external BT Device. Pair your BT Device with it.

4. When paired, Earbud Indicators will turn off.
5. If pairing is complete you may now play music and answer calls with your external BT Device.
6. During playback:
 - Using the controls on the paired BT Device to adjust sound level; skip tracks ... as usual.
 - Press the Multi-function Button on the Earbud to pause, press again to resume normal playback.
7. If the Earbud is paired to a Cell Phone and a call is incoming during an active music session:
 - Press the Multi-function Button on the Earbud then speak to the Microphone to answer the call. When your call is complete, press the button again to disconnect or end the phone call and resume to music playback.
 - Or, press and hold the Multi-function Button to decline the incoming phone call then resume to music playback.
 - Quick press the Multi-function button twice to redial the last telephone number your cell phone called.
8. When finished listening, press and hold the Multi-function Button on the Earbud to shut off the Earbud.

3. Power on the external BT Device and enter to BT searching mode. Start pairing following the on screen instructions from the external BT Device.

Note:

When the external BT Device searches for the unit, the BT device name "MBH583" will appear on the BT Device Name List on your external BT Device. Pair your BT Device with it.

4. When paired, Earbud Indicators will turn off.
5. If pairing is complete you may now play music and answer calls with your external BT Device.
6. Other operations is same as L Earbud.

To use both L & R Earbuds at the same time (Stereo Mode):

1. Take out L (Left) and R (Right) Earbuds from the Charging Station to power on both earbuds, Red and Blue indicators on each Earbud will illuminate and blink. When Paired, the R Earbud indicator will turn off.
2. Power on the external BT Device and enter to BT searching mode. Start pairing following the on screen instructions from the external BT Device.

Note:

When the external BT Device searches for the unit, the BT device name "MBH583" will appear on the BT Device Name List on your external BT Device. Pair your BT Device with it.

3. When paired, the L Earbud Indicators will turn off.
4. If pairing is complete you may now play music and answer calls with your external BT Device in stereo mode.
5. During playback:
 - Using the controls on the paired BT Device to adjust sound level; skip tracks ... as usual.
 - Press either one of Multi-function Button on the Earbuds to pause, press again to resume normal playback.

6. If the Earbuds are paired to a Cell Phone and a call is incoming during an active music session:
 - Press either one of the Multi-function Button on the Earbuds then speak to the Microphones to answer the call. When your call is complete, press the button again to disconnect or end the phone call and resume to music playback.
 - Or, press and hold the Multi-function Button to decline the incoming phone call then resume to music playback.
 - Quick press either one of Multi-function Button twice to redial the last telephone number your cell phone called.
7. When finished listening, press and hold either one of Multi-function Button on the Earbuds to shut off the L & R Earbuds.

Normal operation after pairing:

1. Power on the external BT Device and enter to BT playback mode.
2. Power on the L and/or R Earbuds as previously instruction.
3. Wait a few seconds, the earbud will automatically pair to the external BT Device.
(Some of cell phones may not have the automatically repairing function. Then enter to the BT searching mode in your external BT Device again, start repairing following the on screen instructions from your external BT Device.)
4. If pairing is complete you may now play music and answer calls with your external BT Device.

TROUBLESHOOTING:

Check the following before requesting service:

SYMPTOM	POSSIBLE CAUSE	POSSIBLE SOLUTION
Can't power on	Built-in battery drained	Recharge the built-in battery of Charging Station and Earbuds as page 2-3
The Earbuds can NOT be recharging	The Charging Station is in Off position	Press the ⏻ Button on the Charging Station to start charging, the Red Indicator on the Earbud will illuminate.
	The Charging contacts on the Charging Station and/or Earbud is dirty	Clear it before charging
	The Earbud had not insert to the Charging Port firmly	Insert the Earbud into Charging Port firmly
No sound or sound weak	Volume level of paired device is in low level	Rise the volume level of the paired device
Sound distortion	Volume level of the paired device too high	Reduce the volume level of the paired device
BT not functioning	The external BT Device had NOT paired to the unit	Pair the external BT Device to the unit as page 3-5
	The external BT device too far from the Earbud	Place the external BT device close to the Earbud

GENERAL SPECIFICATIONS:

Power Source	Charging Station: Built-in DC 3.7 V, 250 mAh (0.925WH) rechargeable Li-ion Battery; Recharge by DC 5V through Micro USB Port
	Earbuds: Built-in DC 3.7 V, 40 mAh (0.148 WH) rechargeable Li-ion Battery per each Earbud; Recharge by the Charging Station
Impedance of the Earbuds	32 ohm
Audio power	5 mW per channel (Total 10 mW)
BT Version	5.0
BT Operation Distance	Up to 32 feet in open area

PACKAGE INCLUDES

- 1 x User's Manual
- 1 x Charging Station
- 2 x Earbuds
- 1 x USB Connection Cable (For charging the Charging Station only)
- 1 x Carry pouch

SPECIFICATIONS AND ACCESSORIES ARE SUBJECT TO CHANGE WITHOUT NOTICE

LIMITED WARRANTY

Craig Electronics Inc. warrants this product to be free from manufacturing defects in material and workmanship under normal use for a period of 180 days from date of purchase. If service is required, please return the product to the store where it was purchased for exchange; or, pack the unit in the original packing material with all accessories if applicable, a copy of your sales receipt and a Cashier's check or Money Order for \$3 (to cover shipping and handling costs) payable to Craig Electronics Inc. For consumers in Canada, please make sure that the cashier check or money order is redeemable through a U.S. bank. Ship your product freight pre-paid. Your unit will be repaired, replaced or if the unit can not be repaired or replaced, a refund will be forwarded to you within four weeks of receipt of your unit. Please ship your unit to:

Craig Electronics Inc.
1160 NW 163 Drive
Miami, FL 33169

This warranty is void if the product has been: a) Used in a commercial application or rental. b) Damaged through misuse, negligence, or abuse. c) Modified or repaired by anyone other than an authorized Craig service center. d) Damaged because it is improperly connected to any other equipment.
Note: This warranty does not cover: a) Ordinary adjustments as outlined in the Owner's Manual which can be performed by the customer. b) Damage to equipment not properly connected to the product. c) Any cost incurred in shipping the product for repair. d) Damage to the product not used in the USA.

This warranty is not transferable and only applies to the original purchase. Any implied warranties, including the warranty of merchantability, are limited in duration to the period of this expressed warranty and no warranty whether expressed or implied shall apply to the product thereafter.

Under no circumstance shall Craig Electronics Inc. be liable for any loss or consequential damage arising out of the use of this product. This warranty gives specific legal rights. However, you may have other rights which may vary from state to state. Some states do not allow limitations on implied warranties or exclusion of consequential damage. Therefore, these restrictions may not apply to you.

This product has been manufactured by and is sold under the responsibility of Craig Electronics Inc. and Craig Electronics Inc. is the warrantor in relation to this product. MAGNAVOX and SMART. VERY SMART are registered trademarks of Koninklijke Philips N.V. and are used under license from Koninklijke Philips N.V.

To Obtain Service on your Product
email: magnavox@craigelectronics.com

Printed in China

MBH583_WC_E0S11_B0US