

What You Get

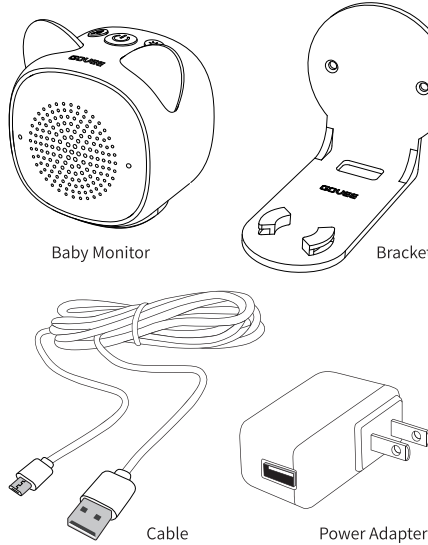

1

Safety Instructions

This baby monitor is compliant with all relevant standards regarding electromagnetic fields. Please read the manual carefully before using the device.

- Adult assembly is required. Keep small parts away from babies when assembling.
- Do not allow babies to play with it as a toy.
- This baby monitor isn't a substitute for responsible adult supervision.
- Keep the device out of the reach of babies.
- Keep cables away from babies (more than 1.64ft/0.5m away).
- Do not place the device near the water or heat source.
- Please use the power adapter provided.

Specification

Wi-Fi Audio Baby Monitor	
Voltage	5V/1A
Wi-Fi-enabled Frequency	2.4GHz
Wi-Fi-enabled Range	30m/100ft

2

At a glance

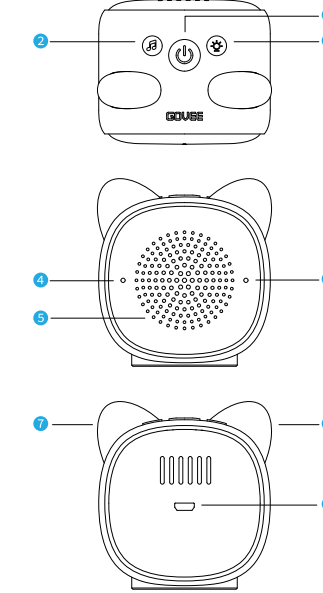

3

1 On/Off Button:

Press to turn Baby Monitor on/off.

Press and hold for 3 seconds to get ready for connecting Wi-Fi.

2 Lullaby Button:

Press to turn on/off lullaby.

Press twice quickly to switch lullaby.

3 Night Light Button:

Press to turn the light on/off.

Press twice quickly to adjust brightness.

Press and hold for 3 seconds to turn the indicator light on/off.

4 Indicator Light:

Solid blue: Wi-Fi connection is normal.

Solid red: Lost Wi-Fi connection.

5 Speaker

6 Mic

7 Night Light

8 Micro USB Port

4

Installing the Baby Monitor

1 On the table

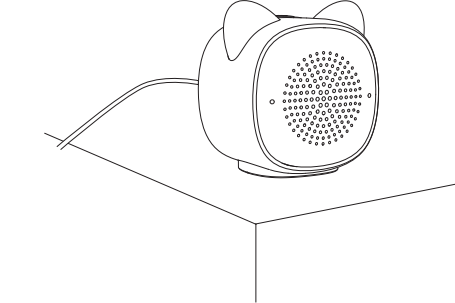

2 By the bracket

a. Install the bracket

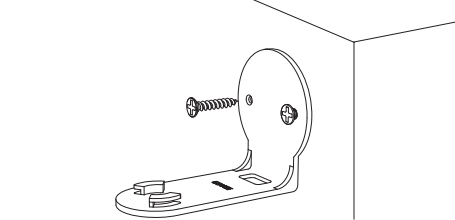

5

b. Install the Baby Monitor

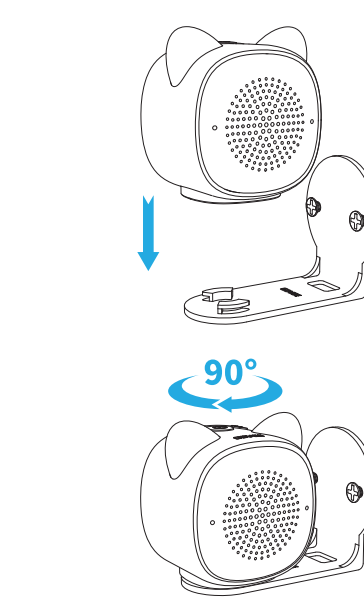

6

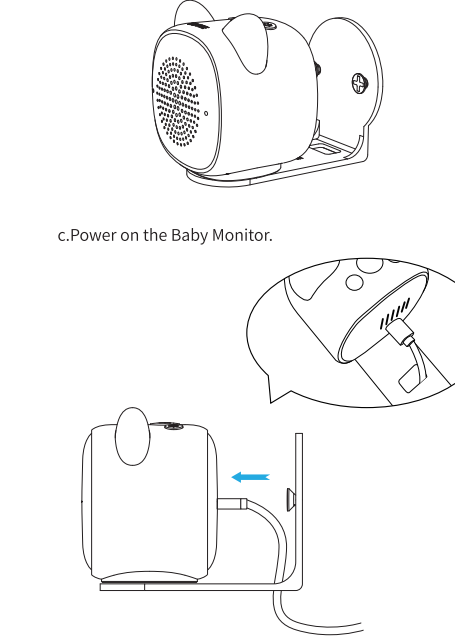

7

Downloading the Govee Home App

What you need:

- Download the Govee Home app from App Store (iOS devices) or Google Play (Android devices).
- A smart phone or tablet running iOS 9.3 (or above) or Android 4.3 (or above).



Connecting to a Wi-Fi Network

- 1 Turn on Bluetooth in your phone;



8

- 2 Connect your phone to 2.4GHz Wi-Fi (GPS should be turned on for Android devices);

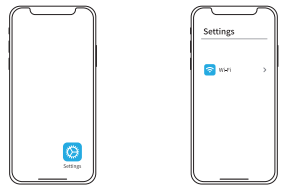

- 3 Open Govee Home, tap “+” icon at the top right corner and select “H7212”;

- 4 Press the button for 3s;

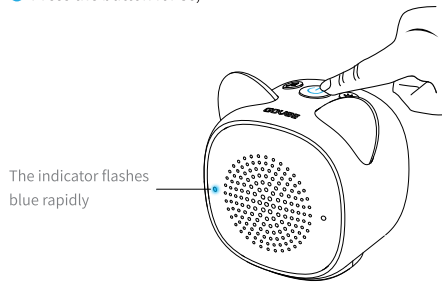

9

- 5 Enter Wi-Fi password;

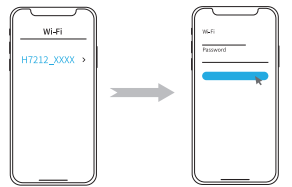

- 6 The device is connecting to Wi-Fi;

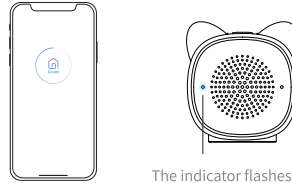

- 7 Connect to Wi-Fi successfully.

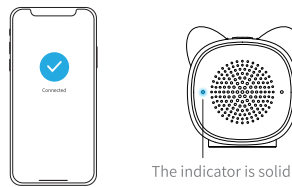

10

Notice:

1. Before connecting to Wi-Fi, make sure the Wi-Fi is 2.4GHz and 802.11 b/g/n bands.
2. The device stops connecting if it doesn't connect to Wi-Fi within 3 minutes.
3. The indicator turns to be solid red if Wi-Fi connection fails. Please check steps above and try again.

Using the Baby Monitor with Govee Home

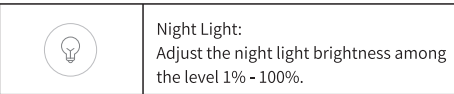
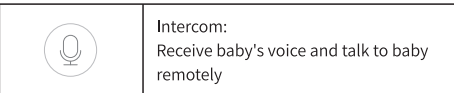
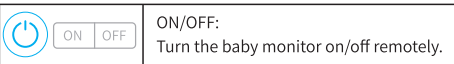

11

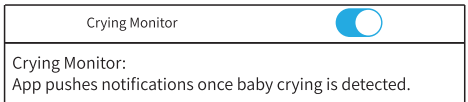
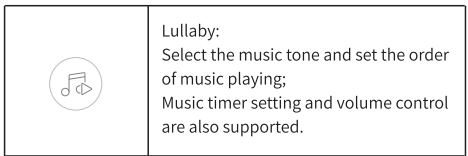

Troubleshooting

- 1 Cannot connect to Wi-Fi/Lost Wi-Fi connection.
 - a. Make sure Wi-Fi is 2.4GHz. 5GHz network is not supported.
 - b. Check whether the Wi-Fi password entered is correct.
 - c. Keep the device within router-enabled range (less than 30m/98ft is suggested).
 - d. Keep obstacles between the device and router as less as possible.
- 2 No/Delayed notification in App.
 - a. Check whether Wi-Fi connection is stable.

12

- b. Make sure Govee Home is allowed in your phone.
- c. Keep the device close to the router.

- 3 Noisy audio transmission.

- a. Keep the device away from other electric appliances.
- b. Check whether the device was stably installed.
- c. More than 10ft/3m between mobile phone and the device is suggested.

- 4 No/Delayed message alert.

- a. Check whether the device is too far from your baby.
- b. Make sure the Mic of device is facing to baby.
- c. Please check whether your phone is mute or in low volume.
- d. Make sure Wi-Fi and your phone signal are stable.

- 5 The indicator doesn't work.

- a. Press the Night Light Button and hold for 3 seconds to turn it on.
- b. Re-turn on or re-plug the baby monitor.

13

Customer Service

Please get in touch about any issues you're having, and we'll try our best to respond with 24 hours.

Warranty: 12-Month Limited Warranty

Support: Lifetime Technical Support

Email: support@govee.com

Official Website: www.govee.com

@Govee @Govee @Govee @Goveeofficial

14

FCC STATEMENT

This device complies with Part 15 of the FCC Rules. Operation is subject to the following two conditions:
(1) This device may not cause harmful interference, and (2) This device must accept any interference received, including interference that may cause undesired operation.
Warning: Changes or modifications not expressly approved by the party responsible for compliance could void the user's authority to operate the equipment.

NOTE: This equipment has been tested and found to comply with the limits for a Class B digital device, pursuant to Part 15 of the FCC Rules.

These limits are designed to provide reasonable protection against harmful interference in a residential installation. This equipment generates uses and can radiate radio frequency energy and, if not installed and used in accordance with the instructions, may cause harmful interference to radio communications. However, there is no guarantee that interference will not occur in a particular installation. If this equipment does cause harmful interference to radio or television reception, which can be determined by turning the equipment off and on, the user is encouraged to try to correct the interference by one or more of the following measures:

- 1.Reorient or relocate the receiving antenna.
- 2.Increase the separation between the equipment and receiver.
- 3.Connect the equipment into an outlet on a circuit different from that to which the receiver is connected.
- 4.Consult the dealer or an experienced radio/TV technician for help.

FCC Radiation Exposure Statement

This equipment complies with FCC radiation exposure limits set forth for an uncontrolled environment. This equipment should be installed and operated with minimum distance 20cm between the radiator & your body.



User Manual

MODEL: H7212

Wi-Fi Audio Baby Monitor