

User Manual

Govee Smart Heater

Contents

Safety Instructions

General Safety
Power Cord & Plug
Risk of Leaks & Electric Shock

01

Included in the Box

02

Introduction

Part Names
Controls
Indicator Status
Functions

02

Getting Started

06

Govee Home App

Downloading Govee Home App
Pairing with Govee Home App

07

Care & Maintenance

Cleaning
Maintenance

07

Troubleshooting

For Smart Heater
For App & Connectivity

08

Appendix

After-Sales Service
Specifications
Compliance Information

10

Govee Smart Heater User Manual

Safety Instructions

General Safety

IMPORTANT INSTRUCTIONS

When using electrical appliances, basic precautions should always be followed to reduce the risk of fire, electric shock, and injury to persons, including the following:

Read all instructions before using this heater.

- This heater is hot when in use. To avoid burns, do not let bare skin touch hot surfaces. If provided, use handles when moving this heater. Keep combustible materials, such as furniture, pillows, bedding, papers, clothes, and curtains at least 3 feet (0.9m) from the front of the heater and keep them away from the sides and rear.
- Extreme caution is necessary when any heater is used by or near children invalids and whenever the heater is left operating and unattended.
- Always unplug heater when not in use.
- Do not operate any heater with a damaged cord or plug or after the heater malfunctions, has been dropped or damaged in any manner. Discard heater remove or return to authorized service facility for examination and/or repair.
- Do not use outdoors.
- This heater is not intended for use in bathrooms, laundry areas, and similar indoor locations. Never place heater where it may fall into a bathtub or other water container.
- Do not run cord under carpeting. Do not cover cord with throw rugs, runners, or similar coverings. Do not route cord under furniture or appliances. Arrange cord away from traffic area and where it will not be tripped over.
- To disconnect heater, turn off controls, then remove plug from outlet.
- Do not insert or allow foreign objects to enter any ventilation or exhaust opening as this may cause an electric shock or fire, or damage the heater.
- To prevent a possible fire, do not block air intakes or exhaust in any manner. Do not use on soft surfaces, like a bed, where openings may become blocked.
- A heater has hot and arcing or sparking parts inside. Do not use it in areas where gasoline, paint, or flammable liquids are used or stored.
- Use this heater only as described in this manual. Any other use not recommended by the manufacturer may cause fire, electric shock, or injury to persons.
- Always plug heaters directly into a wall outlet/receptacle. Never use with an extension cord or relocatable power tap (outlet/power strip).
- Faulty wall outlet connections may cause the wall outlet to overheat. Be sure that the heater plug fits tightly into the outlet before using. When using the heater, check to make sure the heater plug is not overheated. If necessary, have a qualified electrician check or replace the wall outlet.

- This heater can only be used when the ambient temperature is normal. When the heater detects that the ambient temperature is too high, it will automatically shut down. Please inspect for any objects on or adjacent to the heater that may cause high temperatures.
- This appliance has a polarized plug (one blade is wider than the other). To reduce the risk of electric shock, this plug is intended to fit in a polarized outlet only one way. If the plug does not fit fully in the outlet, reverse the plug. If it still does not fit, contact a qualified electrician. Do not attempt to defeat this safety feature.
- Please operate, clean and maintain the equipment in accordance with the manufacturer's recommendations. Any other service should be performed by the authorized service representative.

SAVE THESE INSTRUCTION

Included in the Box

Item	Quantity
Space Heater	1
Base Plates	2
User Manual	1
Quick Start Guide	1

Introduction

Govee Smart Heater is suitable for bedrooms, living rooms, and offices, etc. Equipped with PTC heating elements, this smart heater can heat your room quickly in 3 seconds after it is powered on. One tap in the app and you can adjust based on what you need, bringing you instant warmth and maximum home comfort in cold weather.

Part Names

- | | |
|---------------------|--------------------|
| A. Cover | F. Built-in Handle |
| B. Control Panel | G. Air Inlet |
| C. Air Outlet | H. Rear Guard |
| D. Front Guard | I. Rear Base Plate |
| E. Front Base Plate | J. Clock piece |
| | K. Cable Slot |

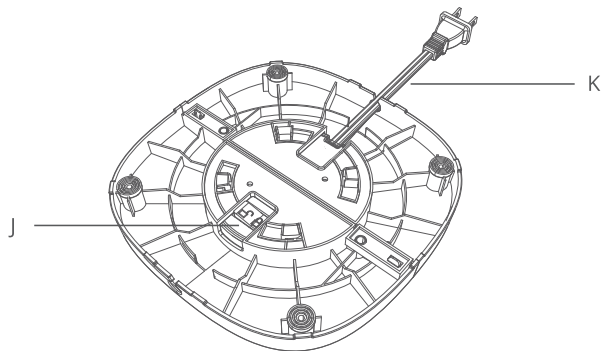
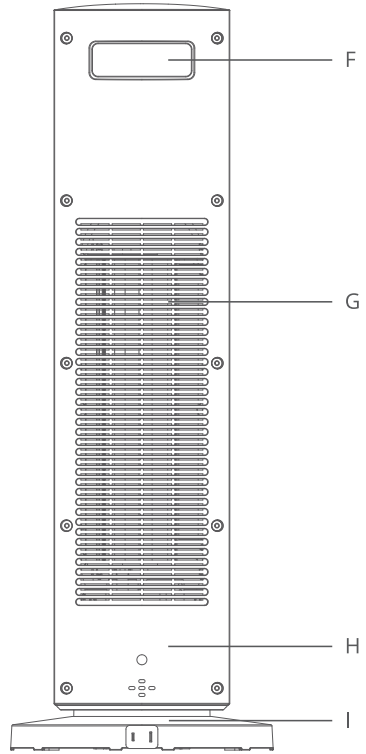
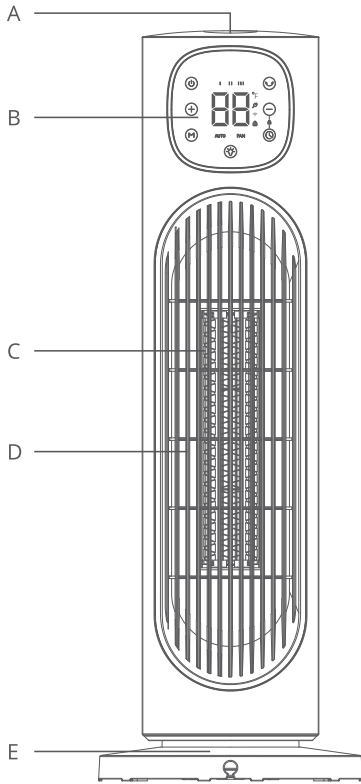

Controls



Power Button

Touch to power on or off.



Oscillation Button

Touch to start or stop the oscillation.



Plus/Minus Button

Touch to adjust the target temperature in Auto Mode. Touch to adjust the time length in Timer Mode.



Mode Button

Touch to cycle through Heating Setting I, Heat Setting II, Heat Setting III, Auto mode, and FAN mode.

Note: Press and hold Power Button and Mode Button for 10 seconds to restore the heater to factory settings and disconnect it from Wi-Fi and Bluetooth.



Timer Button





Touch to set a timer.



Night Light Button

Touch to turn the night light on or off.

Indicator Status

Indicator	Working Status	Light Status
I	Heat Setting I	Solid White
II	Heat Setting II	Solid White
III	Heat Setting III	Solid White
AUTO	Auto Mode	Solid White
FAN	Fan Mode	Solid White
	Powered On	Solid Red
	Safety Lock On	Solid White
	Safety Lock Triggered	Flashes White
	Wi-Fi Connected	Solid White
	Target Temperature / Timer Display	Solid White
All Indicators	Overheat Protection Triggered	Flashes 3 Times

Note: According to related safety standards, the power indicator should always light red when the heater is working.

Functions

Memory Function

This heater will memorize the previous settings (heat settings, oscillation, Wi-Fi connection) when it is powered off. The settings will be active again when this heater is turned on.

24-hour Automatic Shutdown

This heater will shut down automatically when it has been used for 24 hours straight in case the user forgets to power it off.

Overheat Protection

When the heater detects that the ambient temperature exceeds 104°F (40°C), it will automatically power off and all its indicators will flash three times. The heater will automatically resume when it detects that the ambient temperature is lower than 104°F (40°C).

Note: Overheat protection can be dismissed by unplugging the heater from power and waiting for 30 minutes for it to cool down before plugging back in.

Tip-over and Motion Protection

When the heater is moved or knocked over, it will automatically power off and stop all functions. This protection can be dismissed by placing the heater on a flat and sturdy surface and keeping it upright before using it again.

Note: This heater is embedded with a motion sensor. When it senses tip-over or unintended motion, the heater will automatically shut off.

Getting Started

1. Remove all packaging and ensure no foreign objects block the air inlet and outlet.
2. Assemble the front base plate and the rear base plate together as a whole.
3. Pass the power cord through the hole of the base plate.

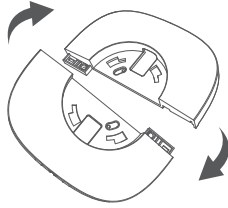

4. Buckle the base plate into the heater body. Rotate the base plate clockwise until the plastic piece blocks the base plate from rotating counterclockwise to secure

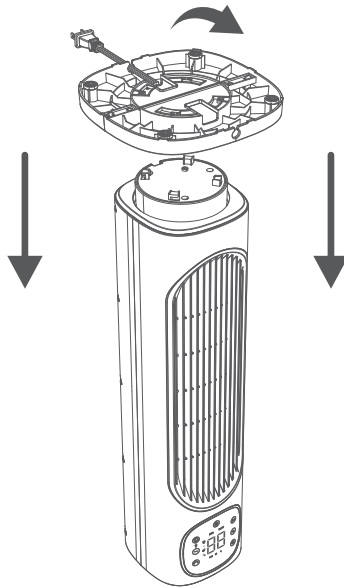

Note: According to related safety standards, the power indicator should always light red when the heater is working.

Govee Home App

You can access more features using Govee Home App.

Downloading Govee Home App

To download Govee Home App, scan the QR code or search for “Govee” in the Apple App Store® (iOS) or Google Play Store (Android).



Govee Home App



Note:

- Choose “Allow” to the permissions requested when opening Govee Home App for the first time. These permissions allow the app’s features to function normally and are not used to record personal, private information.
- Due to ongoing updates, Govee Home App may be slightly different than shown in this manual. In case of any differences, always follow the in-app instructions.

Pairing with Govee Home App

1. Turn on your smartphone’s Bluetooth.
2. Open Govee Home App, tap the “+” icon in the top right corner and search for “H7132”.
3. Tap the device icon and follow the on-screen instructions to complete pairing.

Note:

- You can use Govee Home App to connect your heater to Amazon Alexa or Google Assistant. Follow the in-app instructions to connect to each voice assistant.
- Govee Home App is being continually updated and its features do expand.

Care & Maintenance

Cleaning

To achieve the best performance, clean the heater at least once during the operating season or before storing it when it will not be used for a long period of time.

- Turn the heater off and unplug it from power, then use a soft damp cloth to clean its body, air inlet, and outlet.
- Do not submerge the heater in water and never allow water to drip into it.
- Do not risk your safety by detaching the heater to clean its blade. Otherwise, it may damage the heater or shorten its service life, and even cause danger.

Maintenance

Follow the cleaning instructions and allow all parts to dry completely before storing the heater in a cool, dry place.

Troubleshooting

The troubleshooting section below is for solving frequently asked questions. If your problem persists, please contact customer support.

For Smart Heater

Problem	Possible Causes	Solution
The heater cannot be turned on.	The power cord is not properly plugged into the outlet.	Plug the power cord into a live outlet.
The plug of the heater is hot.	The power plug and the outlet are not securely connected.	Securely reinsert the plug into the socket. If necessary, you should have a qualified electrician check whether the power plug prongs are intact.
The display reading keeps flashing.	The temperature sensor is malfunctioning.	Unplug the heater from power and contact customer support.
The heater suddenly shuts down when hot air is coming out.	Failed to supply power to the heater. Overheat Protection has been triggered.	Ensure your circuit breaker or fuse is working properly. Unplug from the outlet and cool it down. Check and remove any objects on or adjacent to the heater. Wait 30 minutes before plugging the heater back in.
	The Tip-over and Motion Protection has been triggered.	Place the heater on a firm, flat, and level surface free from obstructions. Keep it upright and turn it on again.

For Smart Heater

Problem	Possible Causes	Solution
The heater suddenly shuts down when hot air is coming out.	The Overheat Protection has been triggered.	Unplug from power and wait for 30 minutes for the heater to cool down before plugging back in. The heater will automatically turn on again when the surrounding temperature is below 122°F (50°C).
The oscillation fails around 14°F(-10°C).	The characteristics of grease in motor.	Start the oscillation again after turning on the heater for a while.

For App & Connectivity

1. Cannot connect to Govee Home App.

- Make sure your smartphone is powered on and is not connected with other Bluetooth devices.
- Enable the smartphone's Location Services.
- Try connecting with another smartphone.
- Make sure your app is updated to the latest version.
- Make sure you connect to your Wi-Fi router's 2.4GHz network and that the network is working correctly.
- Make sure the Wi-Fi password you entered is correct.
- Shorten the distance between the heater, Wi-Fi router, and the smartphone.
- Make sure your heater and the Wi-Fi router are located away from appliances that produce electromagnetic radiation (e.g. microwave ovens, refrigerators, etc.)
- If you are using a VPN, try turning it off and then connecting the heater.
- Disable portal authentication for your Wi-Fi network. If portal authentication is enabled, this heater will not be able to access your Wi-Fi network, and setup will fail. Portal authentication means that you need to sign in to your Wi-Fi network through a web page before you can use the Internet.

2. Cannot find the device on Bluetooth Device Nearby page of the app.

- The heater may be connected with another smartphone. Disconnect it from the other smartphone first.

3. The heater is offline.

- Make sure the heater is plugged in and powered on, then refresh “My Devices” in Govee Home App by swiping down on the screen.
- Make sure your router is connected to the internet, and your phone’s network connection is working.
- If the Wi-Fi password has been changed, the heater will automatically go offline. Try connecting it to the network again.
- Delete the offline heater from Govee Home App, then add and reconfigure the heater again in the app.

Appendix

After-Sales Service

Warranty: 12-Month Limited Warranty

Support: Lifetime Technical Support

Email: support@govee.com

Official Website: www.govee.com

Specifications

Model Name	H7132
Power Voltage	120V~, 60Hz
Rated Power	MAX 1500W
Net Weight	3.2 KG/ 7.05 lb
Dimension	210*210*597mm/8.26*8.26*23.5 inch

Compliance Information

FCC Statement

This device complies with Part 15 of the FCC Rules. Operation is subject to the following two conditions: (1) this device may not cause harmful interference, and (2) this device must accept any interference received, including interference that may cause undesired operation.

Warning: Any Changes or modifications not expressly approved by the party responsible for compliance could void the user's authority to operate the equipment.

Note: This equipment has been tested and found to comply with the limits for a Class B digital device, pursuant to Part 15 of the FCC Rules. These limits are designed to provide reasonable protection against harmful interference in a residential installation.

This equipment generates uses and can radiate radio frequency energy and, if not installed and used in accordance with the instructions, may cause harmful interference to radio communications. However, there is no guarantee that interference will not occur in a particular installation. If this equipment does cause harmful interference to radio or television reception, which can be determined by turning the equipment off and on, the user is encouraged to try to correct the interference by one or more of the following measures:

- (1) Reorient or relocate the receiving antenna.
- (2) Increase the separation between the equipment and receiver.
- (3) Connect the equipment into an outlet on a circuit different from that to which the receiver is connected.
- (4) Consult the dealer or an experienced radio/TV technician for help.

FCC Radio Frequency Exposure Statement

This equipment complies with FCC radiation exposure limits set forth for an uncontrolled environment. This equipment should be installed and operated with minimum distance 20cm between the radiator & your body.

The following importer is the responsible party

Name: GOVEE MOMENTS (US) TRADING LIMITED

Address: 13013 WESTERN AVE STE 5 BLUE ISLAND IL 60406-2448

Email: support@govee.com

Contact information: <https://www.govee.com/support>

The Bluetooth® word mark and logos are registered trademarks owned by Bluetooth SIG, Inc. and any use of such marks by Shenzhen Intellirocks Tech. Co., Ltd. is under license.

Govee is a trademark of Shenzhen Intellirocks Tech Co., Ltd.

Copyright 2021 Shenzhen Intellirocks Tech. Co., Ltd. All Right Reserved



Govee Home App

For FAQs and more information,
please visit: www.govee.com