

## Safety Instructions

Read and follow all the safety instructions:

- The strip lights and the control box have an IP65 water-resistant rating and can be used outdoors. Be cautious of the waterproof protection located on the wire's connecting point.
- To avoid damaging your motorcycle battery, press the power (ON/OFF) button on the control box to cut the power supply to the strip lights when not in use for a long period.
- Be cautious of static electricity during installation and usage. Keep the product away from sharp objects or strong corrosive chemicals.
- When bending the strip lights during installation, avoid folding the LED components as it may affect the product's lifespan.
- Remove nails, metal, or other conductive objects from the installation surface before attaching the strip light, as it may cause short-circuiting.
- Do not install the strip lights near any heat sources.
- Do not allow children to install the strip lights alone.
- Avoid installing the strip lights near potentially dangerous sources (e.g., candles, liquid-filled objects).

## Introduction

Thanks for choosing the Govee Motorcycle LED Lights. This product is a RGB Motorcycle LED Lights Kits with 12 strip lights (4x10cm+4x20cm+4x30cm/4x0.328ft+4x0.656ft+4x0.984ft) that support remote and Govee Home app control.

01

## What You Get

Item	Quantity
Strip Lights	12
Remote Controller	1
Cable Ties	30
User Manual	1
Service Card	1

## At a Glance

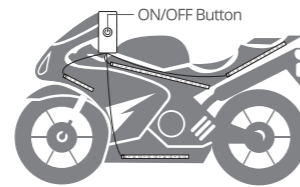

### \* On/Off Button

The master switch of the power. Press to cut off the battery when it is not in use.

(Note: The strip lights cannot be activated by the app or remote after turning off the power this way.)

02

## Using Your Remote Controller

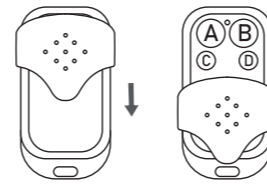

Button	Function
A	Press to turn the strip lights on/off.
B	Press to cycle through 6 brightness levels 1%-20%-40%-60%-80%-100%
C	Press to cycle forward or backward through 32 colors.
D	Press to enter the Music Mode

\* Within 60s after the device is powered on, press the A button and D button at the same time to pair.

## Installing Your Device

### Before You Install

- Unpack the box and check all items listed in the packing list.
- Power on the strip lights and check whether they light up.

03

## Installing Steps

- 1 Wipe the surface to ensure it is clean and dry;
- 2 Peel off the protective film on the tape then stick the strip on and press over it firmly;
- 3 Connect the lights' power line to the motorcycle battery. Red for positive, Black for negative, White for brake;
- 4 Use cable ties to fasten the spare wires, for a neater look;
- 5 Power on the strip lights and start using.

## Pairing Your Device with the Govee Home App



### What You Need:

A smartphone or tablet running iOS 8.0 (or above) or Android 4.3 (or above).

04



Govee Home App

For FAQs and more information, please visit: [www.govee.com](http://www.govee.com)

## Pairing Instructions

- 1 Download the Govee Home app from the App Store (iOS devices) or Google Play (Android devices).
- 2 Turn on Bluetooth on your smartphone.
- 3 Open the app, tap the "+" icon in the top right corner and search for "H6194"
- 4 Tap the device icon and follow the on-screen instructions to complete pairing.

## Specifications

Length	4x10cm+4x20cm+4x30cm/ 4x0.328ft+4x0.656ft+4x0.984ft
Light Color	RGB
Water Resistance	Strip Lights: IP67 Control Box: IP65
Control Method	App, Control Box, Remote Controller
Power Supply	Motorcycle Battery
Voltage	10-15V

05

## Customer Service

- 📄 Warranty: 12-Month Limited Warranty
- 📞 Support: Lifetime Technical Support
- ✉ Email: [support@govee.com](mailto:support@govee.com)
- 🌐 Official Website: [www.govee.com](http://www.govee.com)
- 📺 @Govee
- 📷 @govee\_official
- 📺 @govee.official
- 📺 @Goveeofficial
- 📺 @Govee.smarthome

06

## FCC Statement

This device complies with Part 15 of the FCC Rules. Operation is subject to the following two conditions:  
(1) This device may not cause harmful interference, and (2) This device must accept any interference received, including interference that may cause undesired operation.  
Warning: Changes or modifications not expressly approved by the party responsible for compliance could void the user's authority to operate the equipment.

**NOTE:** This equipment has been tested and found to comply with the limits for a Class B digital device, pursuant to Part 15 of the FCC Rules.

These limits are designed to provide reasonable protection against harmful interference in a residential installation. This equipment generates uses and can radiate radio frequency energy and, if not installed and used in accordance with the instructions, may cause harmful interference to radio communications. However, there is no guarantee that interference will not occur in a particular installation. If this equipment does cause harmful interference to radio or television reception, which can be determined by turning the equipment off and on, the user is encouraged to try to correct the interference by one or more of the following measures:

1. Reorient or relocate the receiving antenna.
2. Increase the separation between the equipment and receiver.
3. Connect the equipment into an outlet on a circuit different from that to which the receiver is connected.
4. Consult the dealer or an experienced radio/TV technician for help.

07

## FCC Radiation Exposure Statement

This equipment complies with FCC radiation exposure limits set forth for an uncontrolled environment. This equipment should be installed and operated with minimum distance 20cm between the radiator & your body.

Non-replaceable light source.  
Not intended for illumination. Only used for creating ambiance.

1. Do not connect the rope light to the supply while it is in the packing or wound onto a reel;
2. Do not use the rope light when covered or recessed into a surface;
3. Do not open or cut the rope light;

The Bluetooth® word mark and logos are registered trademarks owned by Bluetooth SIG, Inc. and any use of such marks by Shenzhen Intellirocks Tech. Co., Ltd. is under license.

	Bluetooth®
Frequency	2.4GHz
Maximum Power	< 10dBm

**CAUTION:**  
RISK OF EXPLOSION IF BATTERY IS REPLACED BY AN INCORRECT TYPE.  
DISPOSE OF USED BATTERIES ACCORDING TO THE INSTRUCTIONS.

Govee is a trademark of Shenzhen Intellirocks Tech Co.Ltd.  
Copyright ©2021 Shenzhen Intellirocks Tech Co.Ltd. All Rights Reserved.

08

Govee

# User Manual



Model:H6194  
Motorcycle LED Lights

H6194说明书

版本:1.0

料号:807-0003-00026

折叠尺寸:75×105 (mm)

展开尺寸:375×105 (mm)

材质:80G书页纸

工艺:印单黑

折叠方式:五折页 (风琴折)