

Model No.: H6018

At a glance

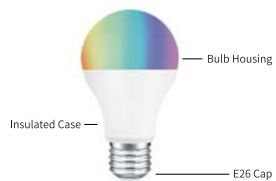

Specification

LED Smart Bulb	
Working Voltage	AC 100 - 240V
Power	9W
Lumen	800lm
Color	RGBWW
Working Temperature	-4°F - 104°F

1

Installing the Bulb

Screw the bulb into base. (Notice: Please turn off the power switch controlling the bulb before installing.)



Downloading the Govee Home App

What you need:

- Download the Govee Home app from App Store (iOS devices) or Google Play (Android devices).
- A smart phone or tablet running iOS 9.3 (or above) or Android 4.3 (or above).

Download the Govee Home App from the App Store (iOS devices) or Google Play (Android devices).



2

Connecting the Bulb to Govee Home

- 1 Connect your phone to a 2.4GHz Wi-Fi. 5GHz band is not supported;



- 2 Open Govee Home, tap "+" icon at the top right corner, select "H6089";
- 3 Turn the bulb on and off 5 times and the bulb will enter breathing mode (more than 1s interval between on and off is suggested);

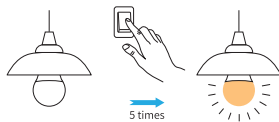

3

- 4 Tap "See the bulb breathing in warm white" in App;

- 5 Enter Wi-Fi password in App and then tap "Go to set" (Notice: Do not switch Wi-Fi to "Govee_bulb_H6089_XXXX" when you need to switch Wi-Fi);

- 6 Go to Wi-Fi setting page and select "Govee_bulb_H6089_XXXX";



4

- 7 Open Govee Home and wait for successful connection (The bulb turns to be solid warm white when connection is done);



- 8 Name your bulb and start to use it with App.



Note: Tap "Video Guide" for more detailed Wi-Fi connecting.

5

Connecting to Alexa/Google Home

- 1 Tap "My Devices" in App and select the bulb you want to control;



- 2 Tap setting icon at the top right corner;









- 3 Select "Using guidance" and then follow instructions offered.





6

Controlling the Bulb with Govee Home

	Group Control: Support individual bulb or group bulbs control.
	Color Changing: Change the light color.
	Scene Modes: 8 lighting scenes optional.
	DIY: Freely combine the light color, mode and speed you like.
	Brightness Adjustment: Adjust the bulb brightness.
	Timer Setting: Schedule a time for the bulb to turn on/off automatically.

7

	Wake: The bulb turns on automatically, brightens gradually and reaches to the brightest at preset time.
	Sleep: The bulb gradually dims and turns off at preset time.

Troubleshooting

- Cannot connect the bulb to Govee Home.
 - a. Check whether Wi-Fi in your phone is turned on. Please make sure Wi-Fi connected to your phone is 2.4GHz (5GHz brand is not supported).
 - b. Check if you have entered the correct Wi-Fi password during Wi-Fi setup.
 - c. Make sure the distance between the bulb and router is less than 50ft.
 - d. Check whether the bulb is powered on.
 - e. Check whether the home network is stable via connecting bulb to another phone's hotspot.

8

- The bulb lost connection.
 - a. Check whether the device is powered on.
 - b. Check whether your home network is stable.
 - c. Check whether the home network is stable via connecting bulb to another phone's hotspot.
 - d. Delete bulbs connected in "My Devices" and reconnect the bulb to Wi-Fi following on-screen instructions.
- How to set group control?
 - a. Tap "My Devices" and select "Scene";
 - b. Tap "+" icon at top right corner to create a new scene.

Note: Select different class according to your needs.
- Is group control via voice available?
 - a. Individual bulb control via voice is supported while group control is not.
 - b. Please set voice group control in Alexa/Google Assistant App.
- Can a bulb be controlled by multiple users?
 - a. One bulb can only be managed by one account.
 - b. Please log in the same account if multiple users want to control one bulb.
- Can App add multiple bulbs simultaneously?
 - a. No. You can only add one bulb at one time in App.

9

- b. If you want to install multiple bulbs in the same lighting fixture, please add all bulbs one by one in App in advance.

Notice

1. The bulb is not waterproof. Please keep it away from water.
2. Please use it within -4°F - 104°F.
3. Please replace a new bulb when lamp bead in it doesn't work.
4. Children are not allowed to install the bulb independently without the help of adults.
5. Please don't install it near the heat source.
6. The dimmer cannot be used with the bulb together.
7. Don't place any source of danger on it.

Customer Service

-  **Warranty: 12-Month Limited Warranty**
-  **Support: Lifetime Technical Support**
-  **Email: support@govee.com**
-  **Official Website: www.govee.com**

 @Govee  @Govee  @Govee  @Goveeofficial

10

FCC STATEMENT

This device complies with Part 15 of the FCC Rules. Operation is subject to the following two conditions:
(1) This device may not cause harmful interference, and (2) This device must accept any interference received, including interference that may cause undesired operation.
Warning: Changes or modifications not expressly approved by the party responsible for compliance could void the user's authority to operate the equipment.

NOTE: This equipment has been tested and found to comply with the limits for a Class B digital device, pursuant to Part 15 of the FCC Rules. These limits are designed to provide reasonable protection against harmful interference in a residential installation. This equipment generates uses and can radiate radio frequency energy and, if not installed and used in accordance with the instructions, may cause harmful interference to radio communications. However, there is no guarantee that interference will not occur in a particular installation. If this equipment does cause harmful interference to radio or television reception, which can be determined by turning the equipment off and on, the user is encouraged to try to correct the interference by one or more of the following measures:

1. Reorient or relocate the receiving antenna.
2. Increase the separation between the equipment and receiver.
3. Connect the equipment into an outlet on a circuit different from that to which the receiver is connected.
4. Consult the dealer or an experienced radio/TV technician for help.

FCC Radiation Exposure Statement

This equipment complies with FCC radiation exposure limits set forth for an uncontrolled environment. This equipment should be installed and operated with minimum distance 20cm between the radiator & your body.

GOVEE
BUILD SMART THINGS

User Manual

MODEL: H6018
Wi-Fi LED Bulb